

District I
1625 N. French Dr., Hobbs, NM 88240
Phone: (575) 393-6161 Fax: (575) 393-0720

District II
811 S. First St., Artesia, NM 88210
Phone: (575) 748-1283 Fax: (575) 748-9720

District III
1000 Rio Brazos Road, Aztec, NM 87410
Phone: (505) 334-6178 Fax: (505) 334-6170

District IV
1220 S. St. Francis Dr., Santa Fe, NM 87505
Phone: (505) 476-3460 Fax: (505) 476-3462

State of New Mexico
Energy Minerals and Natural Resources
Oil Conservation Division
1220 South St. Francis Dr.
Santa Fe, NM 87505

Form C-101
Revised July 18, 2013

HOBBS OCD

☐ AMENDED REPORT

MAR 30 2015

RECEIVED

APPLICATION FOR PERMIT TO DRILL, RE-ENTER, DEEPEN, PLUGBACK, OR ADD A ZONE

¹ Operator Name and Address Apache Corporation: 303 Veterans Airpark Lane, Suite 1000 Midland, TX 79705		² OGRID Number 873
		³ API Number 30-025-35853
⁴ Property Code 309145	⁵ Property Name Mae F Curry	⁶ Well No. 003

7. Surface Location

UL - Lot D	Section 7	Township 21S	Range 37E	Lot Idn	Feet from 660	N/S Line North	Feet From 660	E/W Line West	County Lea
---------------	--------------	-----------------	--------------	---------	------------------	-------------------	------------------	------------------	---------------

*** Proposed Bottom Hole Location**

UL - Lot	Section	Township	Range	Lot Idn	Feet from	N/S Line	Feet From	E/W Line	County
----------	---------	----------	-------	---------	-----------	----------	-----------	----------	--------

9. Pool Information

Pool Name Hardy; Blinebry	Pool Code 29710
------------------------------	--------------------

Additional Well Information

¹¹ Work Type A	¹² Well Type G	¹³ Cable/Rotary R	¹⁴ Lease Type P	¹⁵ Ground Level Elevation 3490'
¹⁶ Multiple No	¹⁷ Proposed Depth 6985'	¹⁸ Formation Blinebry	¹⁹ Contractor	²⁰ Spud Date 4/2015
Depth to Ground water		Distance from nearest fresh water well		Distance to nearest surface water

☒ We will be using a closed-loop system in lieu of lined pits

21. Proposed Casing and Cement Program

Type	Hole Size	Casing Size	Casing Weight/ft	Setting Depth	Sacks of Cement	Estimated TOC
Surf	12-1/4"	8-5/8"	24#	1295'	600	Surface
Prod	7-7/8"	5-1/2"	15.5#	6982'	1525	Surface

Casing/Cement Program: Additional Comments

--

22. Proposed Blowout Prevention Program

Type	Working Pressure	Test Pressure	Manufacturer

²³ I hereby certify that the information given above is true and complete to the best of my knowledge and belief. I further certify that I have complied with 19.15.14.9 (A) NMAC <input type="checkbox"/> and/or 19.15.14.9 (B) NMAC <input type="checkbox"/> , if applicable. Signature: <i>Reesa Fisher</i> Printed name: Reesa Fisher Title: Sr Staff Regulatory Analyst E-mail Address: Reesa.Fisher@apachecorp.com Date: 3/19/2015 Phone: (432) 818-1062		OIL CONSERVATION DIVISION Approved By: <i>[Signature]</i> Title: Petroleum Engineer Approved Date: <i>03/30/15</i> Expiration Date: <i>03/30/17</i> Conditions of Approval Attached	
--	--	--	--

MAR 31 2015

District I
1625 N. French Dr., Hobbs, NM 88240
District II
1301 W. Grand Avenue, Artesia, NM 88210
District III
1000 Rio Brazos Rd., Aztec, NM 87410
District IV
1220 S. St. Francis Dr., Santa Fe, NM 87505

State of New Mexico
Energy, Minerals & Natural Resources Department
OIL CONSERVATION DIVISION
1220 South St. Francis Dr.
Santa Fe, NM 87505

HOBBS OGD
MAR 30 2015

Form C-102
Revised October 12, 2005
Submit to Appropriate District Office
State Lease - 4 Copies
Fee Lease - 3 Copies

RECEIVED

☐ AMENDED REPORT

WELL LOCATION AND ACREAGE DEDICATION PLAT

¹ API Number 30-025-35853		² Pool Code 29710	³ Pool Name Hardy; Blinbry
⁴ Property Code 309145	⁵ Property Name Mae F Curry		⁶ Well Number 003
⁷ OGRID No. 873	⁸ Operator Name Apache Corporation: 303 Veterans Airpark Lane, Suite 1000 Midland, TX 79705		⁹ Elevation 3490' GL

¹⁰ Surface Location

UL or lot no.	Section	Township	Range	Lot Idn	Feet from the	North/South line	Feet from the	East/West line	County
D	7	21S	37E		660	North	660	West	Lea

¹¹ Bottom Hole Location If Different From Surface

UL or lot no.	Section	Township	Range	Lot Idn	Feet from the	North/South line	Feet from the	East/West line	County
¹² Dedicated Acres 40	¹³ Joint or Infill	¹⁴ Consolidation Code		¹⁵ Order No.					

No allowable will be assigned to this completion until all interests have been consolidated or a non-standard unit has been approved by the division.

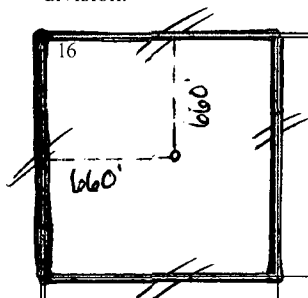

¹⁷ **OPERATOR CERTIFICATION**

I hereby certify that the information contained herein is true and complete to the best of my knowledge and belief, and that this organization either owns a working interest or unleased mineral interest in the land including the proposed bottom hole location or has a right to drill this well at this location pursuant to a contract with an owner of such a mineral or working interest, or to a voluntary pooling agreement or a compulsory pooling order heretofore entered by the division.

Reesa Fisher 03/18/2015
Signature Date

Reesa Fisher

Printed Name

¹⁸ **SURVEYOR CERTIFICATION**

I hereby certify that the well location shown on this plat was plotted from field notes of actual surveys made by me or under my supervision, and that the same is true and correct to the best of my belief.

Date of Survey

Signature and Seal of Professional Surveyor:

Certificate Number