

District I
1625 N. French Dr., Hobbs, NM 88240
Phone: (575) 393-6161 Fax: (575) 393-0720
District II
811 S. First St., Artesia, NM 88210
Phone: (575) 748-1283 Fax: (575) 748-9720
District III
1000 Rio Brazos Road, Aztec, NM 87410
Phone: (505) 334-6178 Fax: (505) 334-6170
District IV
1220 S. St. Francis Dr., Santa Fe, NM 87505
Phone: (505) 476-3460 Fax: (505) 476-3462

State of New Mexico
Energy, Minerals & Natural Resources Department
OIL CONSERVATION DIVISION
1220 South St. Francis Dr.
Santa Fe, NM 87505

Form C-102
Revised August 1, 2011
Submit one copy to appropriate
District Office

SEP 08 2015

☐ AMENDED REPORT

WELL LOCATION AND ACREAGE DEDICATION PLAT

1 API Number 30-025-42774		2 Pool Code 98097		3 Pool Name W.C. 025 G-09 5263327G-UPPER WC					
4 Property Code 715246		5 Property Name EL MAR 21 WIDM FED COM				6 Well Number 3H			
7 GRID NO. 14744		8 Operator Name MEWBOURNE OIL COMPANY				9 Elevation 3275'			
10 Surface Location									
UL or lot no. D	Section 21	Township 26S	Range 33E	Lot Idn	Feet from the 200	North/South line NORTH	Feet From the 660	East/West line WEST	County LEA
11 Bottom Hole Location If Different From Surface									
UL or lot no. M	Section 21	Township 26S	Range 33E	Lot Idn	Feet from the 330	North/South line SOUTH	Feet from the 330	East/West line WEST	County LEA
12 Dedicated Acres 320		13 Joint or Infill		14 Consolidation Code		15 Order No. NSL PENDING			

No allowable will be assigned to this completion until all interest have been consolidated or a non-standard unit has been approved by the division.

		<p>17 OPERATOR CERTIFICATION</p> <p>I hereby certify that the information contained herein is true and complete to the best of my knowledge and belief, and that this organization either owns a working interest or unleased mineral interest in the land including the proposed bottom hole location or has a right to drill this well at this location pursuant to a contract with an owner of such a mineral or working interest, or to a voluntary pooling agreement or a compulsory pooling order heretofore entered by the division.</p> <p>Signature: <i>[Signature]</i> Date: 11-19-14</p> <p>Printed Name: BRADLEY FISHER</p> <p>E-mail Address:</p>	
<p>18 SURVEYOR CERTIFICATION</p> <p>I hereby certify that the well location shown on this plat was plotted from field notes of actual surveys made by me or under my supervision, and that the same is true and correct to the best of my belief.</p> <p>10-23-2014</p> <p>Date of Survey</p> <p>Signature and Seal of Professional Surveyor: <i>[Signature]</i></p> <p>19680</p> <p>Certificate Number</p>			

RRC - Firm No.: TX 10193838 NM 4655451 - Job No.: LS140429

SEP 09 2015

Mewbourne Oil Company

PO Box 5270
Hobbs, NM 88241
(575) 393-5905

I hereby certify that I, or someone under my direct supervision, have inspected the drill site and access route proposed herein; that I am familiar with the conditions which currently exist; that I have full knowledge of State and Federal laws applicable to this operation; that the statements made in this APD package are, to the best of my knowledge, true and correct; and that the work associated with the operations proposed herein will be performed in conformity with this APD package and the terms and conditions under which it is approved. I also certify that I, or the company I represent, am responsible for the operations conducted under this application. These statements are subject to the provisions of 18 U.S.C. 1001 for the filing of false statements.

Executed this 19 day of NOV, 2014.

Name: Robin Terrell

Signature:  FER RT

Position Title: Hobbs District Manager

Address: PO Box 5270, Hobbs NM 88241

Telephone: 575-393-5905

E-mail: rterrell@mewbourne.com

United States Department of the Interior
Bureau of Land Management
Carlsbad Field Office
620 E Greene Street
Carlsbad, New Mexico 88201-1287

Statement Accepting Responsibility for Operations

Operator Name: Mewbourne Oil Company
Street or Box: P.O. Box 5270
City, State: Hobbs, New Mexico
Zip Code: 88241

The undersigned accepts all applicable terms, conditions, stipulations, and restrictions concerning operations conducted of the leased land or portion thereof, as described below.

Lease Number: NM-02965-A, Fee

Legal Description of Land: Section 21, T-26S, R-33E Lea County, New Mexico.
Location @ 200' FNL & 660' FWL

Formation (if applicable): Wolfcamp A

Bond Coverage: \$150,000

BLM Bond File: NM1693 nationwide, NMB000919

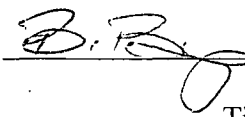
Authorized Signature:  *For RT*
Name: Robin Terrell
Title: District Manager
Date: 11-19-14

MEWBOURNE OIL COMPANY
EL MAR 21 W1DM FED COM #3H
(200' FNL & 660' FWL)
SECTION 21, T26S, R33E
N. M. P. M., LEA CO., NEW MEXICO

EL MAR 21 W1DM FED COM #3H
ELEV.: 3275'
LAT: 32.03559077° N
LONG: 103.58315757° W

DIRECTIONS TO LOCATION

From the intersection of CR-J1 (Orla) and CR-J2 (Battle Axe),
Go East on CR- J2 turning North approx. 9.2 miles to a lease road on
the left;

Turn left and go West approx. 0.3 miles to El Mar 21 A3DM
Fed Com #1H;

Location is on the left.

SCALE: 1" = 100'
0 50 100
BEARINGS ARE
NAD 27 GRID - NM EAST
DISTANCES ARE
GROUND.

Firm No.: TX 10193838 NM 4655451

Copyright 2014 - All Rights Reserved

NO.	REVISION	DATE
JOB NO.:	LS140429	
DWG. NO.:	140429PAD	

RRC

308 W. BROADWAY ST., HOBBS, NM 88240 (575) 964-8200

SCALE: 1" = 100'
DATE: 10-23-2014
SURVEYED BY: BK/KR
DRAWN BY: ARJ
APPROVED BY: RMH
SHEET : 1 OF 1

SCALE: 1" = 100'
DATE: 10-23-2014
SURVEYED BY: BK/KR
DRAWN BY: ARJ
APPROVED BY: RMH
SHEET : 1 OF 1

LOCATION VERIFICATION MAP

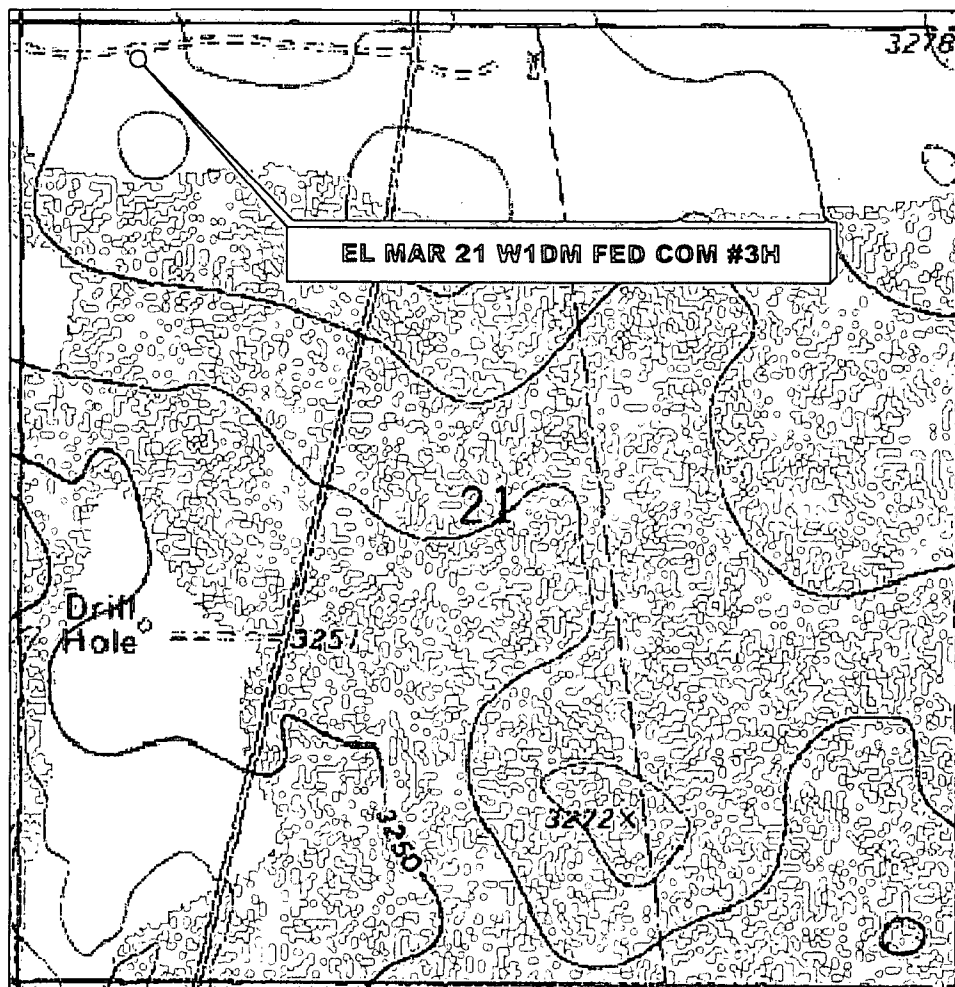

SECTION 21, TWP. 26 SOUTH, RGE. 33 EAST,
N. M. P. M., LEA CO., NEW MEXICO

OPERATOR: Mewbourne Oil Company
LEASE: El Mar 21 W1DM Fed Com
WELL NO.: 3H
ELEVATION: 3275'

LOCATION: 200' FNL & 660' FWL
CONTOUR INTERVAL: 10'
USGS TOPO. SOURCE MAP:
Paduca Breaks East, NM (1973)

Firm No.: TX 10193838 NM 4655451

Copyright 2014 - All Rights Reserved

NO.	REVISION	DATE
JOB NO.: LS140429		
DWG. NO.: 140429LVM		

RRC

308 W. BROADWAY ST., HOBBS, NM 88240 (575) 964-8200

SCALE: 1"=1000'
DATE: 10-23-2014
SURVEYED BY: BK/KR
DRAWN BY: ARJ
APPROVED BY: RMH
SHEET : 1 OF 1

VICINITY MAP

NOT TO SCALE

EL MAR 21 W1DM FED COM #3H

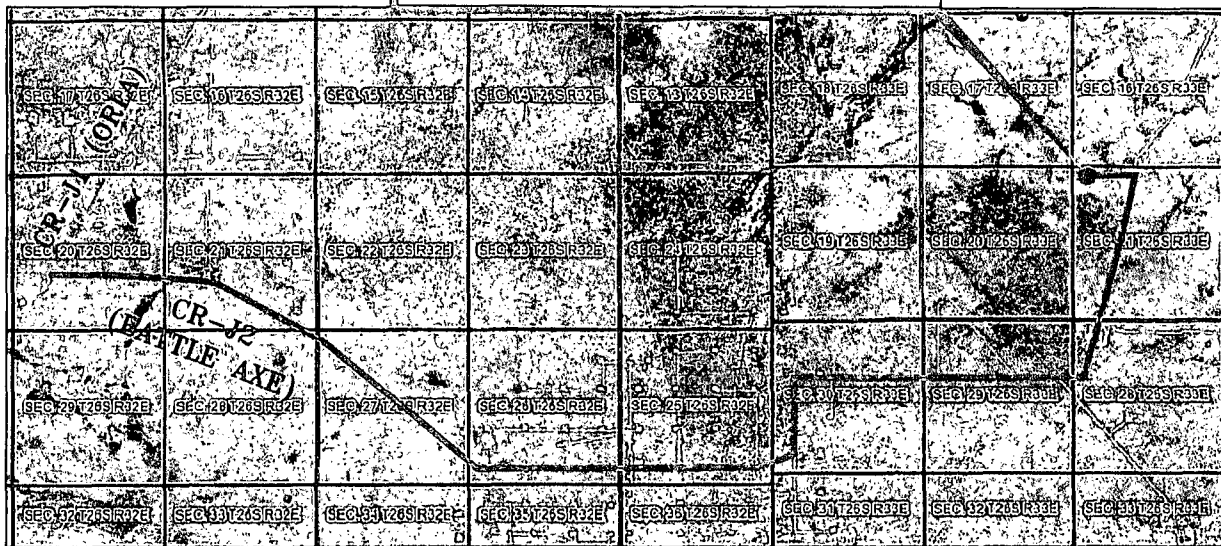

SECTION 21, TWP. 26 SOUTH, RGE. 33 EAST,
N. M. P. M., LEA CO., NEW MEXICO

OPERATOR: Mewbourne Oil Company
LEASE: El Mar 21 W1DM Fed Com
WELL NO.: 3H

LOCATION: 200' FNL & 660' FWL
ELEVATION: 3275'

Firm No.: TX 10193838 NM 4655451

Copyright 2014 - All Rights Reserved

NO.	REVISION	DATE
JOB NO.:	LS140429	
DWG. NO.:	140429VM	

RRC

308 W. BROADWAY ST., HOBBS, NM 88240 (575) 964-8200

SCALE:	NTS
DATE:	10-23-2014
SURVEYED BY:	BK/KR
DRAWN BY:	ARJ
APPROVED BY:	RMH
SHEET :	1 OF 1

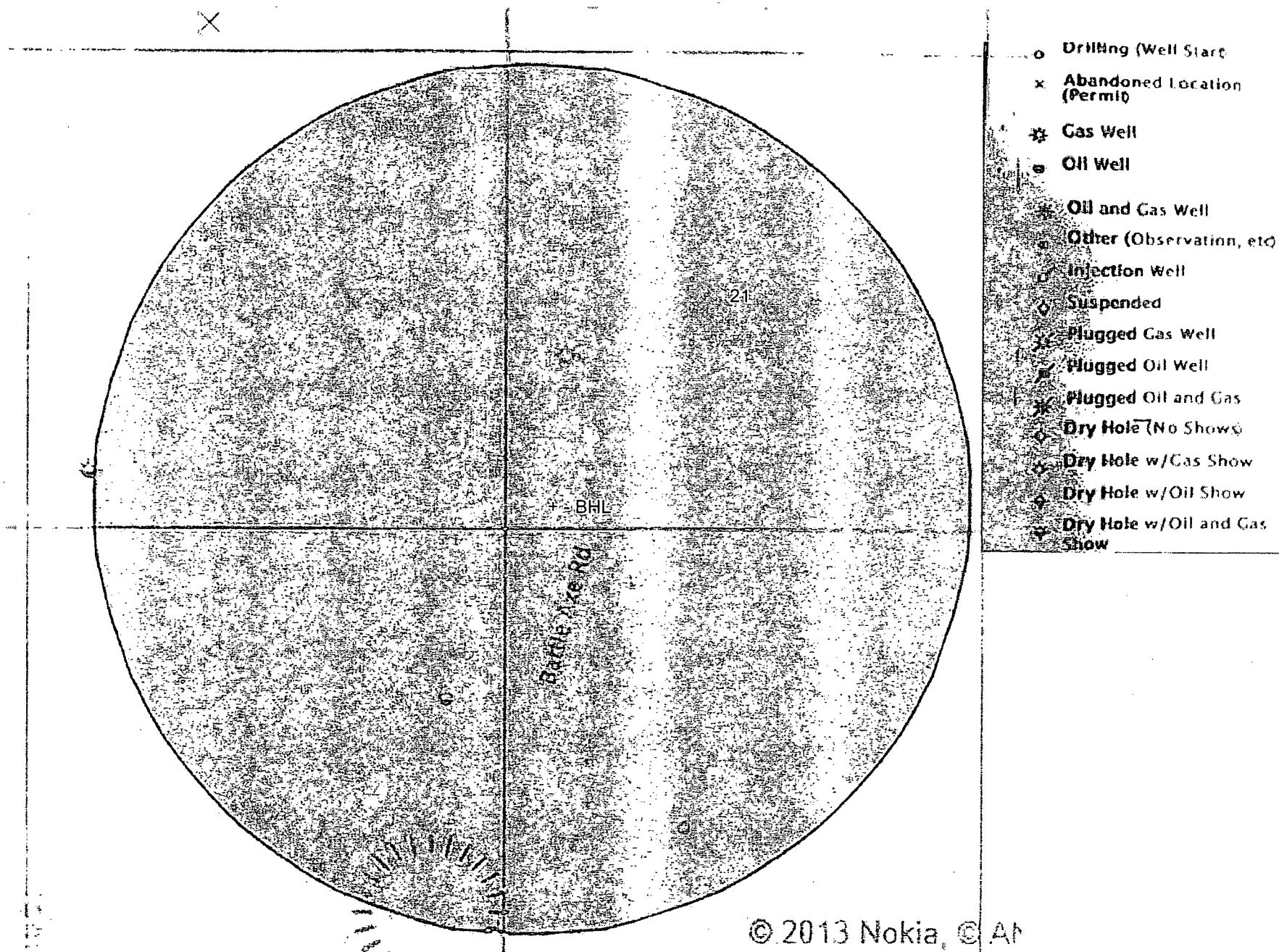
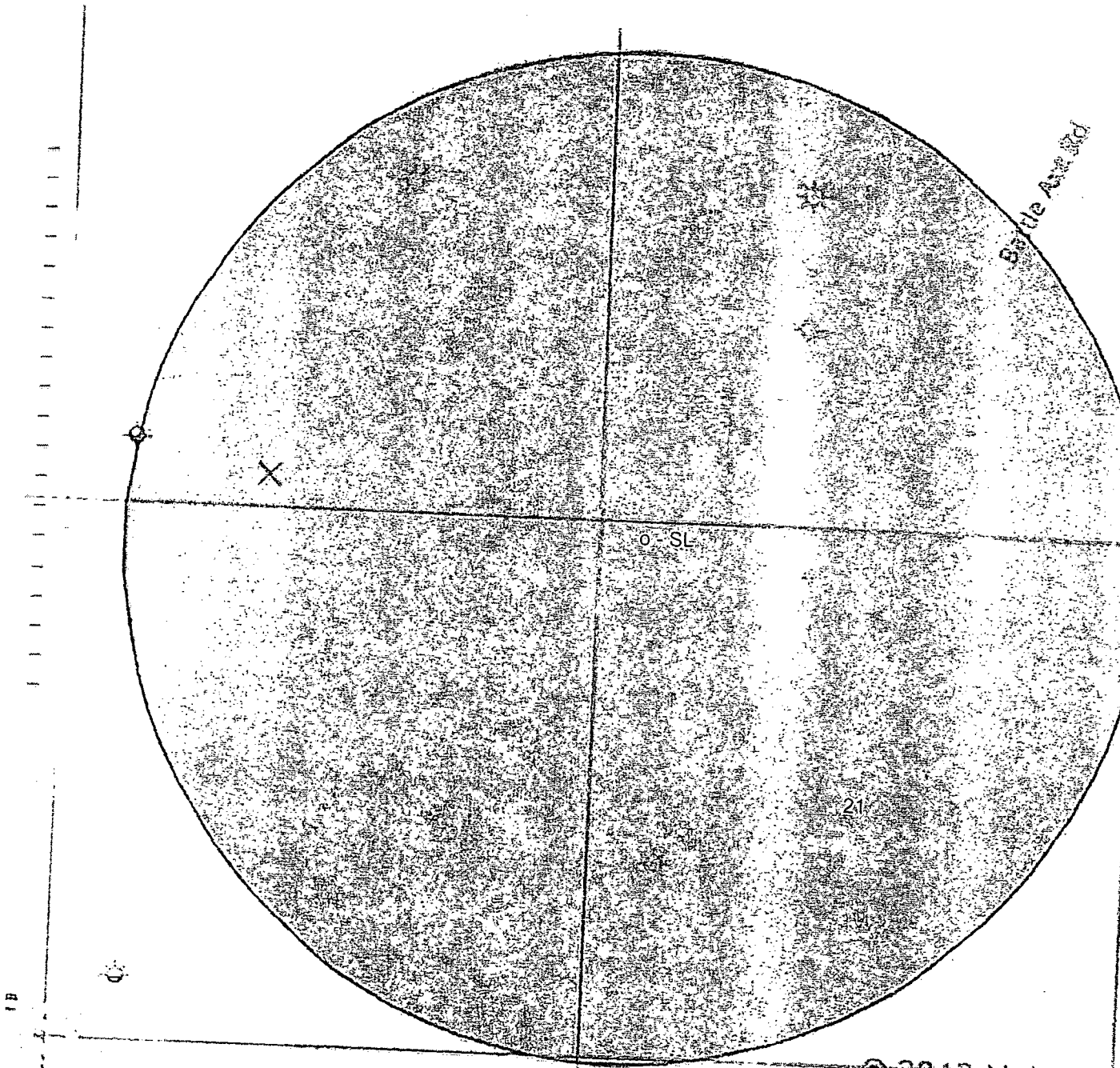

Exhibit "4A" - BHL - El Mar 21 W1DM Fed Com #3H

© 2013 Nokia, © A*



- o Drilling (Well Start)
- x Abandoned Location (Permit)
- * Gas Well
- o Oil Well
- * Oil and Gas Well
- o Other (Observation, etc)
- o Injection Well
- o Suspended
- * Plugged Gas Well
- * Plugged Oil Well
- * Plugged Oil and Gas
- o Dry Hole (No Shows)
- * Dry Hole w/Gas Show
- o Dry Hole w/Oil Show
- * Dry Hole w/Oil and Gas Show

Exhibit "4" SL - El Mar 21 W1DM Fed Com #3H

© 2013 Nokia, © AND

H2S Diagram

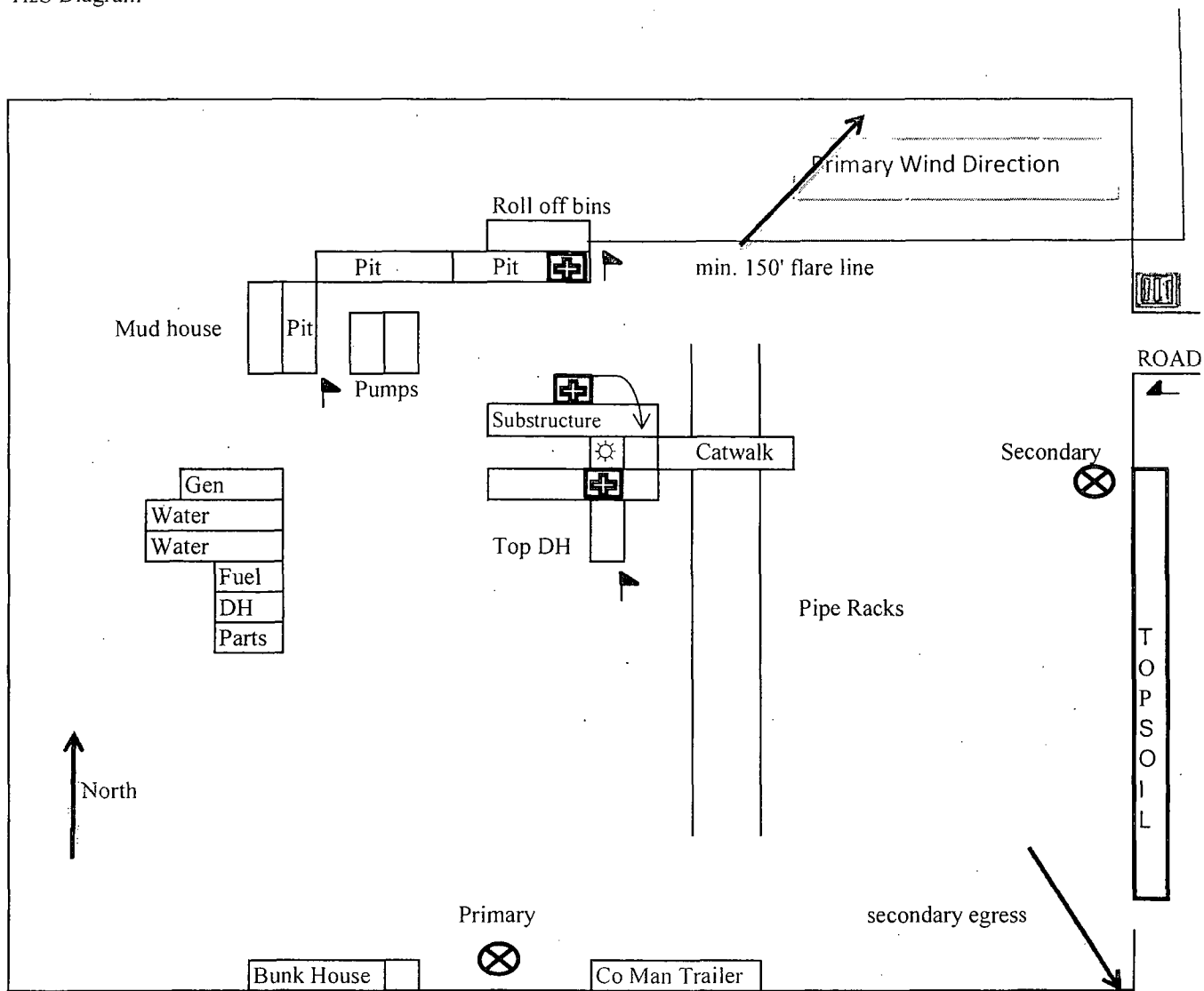

Mewbourne Oil Company
 El Mar 21 W1DM Fed Com #3H
 200' FNL & 660' FWL
 Sec. 21 T26S R33E
 Lea County, NM



= Warning Signs



= Wind Markers



= H2S Monitors



= Safety Stations

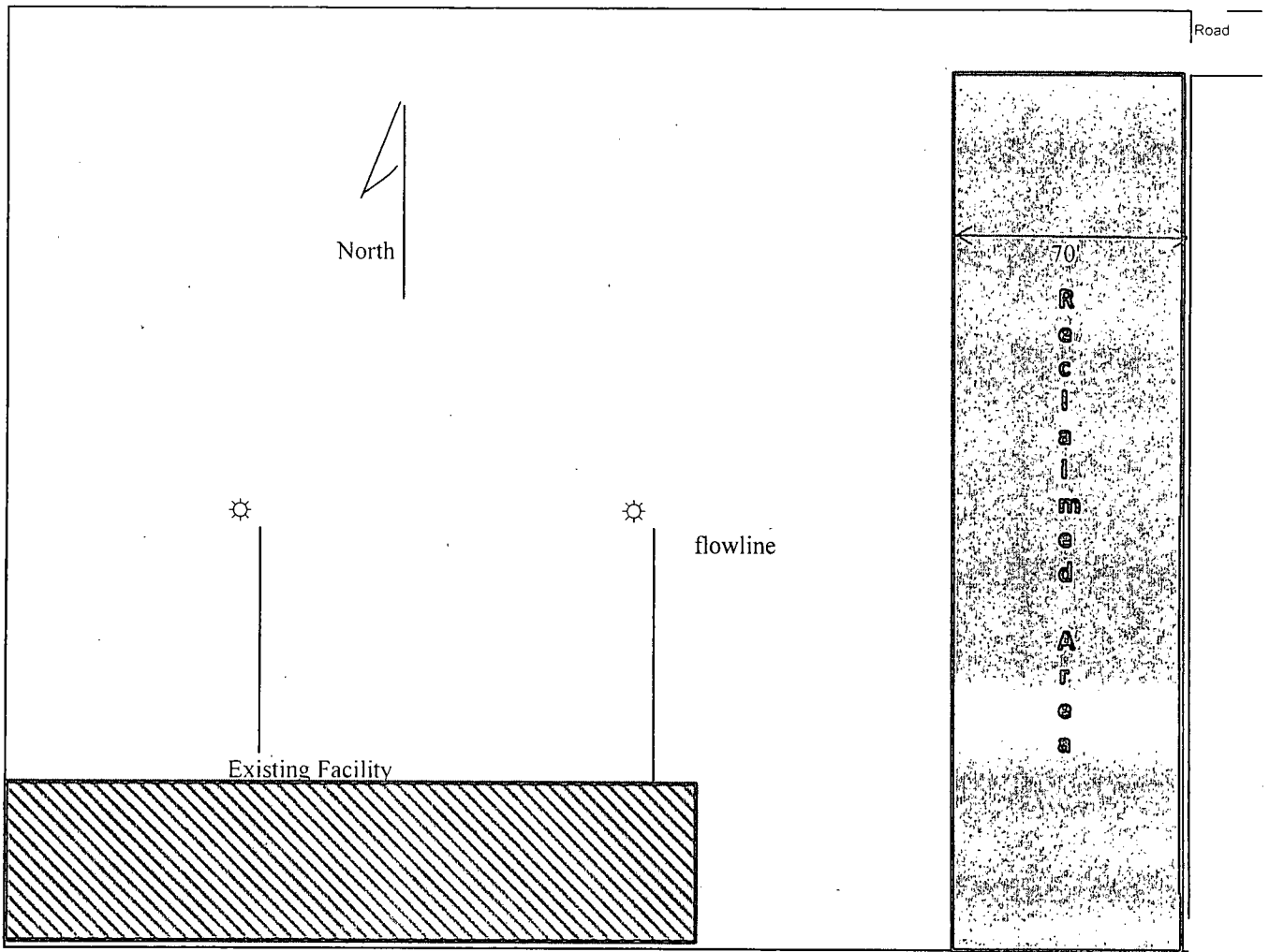

Mewbourne Oil Company
El Mar 21 W1DM Fed Com #3H
200' FNL & 660' FWL
Sec. 21 T26S R33E
Lea Co. NM