

1625 N. French Dr., Hobbs, NM 88240
 District II
 811 South First, Artesia, NM 88210
 District III
 1000 Rio Brazos Road, Aztec, NM 87410
 District IV
 2040 South Pacheco, Santa Fe, NM 87505

Energy Minerals and Natural Resources

Form C-101
 Revised March 17, 1999

Oil Conservation Division
 2040 South Pacheco
 Santa Fe, NM 87505

Submit to appropriate District Office
 State Lease - 6 Copies
 Fee Lease - 5 Copies

AMENDED REPORT

APPLICATION FOR PERMIT TO DRILL, RE-ENTER, DEEPEN, PLUGBACK, OR ADD A ZONE

Operator Name and Address ARCH PETROLEUM, INC. P.O. BOX 10340 MIDLAND, TEXAS 79702-7340		OGRID Number 962
Property Code 14896		API Number 30-025-36331
Property Name BERTIE WHITMIRE		Well No. 11

Surface Location

UL or lot no.	Section	Township	Range	Lot Lth	Feet from the	North/South line	Feet from the	East/West line	County
B	8	20S	37E		660'	NORTH	1650'	EAST	LEA

Proposed Bottom Hole Location If Different From Surface

UL or lot no.	Section	Township	Range	Lot Lth	Feet from the	North/South line	Feet from the	East/West line	County

Proposed Pool 1 MONUMENT ABO SOUTHEAST (96764)	Proposed Pool 2
---	-----------------

Work Type Code N	Well Type Code O	Cable Rotary ROTARY	Lease Type Code P	Ground Level Elevation 3549' GR.
Multiple NO	Proposed Depth 7500'	Formation ABO	Contractor UNKNOWN	Spud Date WHEN APPROVED

Proposed Casing and Cement Program

Hole Size	Casing Size	Casing weight/foot	Setting Depth	Sacks of Cement	Estimated TOC
25"	20"	Conductor	40'	Redi-mix	Surface
12 1/2"	8 5/8"	32	1100'	1000 Sx.	Surface
7 7/8"	5 1/2"	17 & 15.5	7500'	1650 Sx.	Surface

Describe the proposed program. If this application is to DEEPEN or PLUG BACK, give the data on the present productive zone and proposed new productive zone. Describe the blowout prevention program, if any. Use additional sheets if necessary.

1. Drill 25" hole to 40'. Set 40' of 20" conductor and cement to surface w/ Redi-mix.
2. Drill 12 1/2" hole to 1100'. Run and set 1100' of 8 5/8" 32# J-55 SPC casing. Cement with 1000 Sx. of Class "C" cement + 1/2# Flocele/Sx, + 2% CaCl₂ circulate cement to surface.
3. Drill 7 7/8" hole to 7500'. Run and set 7500' of 5 1/2" casing as follows: 5000' of 5 1/2" 17# J-55 LT&C, 5000' of 5 1/2" 15.5# J-55 LT&C, 1000' of 5 1/2" 17# J-55 LT&C. Cement in 3 stages with DV tools at 5000'±, 3000'±. Cement 1st stage with 650 Sx. of Class "C" + additives, 2nd stage cement with 600 Sx. of Class "C" + additives, circulate cement to surface.

Permit Expires 1 Year From Approval
 Date Unless Drilling Underway

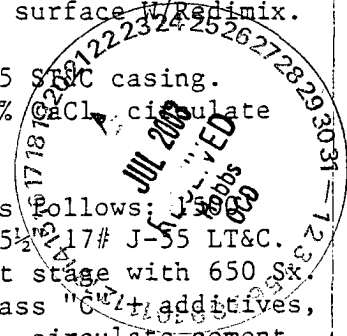

I hereby certify that the information given above is true and complete to the best of my knowledge and belief.

Signature: *Joe T. Janica*
 Printed name: Joe T. Janica
 Title: Agent
 Date: 07/18/03
 Phone: 505-391-8503

OIL CONSERVATION DIVISION

Approved by: *[Signature]*
 Title: PETROLEUM ENGINEER
 Approval Date: JUL 21 2003
 Expiration Date:
 Conditions of Approval:
 Attached

K2

DISTRICT I
P.O. Box 1880, Hobbs, NM 88241-1880

DISTRICT II
P.O. Drawer DD, Artesia, NM 88211-0718

DISTRICT III
1000 Rio Brazos Rd., Aztec, NM 87410

DISTRICT IV
P.O. BOX 2088, SANTA FE, N.M. 87504-2088

State of New Mexico

Energy, Minerals and Natural Resources Department

OIL CONSERVATION DIVISION

P.O. Box 2088
Santa Fe, New Mexico 87504-2088

Form C-102

Revised February 10, 1994

Submit to Appropriate District Office

State Lease - 4 Copies

Fee Lease - 3 Copies

WELL LOCATION AND ACREAGE DEDICATION PLAT

AMENDED REPORT

API Number 30-025-36331	Pool Code 96764	Pool Name MONUMENT ABO-SOUTHEAST
Property Code 14896	Property Name BERTIE WHITMIRE	Well Number 11
OGRID No. 962	Operator Name ARCH PETROLEUM, INC.	Elevation 3549'

Surface Location

UL or lot No.	Section	Township	Range	Lot Idn	Feet from the	North/South line	Feet from the	East/West line	County
B	8	20-S	37-E		660	NORTH	1650	EAST	LEA

Bottom Hole Location If Different From Surface

UL or lot No.	Section	Township	Range	Lot Idn	Feet from the	North/South line	Feet from the	East/West line	County

Dedicated Acres 80 40	Joint or Infill	Consolidation Code	Order No.
---------------------------------	-----------------	--------------------	-----------

NO ALLOWABLE WILL BE ASSIGNED TO THIS COMPLETION UNTIL ALL INTERESTS HAVE BEEN CONSOLIDATED OR A NON-STANDARD UNIT HAS BEEN APPROVED BY THE DIVISION

<p>GEODETTIC COORDINATES NAD 27 NME Y = 581099.1 X = 827525.8 LAT. 32°35'34.96\"N LONG. 103°16'11.66\"W</p>	<p>OPERATOR CERTIFICATION</p> <p>I hereby certify the the information contained herein is true and complete to the best of my knowledge and belief.</p> <p><i>Joe T. Janica</i> Signature</p> <p>Joe T. Janica Printed Name</p> <p>Agent Title</p> <p>07/18/03 Date</p>
	<p>SURVEYOR CERTIFICATION</p> <p>I hereby certify that the well location shown on this plat was plotted from field notes of actual surveys made by me or under my supervision, and that the same is true and correct to the best of my belief.</p> <p>JULY 15, 2003 Date Surveyed</p> <p><i>Ronald J. Eidson</i> Signature</p> <p>Seal of Professional Surveyor</p>
	<p>RONALD J. EIDSON 3239 GARY EIDSON 12641 Certificate No.</p>
	<p>Seal of Professional Surveyor</p>

LOCATION VERIFICATION MAP

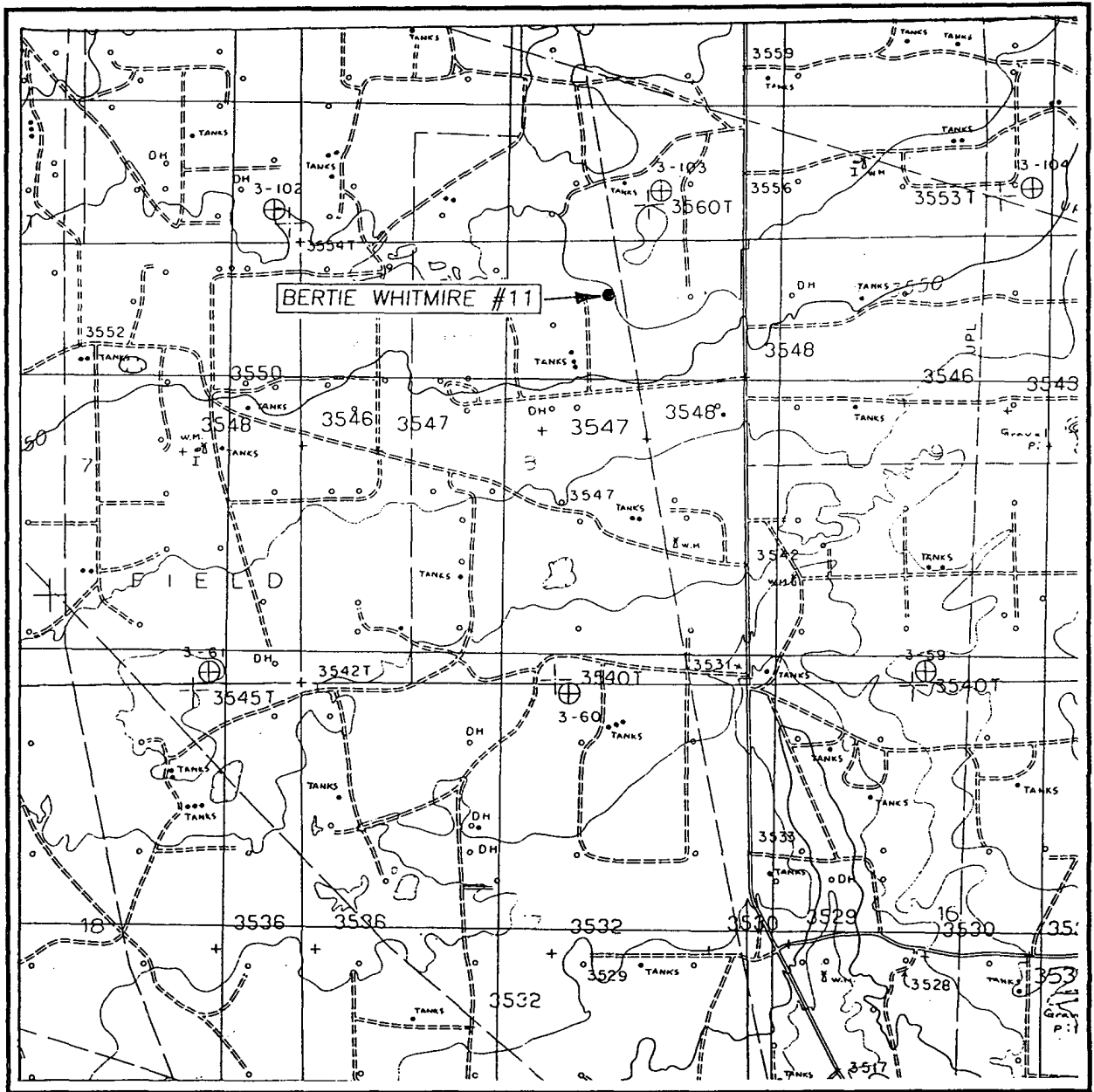

SCALE: 1" = 2000'

CONTOUR INTERVAL: 10'
MONUMENT SOUTH, N.M.

SEC. 8 TWP. 20-S RGE. 37-E

SURVEY N.M.P.M.

COUNTY LEA

DESCRIPTION 660' FNL & 1650' FEL

ELEVATION 3549'

OPERATOR ARCH PETROLEUM

LEASE BERTIE WHITMIRE

U.S.G.S. TOPOGRAPHIC MAP
MONUMENT SOUTH, N.M.

JOHN WEST SURVEYING
HOBBS, NEW MEXICO
(505) 393-3117

VICINITY MAP

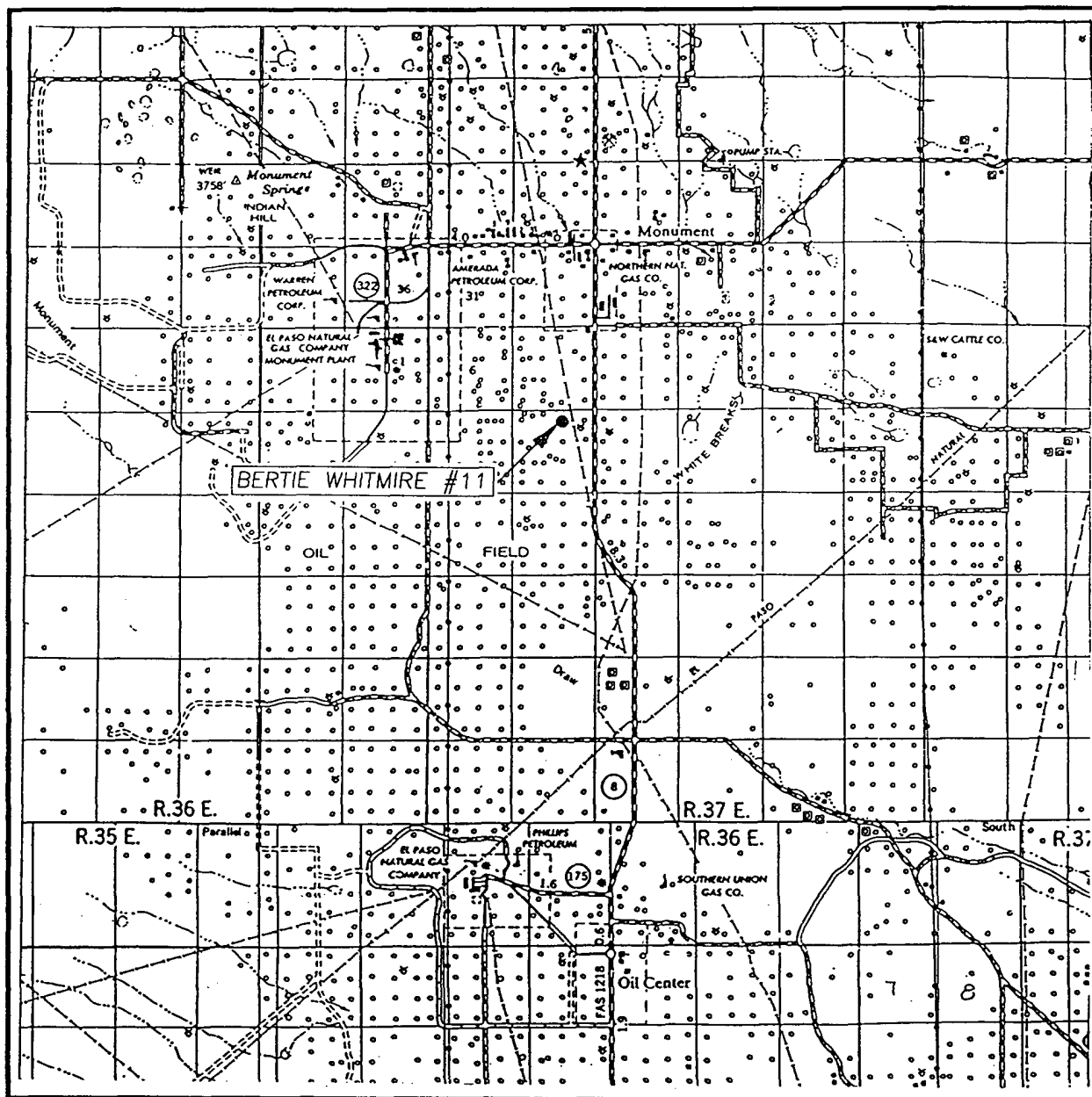

SCALE: 1" = 2 MILES

SEC. 8 TWP. 20-S RGE. 37-E
 SURVEY N.M.P.M.
 COUNTY LEA
 DESCRIPTION 660' FNL & 1650' FEL
 ELEVATION 3549'
 OPERATOR ARCH PETROLEUM
 LEASE BERTIE WHITMIRE

JOHN WEST SURVEYING
HOBBS, NEW MEXICO
(505) 393-3117

BLOWOUT PREVENTER SYSTEM

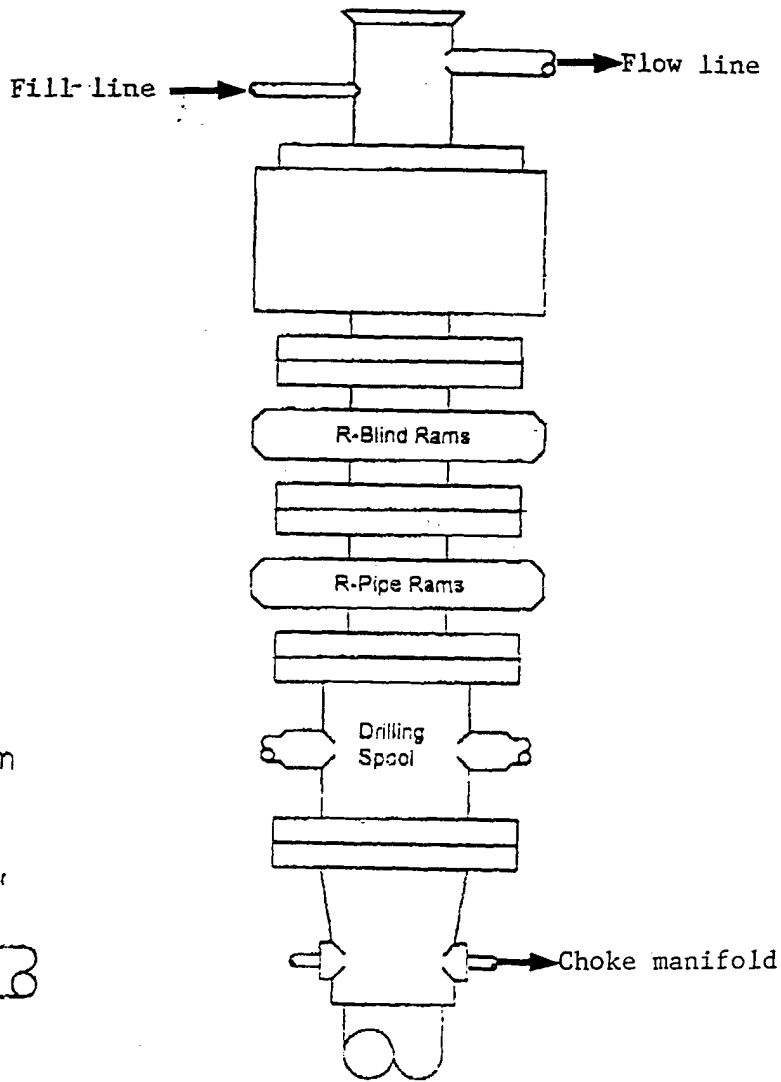

Type 900 Series
3000 psi WP

Choke Manifold Assembly for 3M WP System

