

District I
1625 N. French Dr., Hobbs, NM 88240
Phone: (575) 393-6161 Fax: (575) 393-0720
District II
811 S. First St., Artesia, NM 88210
Phone: (575) 748-1283 Fax: (575) 748-9720
District III
1000 Rio Brazos Road, Aztec, NM 87410
Phone: (505) 334-6178 Fax: (505) 334-6170
District IV
1220 S. St. Francis Dr., Santa Fe, NM 87505
Phone: (505) 476-3460 Fax: (505) 476-3462

State of New Mexico
Energy, Minerals & Natural Resources Department
OIL CONSERVATION DIVISION
1220 South St. Francis Dr.
Santa Fe, NM 87505

Form C-102
Revised August 1, 2011
Submit one copy to appropriate
District Office
☐ AMENDED REPORT

HOBBS OCD
FEB 29 2016

WELL LOCATION AND ACREAGE DEDICATION PLAT

1 API Number 30-025-		2 Pool Code 97838		3 Pool Name Jennings; Upper BOVE SPRING, Shale	
4 Property Code 316011		5 Property Name SD WE 23 FED P7		6 Well Number 3H	
7 GRID No. 4323		8 Operator Name CHEVRON U.S.A. INC.		9 Elevation 3165'	

10 Surface Location

UL or lot no.	Section	Township	Range	Lot Idn	Feet from the	North/South line	Feet from the	East/West line	County
P	14	26 SOUTH	32 EAST, N.M.P.M.		215'	SOUTH	673'	EAST	LEA

11 Bottom Hole Location If Different From Surface

UL or lot no.	Section	Township	Range	Lot Idn	Feet from the	North/South line	Feet from the	East/West line	County
P	23	26 SOUTH	32 EAST, N.M.P.M.		180'	SOUTH	990'	EAST	LEA

12 Dedicated Acres 160	13 Joint or Infill	14 Consolidation Code	15 Order No.
---------------------------	--------------------	-----------------------	--------------

No allowable will be assigned to this completion until all interests have been consolidated or a non-standard unit has been approved by the division.

<p>SD WE 23 FED P7 3H WELL</p> <p>X= 715.248 NAD 27 Y= 377.548 LAT. 32.036092 LONG. 103.638709</p> <p>X= 756.435 NAD83 Y= 377.605 LAT. 32.036217 LONG. 103.639178</p> <p>ELEVATION +3165' NAVD 88</p>	<p>PROPOSED BOTTOM HOLE LOCATION</p> <p>X= 714.953 NAD 27 Y= 372.153 LAT. 32.021265 LONG. 103.639772</p> <p>X= 756.140 NAD83 Y= 372.210 LAT. 32.021390 LONG. 103.640241</p>	<p>CORNER COORDINATES TABLE (NAD 27)</p> <p>A - Y=378663.24, X=714583.23 B - Y=378673.21, X=715914.07 C - Y=377328.02, X=714590.12 D - Y=377338.54, X=715922.04 E - Y=371970.41, X=714615.34 F - Y=371978.70, X=715943.63</p>		<p>17 OPERATOR CERTIFICATION</p> <p>I hereby certify that the information contained herein is true and complete to the best of my knowledge and belief, and that this organization either owns a working interest or undivided mineral interest in the land including the proposed bottom hole location or has a right to drill this well at this location pursuant to a contract with an owner of such a mineral or working interest, or to a voluntary pooling agreement or a compulsory pooling order heretofore entered by the division.</p> <p>Signature: <u>Cindy Herrera-Murillo</u> Date: <u>07-3-15</u> Printed Name: <u>Cindy Herrera-Murillo</u> E-mail Address: <u>Cherreramurillo@chevron.com</u></p> <p>18 SURVEYOR CERTIFICATION</p> <p>I hereby certify that the well location shown on this plat was plotted from field notes of actual surveys made by me or under my supervision, and that the same is true and correct to the best of my belief.</p> <p>Date of Survey: <u>3.24.15</u> Signature and Seal of Professional Surveyor: <u>[Signature]</u> Certificate Number: <u>#15078</u></p> <p>WM. J. DANIEL III NEW MEXICO REGISTERED PROFESSIONAL SURVEYOR 19078</p>
---	---	---	--	---

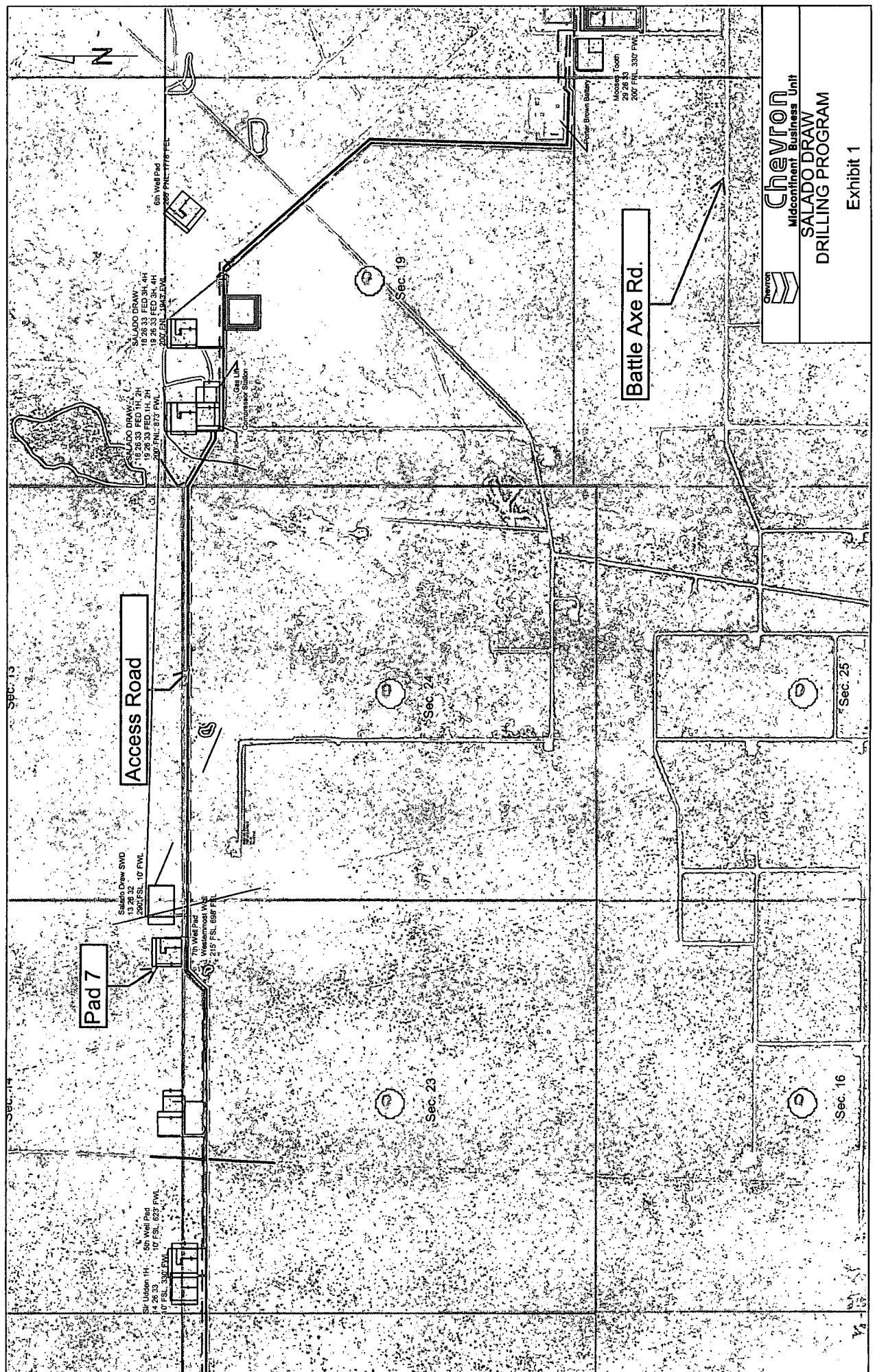

Exhibit 2

NOTE:

Please be advised, that while reasonable efforts are made to locate and verify pipelines and anomalies using our standard pipeline locating equipment, it is impossible to be 100 % effective. As such, we advise using caution when performing work as there is a possibility that pipelines and other hazards, such as fiber optic cables, PVC pipelines, etc. may exist undetected on site.

NOTE:

Many states maintain information centers that establish links between those who dig (excavators) and those who own and operate underground facilities (operators). It is advisable and in most states, law, for the contractor to contact the center for assistance in locating and marking underground utilities. For guidance: New Mexico One Call - www.nmonecall.org

DISCLAIMER: At this time, C.H. Fenstermaker & Associates, LLC has not performed nor was asked to perform any type of engineering, hydrological modeling, flood plain, or "No Rise" certification analyses, including but not limited to determining whether the project will impact flood hazards in connection with federal/FEMA, state, and/or local laws, ordinances and regulations. Accordingly, Fenstermaker makes no warranty or representation of any kind as to the foregoing issues, and persons or entities using this information shall do so at their own risk.

SD WE 14 FED P7 3H WELL	SD WE 23 FED P7 3H WELL	SD WE 14 FED P7 4H WELL	SD WE 23 FED P7 4H WELL
X= 715,223 NAD 27	X= 715,248 NAD 27	X= 715,273 NAD 27	X= 715,298 NAD 27
Y= 377,548	Y= 377,548	Y= 377,548	Y= 377,549
LAT. 32.036092	LAT. 32.036092	LAT. 32.036092	LAT. 32.036092
LONG 103.638790	LONG. 103.638709	LONG. 103.638628	LONG. 103.638548
X= 756,410 NAD83	X= 756,435 NAD83	X= 756,460 NAD83	X= 756,485 NAD83
Y= 377,605	Y= 377,605	Y= 377,606	Y= 377,606
LAT. 32.036217	LAT. 32.036217	LAT. 32.036217	LAT. 32.036217
LONG 103.639259	LONG. 103.639178	LONG. 103.639098	LONG. 103.639017
ELEVATION +3165' NAVD 88	ELEVATION +3165' NAVD 88	ELEVATION +3165' NAVD 88	ELEVATION +3165' NAVD 88

R 32 E

Sec. 14

Bureau of Land Management

T
26
S

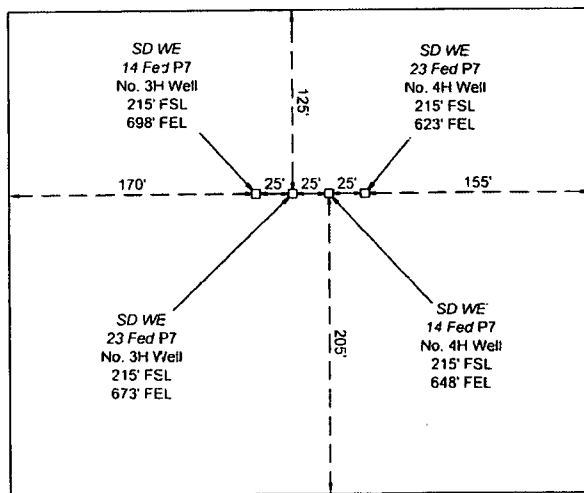

Sec. 23

Bureau of Land Management

FOR THE EXCLUSIVE USE OF:
CHEVRON U.S.A. INC.
I, WM. J. Daniel III, Registered Professional
Land Surveyor, do hereby state this plat is true
and correct to the best of my knowledge.

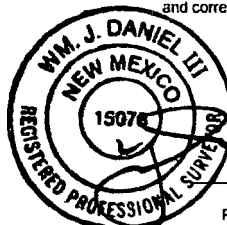

WM. J. Daniel III
Registration No. 15078

DEVELOPMENT PAD DETAIL

SCALE: 1"=100'

100' 0 50' 100'

CHEVRON U.S.A. INC.
PROPOSED DEVELOPMENT PAD
SD WE 14 & 23 FED P7 3H & 4H WELLS
SECTION 14, T26S-R32E
LEA COUNTY, NEW MEXICO



135 Regency Sq. Lafayette, LA 70508
Ph. 337-237-2200 Fax. 337-232-3299
www.fenstermaker.com

DRAWN BY: VHV		REVISIONS	
PROJ. MGR.: VHV	No.	DATE:	REVISED BY:
DATE: 04/14/2015	No.	DATE:	REVISED BY:
FILENAME: T:\2014\2146735\DWG\SD WE 14 & 23 Fed P7 3H-4H_PadDetail.dwg			

SD WE 23 FED P7 3H
TWN 26S - RNG 32E - SEC 14 and SEC 23
LEA, CO NM
Surface and Bottom Hole Locations – 1 Mile Radius

Exhibit 3

