

District I  
1625 N. French Dr., Hobbs, NM 88240  
Phone: (575) 393-6161 Fax: (575) 393-0720  
District II  
811 S. First St., Artesia, NM 88210  
Phone: (575) 748-1283 Fax: (575) 748-9720  
District III  
1000 Rio Brazos Road, Aztec, NM 87410  
Phone: (505) 334-6178 Fax: (505) 334-6170  
District IV  
1220 S. St. Francis Dr., Santa Fe, NM 87505  
Phone: (505) 476-3460 Fax: (505) 476-3462

State of New Mexico  
Energy, Minerals & Natural Resources Department  
OIL CONSERVATION DIVISION  
1220 South St. Francis Dr.  
Santa Fe, NM 87505

Form C-102  
Revised August 1, 2011  
Submit one copy to appropriate  
District Office

FEB 29 2016

☐ AMENDED REPORT

WELL LOCATION AND ACREAGE DEDICATION PLAT

<sup>1</sup> API Number 30025-	<sup>2</sup> Pool Code 97838	<sup>3</sup> Pool Name Jennings; Upper Bone Spring, Shale
<sup>4</sup> Property Code 316011	<sup>5</sup> Property Name SD WE 23 FED P7	<sup>6</sup> Well Number 4H
<sup>7</sup> OGRID No. 4323	<sup>8</sup> Operator Name CHEVRON U.S.A. INC.	<sup>9</sup> Elevation 3165'

10 Surface Location									
UL or lot no.	Section	Township	Range	Lot Idn	Feet from the	North/South line	Feet from the	East/West line	County
P	14	26 SOUTH	32 EAST, N.M.P.M.		215'	SOUTH	623'	EAST	LEA

11 Bottom Hole Location If Different From Surface									
UL or lot no.	Section	Township	Range	Lot Idn	Feet from the	North/South line	Feet from the	East/West line	County
P	23	26 SOUTH	32 EAST, N.M.P.M.		180'	SOUTH	330'	EAST	LEA

<sup>12</sup> Dedicated Acres 160	<sup>13</sup> Joint or Infill	<sup>14</sup> Consolidation Code	<sup>15</sup> Order No.
--------------------------------------	-------------------------------	----------------------------------	-------------------------

No allowable will be assigned to this completion until all interests have been consolidated or a non-standard unit has been approved by the division.

<p>SD WE 23 FED P7 4H WELL</p> <p>X= 715,298 NAD 27 Y= 377,549 LAT. 32.036092 LONG. 103.638548</p> <p>X= 756,485 NAD83 Y= 377,606 LAT. 32.036217 LONG. 103.639017</p> <p>ELEVATION +3165' NAVD 88</p>	<p>PROPOSED BOTTOM HOLE LOCATION</p> <p>X= 715,513 NAD 27 Y= 372,157 LAT. 32.021265 LONG. 103.637643</p> <p>X= 756,800 NAD83 Y= 372,214 LAT. 32.021390 LONG. 103.638111</p>	<p>CORNER COORDINATES TABLE (NAD 27)</p>	<p>A - Y=378663.24, X=714583.23 B - Y=378673.21, X=715914.07 C - Y=377328.02, X=714590.12 D - Y=377338.54, X=715922.04 E - Y=371970.41, X=714615.34 F - Y=371978.70, X=715943.63</p>		<p><b>17 OPERATOR CERTIFICATION</b></p> <p>I hereby certify that the information contained herein is true and complete to the best of my knowledge and belief, and that this organization either owns a working interest or unleased mineral interest in the land including the proposed bottom hole location or has a right to drill this well at this location pursuant to a contract with an owner of such a mineral or working interest, or to a voluntary pooling agreement or a compulsory pooling order heretofore entered by the division.</p> <p>Signature: <u>Cindy Herrera-Murillo</u> Date: <u>7-31-15</u> Printed Name: <u>Cindy Herrera-Murillo</u> E-mail Address: <u>CherreraMurillo@chevron.com</u></p>	<p><b>18 SURVEYOR CERTIFICATION</b></p> <p>I hereby certify that the well location shown on this plat was plotted from field notes of actual surveys made by me or under my supervision, and that the same is true and correct to the best of my belief.</p> <p>Date of Survey: <u>3.24.15</u> Signature and Seal of Professional Surveyor: <u>[Signature]</u> Certificate Number: <u>#15078</u></p> <p>WM. J. DANIEL III NEW MEXICO REGISTERED PROFESSIONAL SURVEYOR 15078</p>
---	---	--	--	--	--	---

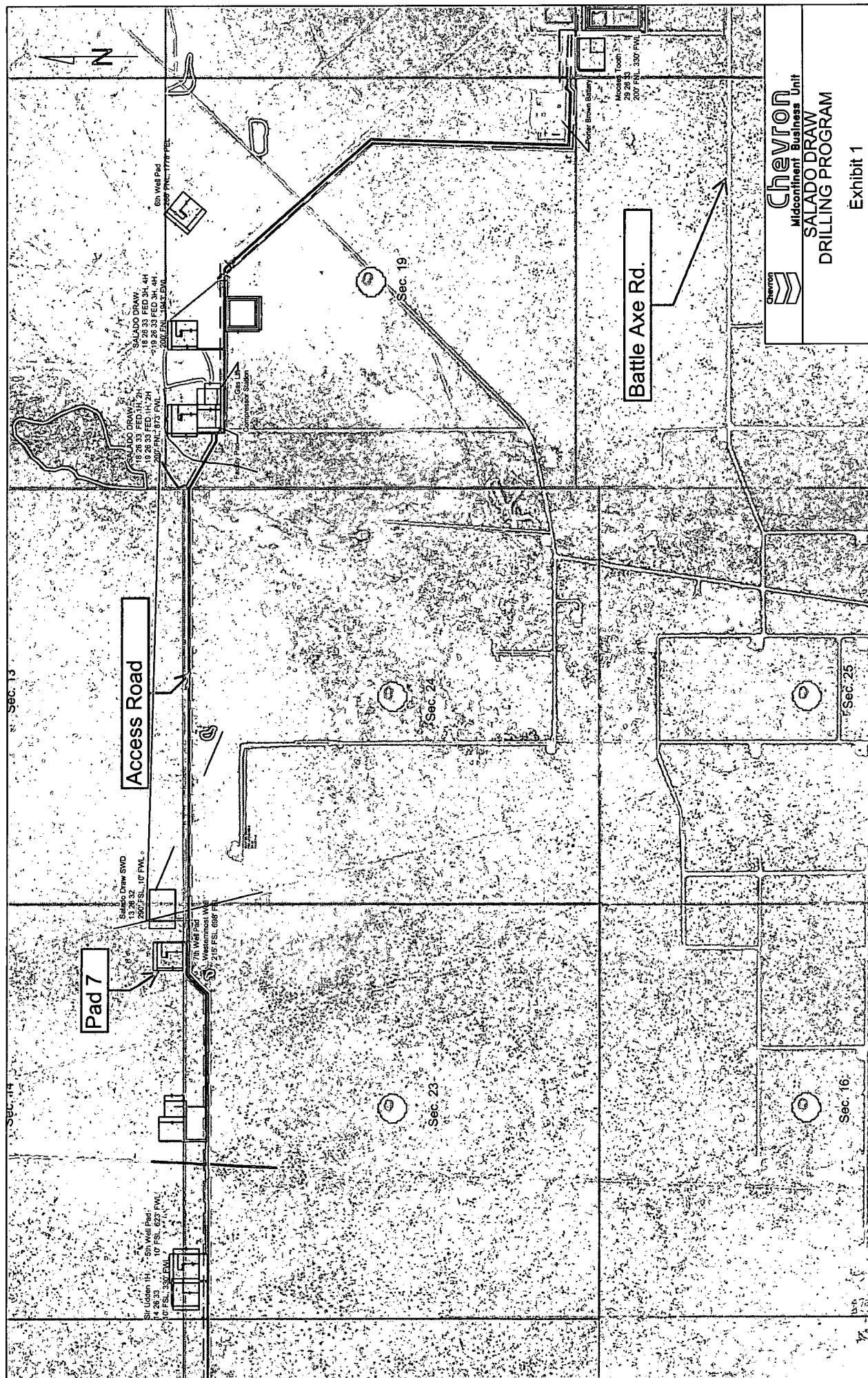

# Exhibit 2

## NOTE:

Please be advised, that while reasonable efforts are made to locate and verify pipelines and anomalies using our standard pipeline locating equipment, it is impossible to be 100 % effective. As such, we advise using caution when performing work as there is a possibility that pipelines and other hazards, such as fiber optic cables, PVC pipelines, etc. may exist undetected on site.

## NOTE:

Many states maintain information centers that establish links between those who dig (excavators) and those who own and operate underground facilities (operators). It is advisable and in most states, law, for the contractor to contact the center for assistance in locating and marking underground utilities. For guidance: New Mexico One Call - [www.nmonocall.org](http://www.nmonocall.org)

DISCLAIMER: At this time, C.H. Fenstermaker & Associates, LLC has not performed nor was asked to perform any type of engineering, hydrological modeling, flood plain, or "No Rise" certification analyses, including but not limited to determining whether the project will impact flood hazards in connection with federal/FEMA, state, and/or local laws, ordinances and regulations. Accordingly, Fenstermaker makes no warranty or representation of any kind as to the foregoing issues, and persons or entities using this information shall do so at their own risk.

SD WE 14 FED P7 3H WELL	SD WE 23 FED P7 3H WELL	SD WE 14 FED P7 4H WELL	SD WE 23 FED P7 4H WELL
X= 715,223 NAD 27	X= 715,248 NAD 27	X= 715,273 NAD 27	X= 715,298 NAD 27
Y= 377,548	Y= 377,548	Y= 377,548	Y= 377,549
LAT. 32.036092	LAT. 32.036092	LAT. 32.036092	LAT. 32.036092
LONG. 103.638790	LONG. 103.638709	LONG. 103.638628	LONG. 103.638548
X= 756,410 NAD83	X= 756,435 NAD83	X= 756,460 NAD83	X= 756,485 NAD83
Y= 377,605	Y= 377,605	Y= 377,606	Y= 377,606
LAT. 32.036217	LAT. 32.036217	LAT. 32.036217	LAT. 32.036217
LONG. 103.639259	LONG. 103.639178	LONG. 103.639098	LONG. 103.639017
ELEVATION +3165' NAVD 88	ELEVATION +3165' NAVD 88	ELEVATION +3165' NAVD 88	ELEVATION +3165' NAVD 88

## R 32 E

### Sec. 14

Bureau of Land Management

T  
26  
S

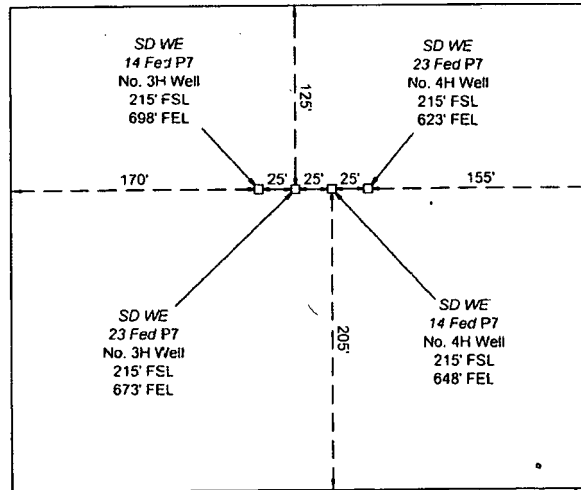

### Sec. 23

Bureau of Land Management

FOR THE EXCLUSIVE USE OF  
CHEVRON U.S.A. INC.  
I, WM. J. DANIEL III, Registered Professional  
Land Surveyor, do hereby state this plat is true  
and correct to the best of my knowledge.

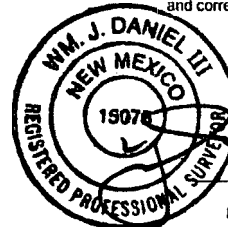

WM. J. Daniel III  
Registration No. 15078

DEVELOPMENT PAD DETAIL

SCALE: 1"=100'

100' 0 50' 100'

CHEVRON U.S.A. INC.  
PROPOSED DEVELOPMENT PAD  
SD WE 14 & 23 FED P7 3H & 4H WELLS  
SECTION 14, T26S-R32E  
LEA COUNTY, NEW MEXICO



135 Regency Sq. Lafayette, LA 70508  
Ph. 337-237-2200 Fax. 337-232-3299  
[www.fenstermaker.com](http://www.fenstermaker.com)

DRAWN BY: VHV		REVISIONS	
PROJ. MGR.: VHV	No.	DATE:	REVISED BY:
DATE: 04/14/2015	No.	DATE:	REVISED BY:
FILENAME: T:\2014\2146735\DWG\SD WE 14 & 23 Fed P7 3H-4H_PadDetail.dwg			

SD WE 23 FED P7 4H  
TWN 26S - RNG 32E - SEC 14 and SEC 23  
LEA, CO NM

Surface and Bottom Hole Locations – 1 Mile Radius

# Exhibit 3

