

PORTS CO

APR 04 2016

RECEIVED

# Plat for Closed Loop System

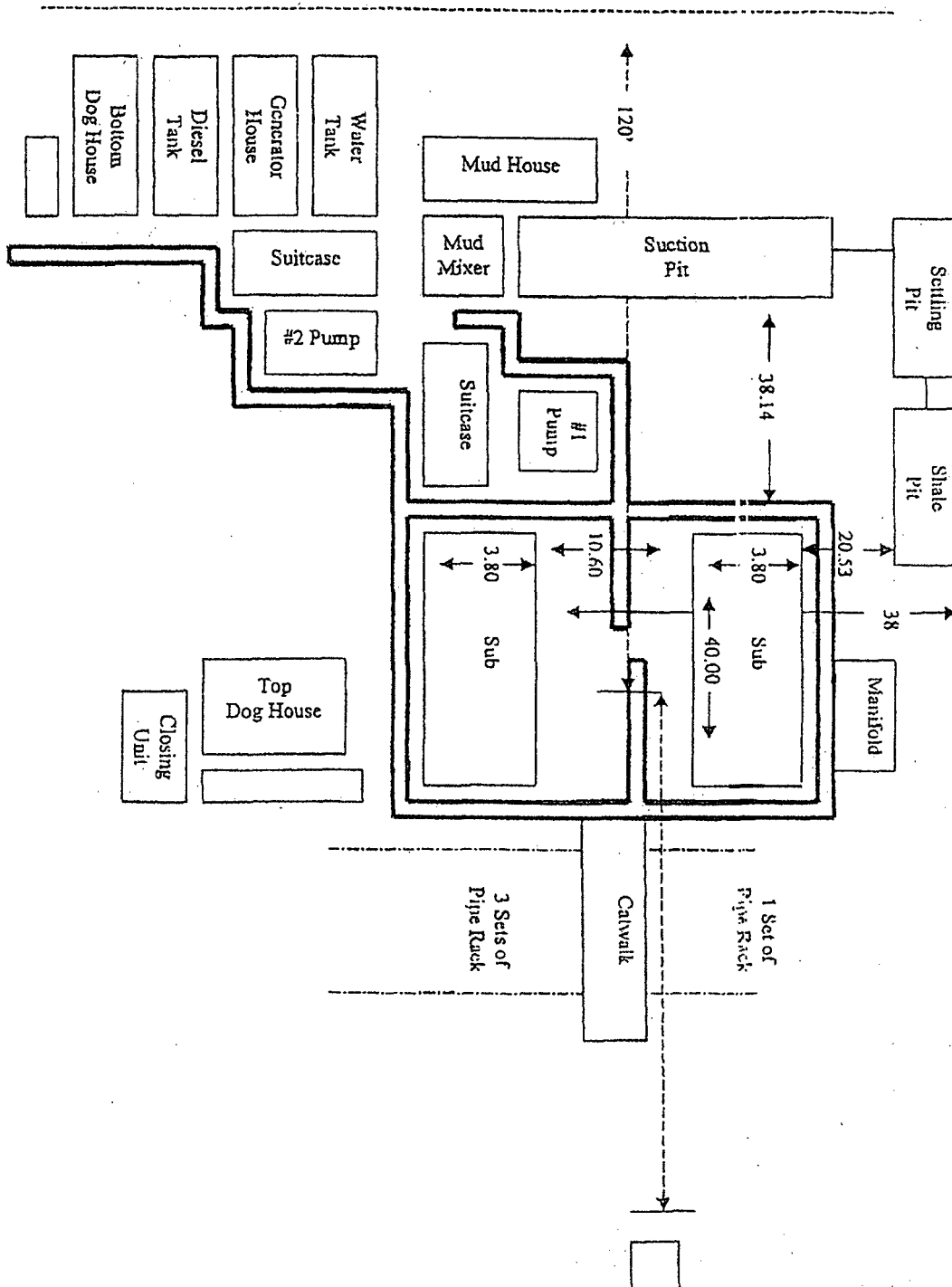

APR 14 2016

Note: Dimensional information reflected on this drawing are estimated measurements only.

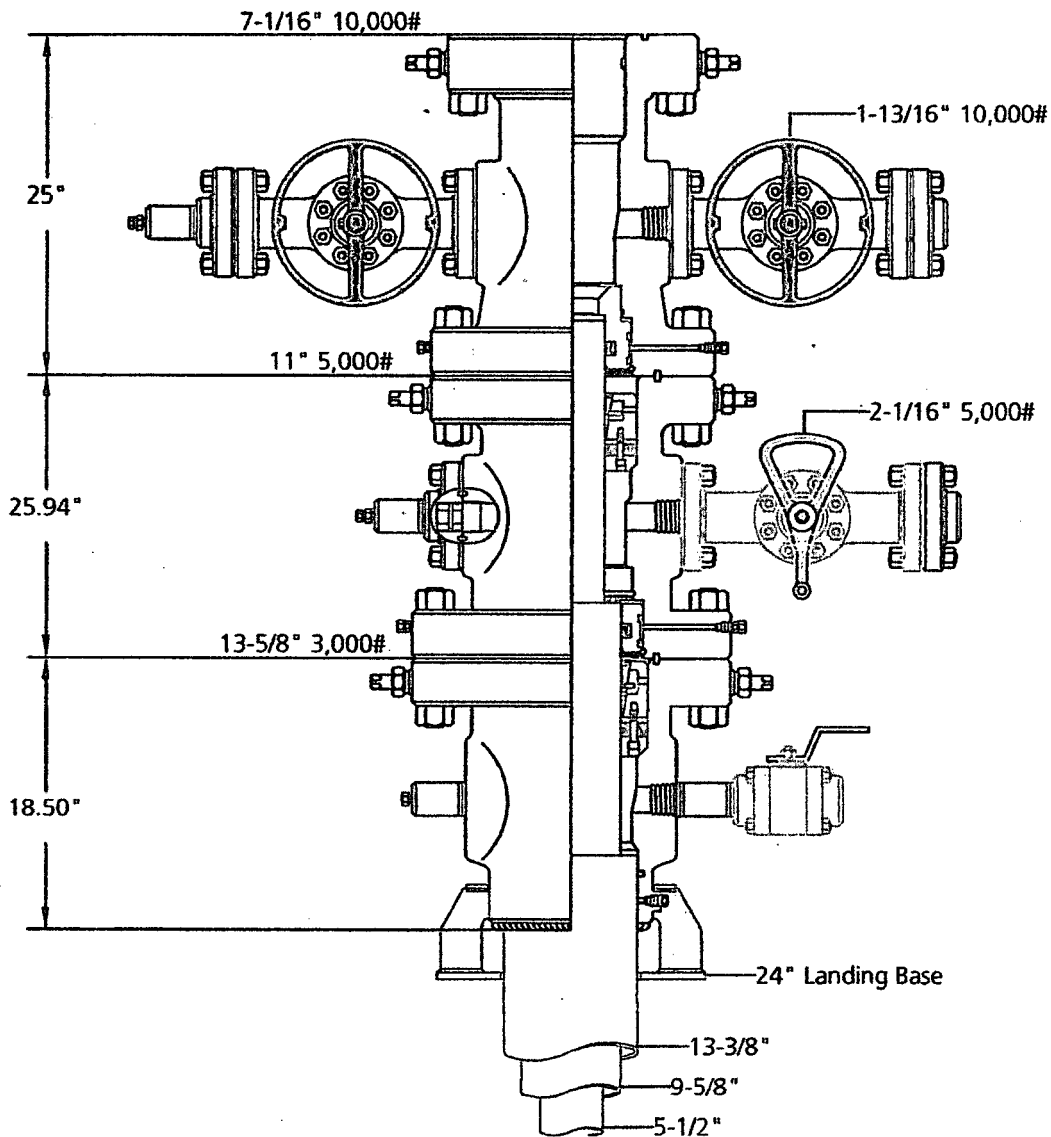

Legacy Reserves  
Conventional 3-String



Name: Jeanette	Date: 7-15-15	Working Pressure:	# 1274616
----------------	---------------	-------------------	-----------

# McVay Rig 4

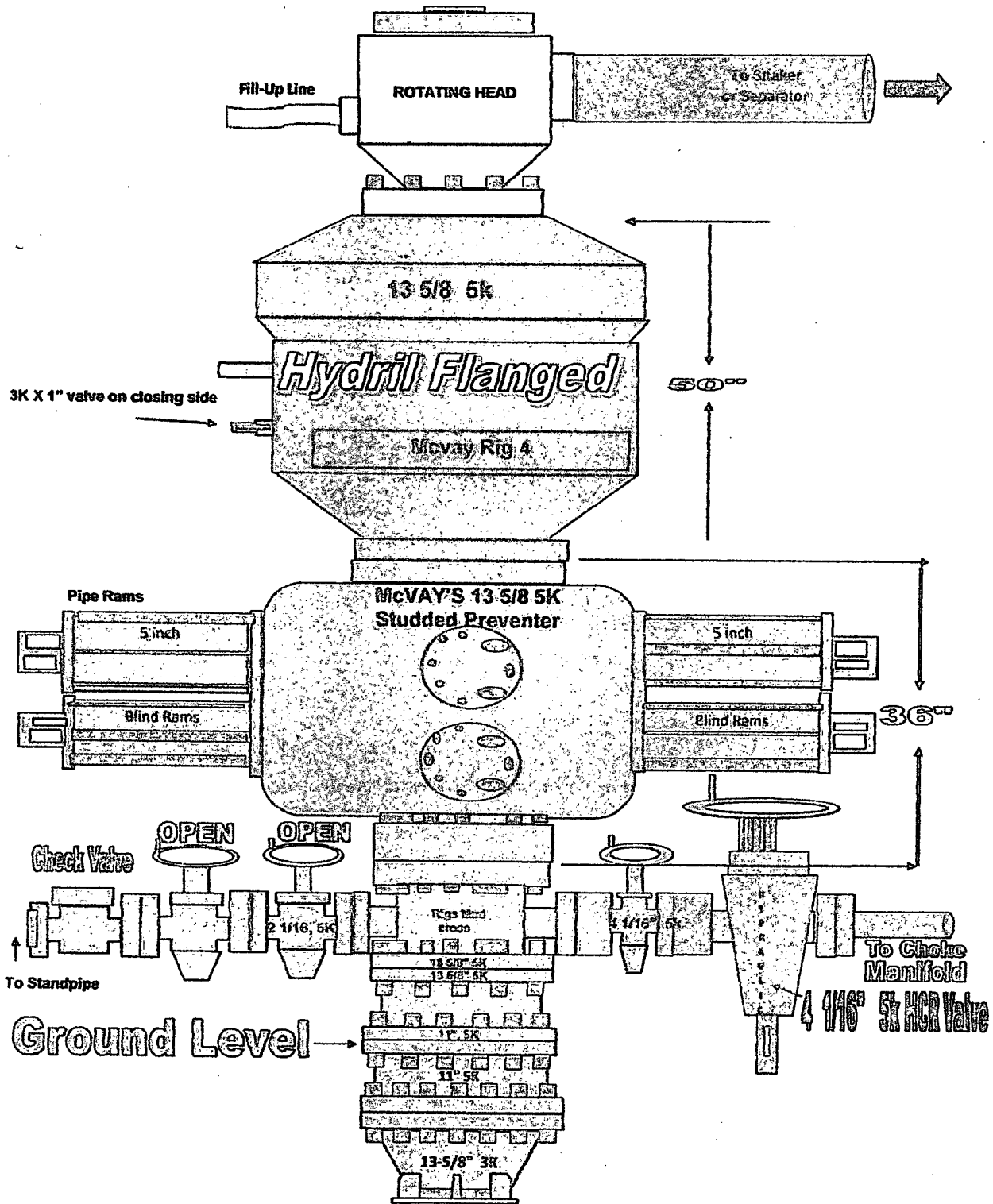

# McVay 4 Choke Manifold

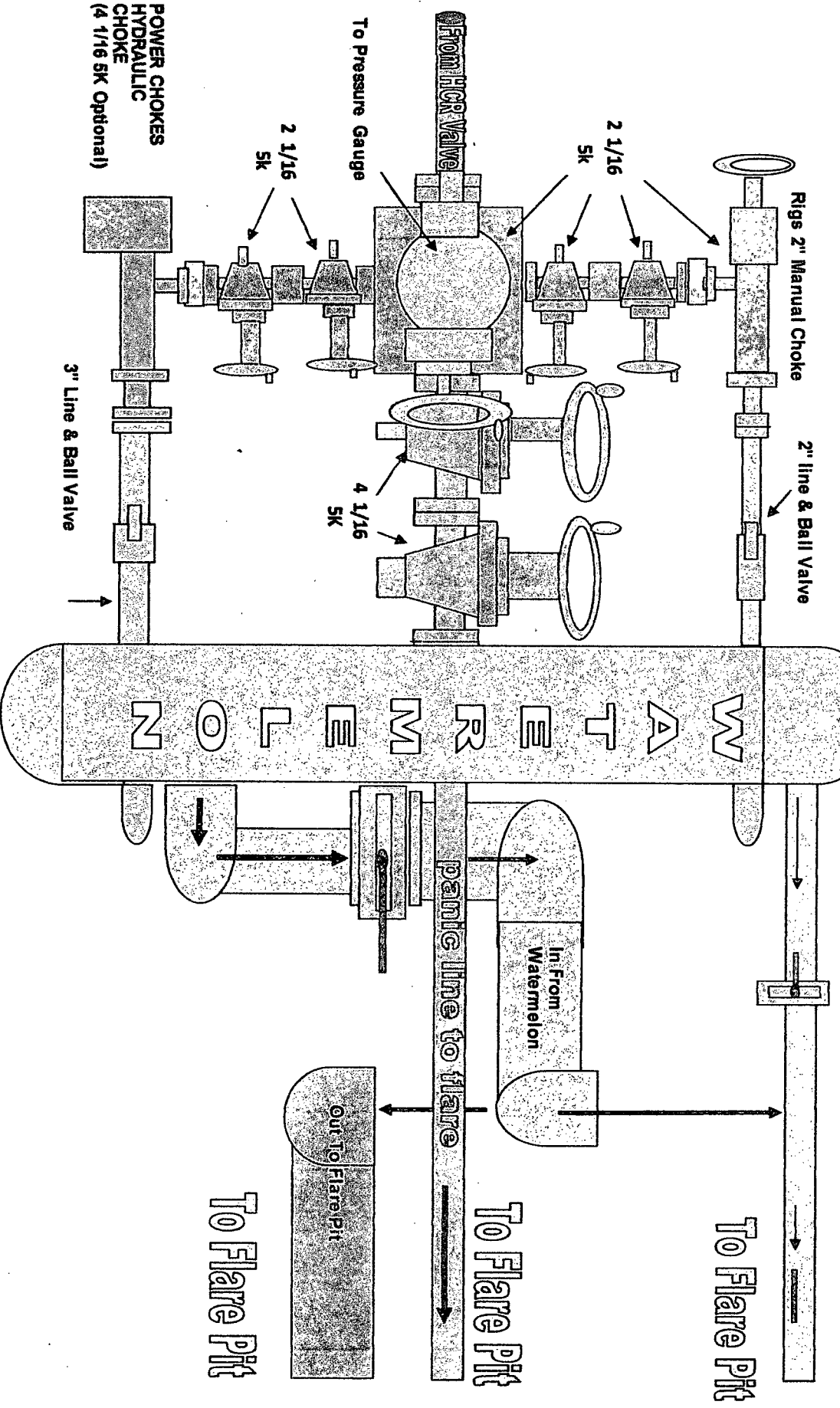

\*We use the same choke manifolds for all aspects of our operations & all are rated to 10K;

\* All connections downstream from BOP thru chokes Are Flanged. All connections downstream from chokes are Flanged .

**Design Plan, Operating & Maintenance Plan & Closure Plan for the OCD Form C-144**

**DESIGN PLAN:**

Fluid & cuttings coming from drilling operations will pass over the Shale Shaker with the cuttings going to the CRI haul off bin and the cleaned fluid returning to the working steel pits.

**Equipment includes:**

2-500 bbl steel tanks (fresh water for drilling)  
2-700 bbl steel working pits (1400 bbls total)  
2-20 cu yards steel haul off bins  
2-pumps (CE FB1300)  
2-shale shakers  
1-mud cleaner (if needed)  
1-centrifuge (if needed)

**OPERATING AND MAINTENANCE PLAN:**

Inspection to occur every tour for proper operation of system and individual components. If any problems are found they will be repaired and/or corrected immediately.

**CLOSURE PLAN:**

All haul bins containing cuttings will be removed from location and hauled to Controlled Recovery, Inc. (NM-01-0006) disposal site located near mile marker 66 on Highway 62/180.

  
Blain K. Lewis

Senior Operations Engineer

**EXHIBIT D**

**Rig Plat Only  
LEA UNIT 46H  
V-DOOR EAST**

NORTH

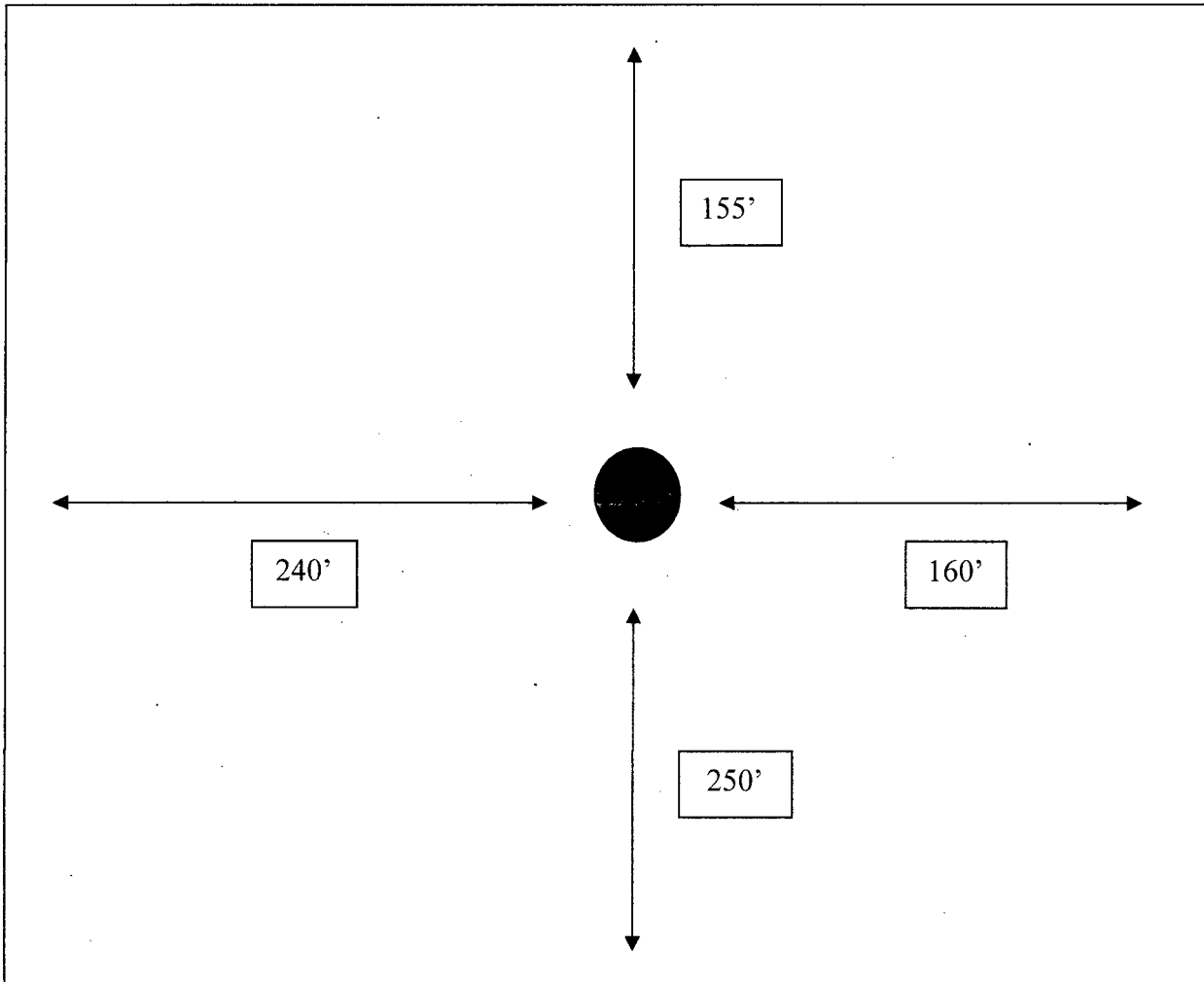

14'

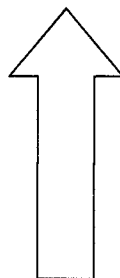

N  
O  
R  
T  
H