

HOBBS OCD

UNITED STATES **Carlsbad Field Office**  
DEPARTMENT OF THE INTERIOR  
BUREAU OF LAND MANAGEMENT **OCD Hobbs**FORM APPROVED  
OMB NO. 1004-0137  
Expires: January 31, 2018

DEC 27 2016

RECEIVED

**SUNDRY NOTICES AND REPORTS ON WELLS**  
Do not use this form for proposals to drill or to re-enter an abandoned well. Use form 3160-3 (APD) for such proposals.**SUBMIT IN TRIPLICATE - Other instructions on page 2**

5. Lease Serial No. NMNM15091
6. If Indian, Allottee or Tribe Name
7. If Unit or CA/Agreement, Name and/or No.
8. Well Name and No. ROJO AE 7811 JV-P FEDERAL COM 1H
9. API Well No. 30-025-43476-00-X1
10. Field and Pool or Exploratory Area RED HILLS
11. County or Parish, State LEA COUNTY, NM

1. Type of Well <input checked="" type="checkbox"/> Oil Well <input type="checkbox"/> Gas Well <input type="checkbox"/> Other	2. Name of Operator BTA OIL PRODUCERS /	Contact: PAM INSKEEP E-Mail: pinskeep@btaoil.com
3a. Address 104 SOUTH PECOS STREET MIDLAND, TX 79701	3b. Phone No. (include area code) Ph: 432.682.3753 Ext: 139 Fx: 432.683.0325	10. Field and Pool or Exploratory Area RED HILLS
4. Location of Well (Footage, Sec., T., R., M., or Survey Description) Sec 27 T25S R33E NWNW 190FNL 1050FWL 32.108139 N Lat, 103.564934 W Lon	11. County or Parish, State LEA COUNTY, NM	

**12. CHECK THE APPROPRIATE BOX(ES) TO INDICATE NATURE OF NOTICE, REPORT, OR OTHER DATA**

TYPE OF SUBMISSION	TYPE OF ACTION			
<input checked="" type="checkbox"/> Notice of Intent	<input type="checkbox"/> Acidize	<input type="checkbox"/> Deepen	<input type="checkbox"/> Production (Start/Resume)	<input type="checkbox"/> Water Shut-Off
<input type="checkbox"/> Subsequent Report	<input type="checkbox"/> Alter Casing	<input type="checkbox"/> Hydraulic Fracturing	<input type="checkbox"/> Reclamation	<input type="checkbox"/> Well Integrity
<input type="checkbox"/> Final Abandonment Notice	<input type="checkbox"/> Casing Repair	<input type="checkbox"/> New Construction	<input type="checkbox"/> Recomplete	<input checked="" type="checkbox"/> Other
	<input type="checkbox"/> Change Plans	<input type="checkbox"/> Plug and Abandon	<input type="checkbox"/> Temporarily Abandon	Change to Original A
	<input type="checkbox"/> Convert to Injection	<input type="checkbox"/> Plug Back	<input type="checkbox"/> Water Disposal	PD

13. Describe Proposed or Completed Operation: Clearly state all pertinent details, including estimated starting date of any proposed work and approximate duration thereof. If the proposal is to deepen directionally or recompleat horizontally, give subsurface locations and measured and true vertical depths of all pertinent markers and zones. Attach the Bond under which the work will be performed or provide the Bond No. on file with BLM/BIA. Required subsequent reports must be filed within 30 days following completion of the involved operations. If the operation results in a multiple completion or recompleat in a new interval, a Form 3160-4 must be filed once testing has been completed. Final Abandonment Notices must be filed only after all requirements, including reclamation, have been completed and the operator has determined that the site is ready for final inspection.

BTA proposes to amend the production facility (move from well pad to a Central Tank Battery [CTB]) and change the reclamation area for this well, from as it was originally approved in the APD.

BTA proposes an off-pad CTB to serve the #1H, and well as the #2H and #3H wells (#2H & #3H APD's are currently in the AFMSS system for processing and approval). Plat of the CTB is attached along with a plat of the well locations and CTB placement in relation to all wells.

BTA will propose a second well to be drilled, in the future, on the #1H pad. We would like to retain the pad, as is, until after the second well is drilled. We will then perform an interim reclamation, minimizing the well(s) pad as much as possible.

Communitization Agreements are in process for the #1H, #2H, & #3H wells. If needed, a commingling

14. I hereby certify that the foregoing is true and correct. <b>Electronic Submission #361579 verified by the BLM Well Information System</b> <b>For BTA OIL PRODUCERS, sent to the Carlsbad</b> <b>Committed to AFMSS for processing by DUNCAN WHITLOCK on 12/21/2016 (17DW0007SE)</b>	
Name (Printed/Typed) PAM INSKEEP	Title REGULATORY ADMINISTRATOR
Signature (Electronic Submission)	Date 12/20/2016

**THIS SPACE FOR FEDERAL OR STATE OFFICE USE**

Approved By <u>DUNCAN WHITLOCK</u>	Title <u>TECHNICAL LPET</u>	Date <u>12/21/2016</u>
Conditions of approval, if any, are attached. Approval of this notice does not warrant or certify that the applicant holds legal or equitable title to those rights in the subject lease which would entitle the applicant to conduct operations thereon.		Office <u>Carlsbad</u>

Title 18 U.S.C. Section 1001 and Title 43 U.S.C. Section 1212, make it a crime for any person knowingly and willfully to make to any department or agency of the United States any false, fictitious or fraudulent statements or representations as to any matter within its jurisdiction.

(Instructions on page 2)

**\*\* BLM REVISED \*\* BLM REVISED \*\* BLM REVISED \*\* BLM REVISED \*\* BLM REVISED \*\***

**Additional data for EC transaction #361579 that would not fit on the form**

**32. Additional remarks, continued**

agreement for these wells will be applied for.

SECTION 27, TOWNSHIP 25 SOUTH, RANGE 33 EAST, N.M.P.M.,

LEA COUNTY

NEW MEXICO

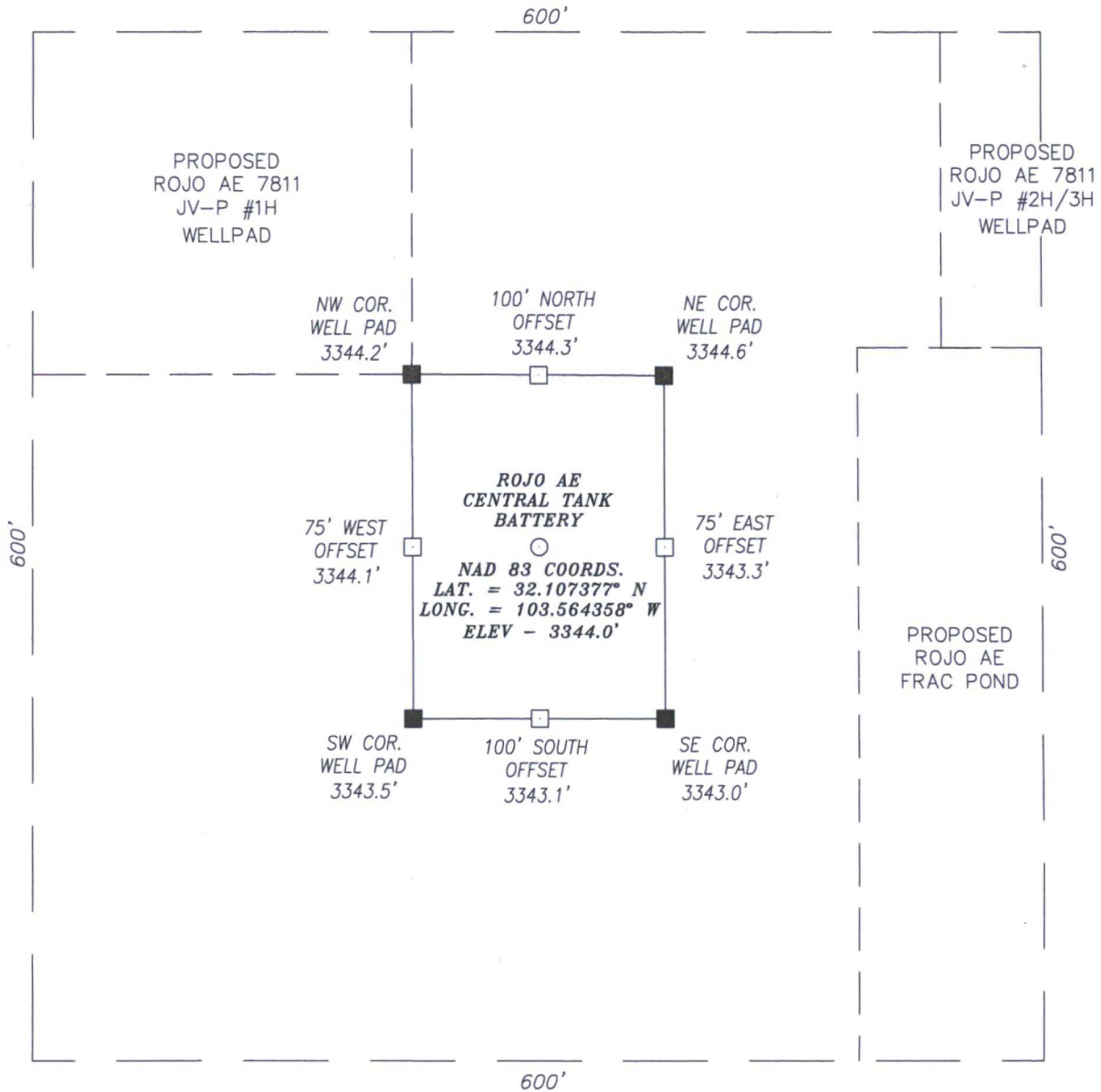

DIRECTIONS TO LOCATION

FROM THE INTERSECTION OF DINWIDDIE RD. AND BATTLE AXE RD. GO WEST APPROX. 1.1 MILES; THEN TURN RIGHT (NORTH) AND GO APPROX. 3.0 MILES TO A PROPOSED ROAD ON THE RIGHT. PROPOSED WELL IS APPROX. 1,083 FEET SOUTHEAST.

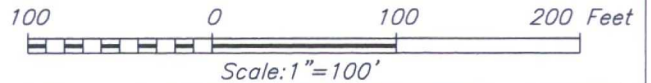

**HARCROW SURVEYING, LLC**  
2314 W. MAIN ST, ARTESIA, N.M. 88210  
PH: (575) 746-2158 FAX: (575) 746-2158  
c.harcrow@harcrowsurveying.com



**BTA OIL PRODUCERS, LLC**

ROJO AE CENTRAL TANK BATTERY  
LOCATED 513 FEET FROM THE NORTH LINE  
AND 1372 FEET FROM THE WEST LINE OF SECTION 27,  
TOWNSHIP 25 SOUTH, RANGE 33 EAST, N.M.P.M.,  
LEA COUNTY, NEW MEXICO

SURVEY DATE: OCT. 12, 2016	PAGE: 1 OF 1
DRAFTING DATE: OCT. 19, 2016	
APPROVED BY: CH	DRAWN BY: JR
	FILE: 16-815



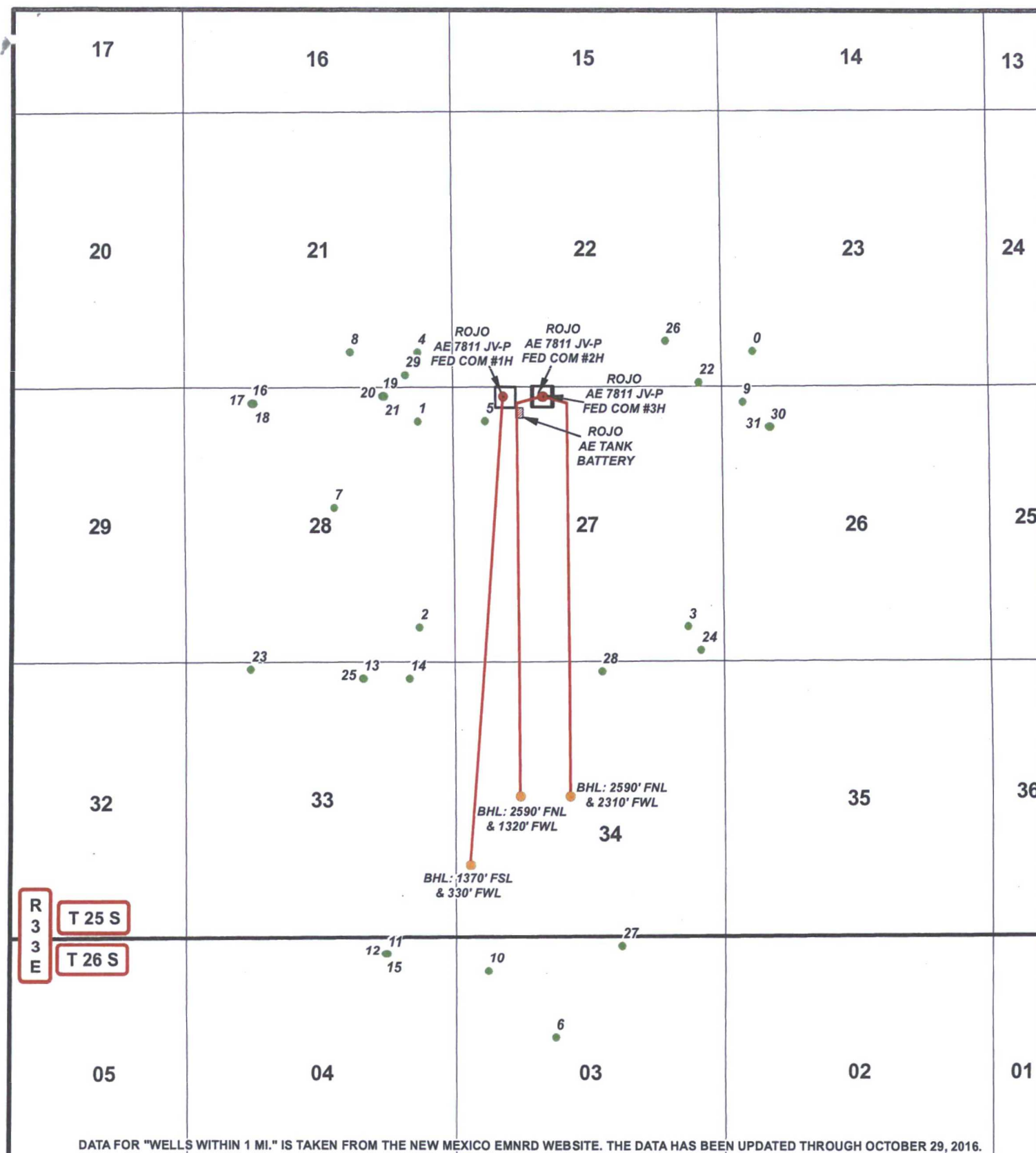

DATA FOR "WELLS WITHIN 1 MI." IS TAKEN FROM THE NEW MEXICO EMNRD WEBSITE. THE DATA HAS BEEN UPDATED THROUGH OCTOBER 29, 2016.

## LEGEND

- WELL
- BOTTOMHOLE
- WELLS WITHIN 1 MI.

## ROJO AE 7811 JV-P FEDERAL COM WELLS & CTB

SEC: 27

TWP: 25 S.

RGE: 33 E.

STATE: NEW MEXICO

COUNTY: LEA

LEASE: ROJO AE 7811 JV-P FED COM

SURVEY: N.M.P.M

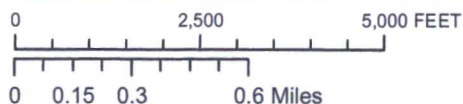

1 IN = 2,500 FT

OVERVIEW MAP

12/20/2016

C.H.



OIL PRODUCERS



HARCROW SURVEYING, LLC.  
2314 W. MAIN ST, ARTESIA, NM 88210  
PH: (575) 746-2158 FAX: (575) 746-2158  
c.harcrow@harcrowsurveying.com