

District I
1625 N. French Dr. Hobbs, NM 88249
Phone: (575) 393-0601 Fax: (575) 393-0720
District II
811 S. First St. Artesia, NM 88210
Phone: (575) 718-1283 Fax: (575) 748-0720
District III
1000 Rio Bravo Road, Aztec, NM 87410
Phone: (505) 334-6178 Fax: (505) 334-6176
District IV
1220 S. St. Francis Dr. Santa Fe, NM 87505
Phone: (505) 476-1460 Fax: (505) 476-1461

State of New Mexico
Energy, Minerals & Natural Resources Department
OIL CONSERVATION DIVISION
1220 South St. Francis Dr.
Santa Fe, NM 87505

Form C-102
Revised August 1, 2011
Submit one copy to appropriate
District Office

☐ AMENDED REPORT

WELL LOCATION AND ACREAGE DEDICATION PLAT

API Number 30-025-43461	Pool Code 97838	Pool Name Linnings Upper Bone Spring, Shale
Property Code 317446	Property Name SD WE 15 FLD P9	Well Number 6H
OCRID No 4323	Operator Name CHEVRON U.S.A. INC	Elevation 3157'

Surface Location

UL or lot no	Section	Township	Range	Lot Idn	Feet from the	North/South line	Feet from the	East/West line	County
O	15	26 SOUTH	32 EAST, N.M.P.M.		12'	SOUTH	1446'	EAST	LEA

Bottom Hole Location If Different From Surface

UL or lot no	Section	Township	Range	Lot Idn	Feet from the	North/South line	Feet from the	East/West line	County
B	15	26 SOUTH	32 EAST, N.M.P.M.		180'	NORTH	1662'	EAST	LEA

Dedicated Acres 160	Joint or In-It	Consolidation Code	Order No
-------------------------------	----------------	--------------------	----------

No allowable will be assigned to this completion until all interests have been consolidated or a non-standard unit has been approved by the division.

<p>PROPOSED BOTTOM HOLE LOCATION</p> <p>X= 708,918 NAD 27 Y= 382,450 LAT 32 049677 LONG 103 659036</p> <p>X= 750,105 NAD83 Y= 382,507 LAT 32 049802 LONG 103 659507</p>		<p>OPERATOR CERTIFICATION</p> <p>I hereby certify that the information contained herein is true and complete to the best of my knowledge and belief, and that this organization either owns a working interest or unleased mineral interest in the land including the proposed bottom hole location or has a right to drill this well at this location pursuant to a contract with an owner of such a mineral or working interest, or to a voluntary pooling agreement or a compulsory pooling order heretofore entered by the division.</p> <p><i>[Signature]</i> 1/27/2016 Signature Date</p> <p>DENISE PINKERTON Printed Name</p> <p><i>Leake@chevron.com</i> E-mail Address</p> <p>SURVEYOR CERTIFICATION</p> <p>I hereby certify that the well location shown on this plat was plotted from field notes of actual surveys made by me or under my supervision, and that the same is true and correct to the best of my belief.</p> <p>5-26-2016 Date of Survey</p> <p><i>[Signature]</i> Signature and Seal of Professional Surveyor</p> <p>23006 Certificate Number</p>
--------------------------------------------------------------------------------------------------------------------------------------------------------------------------------------------------------	--	---------------------------------------------------------------------------------------------------------------------------------------------------------------------------------------------------------------------------------------------------------------------------------------------------------------------------------------------------------------------------------------------------------------------------------------------------------------------------------------------------------------------------------------------------------------------------------------------------------------------------------------------------------------------------------------------------------------------------------------------------------------------------------------------------------------------------------------------------------------------------------------------------------------------------------------------------------------------------------------------------------------------------------------------------------------------------------------------------------------------------

LEGEND

- Section Line
- Centerline Access Road
- Existing Lease Road & Drillsite
- As-Drilled Well
- Fnd. Monument

R 32 E

Sec. 15

Bureau of Land Management

(±1.28 Acres-Pad)

FOR THE EXCLUSIVE USE OF
CHEVRON U.S.A. INC.
I, Robert L. Lastrapes, Professional
Surveyor, do hereby state this plat is true
and correct to the best of my knowledge.

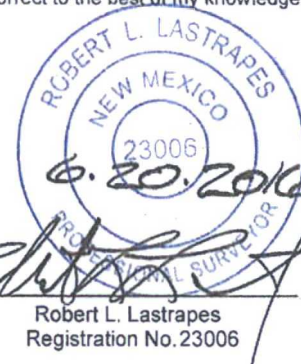

PROPOSED
ARCHAEOLOGICAL
AREA
±5.21 ACRES

T
26
S

PROPOSED PAD
±4.09 ACRES

SD WE 15 Fed P9
No. 6H Well
12' FSL
1446' FEL

Red Hills West 22 Fed Com
No. 1H Well
(As-Drilled)

Point of
Commencement/
Fnd. 1 1/2" Iron
Pipe w/Cap

Existing Lease Road

CENTERLINE
PROPOSED ACCESS ROAD

14' x ±61.18'
±0.02 ACRES
±3.71 Rods

Sec. 22

Bureau of Land Management

(±2.81 Acres-Pad)

SD WE 15 FED P9 NO. 6H WELL		
X=	709,149	NAD 27
Y=	377,296	
LAT.	32.035506	
LONG.	103.658395	
X=	750,336	NAD83
Y=	377,353	
LAT.	32.035631	
LONG.	103.658865	
ELEVATION +3157' NAVD 88		

NW ARCH. AREA CORNER		NE ARCH. AREA CORNER		SE ARCH. AREA CORNER		SW ARCH. AREA CORNER	
X=	708,822	NAD 27	X=	709,497	NAD 27	X=	708,827
Y=	377,593		Y=	377,599		Y=	376,993
NW PAD CORNER		NE PAD CORNER		SE PAD CORNER		SW PAD CORNER	
X=	708,913	NAD 27	X=	709,408	NAD 27	X=	708,916
Y=	377,394		Y=	377,399		Y=	377,034
ELEVATION +3157' NAVD 88		ELEVATION +3156' NAVD 88		ELEVATION +3157' NAVD 88		ELEVATION +3156' NAVD 88	

SURFACE USE PLAT

Scale: 1" = 200'

200' 0 100' 200'

CHEVRON U.S.A. INC.
PROPOSED PAD & ACCESS ROAD
SD WE 15 FED P9 NO. 6H WELL
SECTIONS 15 & 22, T26S-R32E
LEA COUNTY, NEW MEXICO

PAGE 1 OF 2



C. H. Fenstermaker & Associates, L.L.C.
135 Regency Sq. Lafayette, LA 70508
Ph 337-237-2200 Fax 337-232-3299
www.fenstermaker.com

DRAWN BY: KJD

REVISIONS

PROJ. MGR.: VHV

No. 1

DATE: 06/02/2016

REVISED BY: BOR

DATE: JUNE 23, 2015

No.

DATE:

REVISED BY:

FILENAME: T:\2015\2152220\DWG\SD WE 15 Fed P9 6H_SUP.dwg

DISCLAIMER: At this time, C. H. Fenstermaker & Associates, L.L.C. has not performed nor was asked to perform any type of engineering, hydrological modeling, flood plain, or "No Rise" certification analyses, including but not limited to determining whether the project will impact flood hazards in connection with federal/FEMA, state, and/or local laws, ordinances and regulations. Accordingly, Fenstermaker makes no warranty or representation of any kind as to the foregoing issues, and persons or entities using this information shall do so at their own risk.

NOTE:

Please be advised, that while reasonable efforts are made to locate and verify pipelines and anomalies using our standard pipeline locating equipment, it is impossible to be 100 % effective. As such, we advise using caution when performing work as there is a possibility that pipelines and other hazards, such as fiber optic cables, PVC pipelines, etc. may exist undetected on site.

NOTE:

Many states maintain information centers that establish links between those who dig (excavators) and those who own and operate underground facilities (operators). It is advisable and in most states, law, for the contractor to contact the center for assistance in locating and marking underground utilities. For guidance, New Mexico One Call, www.nmonecall.org

FOR THE EXCLUSIVE USE OF
CHEVRON U.S.A. INC.
I, Robert L. Lastrapes, Professional
Surveyor, do hereby state this plat is true
and correct to the best of my knowledge.

ROBERT L. LASTRAPES
NEW MEXICO
23006
6-20-2016
PROFESSIONAL SURVEYOR
Robert L. Lastrapes
Registration No. 23006

SURFACE USE PLAT

CHEVRON U.S.A. INC.
PROPOSED PAD & ACCESS ROAD
SD WE 15 FED P9 NO. 6H WELL
SECTIONS 15 & 22, T26S-R32E
LEA COUNTY, NEW MEXICO

PAGE 2 OF 2



C. H. Fenstermaker & Associates, L.L.C.
135 Regency Sq. Lafayette, LA 70508
Ph 337-237-2200 Fax 337-232-3299
www.fenstermaker.com

DRAWN BY: KJD		REVISIONS	
PROJ. MGR.: VHV	No. 1	DATE: 06/02/2016	REVISED BY: BOR
DATE: JUNE 23, 2015	No.	DATE:	REVISED BY:
FILENAME: T:\2015\2152220\DWG\SD WE 15 Fed P9 6H_SUP.dwg			

R 32 E

Sec. 15

Bureau of Land Management

Sec. 14

Bureau of Land Management

T
26
S

Proposed Pad 12 Flowline Cluster
±6914'
Proposed Pad 12 Temporary Water Line
±10,541'

Proposed Pad 9 Flowline Cluster
±4,589'
Proposed Pad 9 Temporary Water Line
±8,076'

Proposed 60' Wide
PL ROW

Existing
Battery
Pad

Existing
Compressor
Pad

Existing Draw
PAD 12-41
Pad

Pad 12

Proposed 60' Wide PL ROW
(Pad 8 to Pad 12)

Pad 8

Pad 6

Proposed Expansion

Existing Lease Road

Proposed
Access
Road

Proposed
Access
Road

Existing Red
Hills 1H Pad

Proposed
Flow
Road

Proposed
PL ROW

Existing Fence

Sec. 22

Bureau of Land Management

Sec. 23

Bureau of Land Management

Sec. 24

Bureau of Land Management

NAD 27 NEW MEXICO EAST ZONE



Scale: 1" = 1000'

1000' 0 500' 1000'



C. H. Fenstermaker & Associates, L.L.C.
135 Regency Sq. Lafayette, LA 70508
Ph. 337-237-2200 Fax. 337-232-3299
www.fenstermaker.com

CHEVRON U.S.A. INC.

WORK AREA DETAIL FOR THE
SD WE 15 FED P9 & P12 1H-8H WELLS
SECTIONS 15, 22, 23 & 24, T26S-R32E
LEA COUNTY, NEW MEXICO

DRAWN BY: VHV

REVISIONS

PROJ. MGR.: VHV

No. #

DATE:

REVISED BY:

DATE: JULY 26, 2016

No. #

DATE:

REVISED BY:

FILENAME: T:\2015\2152215\DWG\Pad 9_Pad 12_AerialDetail.dwg

DIRECTIONS TO LOCATION: From Hwy 1 (Orla Road), head Easterly on Battle Axe Road approximately 6.80 miles to an existing lease road. Head Northerly then West along existing lease roads approximately 4.48 miles to the access road entrance on the North side of the road.

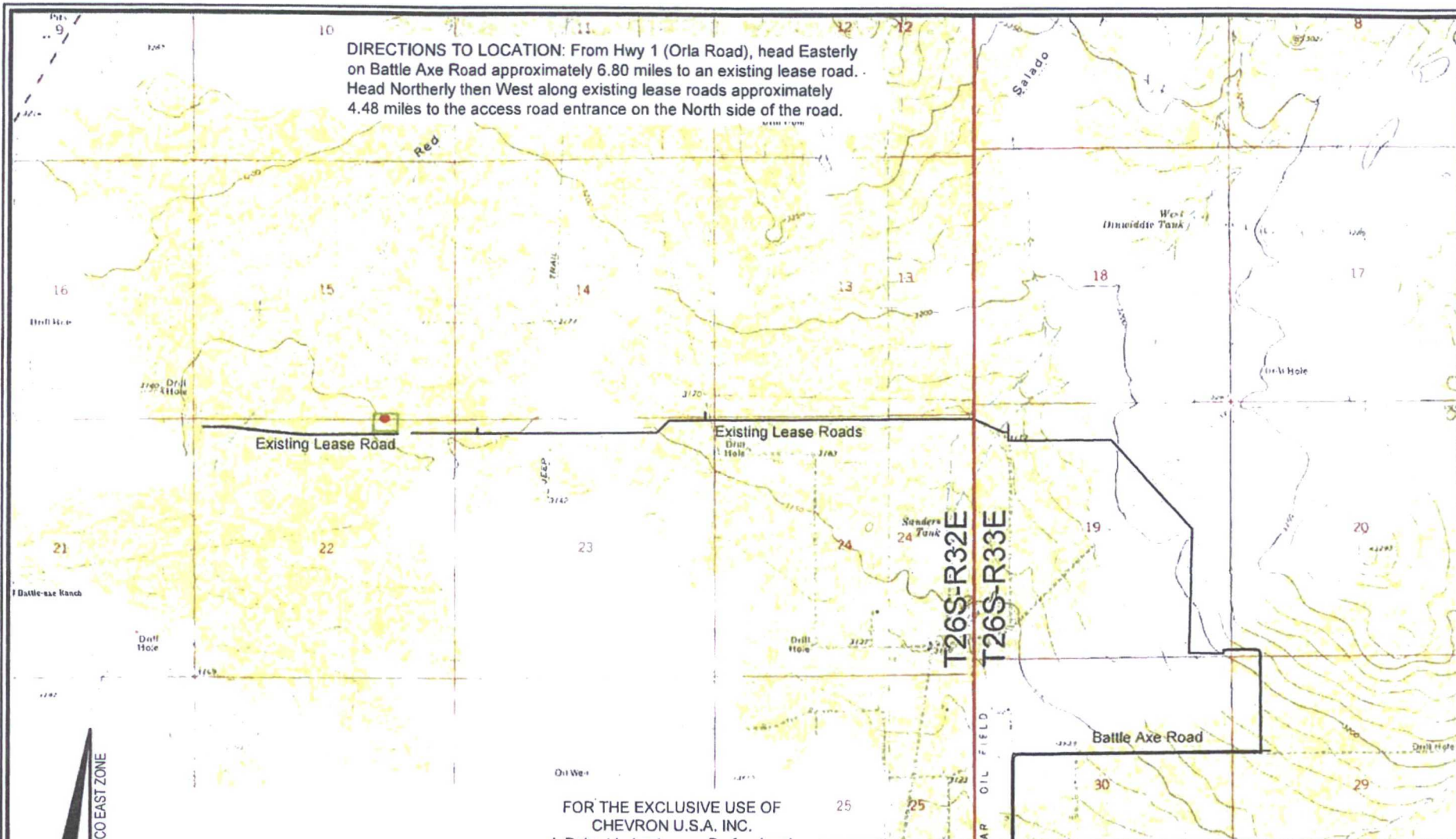

LEGEND

- Proposed Well
- Proposed Access Road
- Proposed Drillsite
- Existing Road
- Section Line

Scale: 1" = 3,000'

3,000' 0 1,500' 3,000'



NAD 27 NEW MEXICO EAST ZONE

FOR THE EXCLUSIVE USE OF
CHEVRON U.S.A. INC.
I, Robert L. Lastrapes, Professional
Surveyor, do hereby state this plat is true
and correct to the best of my knowledge.



Robert L. Lastrapes
Registration No. 23006

VICINITY MAP

CHEVRON U.S.A. INC.

SD WE 15 FED P9 NO. 6H WELL
LOCATED 12' FSL & 1446' FEL
SECTION 15, T26S-R32E
LEA COUNTY, NEW MEXICO

DRAWN BY: KJD

REVISIONS

PROJ. MGR.: VHV

No. 1

DATE: 06/02/2016

REVISED BY: BOR

DATE: JUNE 23, 2015

No.

DATE:

REVISED BY:

FILENAME: T:\2015\215220\DWG\SD WE 15 Fed P9 6H_APD.dwg



C. H. Fenstermaker & Associates, L.L.C.
135 Regency Sq. Lafayette, LA 70506
Ph. 337-237-2200 Fax. 337-232-3299
www.fenstermaker.com

LEGEND

- Section Line
- Centerline Access Road
- Existing Lease Road & Drillsite
- As-Drilled Well
- End. Monument

R 32 E

Sec. 15

Bureau of Land Management

(±1.28 Acres-Pad)

FOR THE EXCLUSIVE USE OF
CHEVRON U.S.A. INC.
I, Robert L. Lastrapes, Professional
Surveyor, do hereby state this plat is true
and correct to the best of my knowledge.

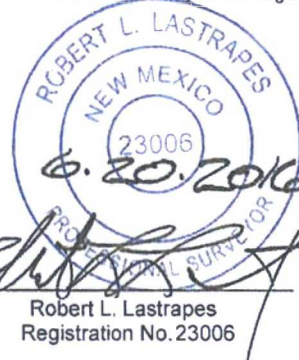

PROPOSED
ARCHAEOLOGICAL
AREA
±5.21 ACRES

T
26
S

PROPOSED PAD
±4.09 ACRES

SD WE 15 Fed P9
No. 6H Well
12' FSL
1446' FEL

Red Hills West 22 Fed Com
No. 1H Well
(As-Drilled)

Point of
Commencement/
End. 1 1/2" Iron
Pipe w/Cap

Existing Lease Road

CENTERLINE
PROPOSED ACCESS ROAD

14' x ±61.18'
±0.02 ACRES
±3.71 Rods

Sec. 22

Bureau of Land Management

(±2.81 Acres-Pad)

SD WE 15 FED P9 NO. 6H WELL		
X=	709,149	NAD 27
Y=	377,296	
LAT.	32.035506	
LONG.	103.658395	
SD WE 15 FED P9 NO. 6H WELL		
X=	750,336	NAD83
Y=	377,353	
LAT.	32.035631	
LONG.	103.658865	
ELEVATION +3157' NAVD 88		

NW ARCH. AREA CORNER	NE ARCH. AREA CORNER	SE ARCH. AREA CORNER	SW ARCH. AREA CORNER
X= 708,822 NAD 27 Y= 377,593	X= 709,497 NAD 27 Y= 377,599	X= 709,502 NAD 27 Y= 376,999	X= 708,827 NAD 27 Y= 376,993
NW PAD CORNER	NE PAD CORNER	SE PAD CORNER	SW PAD CORNER
X= 708,913 NAD 27 Y= 377,394	X= 709,408 NAD 27 Y= 377,399	X= 709,411 NAD 27 Y= 377,039	X= 708,916 NAD 27 Y= 377,034
ELEVATION +3157' NAVD 88	ELEVATION +3157' NAVD 88	ELEVATION +3157' NAVD 88	ELEVATION +3156' NAVD 88

SURFACE USE PLAT

Scale: 1" = 200'

200' 0 100' 200'

CHEVRON U.S.A. INC.
PROPOSED PAD & ACCESS ROAD
SD WE 15 FED P9 NO. 6H WELL
SECTIONS 15 & 22, T26S-R32E
LEA COUNTY, NEW MEXICO

PAGE 1 OF 2



C. H. Fenstermaker & Associates, L.L.C.
135 Regency Sq. Lafayette, LA 70508
Ph 337-237-2200 Fax 337-232-3299
www.fenstermaker.com

DRAWN BY: KJD

REVISIONS

PROJ. MGR.: VHV

No. 1

DATE: 06/02/2016

REVISED BY: BOR

DATE: JUNE 23, 2015

No.

DATE:

REVISED BY:

FILENAME: T:\2015\2152220\DWG\SD WE 15 Fed P9 6H_SUP.dwg

DISCLAIMER: At this time, C. H. Fenstermaker & Associates, L.L.C. has not performed nor was asked to perform any type of engineering, hydrological modeling, flood plain, or "No Rise" certification analyses, including but not limited to determining whether the project will impact flood hazards in connection with federal/FEMA, state, and/or local laws, ordinances and regulations. Accordingly, Fenstermaker makes no warranty or representation of any kind as to the foregoing issues, and persons or entities using this information shall do so at their own risk.

NOTE:

Please be advised, that while reasonable efforts are made to locate and verify pipelines and anomalies using our standard pipeline locating equipment, it is impossible to be 100 % effective. As such, we advise using caution when performing work as there is a possibility that pipelines and other hazards, such as fiber optic cables, PVC pipelines, etc. may exist undetected on site.

NOTE:

Many states maintain information centers that establish links between those who dig (excavators) and those who own and operate underground facilities (operators). It is advisable and in most states, law, for the contractor to contact the center for assistance in locating and marking underground utilities. For guidance, New Mexico One Call, www.nmonecall.org

FOR THE EXCLUSIVE USE OF
CHEVRON U.S.A. INC.

I, Robert L. Lastrapes, Professional
Surveyor, do hereby state this plat is true
and correct to the best of my knowledge.

ROBERT L. LASTRAPES
NEW MEXICO
23006
6-20-2016
PROFESSIONAL SURVEYOR
Robert L. Lastrapes
Registration No. 23006

SURFACE USE PLAT

CHEVRON U.S.A. INC.
PROPOSED PAD & ACCESS ROAD
SD WE 15 FED P9 NO. 6H WELL
SECTIONS 15 & 22, T26S-R32E
LEA COUNTY, NEW MEXICO

PAGE 2 OF 2



C. H. Fenstermaker & Associates, L.L.C.
135 Regency Sq. Lafayette, LA 70508
Ph 337-237-2200 Fax 337-232-3299
www.fenstermaker.com

DRAWN BY: KJD		REVISIONS	
PROJ. MGR.: VHV	No. 1	DATE: 06/02/2016	REVISED BY: BOR
DATE: JUNE 23, 2015	No.	DATE:	REVISED BY:
FILENAME: T:\2015\2152220\DWG\SD WE 15 Fed P9 6H_SUP.dwg			

SD WE 15 Fed P9 6H – Surface & Bottom Hole Location
TWN 26S RNG 32E SEC 15
1 Mile Radius

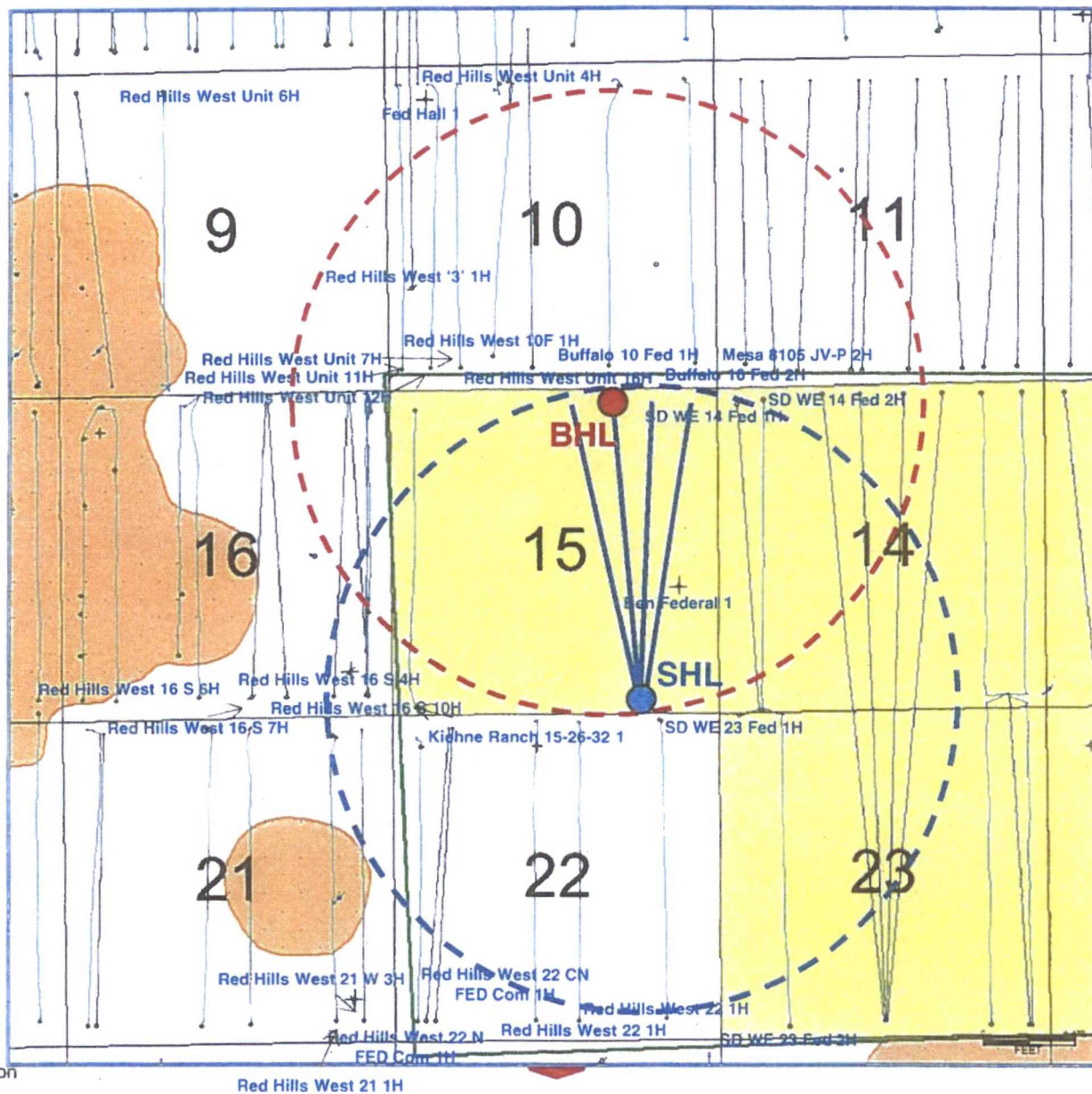

LEGEND

- Section Line
- Centerline Access Road
- Existing Lease Road & Drillsite
- As-Drilled Well
- Fnd. Monument

R 32 E

Sec. 15

Bureau of Land Management

(±1.28 Acres-Pad)

FOR THE EXCLUSIVE USE OF
CHEVRON U.S.A. INC.
I, Robert L. Lastrapes, Professional
Surveyor, do hereby state this plat is true
and correct to the best of my knowledge.

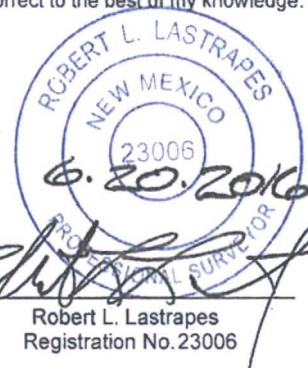

PROPOSED
ARCHAEOLOGICAL
AREA
±5.21 ACRES

T
26
S

PROPOSED PAD
±4.09 ACRES

SD WE 15 Fed P9
No. 6H Well
12' FSL
1446' FEL

Red Hills West 22 Fed Com
No. 1H Well
(As-Drilled)

Point of
Commencement/
Fnd. 1 1/2" Iron
Pipe w/Cap

Existing Lease Road

CENTERLINE
PROPOSED ACCESS ROAD
14' x ±61.18'
±0.02 ACRES
±3.71 Rods

Sec. 22

Bureau of Land Management
(±2.81 Acres-Pad)

SD WE 15 FED P9 NO. 6H WELL		
X=	709,149	NAD 27
Y=	377,296	
LAT.	32.035506	
LONG.	103.658395	
X=	750,336	NAD83
Y=	377,353	
LAT.	32.035631	
LONG.	103.658865	
ELEVATION	+3157' NAVD 88	

NW ARCH. AREA CORNER	NE ARCH. AREA CORNER	SE ARCH. AREA CORNER	SW ARCH. AREA CORNER
X= 708,822 NAD 27 Y= 377,593	X= 709,497 NAD 27 Y= 377,599	X= 709,502 NAD 27 Y= 376,999	X= 708,827 NAD 27 Y= 376,993
NW PAD CORNER	NE PAD CORNER	SE PAD CORNER	SW PAD CORNER
X= 708,913 NAD 27 Y= 377,394	X= 709,408 NAD 27 Y= 377,399	X= 709,411 NAD 27 Y= 377,039	X= 708,916 NAD 27 Y= 377,034
ELEVATION +3157' NAVD 88	ELEVATION +3156' NAVD 88	ELEVATION +3157' NAVD 88	ELEVATION +3156' NAVD 88

SURFACE USE PLAT

Scale: 1" = 200'

200' 0 100' 200'

CHEVRON U.S.A. INC.
PROPOSED PAD & ACCESS ROAD
SD WE 15 FED P9 NO. 6H WELL
SECTIONS 15 & 22, T26S-R32E
LEA COUNTY, NEW MEXICO

PAGE 1 OF 2



C. H. Fenstermaker & Associates, L.L.C.
135 Regency Sq. Lafayette, LA 70508
Ph 337-237-2200 Fax 337-232-3299
www.fenstermaker.com

DRAWN BY: KJD		REVISIONS	
PROJ. MGR.: VHV	No. 1	DATE: 06/02/2016	REVISED BY: BOR
DATE: JUNE 23, 2015	No.	DATE:	REVISED BY:
FILENAME: T:\2015\2152220\DWG\SD WE 15 Fed P9 6H_SUP.dwg			

DISCLAIMER: At this time, C. H. Fenstermaker & Associates, L.L.C. has not performed nor was asked to perform any type of engineering, hydrological modeling, flood plain, or "No Rise" certification analyses, including but not limited to determining whether the project will impact flood hazards in connection with federal/FEMA, state, and/or local laws, ordinances and regulations. Accordingly, Fenstermaker makes no warranty or representation of any kind as to the foregoing issues, and persons or entities using this information shall do so at their own risk.

NOTE:

Please be advised, that while reasonable efforts are made to locate and verify pipelines and anomalies using our standard pipeline locating equipment, it is impossible to be 100 % effective. As such, we advise using caution when performing work as there is a possibility that pipelines and other hazards, such as fiber optic cables, PVC pipelines, etc. may exist undetected on site.

NOTE:

Many states maintain information centers that establish links between those who dig (excavators) and those who own and operate underground facilities (operators). It is advisable and in most states, law, for the contractor to contact the center for assistance in locating and marking underground utilities. For guidance, New Mexico One Call. www.nmonecall.org

FOR THE EXCLUSIVE USE OF
CHEVRON U.S.A. INC.

I, Robert L. Lastrapes, Professional
Surveyor, do hereby state this plat is true
and correct to the best of my knowledge.

ROBERT L. LASTRAPES
NEW MEXICO
23006
6-20-2016
PROFESSIONAL SURVEYOR
Robert L. Lastrapes
Registration No. 23006

SURFACE USE PLAT

CHEVRON U.S.A. INC.
PROPOSED PAD & ACCESS ROAD
SD WE 15 FED P9 NO. 6H WELL
SECTIONS 15 & 22, T26S-R32E
LEA COUNTY, NEW MEXICO

PAGE 2 OF 2



C. H. Fenstermaker & Associates, L.L.C.
135 Regency Sq. Lafayette, LA 70508
Ph 337-237-2200 Fax. 337-232-3299
www.fenstermaker.com

DRAWN BY: KJD		REVISIONS	
PROJ. MGR.: VHV	No. 1	DATE: 06/02/2016	REVISED BY: BOR
DATE: JUNE 23, 2015	No.	DATE:	REVISED BY:
FILENAME: T:\2015\2152220\DWG\SD WE 15 Fed P9 6H_SUP.dwg			

Nabors Pace X SD Sec 15 Pad 9



Rig layout shows rig in first and last well for illustration purposes.

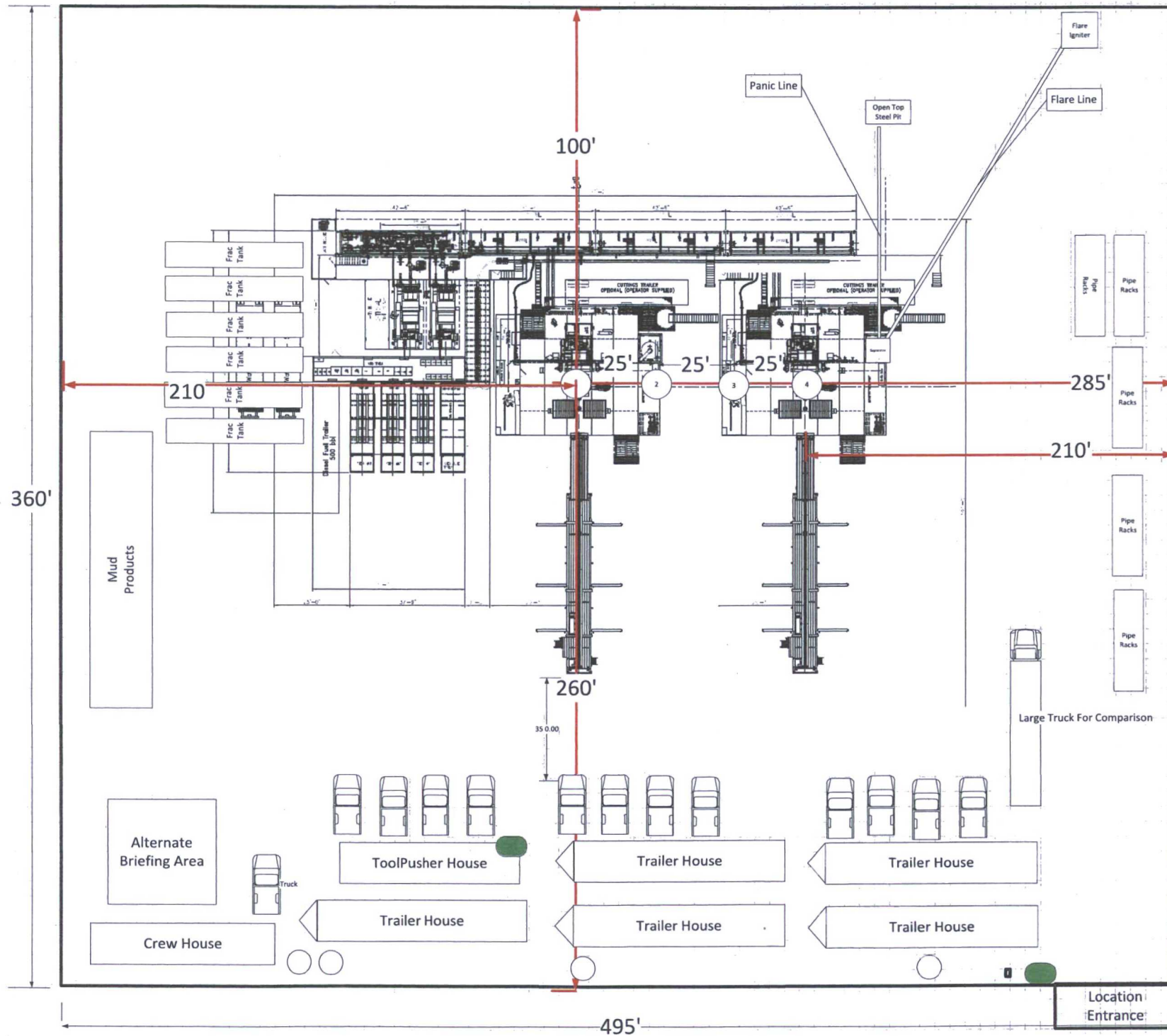

H2S Monitor Locations

- Bop/Cellar
- Rig Floor
- Shaker Skid
- Bell Nipple

Flag Locations

- Sign-in Shack
- Rig Floor
- Dog House

10 Minute Escape Packs

- 1 at Pits
- 1 at Trip Tank
- 1 at Accumulator
- 4 at Rig Floor

45 Minute Escape Packs

- 2 at Briefing Area
- 2 at Alternate Briefing Area

Legend

● H2S Monitor

● Flag

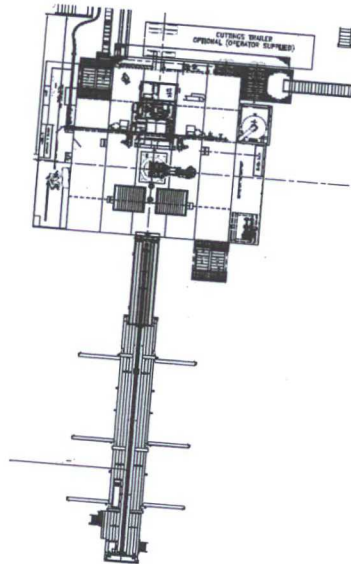

LEGEND

- Section Line
- Centerline Access Road
- Existing Lease Road & Drillsite
- ☼ As-Drilled Well
- Fnd. Monument

R 32 E

Sec. 15

Bureau of Land Management

(±1.28 Acres-Pad)

FOR THE EXCLUSIVE USE OF
CHEVRON U.S.A. INC.
I, Robert L. Lastrapes, Professional
Surveyor, do hereby state this plat is true
and correct to the best of my knowledge.

ROBERT L. LASTRAPES
NEW MEXICO
23006
6-20-2016
PROFESSIONAL SURVEYOR
Robert L. Lastrapes
Registration No. 23006

PROPOSED
ARCHAEOLOGICAL
AREA
±5.21 ACRES

PROPOSED PAD
±4.09 ACRES

Future Interim
Reclamation Area

SD WE 15 Fed P9
No. 8H Well
12' FSL
1396' FEL

Red Hills West 22 Fed Com
No. 1H Well
(As-Drilled)

Point of
Commencement/
Fnd. 1 1/2" Iron
Pipe w/Cap

Existing Lease Road

CENTERLINE
PROPOSED ACCESS ROAD
14' x ±61.18'
±0.02 ACRES
±3.71 Rods

Sec. 22

Bureau of Land Management

(±2.81 Acres-Pad)

SD WE 15 FED P9 NO. 8H WELL	
X=	709,199 NAD 27
Y=	377,297
LAT.	32.035506
LONG.	103.658233
SD WE 15 FED P9 NO. 8H WELL	
X=	750,386 NAD83
Y=	377,354
LAT.	32.035631
LONG.	103.658703
ELEVATION	+3157' NAVD 88

NW ARCH. AREA CORNER	NE ARCH. AREA CORNER	SE ARCH. AREA CORNER	SW ARCH. AREA CORNER
X= 708,822 NAD 27 Y= 377,593	X= 709,497 NAD 27 Y= 377,599	X= 709,502 NAD 27 Y= 376,999	X= 708,827 NAD 27 Y= 376,993
NW PAD CORNER	NE PAD CORNER	SE PAD CORNER	SW PAD CORNER
X= 708,913 NAD 27 Y= 377,394	X= 709,408 NAD 27 Y= 377,399	X= 709,411 NAD 27 Y= 377,039	X= 708,916 NAD 27 Y= 377,034
ELEVATION +3157' NAVD 88	ELEVATION +3157' NAVD 88	ELEVATION +3157' NAVD 88	ELEVATION +3156' NAVD 88

SURFACE USE PLAT

Scale: 1" = 200'

200' 0 100' 200'

CHEVRON U.S.A. INC.
PROPOSED PAD & ACCESS ROAD
SD WE 15 FED P9 NO. 8H WELL
SECTIONS 15 & 22, T26S-R32E
LEA COUNTY, NEW MEXICO

PAGE 1 OF 2



C H Fenstermaker & Associates, L L C
135 Regency Sq. Lafayette, LA 70508
Ph. 337-237-2200 Fax. 337-232-3299
www.fenstermaker.com

DRAWN BY: KJD

REVISIONS

PROJ. MGR.: VHV

No. 1

DATE: 06/02/2016

REVISED BY: BOR

DATE: JUNE 23, 2015

No.

DATE:

REVISED BY:

FILENAME: T:\2015\215222\DWG\SD WE 15 Fed P9 8H_SUP.dwg

DISCLAIMER: At this time, C. H. Fenstermaker & Associates, L.L.C. has not performed nor was asked to perform any type of engineering, hydrological modeling, flood plain, or "No Rise" certification analyses, including but not limited to determining whether the project will impact flood hazards in connection with federal/FEMA, state, and/or local laws, ordinances and regulations. Accordingly, Fenstermaker makes no warranty or representation of any kind as to the foregoing issues, and persons or entities using this information shall do so at their own risk.



NOTE:

Please be advised, that while reasonable efforts are made to locate and verify pipelines and anomalies using our standard pipeline locating equipment, it is impossible to be 100 % effective. As such, we advise using caution when performing work as there is a possibility that pipelines and other hazards, such as fiber optic cables, PVC pipelines, etc. may exist undetected on site.

NOTE:

Many states maintain information centers that establish links between those who dig (excavators) and those who own and operate underground facilities (operators). It is advisable and in most states, law, for the contractor to contact the center for assistance in locating and marking underground utilities. For guidance, New Mexico One Call. www.nmonecall.org

FOR THE EXCLUSIVE USE OF
CHEVRON U.S.A. INC.
I, Robert L. Lastrapes, Professional
Surveyor, do hereby state this plat is true
and correct to the best of my knowledge.



Robert L. Lastrapes
Registration No. 23006

SURFACE USE PLAT

CHEVRON U.S.A. INC.
PROPOSED PAD & ACCESS ROAD
SD WE 15 FED P9 NO. 8H WELL
SECTIONS 15 & 22, T26S-R32E
LEA COUNTY, NEW MEXICO

PAGE 2 OF 2



C. H. Fenstermaker & Associates, L.L.C.
135 Regency Sq. Lafayette, LA 70508
Ph 337-237-2200 Fax 337-232-3299
www.fenstermaker.com

DRAWN BY: KJD		REVISIONS	
PROJ. MGR.: VHV	No. 1	DATE: 06/02/2016	REVISED BY: BOR
DATE: JUNE 23, 2015	No.	DATE:	REVISED BY:
FILENAME: T:\2015\215222\DWG\SD WE 15 Fed P9 8H_SUP.dwg			

LEGEND

- Section Line
- Centerline Access Road
- Existing Lease Road & Drillsite
- ☼ As-Drilled Well
- Fnd Monument

R 32 E

Sec. 15

Bureau of Land Management

(±1.28 Acres-Pad)

FOR THE EXCLUSIVE USE OF
CHEVRON U.S.A. INC.
I, Robert L. Lastrapes, Professional
Surveyor, do hereby state this plat is true
and correct to the best of my knowledge.



Robert L. Lastrapes
Registration No. 23006

PROPOSED
ARCHAEOLOGICAL
AREA
±5.21 ACRES

T
26
S

PROPOSED PAD
±4.09 ACRES

SD WE 15 Fed P9
No. 6H Well
12' FSL
1446' FEL

Red Hills West 22 Fed Com
No. 1H Well
(As-Drilled)

Point of
Commencement/
Fnd. 1 1/2" Iron
Pipe w/Cap

Existing Lease Road

CENTERLINE
PROPOSED ACCESS ROAD
14' x ±61.18'
±0.02 ACRES
±3.71 Rods

Sec. 22

Bureau of Land Management

(±2.81 Acres-Pad)

SD WE 15 FED P9 NO. 6H WELL	
X=	709,149 NAD 27
Y=	377,296
LAT.	32.035506
LONG.	103.658395
SD WE 15 FED P9 NO. 6H WELL	
X=	750,336 NAD83
Y=	377,353
LAT.	32.035631
LONG.	103.658865
ELEVATION	+3157' NAVD 88

NW ARCH. AREA CORNER		NE ARCH. AREA CORNER		SE ARCH. AREA CORNER		SW ARCH. AREA CORNER	
X=	708,822 NAD 27	X=	709,497 NAD 27	X=	709,502 NAD 27	X=	708,827 NAD 27
Y=	377,593	Y=	377,599	Y=	376,999	Y=	376,993
NW PAD CORNER		NE PAD CORNER		SE PAD CORNER		SW PAD CORNER	
X=	708,913 NAD 27	X=	709,408 NAD 27	X=	709,411 NAD 27	X=	708,916 NAD 27
Y=	377,394	Y=	377,399	Y=	377,039	Y=	377,034
ELEVATION	+3157' NAVD 88	ELEVATION	+3157' NAVD 88	ELEVATION	+3157' NAVD 88	ELEVATION	+3156' NAVD 88

SURFACE USE PLAT

Scale: 1" = 200'

200' 0 100' 200'

CHEVRON U.S.A. INC.

PROPOSED PAD & ACCESS ROAD

SD WE 15 FED P9 NO. 6H WELL

SECTIONS 15 & 22, T26S-R32E

LEA COUNTY, NEW MEXICO

PAGE 1 OF 2



C. H. Fenstermaker & Associates, L.L.C.
135 Regency Sq. Lafayette, LA 70508
Ph 337-237-2200 Fax 337-232-3299
www.fenstermaker.com

DRAWN BY: KJD

REVISIONS

PROJ. MGR.: VHV

No. 1

DATE: 06/02/2016

REVISED BY: BOR

DATE: JUNE 23, 2015

No.

DATE:

REVISED BY:

FILENAME: T:\2015\2152220\DWG\SD WE 15 Fed P9 6H_SUP.dwg

DISCLAIMER: At this time, C. H. Fenstermaker & Associates, L.L.C. has not performed nor was asked to perform any type of engineering, hydrological modeling, flood plain, or "No Rise" certification analyses, including but not limited to determining whether the project will impact flood hazards in connection with federal/FEMA, state, and/or local laws, ordinances and regulations. Accordingly, Fenstermaker makes no warranty or representation of any kind as to the foregoing issues, and persons or entities using this information shall do so at their own risk.

NOTE:

Please be advised, that while reasonable efforts are made to locate and verify pipelines and anomalies using our standard pipeline locating equipment, it is impossible to be 100 % effective. As such, we advise using caution when performing work as there is a possibility that pipelines and other hazards, such as fiber optic cables, PVC pipelines, etc. may exist undetected on site.

NOTE:

Many states maintain information centers that establish links between those who dig (excavators) and those who own and operate underground facilities (operators). It is advisable and in most states, law, for the contractor to contact the center for assistance in locating and marking underground utilities. For guidance, New Mexico One Call. www.nmonecall.org

FOR THE EXCLUSIVE USE OF
CHEVRON U.S.A. INC.
I, Robert L. Lastrapes, Professional
Surveyor, do hereby state this plat is true
and correct to the best of my knowledge.

ROBERT L. LASTRAPES
NEW MEXICO
23006
6-20-2016
PROFESSIONAL SURVEYOR
Robert L. Lastrapes
Registration No. 23006

SURFACE USE PLAT

CHEVRON U.S.A. INC.
PROPOSED PAD & ACCESS ROAD
SD WE 15 FED P9 NO. 6H WELL
SECTIONS 15 & 22, T26S-R32E
LEA COUNTY, NEW MEXICO

PAGE 2 OF 2



C. H. Fenstermaker & Associates, L.L.C.
135 Regency Sq. Lafayette, LA 70508
Ph 337-237-2200 Fax 337-232-3299
www.fenstermaker.com

DRAWN BY: KJD		REVISIONS	
PROJ. MGR.: VHV	No. 1	DATE: 06/02/2016	REVISED BY: BOR
DATE: JUNE 23, 2015	No.	DATE:	REVISED BY:
FILENAME: T:\2015\2152220\DWG\SD WE 15 Fed P9 6H_SUP.dwg			