

District I
1625 N. French Dr., Hobbs, NM 88240
Phone: (575) 393-6161 Fax: (575) 393-0720
District II
811 S. First St., Artesia, NM 88210
Phone: (575) 748-1283 Fax: (575) 748-9720
District III
1000 Rio Brazos Road, Aztec, NM 87410
Phone: (505) 334-6178 Fax: (505) 334-6170
District IV
1220 S. St. Francis Dr., Santa Fe, NM 87505
Phone: (505) 476-3460 Fax: (505) 476-3462

State of New Mexico
Energy, Minerals & Natural Resources Department
OIL CONSERVATION DIVISION
1220 South St. Francis Dr.
Santa Fe, NM 87505

Form C-102
Revised August 1, 2011
Submit one copy to appropriate
District Office

☐ AMENDED REPORT

WELL LOCATION AND ACREAGE DEDICATION PLAT

¹ API Number 30 025-43666	² Pool Code 83600 2220	³ Pool Name ANTELOPE RIDGE; RED HILLS, WOLFCAMP
⁴ Property Code	⁵ Property Name FLOWMASTER	⁶ Well Number 1H
⁷ GRID No. 371127	⁸ Operator Name BLACK MOUNTAIN OPERATING, LLC	⁹ Elevation 3521'

¹⁰ Surface Location

UL or lot no.	Section	Township	Range	Lot Idn	Feet from the	North/South line	Feet from the	East/West line	County
D	15	24 SOUTH	34 EAST, N.M.P.M.		311'	NORTH	1225'	WEST	LEA

¹¹ Bottom Hole Location If Different From Surface

UL or lot no.	Section	Township	Range	Lot Idn	Feet from the	North/South line	Feet from the	East/West line	County
M	15	24 SOUTH	34 EAST, N.M.P.M.		330'	SOUTH	654'	WEST	LEA

¹² Dedicated Acres 160.00	¹³ Joint or Infill	¹⁴ Consolidation Code Other	¹⁵ Order No.
---	-------------------------------	---	-------------------------

No allowable will be assigned to this completion until all interests have been consolidated or a non-standard unit has been approved by the division.

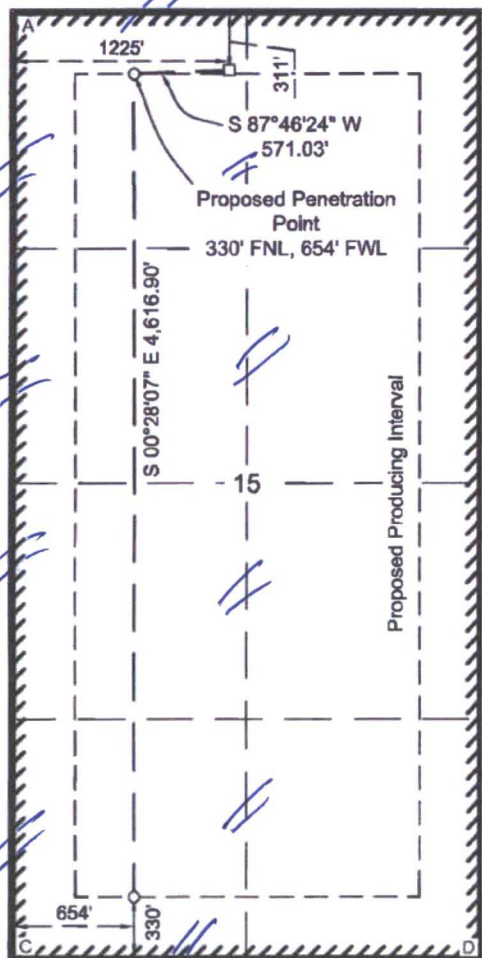

FLOWMASTER 1H WELL		
X=	769,473	NAD 27
Y=	448,235	
LAT.	32.223814	
LONG.	103.461942	
X=	810,658	NAD83
Y=	448,294	
LAT.	32.223939	
LONG.	103.462417	
ELEVATION +3521' NAVD 88		

CORNER COORDINATES TABLE (NAD 27)

A - Y=446539.32, X=768245.70
B - Y=446554.60, X=770886.94
C - Y=441262.20, X=768288.86
D - Y=441279.07, X=770930.90

PROPOSED BOTTOM HOLE LOCATION		
X=	768,940	NAD 27
Y=	441,596	
LAT.	32.211075	
LONG.	103.463786	
X=	810,125	NAD83
Y=	441,655	
LAT.	32.211200	
LONG.	103.464260	

¹⁷ OPERATOR CERTIFICATION

I hereby certify that the information contained herein is true and complete to the best of my knowledge and belief, and that this organization either owns a working interest or unleased mineral interest in the land including the proposed bottom hole location or has a right to drill this well at this location pursuant to a contract with an owner of such a mineral or working interest, or to a voluntary pooling agreement or a compulsory pooling order heretofore entered by the division.

Signature: Denise L. White Date: 03/07/2017

Printed Name: Denise L. White

E-mail Address: denise.white@blackmtn.com

¹⁸ SURVEYOR CERTIFICATION

I hereby certify that the well location shown on this plat was plotted from field notes of actual surveys made by me or under my supervision, and that the same is true and correct to the best of my belief.

Date of Survey: 2-27-17

Signature and Seal of Professional Surveyor

Certificate Number: 23006



R 34 E

T
24
S

Point of
Commencement/
Fnd. Monument @
the NW Corner of
Section 15

Sec. 15
Bert Madera

Existing Pipeline

Existing Pipeline

Flowmaster
No. 1H Well
311' FNL
1,225' FWL

PROPOSED PAD
±3.62 Acres

CENTERLINE
PROPOSED
ACCESS ROAD
25' x ±312.27'
±18.93 Rods
±0.18 Acres

S 60° 54' 16" E 1,675.75'
Existing 2-Track Road

Existing Pipeline

Existing
Pipelines

Existing Lease Road

NAD 27 NEW MEXICO EAST ZONE

LEGEND

- Section Line
- - - Existing Road
- - - Existing Pipeline
- Proposed Pad
- Centerline Access
- Fnd. Monument

Scale: 1" = 200'

200' 0 100' 200'

FOR THE EXCLUSIVE USE OF
BLACK MOUNTAIN OPERATING, LLC
I, Robert L. Lastrapes, Professional
Surveyor, do hereby state this plat is true
and correct to the best of my knowledge.

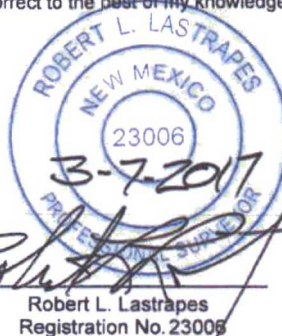

NW PAD CORNER		NE PAD CORNER		FLOWMASTER NO. 1H WELL	
X=	769,262 NAD 27	X=	769,712 NAD 27	X=	769,473 NAD 27
Y=	446,384	Y=	446,387	Y=	446,235
ELEVATION +3521' NAVD 88		ELEVATION +3521' NAVD 88		LAT.	32.223814
SW PAD CORNER		SE PAD CORNER		LONG.	103.461942
X=	769,264 NAD 27	X=	769,714 NAD 27	X=	810,658 NAD83
Y=	446,034	Y=	446,037	Y=	446,294
ELEVATION +3518' NAVD 88		ELEVATION +3519' NAVD 88		LAT.	32.223939
				LONG.	103.462417
				ELEVATION	+3521' NAVD 88

SURFACE USE PLAT

Page 1 of 2

BLACK MOUNTAIN OPERATING, LLC

PROPOSED PAD & ACCESS ROAD
FLOWMASTER NO. 1H WELL
SECTION 15, T24S-R34E
LEA COUNTY, NEW MEXICO

DRAWN BY: BOR		REVISIONS			
PROJ. MGR.: VHV	No.	DATE:		REVISED BY:	
DATE: 03/03/2017	No.	DATE:		REVISED BY:	
FILENAME: T:\2017\2175474\DWG\Flowmaster 1H_SUP.dwg					



C. H. Fenstermaker & Associates, L.L.C.
135 Regency Sq. Lafayette, LA 70508
Ph. 337-237-2200 Fax. 337-232-3299
www.fenstermaker.com

NOTE:

Please be advised, that while reasonable efforts are made to locate and verify pipelines and anomalies using our standard pipeline locating equipment, it is impossible to be 100 % effective. As such, we advise using caution when performing work as there is a possibility that pipelines and other hazards, such as fiber optic cables, PVC pipelines, etc. may exist undetected on site.

NOTE:

Many states maintain information centers that establish links between those who dig (excavators) and those who own and operate underground facilities (operators). It is advisable and in most states, law, for the contractor to contact the center for assistance in locating and marking underground utilities. For guidance: New Mexico One Call - www.nmonecall.org

DISCLAIMER: At this time, C. H. Fenstermaker & Associates, L.L.C. has not performed nor was asked to perform any type of engineering, hydrological modeling, flood plain, or "No Rise" certification analyses, including but not limited to determining whether the project will impact flood hazards in connection with federal/FEMA, state, and/or local laws, ordinances and regulations. Accordingly, Fenstermaker makes no warranty or representation of any kind as to the foregoing issues, and persons or entities using this information shall do so at their own risk.

CENTERLINE PROPOSED ACCESS ROAD		
COURSE	BEARING	DISTANCE
1	N 01° 31' 56" W	312.27'

PROPOSED PAD		
COURSE	BEARING	DISTANCE
2	S 89° 40' 07" W	437.50'
3	N 00° 19' 53" W	350.00'
4	N 89° 40' 07" E	450.00'
5	S 00° 19' 53" E	350.00'
6	S 89° 40' 07" W	12.50'

FOR THE EXCLUSIVE USE OF
BLACK MOUNTAIN OPERATING, LLC
I, Robert L. Lastrapes, Professional
Surveyor, do hereby state this plat is true
and correct to the best of my knowledge.



Robert L. Lastrapes
Registration No. 23006



C. H. Fenstermaker & Associates, L.L.C.
135 Regency Sq. Lafayette, LA 70508
Ph. 337-237-2200 Fax. 337-232-3299
www.fenstermaker.com

SURFACE USE PLAT

Page 2 of 2

BLACK MOUNTAIN OPERATING, LLC
PROPOSED PAD & ACCESS ROAD
FLOWMASTER NO. 1H WELL
SECTION 15, T24S-R34E
LEA COUNTY, NEW MEXICO

DRAWN BY: BOR		REVISIONS	
PROJ. MGR.: VHV	No.	DATE:	REVISED BY:
DATE: 03/03/2017	No.	DATE:	REVISED BY:
FILENAME: T:\2017\2175474\DWG\Flowmaster 1H_SUP.dwg			