

UNITED STATES
DEPARTMENT OF THE INTERIOR
BUREAU OF LAND MANAGEMENTFORM APPROVED
OMB NO. 1004-0137
Expires: January 31, 2018

HOBBS OCD

JUL 24 2017

RECEIVED

SUNDRY NOTICES AND REPORTS ON WELLS

Do not use this form for proposals to drill or to re-enter an abandoned well. Use form 3160-3 (APD) for such proposals.

SUBMIT IN TRIPLICATE - Other instructions on page 2

1. Type of Well <input checked="" type="checkbox"/> Oil Well <input type="checkbox"/> Gas Well <input type="checkbox"/> Other		5. Lease Serial No. Multiple--See Attached
2. Name of Operator OCCIDENTAL PERMIAN LP Contact: JUSTIN MORRIS E-Mail: JUSTIN_MORRIS@OXY.COM		6. If Indian, Allottee or Tribe Name
3a. Address MIDLAND, TX 79710	3b. Phone No. (include area code) Ph: 713-366-5249	7. If Unit or CA/Agreement, Name and/or No. Multiple--See Attached
4. Location of Well (Footage, Sec., T., R., M., or Survey Description) Multiple--See Attached		8. Well Name and No. Multiple--See Attached
		9. API Well No. Multiple--See Attached
		10. Field and Pool or Exploratory Area FOWLER
		11. County or Parish, State LEA COUNTY, NM

12. CHECK THE APPROPRIATE BOX(ES) TO INDICATE NATURE OF NOTICE, REPORT, OR OTHER DATA

TYPE OF SUBMISSION	TYPE OF ACTION			
<input checked="" type="checkbox"/> Notice of Intent	<input type="checkbox"/> Acidize	<input type="checkbox"/> Deepen	<input type="checkbox"/> Production (Start/Resume)	<input type="checkbox"/> Water Shut-Off
<input type="checkbox"/> Subsequent Report	<input type="checkbox"/> Alter Casing	<input type="checkbox"/> Hydraulic Fracturing	<input type="checkbox"/> Reclamation	<input type="checkbox"/> Well Integrity
<input type="checkbox"/> Final Abandonment Notice	<input type="checkbox"/> Casing Repair	<input type="checkbox"/> New Construction	<input type="checkbox"/> Recomplete	<input checked="" type="checkbox"/> Other Surface Commingling
	<input type="checkbox"/> Change Plans	<input type="checkbox"/> Plug and Abandon	<input type="checkbox"/> Temporarily Abandon	
	<input type="checkbox"/> Convert to Injection	<input type="checkbox"/> Plug Back	<input type="checkbox"/> Water Disposal	

13. Describe Proposed or Completed Operation: Clearly state all pertinent details, including estimated starting date of any proposed work and approximate duration thereof. If the proposal is to deepen directionally or recompleat horizontally, give subsurface locations and measured and true vertical depths of all pertinent markers and zones. Attach the Bond under which the work will be performed or provide the Bond No. on file with BLM/BIA. Required subsequent reports must be filed within 30 days following completion of the involved operations. If the operation results in a multiple completion or recompleat in a new interval, a Form 3160-4 must be filed once testing has been completed. Final Abandonment Notices must be filed only after all requirements, including reclamation, have been completed and the operator has determined that the site is ready for final inspection.

APPLICATION FOR POOL AND LEASE COMMINGLE AT THE SOUTH MATTIX UNIT FEDERAL CTB

Occidental Permian LTD is requesting approval for Pool & Lease Commingle for all wells attached, which will nullify previously approved commingle permit PC-796.

A map is enclosed showing the Federal leases and well locations.

Oil & Gas metering:

The central tank battery is located on the South Mattix Unit Federal lease (NMNM 0321613) located at 32.2171, -103.149 in section 15, T24S, R37E in Lea County, New Mexico.

Verbal Approval Given 7/21/17 JOM

14. I hereby certify that the foregoing is true and correct. Electronic Submission #377210 verified by the BLM Well Information System For OCCIDENTAL PERMIAN LP, sent to the Hobbs Committed to AFMSS for processing by DEBORAH MCKINNEY on 05/30/2017 (17DLM1142SE)	
Name (Printed/Typed) JUSTIN MORRIS	Title REGULATORY ENGINEER
Signature (Electronic Submission)	Date 05/24/2017

THIS SPACE FOR FEDERAL OR STATE OFFICE USE

Approved By <i>J. D. W. Whitlock</i>	Title <i>TLDET</i>	Date <i>7/20/17</i>
Conditions of approval, if any, are attached. Approval of this notice does not warrant or certify that the applicant holds legal or equitable title to those rights in the subject lease which would entitle the applicant to conduct operations thereon.		Office <i>CFO</i>

Title 18 U.S.C. Section 1001 and Title 43 U.S.C. Section 1212, make it a crime for any person knowingly and willfully to make to any department or agency of the United States any false, fictitious or fraudulent statements or representations as to any matter within its jurisdiction.

(Instructions on page 2)

** BLM REVISED ** BLM REVISED ** BLM REVISED ** BLM REVISED ** BLM REVISED **

Ke

Additional data for EC transaction #377210 that would not fit on the form

5. Lease Serial No., continued

NMLC032450A
NMLC032450B
NMLC060579
NMNM0321613

7. If Unit or CA/Agreement, Name and No., continued

8920005780
892000578C
892000578D
892000578X

Wells/Facilities, continued

Agreement	Lease	Well/Fac Name, Number	API Number	Location
NMNM71037A	NMNM0321613	SOUTH MATTIX 1	30-025-11111-00-S1	Sec 15 T24S R37E NWSE 1980FSL 1980FEL
NMNM71037X	NMLC032450B	SOUTH MATTIX 14	30-025-11110-00-S3	Sec 15 T24S R37E NESW 1980FSL 1980FWL
NMNM71037X	NMNM0321613	SOUTH MATTIX 24	30-025-22488-00-S4	Sec 15 T24S R37E SWSE 510FSL 1830FEL
NMNM71037X	NMLC032450A	SOUTH MATTIX 5	30-025-11201-00-S5	Sec 22 T24S R37E SENE 1980FNL 660FEL
NMNM71037X	NMNM0321613	SOUTH MATTIX UNIT FEDERAL 4	30-025-35292-00-S1	Sec 15 T24S R37E NWSE 2005FSL 1650FEL
NMNM71037A	NMNM0321613	SOUTH MATTIX 17	30-025-20298-00-S1	Sec 15 T24S R37E SWNE 1980FNL 1980FEL
NMNM71037A	NMLC032450B	SOUTH MATTIX 25	30-025-22825-00-S1	Sec 15 T24S R37E NENW 910FNL 1980FWL
NMNM71037D	NMNM0321613	SOUTH MATTIX 10	30-025-11118-00-S1	Sec 15 T24S R37E SENE 1980FNL 810FEL
NMNM71037D	NMLC032450A	SOUTH MATTIX 12	30-025-11203-00-S1	Sec 22 T24S R37E SESE 766FSL 544FEL
NMNM71037D	NMLC032450A	SOUTH MATTIX 13	30-025-11204-00-S1	Sec 22 T24S R37E NESE 2310FSL 330FEL
NMNM71037D	NMLC032450A	SOUTH MATTIX 2	30-025-11112-00-S1	Sec 15 T24S R37E SESW 660FSL 1980FWL
NMNM71037D	NMLC032450B	SOUTH MATTIX 20	30-025-21678-00-S1	Sec 15 T24S R37E SWNW 1980FNL 660FWL
NMNM71037D	NMLC032450B	SOUTH MATTIX 22	30-025-21922-00-S1	Sec 15 T24S R37E NENW 710FNL 1930FWL
NMNM71037D	NMLC032450B	SOUTH MATTIX 27	30-025-25612-00-S1	Sec 15 T24S R37E SENW 2030FNL 1880FWL
NMNM71037D	NMLC032450A	SOUTH MATTIX 3	30-025-11196-00-S1	Sec 22 T24S R37E NWNE 660FNL 1980FEL
NMNM71037D	NMNM0321613	SOUTH MATTIX 30	30-025-25747-00-S1	Sec 15 T24S R37E SESE 330FSL 330FEL
NMNM71037D	NMNM0321613	SOUTH MATTIX 33	30-025-26095-00-S2	Sec 15 T24S R37E SWNE 1650FNL 1650FEL
NMNM71037D	NMLC032450B	SOUTH MATTIX 40	30-025-31475-00-S1	Sec 15 T24S R37E NESW 2373FSL 2200FWL
NMNM71037D	NMLC032450A	SOUTH MATTIX 6	30-025-11114-00-S1	Sec 15 T24S R37E NWSW 1980FSL 660FWL
NMNM71037D	NMNM0321613	SOUTH MATTIX 9	30-025-11117-00-S1	Sec 15 T24S R37E NWNE 660FNL 1980FEL
NMNM71037E	NMLC060579	SOUTH MATTIX 15	30-025-20513-00-S4	Sec 22 T24S R37E NENE 660FNL 660FEL
NMNM71037E	NMNM0321613	SOUTH MATTIX 37	30-025-26355-00-S1	Sec 15 T24S R37E NESE 1840FSL 660FEL
NMNM71037E	NMNM0321613	SOUTH MATTIX 39	30-025-26598-00-S2	Sec 15 T24S R37E SWNE 1890FNL 2070FEL

32. Additional remarks, continued

Wells will be routed to one of two common three-phase production separators as shown in attached diagram. Oil production will flow to three common oil tanks after measurement and then be sent through a LACT meter (S/N *TBD). Gas production will be sent to ETC Sales Meter (S/N 14203) located at 32.2170, -103.1499 or ETC Sales Meter (S/N 63238) located at 32.2168, -103.1494. Water production will be sent to Fowler SWD for disposal.

All wells will be tested at least quarterly for a minimum of 24 hours through three-phase test separator with meters for gas (S/N 2104796), oil (S/N 435289) and water (S/N 434677) or three-phase test separator with meters for gas (S/N 2101483), oil (S/N 363735) and water (S/N 576327) for allocation purposes.

All meters will be proven, as per API, NMOCD, and BLM specifications, when installed, once per month for the first 3 months (to establish a consistent repeatability factor), and then quarterly thereafter. The factor obtained will be used to allocate the production volumes.

This commingle will result in maximum ultimate economic recovery of oil and gas with minimum waste, as wells would otherwise have to be plugged.

Process and Flow Descriptions:

The flow of production is shown in detail on enclosed facility diagram and map which shows the lease boundaries, Communitization agreement boundaries, location of wells, facility, and gas sales meter. The commingling of this production is the most effective means of producing the reserves.

Occidental Permian LTD understands the requested approval will not constitute the granting of any right-of-way or construction rights not granted by the lease instrument. These applications will be submitted separately for approval per NMOCD and BLM regulations.

The BLM and NMOCD will be notified of any future changes in the facilities.

Pursuant to Statewide rule 19.15.12.10(C)(4)(g) OXY USA INC requests the option to include additional pools or leases within the defined parameters set forth in the order for future additions.

APPLICATION FOR POOL AND LEASE COMMINGLE, AND OFF-LEASE MEASUREMENT, STORAGE AND SALES AT THE SOUTH MATTIX UNIT FEDERAL CTB

Occidental Permian LTD is requesting approval for Pool & Lease Commingle for all wells listed below, which will nullify previously approved commingle permit PC-796. Off-lease measurement, storage and sales for South Mattix PA# NM71037E including wells #15, #37 and #39 is also requested.

This proposal is based on economics. If the wells are not commingled, the required facility repairs cannot be justified.

SOUTH MATTIX UNIT NMNM 71037X

Pool: Fowler; Drinkard (26220): Lease #NMNM 0321613 (Schedule D)

WELL NAME	API NO.	LOCATION	BOPD	GRAVITY	MSCFPD	BTU
SOUTH MATTIX #24	30-025-22488	O-15-24S-37E	0	40.7	0.3	1291
SOUTH MATTIX UNIT FEDERAL #45	30-025-35292	J-15-24S-37E	1.7	40.7	128.2	1291

Pool: Fowler; Drinkard (26220): Lease #NMLC 032450A (5% Royalty)

WELL NAME	API NO.	LOCATION	BOPD	GRAVITY	MSCFPD	BTU
SOUTH MATTIX #5	30-025-11201	H-22-24S-37E	0.7	40.7	0	1291

Pool: Fowler; Drinkard (26220): Lease #NMLC 032450B (Schedule D)

WELL NAME	API NO.	LOCATION	BOPD	GRAVITY	MSCFPD	BTU
SOUTH MATTIX #14	30-025-11110	K-15-24S-37E	1.6	40.7	0	1291

PA# NM 71037A

Pool: Fowler; Ellenburger (26410): Lease #NMNM 0321613 (Schedule D)

WELL NAME	API NO.	LOCATION	BOPD	GRAVITY	MSCFPD	BTU
SOUTH MATTIX #1	30-025-11111	J-15-24S-37E	7.6	40.7	49	1291
SOUTH MATTIX #17	30-025-20298	G-15-24S-37E	36	40.7	38.5	1291

Pool: Fowler; Ellenburger (26410): Lease #NMLC 032450B (Schedule D)

WELL NAME	API NO.	LOCATION	BOPD	GRAVITY	MSCFPD	BTU
SOUTH MATTIX #25	30-025-20298	G-15-24S-37E	3.7	40.7	7.4	1291

PA# NM 71037D

Pool: Fowler; Upper Yeso (26680): Lease #NMLC 032450A (5% Royalty)

WELL NAME	API NO.	LOCATION	BOPD	GRAVITY	MSCFPD	BTU
SOUTH MATTIX #2	30-025-11112	N-15-24S-37E	0.8	36.9	3.9	1141
SOUTH MATTIX #3	30-025-11196	B-22-24S-37E	0	36.9	3.6	1141
SOUTH MATTIX #6	30-025-11114	L-15-24S-37E	13.5	36.9	77.1	1141
SOUTH MATTIX #12	30-025-11203	P-22-24S-37E	2.4	36.9	0	1141
SOUTH MATTIX #13	30-025-11204	I-22-24S-37E	0	36.9	0	1141

Pool: Fowler; Upper Yeso (26680): Lease #NMLC 032450B (Schedule D)

WELL NAME	API NO.	LOCATION	BOPD	GRAVITY	MSCFPD	BTU
SOUTH MATTIX #20	30-025-21678	E-15-24S-37E	2	36.9	2.8	1141
SOUTH MATTIX #22	30-025-21922	C-15-24S-37E	2.6	36.9	39.2	1141
SOUTH MATTIX #27	30-025-25612	F-15-24S-37E	0.7	36.9	18.3	1141
SOUTH MATTIX #40	30-025-31475	K-15-24S-37E	0.8	36.9	63	1141

Pool: Fowler; Upper Yeso (26680): Lease #NMNM 0321613 (Schedule D)

WELL NAME	API NO.	LOCATION	BOPD	GRAVITY	MSCFPD	BTU
SOUTH MATTIX #9	30-025-11117	B-15-24S-37E	0	36.9	1.2	1141
SOUTH MATTIX #10	30-025-11118	H-15-24S-37E	5.5	36.9	64	1141
SOUTH MATTIX #30	30-025-25747	P-15-24S-37E	2	36.9	0	1141
SOUTH MATTIX #33	30-025-26095	G-15-24S-37E	2.2	36.9	5.7	1141

PA# NM 71037E

Pool: Fowler; Drinkard (26220): Lease #NMNM 0321613 (Schedule D)

WELL NAME	API NO.	LOCATION	BOPD	GRAVITY	MSCFPD	BTU
SOUTH MATTIX #37	30-025-26355	I-15-24S-37E	0	40.7	1.7	1291
SOUTH MATTIX #39	30-025-26598	G-15-24S-37E	0.7	40.7	0	1291

Pool: Fowler; Drinkard (26220): Lease #NMLC 060579 (5% Royalty)

WELL NAME	API NO.	LOCATION	BOPD	GRAVITY	MSCFPD	BTU
SOUTH MATTIX #15	30-025-20513	A-22-24S-37E	2.3	40.7	0	1291

A map is enclosed showing the Federal leases and well locations.

Oil & Gas metering:

The central tank battery is located on the South Mattix Unit located at Section 15, NWSE, T24S, R37E in Lea County, New Mexico.

Wells will be routed to one of two common three-phase production separators as shown in attached diagram. Oil production will flow to three common oil tanks after measurement and then be sent through a LACT meter (S/N *). Gas production is measured at the South Mattix Unit CTB through ETC Sales Meter (S/N 14203) and ETC Sales Meter (S/N 63238). Water production will be sent to Fowler SWD for disposal.

All wells will be tested at least quarterly for a minimum of 24 hours through three-phase test separator with meters for gas (S/N 2104796), oil (S/N 435289) and water (S/N 434677) or three-phase test separator with meters for gas (S/N 2101483), oil (S/N 363735) and water (S/N 576327) for allocation purposes.

All meters will be proven, as per API, NMOCD, and BLM specifications, when installed, once per month for the first 3 months (to establish a consistent repeatability factor), and then quarterly thereafter. The factor obtained will be used to allocate the production volumes.

This commingle will result in maximum ultimate economic recovery of oil and gas with minimum waste, as wells would otherwise have to be plugged.

Process and Flow Descriptions:

The flow of production is shown in detail on enclosed facility diagram and maps which show the lease boundaries, unit boundary, participating agreement boundaries, location of wells and central tank battery. The commingling of this production is the most effective means of producing the reserves.

Occidental Permian LTD understands the requested approval will not constitute the granting of any right-of-way or construction rights not granted by the lease instrument. These applications will be submitted separately for approval per NMOCD and BLM regulations.

After completion of facility modifications, OXY will provide BLM with an updated facility diagram.

Pursuant to Statewide rule 19.15.12.10(C)(4)(g) OXY USA INC requests the option to include additional pools or leases within the defined parameters set forth in the order for future additions.

The working interest, royalty interest and overriding royalty interest owners have been notified of this proposal by certified mail (see attached).

*Meter number will be submitted upon installation.

OCCIDENTAL PERMIAN LTD
SOUTH MATTOX UNIT FEDERAL BATTERY
802000570
SWNE S15, T24S, R37E
LEA COUNTY, NEW MEXICO

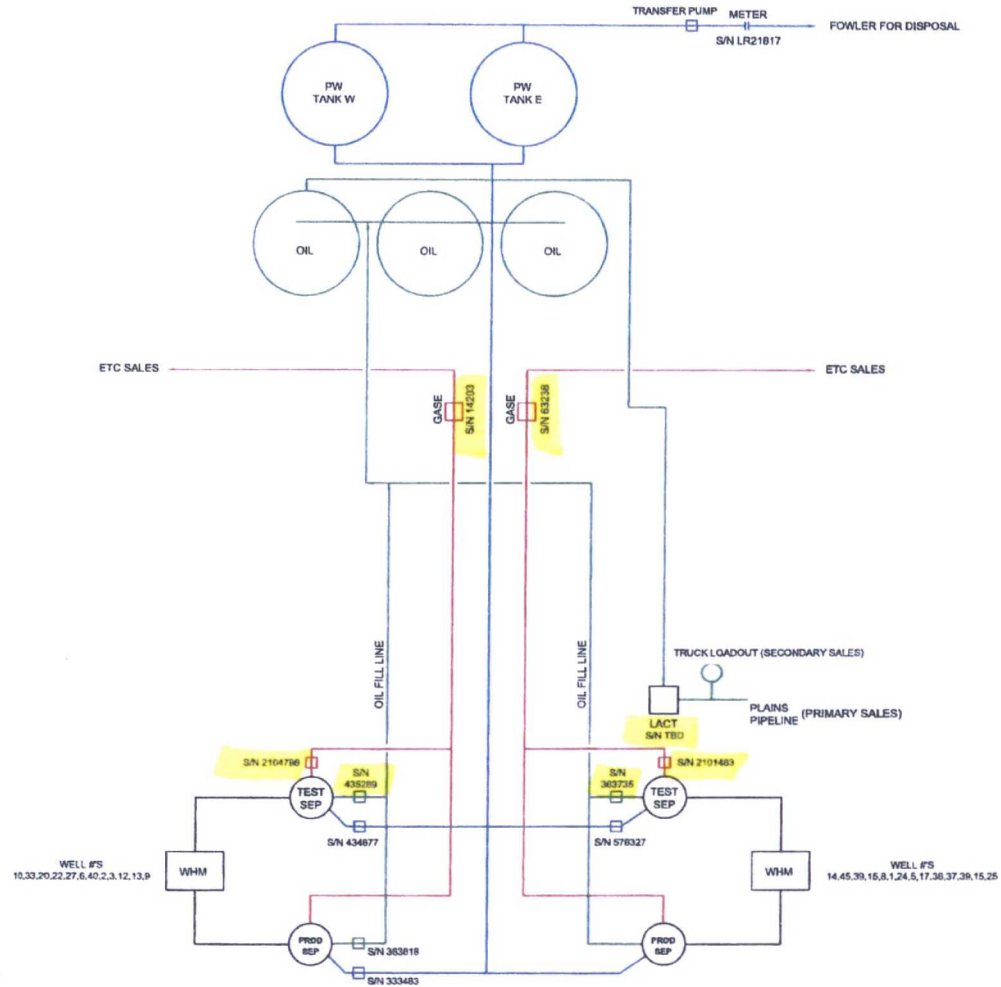

PROJECT DRAWING REVISION										MASTER DRAWING REVISION									
NO.	DATE	BY	REASON	CHANGED BY	DESCRIPTION	NO.	DATE	BY	REASON	CHANGED BY	DESCRIPTION	NO.	DATE	BY	REASON	CHANGED BY	DESCRIPTION	NO.	DATE
1	10-19-17	JN			DESIGNED FOR REVIEW	1						1						1	
IN CASE OF REVISIONS A MARKED UP PRINT SHALL BE SENT TO THE PROJECT ENGINEER										NOTES/REFERENCE DRAWINGS									

**LEASES ASSOCIATED WITH
SOUTH MATTIX UNIT**

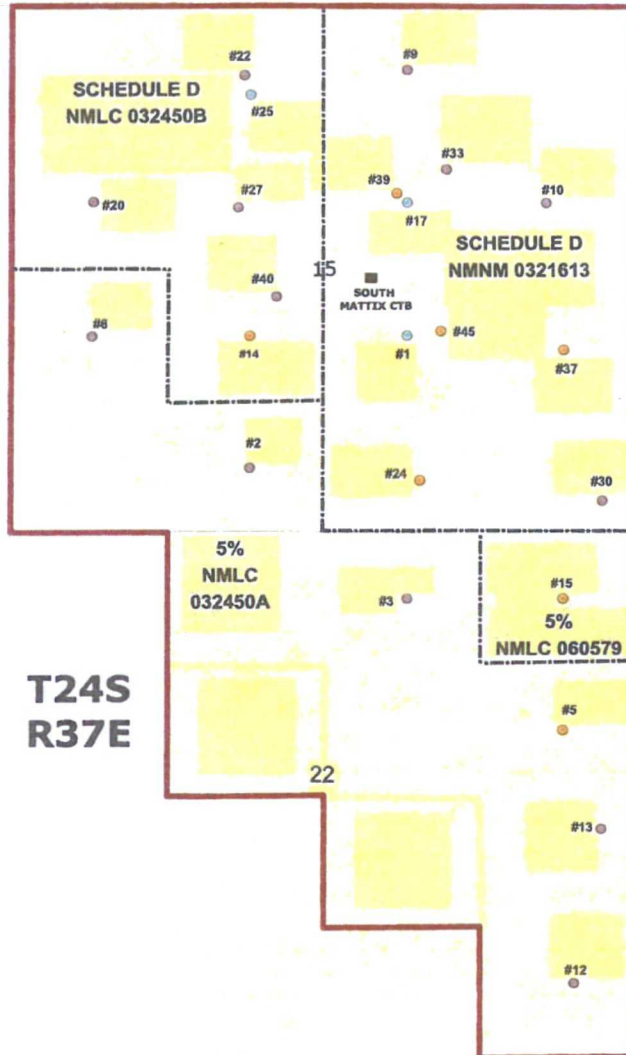

**T24S
R37E**

Occidental Petroleum
5 Greenway Plaza, Houston, TX 77046

South Mattix Unit Wells
Lea County, New Mexico

South Mattix Well

- Drinkard
- Ellenburger
- Upper Yeso

Land

- South Mattix Unit
- Federal Lease
- Oxy Lease

Copyright 2004 by Occidental Petroleum Corporation

SOUTH MATTIX UNIT
NMNM 71037X

UNIT BOUNDARY

T24S
R37E

16

15

14

21

22

23

Occidental Petroleum
5 Greenway Plaza, Houston, TX 77046

South Mattix Unit Wells
Lea County, New Mexico

South Mattix Well

-  Drinkard
-  Ellenburger
-  Upper Yaso

Land

-  South Mattix Unit
-  Federal Lease
-  Oxy Lease

Lea County, New Mexico
Map 1, 1998, 1:250,000

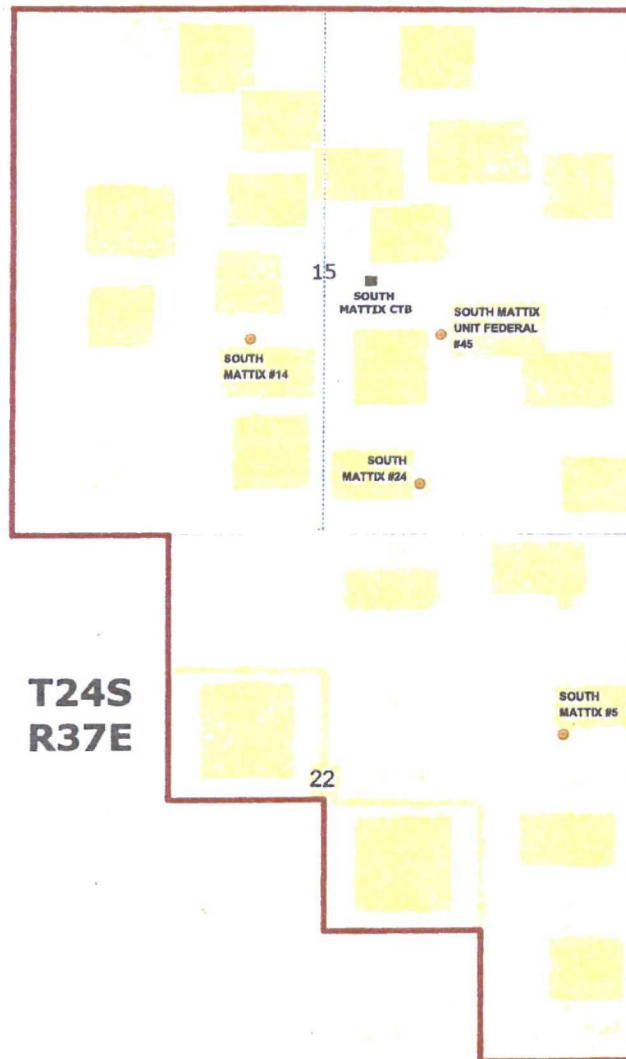

**SOUTH MATTIX UNIT
ELLENBURGER
PA# NM 71037A**

16

15

14

PA BOUNDARY

**T24S
R37E**

21

22

23

Occidental Petroleum
5 Greenway Plaza, Houston, TX 77040

South Mattix Unit Wells
Lea County, New Mexico

South Mattix Well

- Drinkard
- Ellenburger
- Upper Yeso

Land

- South Mattix Unit
- Federal Lease
- Oil Lease

Lea County, New Mexico, 1997
Map 1, 1/2" = 1 mile, 1/4" = 1/4 mile
Map 1, 1/2" = 1 mile, 1/4" = 1/4 mile

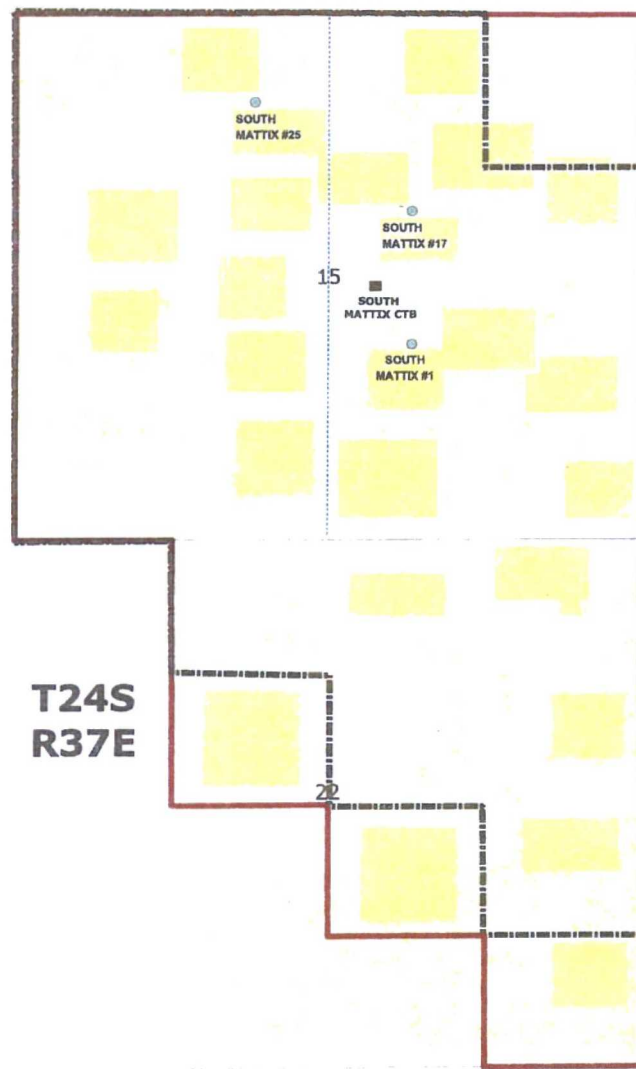

**SOUTH MATTIX UNIT
UPPER YESO
PA# NM 71037D**

PA BOUNDARY

**T24S
R37E**

16

14

21

23

15

22

SOUTH
MATTIX #22

SOUTH
MATTIX #9

SOUTH
MATTIX #33

SOUTH
MATTIX #10

SOUTH
MATTIX #20

SOUTH
MATTIX #27

SOUTH
MATTIX #40

SOUTH
MATTIX CTB

SOUTH
MATTIX #6

SOUTH
MATTIX #2

SOUTH
MATTIX #30

SOUTH MATTIX
#3

SOUTH MATTIX
#13

SOUTH
MATTIX #12

Occidental Petroleum
5 Greenway Plaza, Houston, TX 77046

South Mattix Unit Wells
Lea County, New Mexico

South Mattix Well

-  Drinkard
-  Blainburger
-  Upper Yeso

- Land**
-  South Mattix Unit
 -  Federal Lease
 -  Oxy Lease

UNRECORDED DEED NO. 873
APRIL 1, 1998
Pgs. 1, 2, 3, 4, 5, 6, 7, 8, 9, 10, 11, 12, 13, 14, 15, 16, 17, 18, 19, 20, 21, 22, 23, 24, 25, 26, 27, 28, 29, 30, 31, 32, 33, 34, 35, 36, 37, 38, 39, 40, 41, 42, 43, 44, 45, 46, 47, 48, 49, 50, 51, 52, 53, 54, 55, 56, 57, 58, 59, 60, 61, 62, 63, 64, 65, 66, 67, 68, 69, 70, 71, 72, 73, 74, 75, 76, 77, 78, 79, 80, 81, 82, 83, 84, 85, 86, 87, 88, 89, 90, 91, 92, 93, 94, 95, 96, 97, 98, 99, 100

**SOUTH MATTIX UNIT
DRINKARD
PA# NM 71037E**

16

14

15

PA BOUNDARY

**T24S
R37E**

21

22

23

Occidental Petroleum
5 Greenway Plaza, Houston, TX 77046

South Mattix Unit Wells
Lea County, New Mexico

South Mattix Well

-  Drinkard
-  Ellenburger
-  Upper Yeso

Land

-  South Mattix Unit
-  Federal Lease
-  Oxy Lease

Lea County, New Mexico
Map No. 71037E
PA# NM 71037E

**BUREAU OF LAND MANAGEMENT
CASE RECORDATION
(LIVE) SERIAL REGISTER PAGE**

Run Date/Time: 07/12/17 04:13 PM

Page 1 of 2

01 02-25-1920;041STAT0437;30USC181

Total Acres
1,000.000

Serial Number
NMNM-- - 071037X

Case Type 318210: O&G EXPLORATORY UNIT

Commodity 459: OIL & GAS

Case Disposition: AUTHORIZED Case File Juris:

Serial Number: NMNM-- - 071037X

Name & Address	Int Rel	%Interest
BLM ROSWELL FO 2909 W 2ND ST	ROSWELL NM 88201	OFFICE OF RECORD 0.00000000
BP AMERICA PRODUCTION CO PO BOX 3092	HOUSTON TX 772533092	OPERATOR 100.00000000

Serial Number: NMNM-- - 071037X

Mer Twp	Rng	Sec	SType	Nr Suff	Subdivision	District/Resource Area	County	Mgmt Agency
23	0240S	0370E	015	ALL	ENTIRE SECTION	CARLSBAD FIELD OFFICE	LEA	BUREAU OF LAND MGMT
23	0240S	0370E	022	ALIQ	NE,E2NW,N2SE,SESE;	CARLSBAD FIELD OFFICE	LEA	BUREAU OF LAND MGMT

Serial Number: NMNM-- - 071037X

Act Date	Code	Action	Action Remarks	Pending Office
01/26/1948	680	AGREEMENT FILED		
06/01/1948	334	AGRMT APPROVED		
06/01/1948	387	CASE ESTABLISHED	DESIGNATION RECEIVED	
06/01/1948	500	GEOGRAPHIC NAME	SOUTH MATTIX;	
06/01/1948	501	REFERENCE NUMBER	UA-I SEC 578;	
06/01/1948	515	REFERENCE NUMBER (AFS)	AFS-892000578X;	
06/01/1948	516	FORMATION	/B/	
06/01/1948	519	AGRMT/EXPANSION DESIG	AGREEMENT	
06/01/1948	526	ACRES-FED INT 100%	1000.00;100.00%	
06/01/1948	868	EFFECTIVE DATE	/A/ UNIT AGREEMENT	
05/06/1949	654	AGRMT PRODUCING	INT ELBG PA, #A	
10/01/1952	868	EFFECTIVE DATE	/C/2/ 1ST EXPANSION	
05/23/1953	580	PROPOSAL RECEIVED	/2/ EXPANSION	
01/04/1954	348	EXPANSION AGRMT APPV	/C/2/	
11/21/1960	664	PA EFFECTIVE	INT PDCK PA, #B	
08/31/1962	664	PA EFFECTIVE	INT TUBB PA, #C	
09/02/1962	664	PA EFFECTIVE	INT BLBR PA;	
12/03/1963	664	PA EFFECTIVE	INT LOWER PDCK PA;	
04/01/1971	664	PA EFFECTIVE	UPPER YESO PA, #D	
04/01/1971	972	CASES CONSOLIDATED	/C/ PA #D	
08/05/1979	664	PA EFFECTIVE	INT DRKD PA, #E	
04/16/1992	664	PA EFFECTIVE	INT FSLM PA, #F	
03/03/1994	421	PLAN OPER/EXPL/DEV FILED	/1/	
03/10/1994	422	PLAN OPER/EXPL/DEV APPV	/1/	
01/12/1995	974	AUTOMATED RECORD VERIF	MO/MO	
06/21/2002	940	NAME CHANGE RECOGNIZED	AMOCO/BP AMERICA PROD	

Line Nr Remarks

Serial Number: NMNM-- - 071037X

0002	/A/ EXHIBIT B EFFECTIVE 10/01/1952			
0003	LEASE SERIAL NO	TR#	STATUS	ACRES
0004	NMLC 0 32450A	1	FC	440.00

NO WARRANTY IS MADE BY BLM
FOR USE OF THE DATA FOR
PURPOSES NOT INTENDED BY BLM

BUREAU OF LAND MANAGEMENT
CASE RECORDATION
(LIVE) SERIAL REGISTER PAGE

Run Date/Time: 07/12/17 04:13 PM

Page 2 of 2

0005	NMLC	0 32450B ✓	2	FC	120.00
0006	NMLC	0 32450B ✓	2A	FC	80.00
0007	NMLC	0 60579 ✓	3	FC	40.00
0008	NMNM	0321613 ✓	4	FC	80.00
0009	NMNM	0321613 ✓	4A	FC	240.00
0010	/C/ 10/01/1952 160.00 ACRES				
0011	TR1, 24S, 37E, S22, SENW, NWSE, SESE				
0012	TR4, 24S, 37E, S15, NENE				
0013	/D/ THE BLINEBRY & LOWER PADDOCK PA'S WERE				
0014	CONSOLIDATED & DESIGNATED AS THE UPPER YESO PA				
0015	EFFECTIVE 04/01/1971				

NO WARRANTY IS MADE BY BLM
FOR USE OF THE DATA FOR
PURPOSES NOT INTENDED BY BLM

**BUREAU OF LAND MANAGEMENT
CASE RECORDATION
(LIVE) SERIAL REGISTER PAGE**

Run Date/Time: 07/20/17 08:58 AM

Page 1 of 2

01 02-25-1920;041STAT0437;30USC226

Total Acres
440.000

Serial Number
NMLC-- 0 032450A

Case Type 311111: O&G LSE NONCOMP PUB LAND

Commodity 459: OIL & GAS

Case Disposition: AUTHORIZED Case File Juris:

Serial Number: NMLC-- 0 032450A

Name & Address	Int Rel	%Interest
OCCIDENTAL PERMIAN LP 5 E GREENWAY PLAZA #110 HOUSTON TX 770460521	LESSEE	100.000000000

Mer Twp	Rng	Sec	SType	Nr Suff	Subdivision	District/Resource Area	County	Mgmt Agency
23	0240S	0370E	015		ALIQU	W2SW,SESW;	CARLSBAD FIELD OFFICE	LEA BUREAU OF LAND MGMT
23	0240S	0370E	015		FF	ALL FORMATIONS;	CARLSBAD FIELD OFFICE	LEA BUREAU OF LAND MGMT
23	0240S	0370E	022		ALIQU	W2NE,SENE,NENW,NESE;	CARLSBAD FIELD OFFICE	LEA BUREAU OF LAND MGMT
23	0240S	0370E	022	01	FF	ALL FORMATIONS;	CARLSBAD FIELD OFFICE	LEA BUREAU OF LAND MGMT
23	0240S	0370E	022	02	FF	SENV,NWSE,SESE,ALL;	CARLSBAD FIELD OFFICE	LEA BUREAU OF LAND MGMT
23	0240S	0370E	022	03	FF	FORMATIONS EXCEPT SEVEN;	CARLSBAD FIELD OFFICE	LEA BUREAU OF LAND MGMT
23	0240S	0370E	022	04	FF	RIVERS QUEEN INTERVAL;	CARLSBAD FIELD OFFICE	LEA BUREAU OF LAND MGMT

Serial Number: NMLC 0032450A

Relinquished/Withdrawn Lands

23	0240S	0370E	722	01	FF	NENE ASGN;	CARLSBAD FIELD OFFICE	LEA BUREAU OF LAND MGMT
23	0240S	0370E	722	02	FF	E2SW,SWSE,SEGR;	CARLSBAD FIELD OFFICE	LEA BUREAU OF LAND MGMT
23	0240S	0370E	722	03	FF	NWSE,SENV,SESE SEGR;	CARLSBAD FIELD OFFICE	LEA BUREAU OF LAND MGMT
23	0240S	0370E	722	04	FF	SEVEN RIVERS INTERVAL AS;	CARLSBAD FIELD OFFICE	LEA BUREAU OF LAND MGMT
23	0240S	0370E	722	05	FF	IDENTIFIED BY SEC 2F OF;	CARLSBAD FIELD OFFICE	LEA BUREAU OF LAND MGMT
23	0240S	0370E	722	06	FF	THE CORTLAND MEYERS UA;	CARLSBAD FIELD OFFICE	LEA BUREAU OF LAND MGMT

Serial Number: NMLC-- 0 032450A

Act Date	Code	Action	Action Remarks	Pending Office
06/17/1926	124	APLN RECD		
07/09/1937	237	LEASE ISSUED		
07/09/1937	496	FUND CODE	05;145003	
07/09/1937	535	RLTY RATE - 5%		
07/09/1937	868	EFFECTIVE DATE		
11/01/1941	570	CASE SEGREGATED BY ASGN	INTO NMLC060579:	
06/01/1948	232	LEASE COMMITTED TO UNIT	NMNM71037;S MATTIX UA	
06/01/1948	651	HELD BY PROD - ALLOCATED	I-SEC 578	
06/01/1948	660	MEMO OF 1ST PROD-ALLOC	I-SEC 578	
11/15/1956	102	NOTICE SENT-PROD STATUS		
07/17/1957	700	LEASE SEGREGATED	INTO NMNM036249;	
07/31/1968	700	LEASE SEGREGATED	INTO NMNM7729;	
03/19/1971	940	NAME CHANGE RECOGNIZED	PAN AMER PETRO/AMOCO	
06/01/1987	246	LEASE COMMITTED TO CA	NMNM88493;	
06/08/1987	963	CASE MICROFILMED/SCANNED	CNUM 103,014 DS	
07/28/1988	974	AUTOMATED RECORD VERIF	AR/RAYO	
10/01/1992	621	RLTY RED-STRIPPER WELL	4.5%;/1;/892000578C	
10/13/1992	522	CA TERMINATED	NMNM88493;	
01/19/1993	974	AUTOMATED RECORD VERIF	SSP/JS	
04/15/1993	974	AUTOMATED RECORD VERIF	GAG	
05/10/1993	974	AUTOMATED RECORD VERIF	SSP/JCV	
09/13/1993	625	RLTY REDUCTION APPV	/1/	
11/03/1993	974	AUTOMATED RECORD VERIF	JLV	
04/02/1997	140	ASGN FILED	AMOCO/ALTURA ENERGY	

**NO WARRANTY IS MADE BY BLM
FOR USE OF THE DATA FOR
PURPOSES NOT INTENDED BY BLM**

**BUREAU OF LAND MANAGEMENT
CASE RECORDATION
(LIVE) SERIAL REGISTER PAGE**

Run Date/Time: 07/20/17 09:03 AM

Page 1 of 2

01 02-25-1920;041STAT0437;30USC226

**Total Acres
200.000**

**Serial Number
NMLC-- 0 032450B**

Case Type 311111: O&G LSE NONCOMP PUB LAND

Commodity 459: OIL & GAS

Case Disposition: AUTHORIZED Case File Juris:

Serial Number: NMLC-- 0 032450B

Name & Address			Int Rel	%Interest
BRILLE INSTITUTE	741 N VERMONT AVE	LOS ANGELES CA 90029	LESSEE	20.044760000
EV PROPERTIES LP	1001 FANNIN ST STE 800	HOUSTON TX 770026700	OPERATING RIGHTS	0.000000000
HARTMAN DOYLE	PO BOX 10426	MIDLAND TX 79702	OPERATING RIGHTS	0.000000000
HUGHES CLIFFORD B	10898 4TH AVE	HESPERIA CA 92345	LESSEE	0.061910000
HUGHES WARREN B	543 N KENTER AVE	LOS ANGELES CA 90024	LESSEE	3.095240000
HUGHES-MYERS ANNE	333 S HOPE ST	LOS ANGELES CA 90017	LESSEE	13.333330000
M MCKENZIE TRUST	5190 CAMPUS DR	NEWPORT BEACH CA 92660	LESSEE	4.122860000
MESERVE EDWIN A	307 LA RAMBLA	SAN CLEMENTE CA 92672	LESSEE	8.765720000
MESERVE J ROBERT	5190 CAMPUS DR	NEWPORT BEACH CA 92660	LESSEE	8.778090000
MUMPER-HEWLINGS TRST	BOX 419	PASADENA CA 91102	LESSEE	9.285710000
OCCIDENTAL PERMIAN LP	5 E GREENWAY PLAZA #110	HOUSTON TX 770460521	OPERATING RIGHTS	0.000000000
PLANTATION OPERATING LLC	2203 TIMBERLOCH PL #229	THE WOODLANDS TX 77380	OPERATING RIGHTS	0.000000000
PLANTATION PETRO ACQ LLC	2203 TIMBERLOCH PL STE 229	THE WOODLANDS TX 773801188	OPERATING RIGHTS	0.000000000
QUANAH EXPLORATION LP	201 W WALL #600	MIDLAND TX 79701	OPERATING RIGHTS	0.000000000
ROBERTSON BALDWIN	6815 SELKIRK DR	BETHESDA MD 20817	LESSEE	3.095240000
ROBERTSON F CAROLINE	17242 HERRADURA	PAC PALISADES CA 90272	LESSEE	3.095240000
SARAH B HUGHES TRUST	2525 OCEAN BLVD #6A	CORONA DEL MAR CA 92625	LESSEE	3.033330000
VIRO & CO	225 E COLORADO BLVD	PASADENA CA 91101	LESSEE	23.288570000

Serial Number: NMLC-- 0 032450B

Mer Twp	Rng	Sec	SType	Nr Suff	Subdivision	District/Resource Area	County	Mgmt Agency
23	0240S	0370E	015	ALIQ	NW,NESW;	CARLSBAD FIELD OFFICE	LEA	BUREAU OF LAND MGMT

Serial Number: NMLC 0032450B

Relinquished/Withdrawn Lands

23 0240S 0370E 704	FF	S2,SEGR;	CARLSBAD FIELD OFFICE	LEA	BUREAU OF LAND MGMT
23 0240S 0370E 705	FF	01 L3,4,SEGR;	CARLSBAD FIELD OFFICE	LEA	BUREAU OF LAND MGMT
23 0240S 0370E 705	FF	02 S2NW,SW,SEGR;	CARLSBAD FIELD OFFICE	LEA	BUREAU OF LAND MGMT
23 0240S 0370E 706	FF	01 L1,2,SEGR;	CARLSBAD FIELD OFFICE	LEA	BUREAU OF LAND MGMT
23 0240S 0370E 706	FF	02 S2NE,SE,SEGR;	CARLSBAD FIELD OFFICE	LEA	BUREAU OF LAND MGMT
23 0240S 0370E 707	FF	01 L1,2,SEGR;	CARLSBAD FIELD OFFICE	LEA	BUREAU OF LAND MGMT
23 0240S 0370E 707	FF	02 E2NW,NE,SEGR;	CARLSBAD FIELD OFFICE	LEA	BUREAU OF LAND MGMT
23 0240S 0370E 709	FF	S2,SEGR;	CARLSBAD FIELD OFFICE	LEA	BUREAU OF LAND MGMT
23 0240S 0370E 721	FF	W2NW,SEGR;	CARLSBAD FIELD OFFICE	LEA	BUREAU OF LAND MGMT

Serial Number: NMLC-- 0 032450B

Act Date	Code	Action	Action Remarks	Pending Office
06/17/1926	124	APLN RECD		
07/09/1937	237	LEASE ISSUED		
07/09/1937	496	FUND CODE	05;145003	
07/09/1937	534	RLTY RATE-SLIDING-SCH D		
07/09/1937	868	EFFECTIVE DATE		
06/01/1948	232	LEASE COMMITTED TO UNIT	NMNM71037;S MATTIX	
07/01/1957	700	LEASE SEGREGATED	INTO NMNM037667;	
10/02/1957	651	HELD BY PROD - ALLOCATED	BP	
10/02/1957	660	MEMO OF 1ST PROD-ALLOC		
03/19/1971	940	NAME CHANGE RECOGNIZED	PAN AMER PETRO/AMOCO	
02/04/1985	140	ASGN FILED		

**NO WARRANTY IS MADE BY BLM
FOR USE OF THE DATA FOR
PURPOSES NOT INTENDED BY BLM**

**BUREAU OF LAND MANAGEMENT
CASE RECORDATION
(LIVE) SERIAL REGISTER PAGE**

Run Date/Time: 07/20/17 09:07 AM

Page 1 of 2

01 02-25-1920;041STAT0437;30USC226

Total Acres

Serial Number

Case Type 311111: O&G LSE NONCOMP PUB LAND

40.000

NMLC-- 0 060579

Commodity 459: OIL & GAS

Case Disposition: AUTHORIZED Case File Juris:

Serial Number: NMLC-- 0 060579

Name & Address			Int Rel	%Interest
BP AMERICA PRODUCTION CO	PO BOX 3092	HOUSTON TX 772533092	OPERATING RIGHTS	0.000000000
CONOCOPHILLIPS CO	PO BOX 7500	BARTLESVILLE OK 740057500	LESSEE	50.000000000
OCCIDENTAL PERMIAN LP	5 E GREENWAY PLAZA #110	HOUSTON TX 770460521	OPERATING RIGHTS	0.000000000
OCCIDENTAL PERMIAN LP	5 E GREENWAY PLAZA #110	HOUSTON TX 770460521	LESSEE	50.000000000
PIONEER NATURAL RES USA INC	1401 17TH ST #1200	DENVER CO 80202	OPERATING RIGHTS	0.000000000

Serial Number: NMLC-- 0 060579

Mer Twp	Rng	Sec	SType	Nr Suff	Subdivision	District/Resource Area	County	Mgmt Agency
23	0240S	0370E	022	ALIQ	NENE;	CARLSBAD FIELD OFFICE	LEA	BUREAU OF LAND MGMT

Serial Number: NMLC-- 0 060579

Act Date	Code	Action	Action Remarks	Pending Office
07/09/1937	387	CASE ESTABLISHED		
07/09/1937	535	RLTY RATE - 5%		
07/09/1937	868	EFFECTIVE DATE		
07/09/1939	496	FUND CODE	05;145003	
09/29/1942	553	CASE CREATED BY ASGN	OUT OF NMLC032450-A;	
06/01/1948	232	LEASE COMMITTED TO UNIT	NMNM71037X;S MATTIX	
06/01/1948	651	HELD BY PROD - ALLOCATED	I-SEC 578	
06/01/1948	660	MEMO OF 1ST PROD-ALLOC	I-SEC 578	
11/19/1956	102	NOTICE SENT-PROD STATUS		
10/24/1979	940	NAME CHANGE RECOGNIZED	CONTL OIL/CONOCO INC	
06/01/1987	246	LEASE COMMITTED TO CA	NMNM88493;	
06/18/1987	963	CASE MICROFILMED/SCANNED	CNUM 103,674 NAT	
01/06/1988	932	TRF OPER RGTS FILED	(1)	
01/06/1988	932	TRF OPER RGTS FILED	(2)	
03/09/1988	932	TRF OPER RGTS FILED		
03/14/1988	933	TRF OPER RGTS APPROVED	(1)EFF 02/01/88;	
03/14/1988	933	TRF OPER RGTS APPROVED	(2)EFF 02/01/88;	
05/17/1988	933	TRF OPER RGTS APPROVED	EFF 04/01/88;	
11/16/1988	140	ASGN FILED	TENNECO OIL/TOC-GULF	
12/05/1988	139	ASGN APPROVED	EFF 12/01/88;	
08/08/1989	140	ASGN FILED	TOCGULF/FINA OIL&CHEM	
08/29/1989	139	ASGN APPROVED	EFF 09/01/89;	
09/14/1989	140	ASGN FILED	TOC-GULF COAST/AMOCO	
10/10/1989	269	ASGN DENIED	TOC-GULF COAST/AMOCO	
01/08/1990	140	ASGN FILED	FINA OIL/AMOCO PROD	
03/10/1990	139	ASGN APPROVED	EFF 02/01/90;	
07/31/1991	932	TRF OPER RGTS FILED	CONOCO/AMOCO	
09/24/1991	933	TRF OPER RGTS APPROVED	EFF 08/01/91;	
10/01/1992	621	RLTY RED-STRIPPER WELL	4.5%/1;/892000578C	

NO WARRANTY IS MADE BY BLM
FOR USE OF THE DATA FOR
PURPOSES NOT INTENDED BY BLM

**BUREAU OF LAND MANAGEMENT
CASE RECORDATION
(LIVE) SERIAL REGISTER PAGE**

Run Date/Time: 07/20/17 09:11 AM

Page 1 of 7

01 02-25-1920;041STAT0437;30USC226

Case Type 310771: O&G EXCHANGE LEASE - PD

Commodity 459: OIL & GAS

Case Disposition: AUTHORIZED Case File Juris:

**Total Acres
1,280.000**

**Serial Number
NMNM-- 0 321613**

Serial Number: NMNM-- 0 321613

Name & Address			Int Rel	%Interest
ANADARKO PETRO CORP	PO BOX 1330	HOUSTON TX 772511330	OPERATING RIGHTS	0.000000000
APACHE CORP	2000 POST OAK BLVD STE 100	HOUSTON TX 770564400	OPERATING RIGHTS	0.000000000
BALK OIL CO INC	PO BOX 5782	MIDLAND TX 79704	OPERATING RIGHTS	0.000000000
BOLGER PERRY	414 W TEXAS #401	MIDLAND TX 79701	OPERATING RIGHTS	0.000000000
BRANUM M W	PO BOX 10646	MIDLAND TX 79702	OPERATING RIGHTS	0.000000000
BURLINGTON RES OG LP PTRRC	3401 E 30TH ST	FARMINGTON NM 874028807	OPERATING RIGHTS	0.000000000
BURLINGTON RES OIL & GAS CO LP	PO BOX 51810	MIDLAND TX 797101810	OPERATING RIGHTS	0.000000000
CHRISTENSEN MARCELLA	PO BOX 3790	MIDLAND TX 79702	OPERATING RIGHTS	0.000000000
CONOCOPHILLIPS CO	PO BOX 7500	BARTLESVILLE OK 740057500	OPERATING RIGHTS	0.000000000
CROSS TIMBERS ENERGY LLC	400 W 7TH ST	FORT WORTH TX 761024701	OPERATING RIGHTS	0.000000000
DAVIDSON JAMES A	PO BOX 494	MIDLAND TX 79702	OPERATING RIGHTS	0.000000000
DOYLE HARTMAN OIL OPERATOR	500 N MAIN	MIDLAND TX 79701	OPERATING RIGHTS	0.000000000
EV PROPERTIES LP	1001 FANNIN ST STE 800	HOUSTON TX 770026700	OPERATING RIGHTS	0.000000000
FLORENCE MAYO ESTATE	2915 HARDY ST	SHREVEPORT LA 71109	LESSEE	20.000000000
HARTMAN DOYLE	500 N MAIN	MIDLAND TX 79701	OPERATING RIGHTS	0.000000000
HARTMAN DOYLE	PO BOX 10426	MIDLAND TX 79702	OPERATING RIGHTS	0.000000000
HOLCOMB H R	300 W TEXAS #533	MIDLAND TX 79701	OPERATING RIGHTS	0.000000000
HUNT CIMARRON LP	PO BOX 1592	ROSWELL NM 882021592	OPERATING RIGHTS	0.000000000
HURT INTERESTS	PO BOX 1973	MIDLAND TX 79702	OPERATING RIGHTS	0.000000000
JACK ABNER M	GENERAL DELIVERY	SCOوبا MS 39358	LESSEE	20.000000000
JACK GUY JR ESTATE	1952 14TH AVE	MERIDIAN MS 39301	LESSEE	20.000000000
JACK HOWARD B	60 BROOKFIELD LN	RAMSEY NJ 07446	LESSEE	20.000000000
JOHN H HENDRIX CORP	PO BOX 3040	MIDLAND TX 797023040	OPERATING RIGHTS	0.000000000
MCDONNOLD OPER INC	505 N BIG SP #204	MIDLAND TX 79704	OPERATING RIGHTS	0.000000000
MELROSE RESOURCES	1635 NE LOOP 410 206	SAN ANTONIO TX 75209	OPERATING RIGHTS	0.000000000
MS BAPTIST FOUND	PO BOX 530	JACKSON MS 39205	LESSEE	20.000000000
MYERS PARTNERS INC	PO BOX 3531	MIDLAND TX 79702	OPERATING RIGHTS	0.000000000
OCCIDENTAL PERMIAN LP	5 E GREENWAY PLAZA #110	HOUSTON TX 770460521	OPERATING RIGHTS	0.000000000
OXY USA INC	PO BOX 50250	MIDLAND TX 79710	OPERATING RIGHTS	0.000000000
OXY USA WTP LP	6 DESTA DR #6000	MIDLAND TX 797055505	OPERATING RIGHTS	0.000000000
PARTNERS LONGHORN	PO BOX 1973	MIDLAND TX 79702	OPERATING RIGHTS	0.000000000
PEVEHOUSE INC	4305 N GARFIELD #203	MIDLAND TX 79705	OPERATING RIGHTS	0.000000000
PLANTATION OPERATING LLC	2203 TIMBERLOCH PL #229	THE WOODLANDS TX 77380	OPERATING RIGHTS	0.000000000
PLANTATION PETRO ACQ LLC	2203 TIMBERLOCH PL STE 229	THE WOODLANDS TX 773801188	OPERATING RIGHTS	0.000000000
PRIMAL ENERGY CORP	21021 SPRINGBROOK PLZ DR #160	SPRING TX 77379	OPERATING RIGHTS	0.000000000
ROVER OPERATING LLC	17304 PRESTON RD STE 740	DALLAS TX 752524645	OPERATING RIGHTS	0.000000000
SANTA FE PROD CO	BOX 10392	MIDLAND TX 79702	OPERATING RIGHTS	0.000000000
SIRGO BROTHERS INC	BOX 3531	MIDLAND TX 79702	OPERATING RIGHTS	0.000000000
SOGO III LLC	310 W WALL ST STE 1000	MIDLAND TX 797015189	OPERATING RIGHTS	0.000000000
SPECIAL ENERGY CORP	PO BOX 369	STILLWATER OK 740760369	OPERATING RIGHTS	0.000000000
TAHOE ENERGY INC	3909 W INDUSTRIAL	MIDLAND TX 797063128	OPERATING RIGHTS	0.000000000
TAHOE OIL & CATTLE	4402 W INDUSTRIAL	MIDLAND TX 79703	OPERATING RIGHTS	0.000000000
ZPZ DELAWARE I LLC	2000 POST OAK BLVD STE 100	HOUSTON TX 770564497	OPERATING RIGHTS	0.000000000

Serial Number: NMNM-- 0 321613

Mer Twp	Rng	Sec	SType	Nr Suff	Subdivision	District/Resource Area	County	Mgmt Agency
23	0240S	0370E	008	ALIQ	NW;	CARLSBAD FIELD OFFICE	LEA	BUREAU OF LAND MGMT
23	0240S	0370E	015	ALIQ	E2;	CARLSBAD FIELD OFFICE	LEA	BUREAU OF LAND MGMT
23	0240S	0370E	017	ALIQ	N2;	CARLSBAD FIELD OFFICE	LEA	BUREAU OF LAND MGMT
23	0240S	0370E	026	ALIQ	NW,N2SW,SESW;	CARLSBAD FIELD OFFICE	LEA	BUREAU OF LAND MGMT
23	0240S	0370E	029	ALIQ	SESE;	CARLSBAD FIELD OFFICE	LEA	BUREAU OF LAND MGMT
23	0240S	0370E	030	ALIQ	NE;	CARLSBAD FIELD OFFICE	LEA	BUREAU OF LAND MGMT

Serial Number: NMNM 0321613

**NO WARRANTY IS MADE BY BLM
FOR USE OF THE DATA FOR
PURPOSES NOT INTENDED BY BLM**

**BUREAU OF LAND MANAGEMENT
CASE RECORDATION
(LIVE) SERIAL REGISTER PAGE**

Run Date/Time: 07/20/17 09:11 AM

Page 2 of 7

Relinquished/Withdrawn Lands

23 0240S 0370E 718	FF	01	L 3-4,SEGR;	CARLSBAD FIELD OFFICE	LEA	BUREAU OF LAND MGMT
23 0240S 0370E 718	FF	02	E2SW,SEGR;	CARLSBAD FIELD OFFICE	LEA	BUREAU OF LAND MGMT
23 0240S 0370E 719	FF	01	L 1-2,SEGR;	CARLSBAD FIELD OFFICE	LEA	BUREAU OF LAND MGMT
23 0240S 0370E 719	FF	02	E2NW,SEGR;	CARLSBAD FIELD OFFICE	LEA	BUREAU OF LAND MGMT

Serial Number: **NMNM-- 0 321613**

Act Date	Code	Action	Action Remarks	Pending Office
12/27/1937	387	CASE ESTABLISHED		
12/28/1937	496	FUND CODE	05;145003	
12/28/1937	651	HELD BY PROD - ALLOCATED	COOPER JAL	
12/28/1937	660	MEMO OF 1ST PROD-ALLOC	COOPER-JAL	
12/28/1937	868	EFFECTIVE DATE		
08/01/1962	534	RLTY RATE-SLIDING-SCH D	/A/	
08/01/1962	868	EFFECTIVE DATE		
10/01/1962	209	CASE CREATED BY SEGR	OUT OF NMLC032326;	
10/01/1962	658	MEMO OF 1ST PROD-ACTUAL		
03/28/1963	102	NOTICE SENT-PROD STATUS		
10/19/1963	909	BOND ACCEPTED	EFF 09/27/63;ES0085	
08/10/1966	940	NAME CHANGE RECOGNIZED	ATL RFG/ATL RICHFIELD	
09/30/1970	700	LEASE SEGREGATED	INTO NMNM12612;	
03/19/1971	940	NAME CHANGE RECOGNIZED	PAN AMER PETRO/AMOCO	
10/24/1979	940	NAME CHANGE RECOGNIZED	CONTL OIL/CONOCO INC	
01/14/1982	140	ASGN FILED	LORTSCHER/TARLTON	
01/14/1982	140	ASGN FILED	M TARLTON/M TARLTON	
09/30/1982	940	NAME CHANGE RECOGNIZED	SUN OIL/SUN EXPL&PROD	
08/05/1983	269	ASGN DENIED	LORTSCHER/TARLTON	
08/05/1983	269	ASGN DENIED	TARLTON/TARLTON	
01/05/1984	932	TRF OPER RGTS FILED	(1)	
01/05/1984	932	TRF OPER RGTS FILED	(2)	
01/05/1984	932	TRF OPER RGTS FILED	(3)	
06/22/1984	933	TRF OPER RGTS APPROVED	(1)EFF 02/01/84;	
06/22/1984	933	TRF OPER RGTS APPROVED	(2)EFF 02/01/84;	
06/22/1984	933	TRF OPER RGTS APPROVED	(3)EFF 02/01/84;	
10/09/1984	932	TRF OPER RGTS FILED		
08/05/1985	932	TRF OPER RGTS FILED		
08/06/1985	932	TRF OPER RGTS FILED	(1)	
08/06/1985	932	TRF OPER RGTS FILED	(2)	SG
08/06/1985	933	TRF OPER RGTS APPROVED	EFF 09/01/85;	
08/06/1985	957	TRF OPER RGTS DENIED		
08/14/1985	909	BOND ACCEPTED	EFF 07/08/85;NM0303	
10/31/1985	933	TRF OPER RGTS APPROVED	(1)EFF 09/01/85;	
10/31/1985	933	TRF OPER RGTS APPROVED	(2)EFF 09/01/85;	
11/20/1985	963	CASE MICROFILMED/SCANNED	CNUM 554,507	AC
06/30/1986	932	TRF OPER RGTS FILED		
09/18/1986	933	TRF OPER RGTS APPROVED	EFF 07/01/86;	
02/23/1987	140	ASGN FILED	TAHOE OIL/GMK INC	
05/04/1987	269	ASGN DENIED	TAHOE OIL/GMK INC	
08/24/1988	974	AUTOMATED RECORD VERIF		JA/MIG
03/09/1989	932	TRF OPER RGTS FILED		
03/23/1989	932	TRF OPER RGTS FILED	(1)	

**NO WARRANTY IS MADE BY BLM
FOR USE OF THE DATA FOR
PURPOSES NOT INTENDED BY BLM**

**BUREAU OF LAND MANAGEMENT
CASE RECORDATION
(LIVE) SERIAL REGISTER PAGE**

Run Date/Time: 07/20/17 09:45 AM

Page 1 of 2

01 02-25-1920;041STAT0437;30USC181

Total Acres
840.000

Serial Number
NMNM-- - 071037A

Case Type 318230: O&G PARTICIPATING AREA

Commodity 459: OIL & GAS

Case Disposition: AUTHORIZED Case File Juris:

Serial Number: NMNM-- - 071037A

Name & Address	Int Rel	%Interest
BLM ROSWELL FO	2909 W 2ND ST	ROSWELL NM 88201
BP AMERICA PRODUCTION CO	PO BOX 3092	HOUSTON TX 772533092
		OFFICE OF RECORD
		OPERATOR
		0.00000000
		100.00000000

Serial Number: NMNM-- - 071037A

Mer Twp	Rng	Sec	SType	Nr Suff	Subdivision	District/Resource Area	County	Mgmt Agency
23	0240S	0370E	015	ALIQ	NWNE,S2NE,NW,S2;	CARLSBAD FIELD OFFICE	LEA	BUREAU OF LAND MGMT
23	0240S	0370E	022	ALIQ	NE,NENW,NESE;	CARLSBAD FIELD OFFICE	LEA	BUREAU OF LAND MGMT

Serial Number: NMNM-- - 071037A

Act Date	Code	Action	Action Remarks	Pending Office
05/06/1949	387	CASE ESTABLISHED		
05/06/1949	500	GEOGRAPHIC NAME	INT ELLENBURGER PA A;	
05/06/1949	500	GEOGRAPHIC NAME	UA-SOUTH MATTIX	
05/06/1949	515	REFERENCE NUMBER (AFS)	AFS-8910005780;	
05/06/1949	868	EFFECTIVE DATE	/A/1/	
06/16/1949	595	WELL DETERMINED PAYING	/1/ LC032326B,1	
08/15/1949	580	PROPOSAL RECEIVED	/1/ INITIAL	
09/30/1949	665	PA APPROVED	/1/	
04/01/1950	664	PA EFFECTIVE	/B/2/ 1ST REV	
08/10/1950	668	PA REVISION/CONSOL APPV	/2/ 1ST REV	
01/01/1951	664	PA EFFECTIVE	/C/3/ 2ND REV	
01/01/1952	664	PA EFFECTIVE	/D/4/ 3RD REV	
05/01/1952	664	PA EFFECTIVE	/E/5/ 4TH REV	
05/13/1952	668	PA REVISION/CONSOL APPV	/3/ 2ND REV	
05/13/1952	668	PA REVISION/CONSOL APPV	/4/ 3RD REV	
10/01/1952	664	PA EFFECTIVE	/F/6/ 5TH REV	
10/28/1952	580	PROPOSAL RECEIVED	/6/ 5TH REV	
04/24/1953	595	WELL DETERMINED PAYING	/6/ LC032450B,7	
04/24/1953	668	PA REVISION/CONSOL APPV	/5/ 4TH REV	
04/24/1953	668	PA REVISION/CONSOL APPV	/6/ 5TH REV	
02/14/1995	974	AUTOMATED RECORD VERIF	MO/MO	
06/21/2002	940	NAME CHANGE RECOGNIZED	AMOCO/BP AMERICA PROD	

Line Nr Remarks

Serial Number: NMNM-- - 071037A

Line Nr	Remarks	TR#	STATUS	ACRES	PERCENT
0002	/A/ PA ALLOCATION EFFECTIVE 10/01/1952				
0003	LEASE SERIAL NO				
0004	NMLC 0 32450B	1	FC	200.00	23.8100
0005	NMLC 0 32450A	2	FC	320.00	38.1000
0006	NMLC 0 321613B	3	FC	280.00	33.3300
0007	NMLC 0 60579	4	FC	40.00	4.7600
0008	TOTAL			840.00	100.0000

**NO WARRANTY IS MADE BY BLM
FOR USE OF THE DATA FOR
PURPOSES NOT INTENDED BY BLM**

BUREAU OF LAND MANAGEMENT
CASE RECORDATION
(LIVE) SERIAL REGISTER PAGE

Run Date/Time: 07/20/17 09:45 AM

Page 2 of 2

0009	TR1, 24S, 37E, S15, NW, NESW
0010	TR2, 24S, 37E, S15, W2SW, SESW, S22, NWN, S2NE, NENW, NESE
0011	TR3, 24S, 37E, S15, NWN, S2NE, SE
0012	TR4, 24S, 37E, S22, NENE

NO WARRANTY IS MADE BY BLM
FOR USE OF THE DATA FOR
PURPOSES NOT INTENDED BY BLM

**BUREAU OF LAND MANAGEMENT
CASE RECORDATION
(LIVE) SERIAL REGISTER PAGE**

Run Date/Time: 07/20/17 08:48 AM

Page 1 of 2

01 02-25-1920;041STAT0437;30USC181

Total Acres

Serial Number

Case Type 318230: O&G PARTICIPATING AREA

1,000.000

NMNM-- - 071037D

Commodity 459: OIL & GAS

Case Disposition: PENDING

Case File Juris:

Serial Number: NMNM-- - 071037D

Name & Address

Int Rel

%Interest

BLM ROSWELL FO	2909 W 2ND ST	ROSWELL NM 88201	OFFICE OF RECORD	0.000000000
BP AMERICA PRODUCTION CO	PO BOX 3092	HOUSTON TX 772533092	OPERATOR	100.000000000

Serial Number: NMNM-- - 071037D

Mer Twp	Rng	Sec	SType	Nr Suff	Subdivision	District/Resource Area	County	Mgmt Agency
23	0240S	0370E	015	ALL	ENTIRE SECTION	CARLSBAD FIELD OFFICE	LEA	BUREAU OF LAND MGMT
23	0240S	0370E	022	ALIQ	NE,E2NW,N2SE,SESE;	CARLSBAD FIELD OFFICE	LEA	BUREAU OF LAND MGMT

Serial Number: NMNM-- - 071037D

Act Date	Code	Action	Action Remarks	Pending Office
09/02/1962	387	CASE ESTABLISHED		
09/02/1962	500	GEOGRAPHIC NAME	INITIAL BLINEBRY PA;	
09/02/1962	500	GEOGRAPHIC NAME	UA-SOUTH MATTIX	
09/02/1962	868	EFFECTIVE DATE	/A/1/	
08/05/1963	580	PROPOSAL RECEIVED	/1/ INITIAL	
10/29/1963	665	PA APPROVED	/1/	
12/03/1963	387	CASE ESTABLISHED		
12/03/1963	500	GEOGRAPHIC NAME	INT LOWER PADDOCK PA;	
12/03/1963	500	GEOGRAPHIC NAME	UA-SOUTH MATTIX;	
12/03/1963	868	EFFECTIVE DATE	/B/2/	
08/30/1965	580	PROPOSAL RECEIVED	/2/ INITIAL	
10/26/1965	665	PA APPROVED	/2/	
02/26/1971	580	PROPOSAL RECEIVED	/3/ AMENDMT TO SEC 11	
03/10/1971	668	PA REVISION/CONSOL APPV	/C/3/ CONSOL, #D	
04/01/1971	387	CASE ESTABLISHED		
04/01/1971	500	GEOGRAPHIC NAME	UA-SOUTH MATTIX;	
04/01/1971	500	GEOGRAPHIC NAME	UPPER YESO PA;	
04/01/1971	972	CASES CONSOLIDATED	/3/	
06/21/2002	940	NAME CHANGE RECOGNIZED	AMOCO/BP AMERICA PROD	

Line Nr Remarks

Serial Number: NMNM-- - 071037D

0002	/A/ PA ALLOCATION EFFECTIVE 04/01/1971					
0003	LEASE SERIAL NO	TR#	STATUS	ACRES	PERCENT	
0004	NMLC 0 32450A	1	FC	440.00	44.0000	
0005	NMLC 0 32450B	2	FC	120.00	12.0000	
0006	NMLC 0 32450B	2A	FC	80.00	8.0000	
0007	NMLC 0 60579	3	FC	40.00	4.0000	
0008	NMNM 0321613	4	FC	80.00	8.0000	
0009	NMNM 0321613	4A	FC	240.00	24.0000	
0010	TOTAL			1000.00	100.0000	
0011	TR1,24S,37E,S15,W2SW,SESW,S22,W2NE,SENE,E2NW,N2SE,					
0012	SESE					

NO WARRANTY IS MADE BY BLM
FOR USE OF THE DATA FOR
PURPOSES NOT INTENDED BY BLM

**BUREAU OF LAND MANAGEMENT
CASE RECORDATION
(LIVE) SERIAL REGISTER PAGE**

Run Date/Time: 07/20/17 08:48 AM

Page 2 of 2

0013	TR2, 24S, 37E, S15, S2NW, NESW
0014	TR2A, 24S, 37E, S15, N2NW
0015	TR3, 24S, 37E, S22, NENE
0016	TR4, 24S, 37E, S15, W2SE
0017	TR4A, 24S, 37E, S15, NE, E2SE
0018	/3/ THE BLINEBRY AND LOWER PADDOCK PA'S WERE
0019	CONSOLIDATED AND DESIGNATED AS THE UPPER YESO
0020	(COMBINED) PA EFFECTIVE 04/01/1971

NO WARRANTY IS MADE BY BLM
FOR USE OF THE DATA FOR
PURPOSES NOT INTENDED BY BLM

**BUREAU OF LAND MANAGEMENT
CASE RECORDATION
(LIVE) SERIAL REGISTER PAGE**

Run Date/Time: 07/12/17 04:14 PM

Page 1 of 2

01 02-25-1920;041STAT0437;30USC181

Total Acres

Serial Number

Case Type 318230: O&G PARTICIPATING AREA

160.000

NMNM-- - 071037E

Commodity 459: OIL & GAS

Case Disposition: AUTHORIZED Case File Juris:

Serial Number: NMNM-- - 071037E

Name & Address	Int Rel	%Interest
BLM ROSWELL FO	ROSWELL NM 88201	OFFICE OF RECORD
BP AMERICA PRODUCTION CO	HOUSTON TX 772533092	OPERATOR
2909 W 2ND ST		0.000000000
PO BOX 3092		100.000000000

Serial Number: NMNM-- - 071037E

Mer Twp	Rng	Sec	SType	Nr Suff	Subdivision	District/Resource Area	County	Mgmt Agency
23	0240S	0370E	015	ALIQ	SWNE,E2SE;	CARLSBAD FIELD OFFICE	LEA	BUREAU OF LAND MGMT
23	0240S	0370E	022	ALIQ	NENE;	CARLSBAD FIELD OFFICE	LEA	BUREAU OF LAND MGMT

Serial Number: NMNM-- - 071037E

Act Date	Code	Action	Action Remarks	Pending Office
08/05/1979	387	CASE ESTABLISHED		
08/05/1979	500	GEOGRAPHIC NAME	INT DRINKARD PA E;	
08/05/1979	500	GEOGRAPHIC NAME	UA-SOUTH MATTIX;	
08/05/1979	515	REFERENCE NUMBER (AFS)	AFS892000578D;	
08/05/1979	868	EFFECTIVE DATE	/A/1/	
04/08/1980	664	PA EFFECTIVE	/B/2/ 1ST REV	
08/08/1980	580	PROPOSAL RECEIVED	/1/ INITIAL	
08/08/1980	580	PROPOSAL RECEIVED	/2/ 1ST REVISION	
10/22/1980	595	WELL DETERMINED PAYING	/1/ NMNM0321613,37	
10/22/1980	595	WELL DETERMINED PAYING	/2/ NMNM0321613,39	
10/22/1980	665	PA APPROVED	/1/	
10/22/1980	668	PA REVISION/CONSOL APPV	/2/ 1ST REVISION	
03/24/1995	974	AUTOMATED RECORD VERIF	MO/MO	
09/01/1999	868	EFFECTIVE DATE	/C/3/2ND REVISION;	
03/16/2000	595	WELL DETERMINED PAYING	NMNM0321613;8 SMU FED	
06/21/2002	940	NAME CHANGE RECOGNIZED	AMOCO/BP AMERICA PROD	
11/16/2006	595	WELL DETERMINED PAYING	NMLC060579;15 SMU FED	
01/15/2007	580	PROPOSAL RECEIVED	/3/2ND REVISION;	
05/21/2008	668	PA REVISION/CONSOL APPV	/3/2ND REVISION;	
05/22/2008	974	AUTOMATED RECORD VERIF	ACS;	

Line Nr Remarks Serial Number: NMNM-- - 071037E

0002	/A/ PA ALLOCATION EFFECTIVE 04/08/1980				
0003	LEASE SERIAL NO	TR#	STATUS	ACRES	PERCENT
0004	NMNM 0321613	4A	FC	80.00	100.0000
0006	TOTAL			80.00	100.0000
0007	TR4A,24S,37E,S15,NESE,SWNE				
0011	/C/2ND REVISION PA ALLOCATION EFFECTIVE 09/01/1999				
0012	LEASE SERIAL NO	TR#	STATUS	ACRES	PERCENT
0015	NMLC 060579	3	FC	40.00	25.0000
0016	NMNM 0321613	4A	FC	120.00	75.0000
0017	TOTAL			160.00	100.0000

NO WARRANTY IS MADE BY BLM
FOR USE OF THE DATA FOR
PURPOSES NOT INTENDED BY BLM

BUREAU OF LAND MANAGEMENT
CASE RECORDATION
(LIVE) SERIAL REGISTER PAGE

Run Date/Time: 07/12/17 04:14 PM

Page 2 of 2

0018	TR3, 24S, 37E, S22, NENE
0019	TR4A, 24S, 37E, S15, E2SE, SWNE

NO WARRANTY IS MADE BY BLM
FOR USE OF THE DATA FOR
PURPOSES NOT INTENDED BY BLM

DATE IN	SUSPENSE	ENGINEER	LOGGED IN	TYPE	APP NO
---------	----------	----------	-----------	------	--------

ABOVE THIS LINE FOR DIVISION USE ONLY

NEW MEXICO OIL CONSERVATION DIVISION

- Engineering Bureau -

1220 South St. Francis Drive, Santa Fe, NM 87505



ADMINISTRATIVE APPLICATION CHECKLIST

THIS CHECKLIST IS MANDATORY FOR ALL ADMINISTRATIVE APPLICATIONS FOR EXCEPTIONS TO DIVISION RULES AND REGULATIONS WHICH REQUIRE PROCESSING AT THE DIVISION LEVEL IN SANTA FE

Application Acronyms:

[NSL-Non-Standard Location] [NSP-Non-Standard Proration Unit] [SD-Simultaneous Dedication]
 [DHC-Downhole Commingling] [CTB-Lease Commingling] [PLC-Pool/Lease Commingling]
 [PC-Pool Commingling] [OLS - Off-Lease Storage] [OLM-Off-Lease Measurement]
 [WFX-Waterflood Expansion] [PMX-Pressure Maintenance Expansion]
 [SWD-Salt Water Disposal] [IPI-Injection Pressure Increase]
 [EOR-Qualified Enhanced Oil Recovery Certification] [PPR-Positive Production Response]

[1] TYPE OF APPLICATION - Check Those Which Apply for [A]

[A] Location - Spacing Unit - Simultaneous Dedication
☐ NSL ☐ NSP ☐ SD

Check One Only for [B] or [C]

[B] Commingling - Storage - Measurement
☐ DHC ☐ CTB ☒ PLC ☐ PC ☒ OLS ☒ OLM

[C] Injection - Disposal - Pressure Increase - Enhanced Oil Recovery
☐ WFX ☐ PMX ☐ SWD ☐ IPI ☐ EOR ☐ PPR

[D] Other: Specify _____

[2] NOTIFICATION REQUIRED TO: - Check Those Which Apply, or ☐ Does Not Apply

[A] ☒ Working, Royalty or Overriding Royalty Interest Owners

[B] ☐ Offset Operators, Leaseholders or Surface Owner

[C] ☐ Application is One Which Requires Published Legal Notice

[D] ☒ Notification and/or Concurrent Approval by BLM or SLO
U.S. Bureau of Land Management - Commissioner of Public Lands State Land Office

[E] ☒ For all of the above, Proof of Notification or Publication is Attached, and/or,

[F] ☐ Waivers are Attached

[3] SUBMIT ACCURATE AND COMPLETE INFORMATION REQUIRED TO PROCESS THE TYPE OF APPLICATION INDICATED ABOVE.

[4] **CERTIFICATION:** I hereby certify that the information submitted with this application for administrative approval is **accurate and complete** to the best of my knowledge. I also understand that **no action** will be taken on this application until the required information and notifications are submitted to the Division.

Note: Statement must be completed by an individual with managerial and/or supervisory capacity.

JUSTIN MORRIS

Print or Type Name

Signature

DRILLING ENGINEER

Title

01/24/2017

Date

JUSTIN_MORRIS@OXY.COM
 e-mail Address

District I
1625 N French Drive, Hobbs, NM 88240
District II
811 S First St., Artesia, NM 88210
District III
1000 Rio Brazos Road, Aztec, NM 87410
District IV
1220 S. St Francis Dr, Santa Fe, NM
87505

State of New Mexico
Energy, Minerals and Natural Resources Department

Form C-107-B
Revised August 1, 2011

OIL CONSERVATION DIVISION
1220 S. St Francis Drive
Santa Fe, New Mexico 87505

Submit the original
application to the Santa Fe
office with one copy to the
appropriate District Office.

APPLICATION FOR SURFACE COMMINGLING (DIVERSE OWNERSHIP)

OPERATOR NAME: Occidental Permian LTD (157984)

OPERATOR ADDRESS: PO BOX 4294, Houston, TX 77210

APPLICATION TYPE:

☐ Pool Commingling ☐ Lease Commingling ☒ Pool and Lease Commingling ☐ Off-Lease Storage and Measurement (Only if not Surface Commingling)

LEASE TYPE: ☐ Fee ☐ State ☒ Federal

Is this an Amendment to existing Order? ☐ Yes ☒ No If "Yes", please include the appropriate Order No. _____
Have the Bureau of Land Management (BLM) and State Land office (SLO) been notified in writing of the proposed commingling
☒ Yes ☐ No

(A) POOL COMMINGLING

Please attach sheets with the following information

(1) Pool Names and Codes	Gravities / BTU of Non-Commingled Production	Calculated Gravities / BTU of Commingled Production		Calculated Value of Commingled Production	Volumes
Please see attached spreadsheet					

- (2) Are any wells producing at top allowables? ☐ Yes ☒ No
(3) Has all interest owners been notified by certified mail of the proposed commingling? ☒ Yes ☐ No.
(4) Measurement type ☒ Metering ☐ Other (Specify)
(5) Will commingling decrease the value of production? ☐ Yes ☒ No If "yes", describe why commingling should be approved

(B) LEASE COMMINGLING

Please attach sheets with the following information

- (1) Pool Name and Code
(2) Is all production from same source of supply? ☐ Yes ☐ No
(3) Has all interest owners been notified by certified mail of the proposed commingling? ☒ Yes ☐ No
(4) Measurement type ☐ Metering ☐ Other (Specify)

(C) POOL and LEASE COMMINGLING

Please attach sheets with the following information

- (1) Complete Sections A and E

(D) OFF-LEASE STORAGE and MEASUREMENT

Please attached sheets with the following information

- (1) Is all production from same source of supply? ☐ Yes ☐ No
(2) Include proof of notice to all interest owners.

(E) ADDITIONAL INFORMATION (for all application types)

Please attach sheets with the following information

- (1) A schematic diagram of facility, including legal location
(2) A plat with lease boundaries showing all well and facility locations Include lease numbers if Federal or State lands are involved
(3) Lease Names, Lease and Well Numbers, and API Numbers

I hereby certify that the information above is true and complete to the best of my knowledge and belief

SIGNATURE _____ TITLE DRILLING ENGINEER DATE 01/24/2017

TYPE OR PRINT NAME JUSTIN MORRIS TELEPHONE NO. (713) 366-5249

E-MAIL ADDRESS JUSTIN_MORRIS@OXY.COM

**Bureau of Land Management
Carlsbad Field Office
620 East Greene Street
Carlsbad, New Mexico 88220
575-234-5972**

**South Mattix Unit NMNM71037X, South Mattix Unit Ellenburger PA# NMNM71037A
South Mattix Unit Upper Yeso PA# NMNM71037D, South Mattix Unit Drinkard PA# NMNM71037E**

Occidental Permian LTD

July 19, 2017

Condition of Approval

Surface Unit, PA & Pool commingling and off PA storage, measurement and sales

1. This approval is subject to like approval by the New Mexico Oil Conservation Division.
2. This agency shall be notified of any spill or discharge as required by NTL-3A.
3. This agency reserves the right to modify or rescind approval whenever it determines continued use of the approved method may adversely affect the surface or subsurface environments or product accountability.
4. This approval does not constitute right-of-way approval for any off-lease activities. Within 30 days, an application for right-of-way approval must be submitted to the Realty Section if not already done.
5. Approval for combining production from various sources is a privilege which is granted to lessees for the purpose of aiding conservation and extending the economic life of leases. Applicants should be cognizant that failure to operate in accordance with the provisions outlined in the Authorized Officer's conditions of approval and/or subsequent stipulations or modifications will subject such approval to revocation.
6. Gas measurement for allocation must be measured as per Federal Regulations, AGA and API requirements for sales meters.
7. All gas and oil subject to royalty shall be measured as per federal regulations and shall be reported to ONRR as required. All gas which is vented, flared or used on lease shall be reported as per 43 CFR 3178 & 3179 to ONRR. All gas which is vented or flared shall be subject to royalty, unless prior approval was given by the authorized officer.
8. This agency shall be notified of any change in sales method or location of sales point.
9. Additional wells and/or leases require additional commingling approvals.
10. Submit LACT meter number upon installation of meter and update facility diagram with meter number.
11. Notify this office 24 Hrs. prior to any meter calibration/proving to allow time for an inspector to witness.
12. If any wells are added to the South Mattix Unit or PAs, which allocate production to leases NMLC032450B and NMNM0321613, or if a well which is presently on one of the South Mattix Unit or PAs is not limited to recompleted, worked over, stimulated, fractured so as to enhance the recovery of production above a rate of 20 bbls per day per well. This approval will no-longer be valid until it has been reevaluated and the Royalty Rate is address as per the allocation of production determined to still fall within acceptable limits at which this approval is being approved.