

SECTION 18, TOWNSHIP 26 SOUTH, RANGE 34 EAST, N.M.P.M.
LEA COUNTY, STATE OF NEW MEXICO

SITE MAP

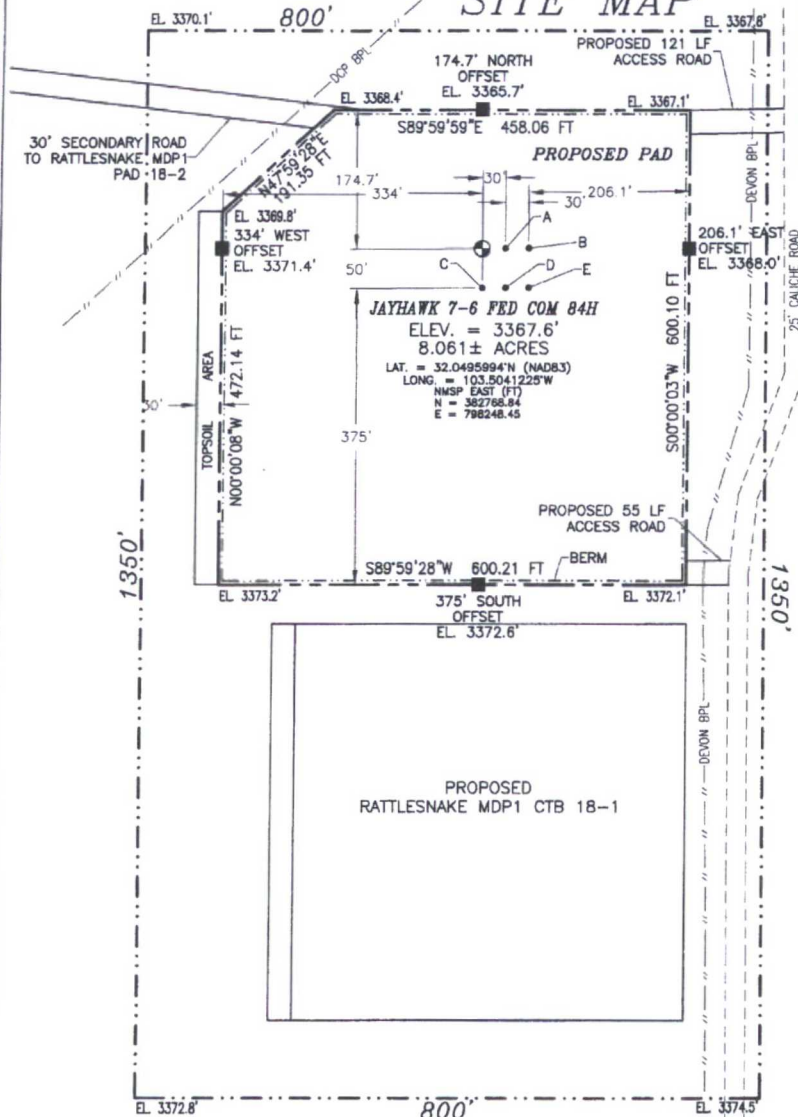

NOTE: LATITUDE AND LONGITUDE COORDINATES ARE SHOWN USING THE NORTH AMERICAN DATUM OF 1983 (NAD83) LISTED NEW MEXICO STATE PLANE EAST COORDINATES ARE GRID (NAD83). BASIS OF BEARING AND DISTANCES USED ARE NEW MEXICO STATE PLANE EAST COORDINATES MODIFIED TO THE SURFACE. VERTICAL DATUM NAVD88.

- A - JAYHAWK 7-6
FED COM 85H
- B - JAYHAWK 7-6
FED COM 86H
- C - FIGHTING OKRA
18-19 FED 84H
- D - FIGHTING OKRA
18-19 FED 85H
- E - FIGHTING OKRA
18-19 FED 86H



020 100 200 400
SCALE 1" = 200'

DIRECTIONS TO LOCATION

FROM STATE HIGHWAY 128 AND CR 2 (BATTLE AXE) GO SOUTH AND WEST ON CR 2 12.31 MILES, TURN LEFT ON CALICHE ROAD AND GO SOUTH 0.65 OF A MILE, TURN LEFT ON CALICHE PIPELINE ROAD AND GO EAST 1.81 MILES, TURN RIGHT AND GO SOUTH 1.07 MILES TO A PROPOSED ROAD SURVEY AND FOLLOW FLAGS WEST 121' TO THE PROPOSED NORTHEAST PAD CORNER FOR THIS LOCATION.

DEVON ENERGY PRODUCTION COMPANY, L.P.
JAYHAWK 7-6 FED COM 84H
LOCATED 400 FT. FROM THE NORTH LINE
AND 1140 FT. FROM THE EAST LINE OF
SECTION 18, TOWNSHIP 26 SOUTH,
RANGE 34 EAST, N.M.P.M.
LEA COUNTY, STATE OF NEW MEXICO

FEBRUARY 21, 2017

SURVEY NO. 4813B

MADRON SURVEYING, INC. 301 SOUTH CANAL (575) 234-3341 CARLSBAD, NEW MEXICO

NOT TO SCALE

MADRON SURVEYING, INC. 301 SOUTH CANAL (575) 234-3341 CARLSBAD, NEW MEXICO

SECTION 18, TOWNSHIP 26 SOUTH, RANGE 34 EAST, N.M.P.M.
LEA COUNTY, STATE OF NEW MEXICO
VICINITY MAP

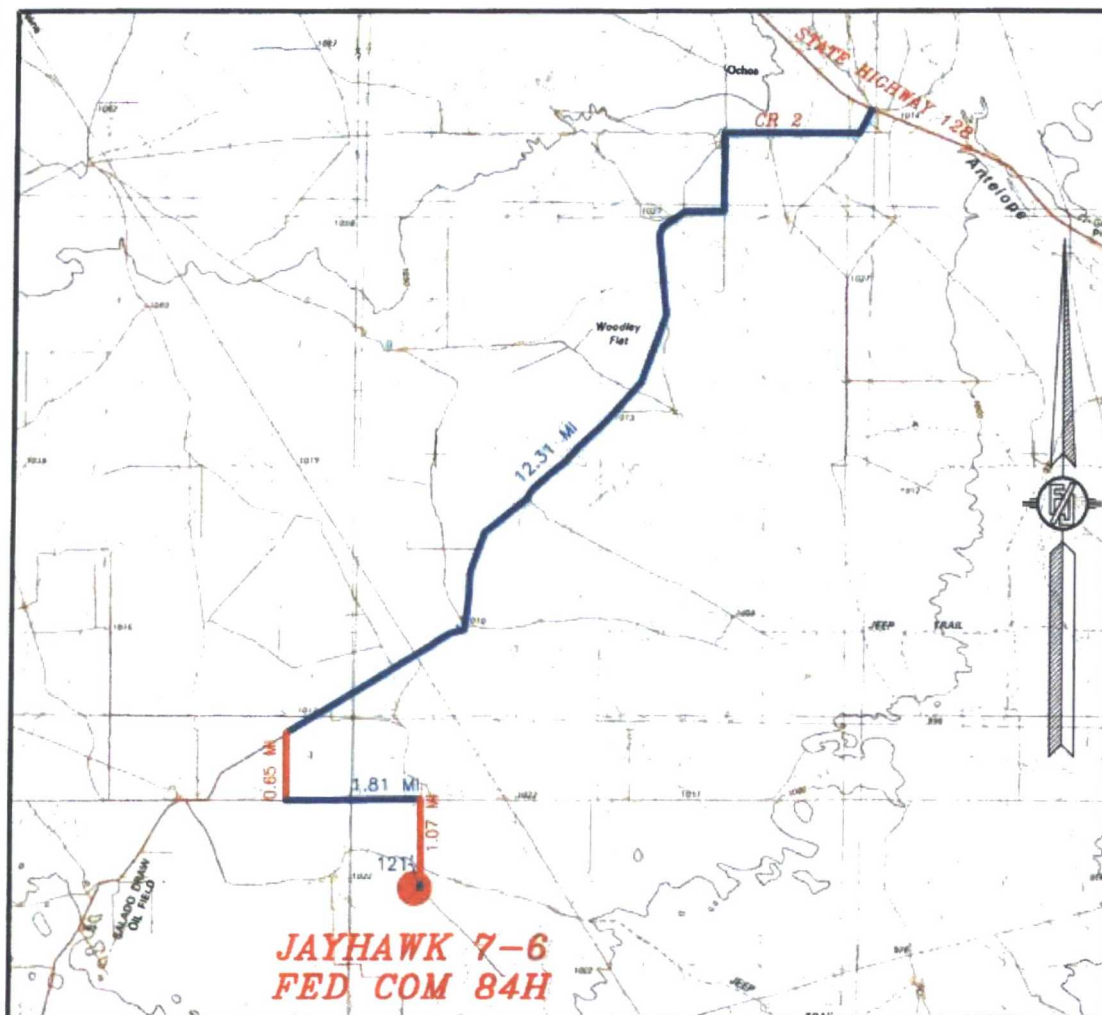

DISTANCES IN MILES

NOT TO SCALE

DEVON ENERGY PRODUCTION COMPANY, L.P.
JAYHAWK 7-6 FED COM 84H
LOCATED 400 FT. FROM THE NORTH LINE
AND 1140 FT. FROM THE EAST LINE OF
SECTION 18, TOWNSHIP 26 SOUTH,
RANGE 34 EAST, N.M.P.M.
LEA COUNTY, STATE OF NEW MEXICO

DIRECTIONS TO LOCATION

FROM STATE HIGHWAY 128 AND CR 2 (BATTLE AXE) GO SOUTH AND WEST ON CR 2 12.31 MILES, TURN LEFT ON CALICHE PIPELINE ROAD AND GO SOUTH 0.85 OF A MILE, TURN LEFT ON CALICHE PIPELINE ROAD AND GO EAST 1.81 MILES, TURN RIGHT AND GO SOUTH 1.07 MILES TO A PROPOSED ROAD SURVEY AND FOLLOW FLAGS WEST 121' TO THE PROPOSED NORTHEAST PAD CORNER FOR THIS LOCATION.

FEBRUARY 21, 2017

SURVEY NO. 4813B

MADRON SURVEYING, INC. 301 SOUTH CANAL (575) 234-3341 CARLSBAD, NEW MEXICO

SECTION 18, TOWNSHIP 26 SOUTH, RANGE 34 EAST, N.M.P.M.
LEA COUNTY, STATE OF NEW MEXICO
AERIAL PHOTO

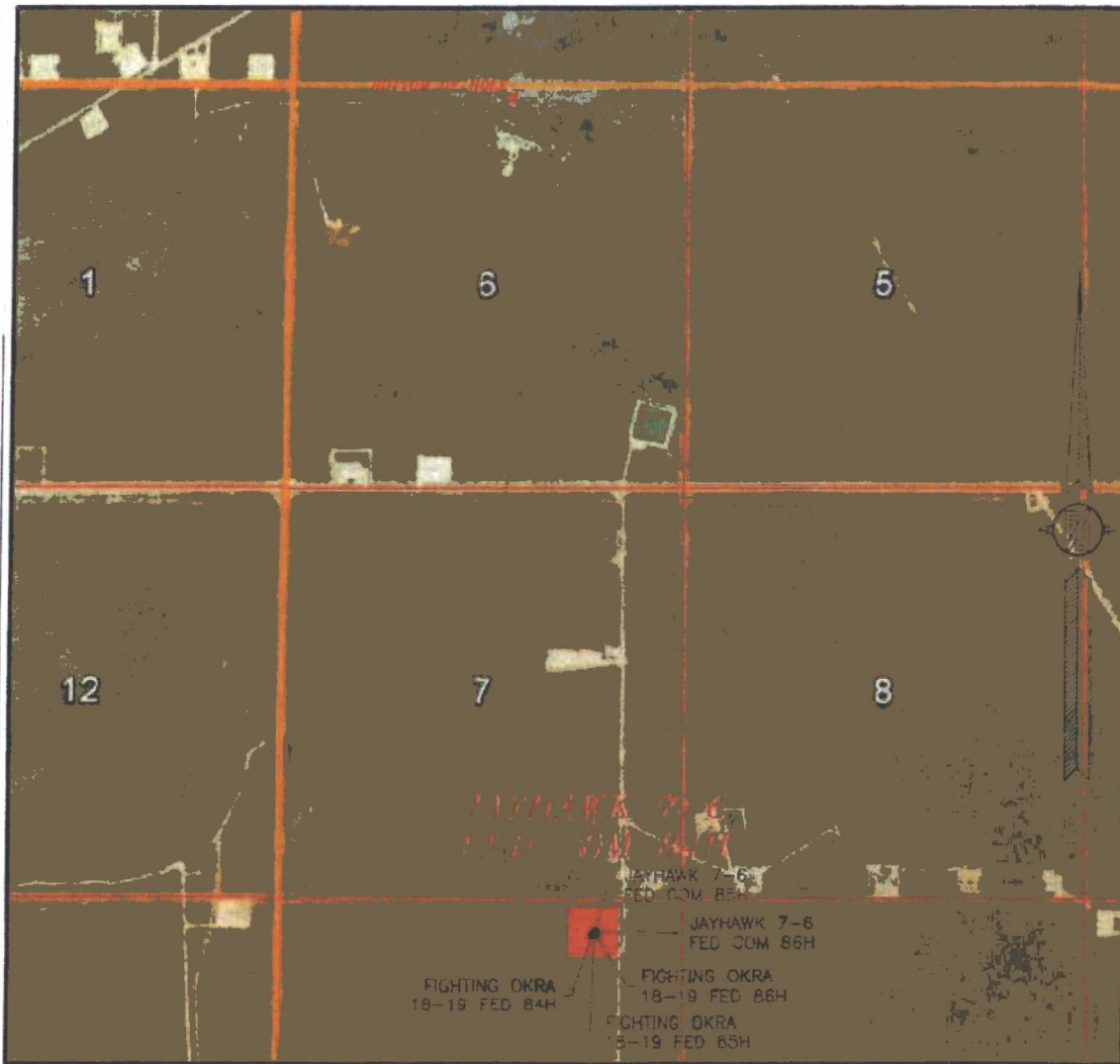

NOT TO SCALE
AERIAL PHOTO:
GOOGLE EARTH
NOVEMBER 2015

DEVON ENERGY PRODUCTION COMPANY, L.P.
JAYHAWK 7-6 FED COM 84H
LOCATED 400 FT. FROM THE NORTH LINE
AND 1140 FT. FROM THE EAST LINE OF
SECTION 18, TOWNSHIP 26 SOUTH,
RANGE 34 EAST, N.M.P.M.
LEA COUNTY, STATE OF NEW MEXICO

FEBRUARY 21, 2017

SURVEY NO. 4813B

MADRON SURVEYING, INC. 301 SOUTH CANAL (575) 234-3341 CARLSBAD, NEW MEXICO

301 SOUTH CANAL
(575) 234-3341