

UNITED STATES
DEPARTMENT OF THE INTERIOR
BUREAU OF LAND MANAGEMENT

APPLICATION FOR PERMIT TO DRILL OR REENTER

FORM APPROVED
OMB No. 1004-0137
Expires October 31, 2014

HOBBS OGD

OCT 20 2017

RECEIVED

1a. Type of work: <input checked="" type="checkbox"/> DRILL <input type="checkbox"/> REENTER		5. Lease Serial No. NMNM27506
1b. Type of Well: <input checked="" type="checkbox"/> Oil Well <input type="checkbox"/> Gas Well <input type="checkbox"/> Other <input checked="" type="checkbox"/> Single Zone <input type="checkbox"/> Multiple Zone		6. If Indian, Allottee or Tribe Name
2. Name of Operator CHEVRON USA INCORPORATED (4323)		7. If Unit or CA Agreement, Name and No.
3a. Address 6301 Deauville Blvd. Midland TX 79706		8. Lease Name and Well No. (319746) SD EA 18 19 FED COM P13 10H
3b. Phone No. (include area code) (432)687-7866		9. API Well No. 30-024-48130
4. Location of Well (Report location clearly and in accordance with any State requirements.)* At surface LOT 1 / 455 FNL / 1201 FWL / LAT 32.04953 / LONG -103.615934 At proposed prod. zone LOT 4 / 180 FSL / 1260 FWL / LAT 32.02244 / LONG -103.615759		10. Field and Pool, or Exploratory WC025G09S263327G / UPPER WOLFC 98097
14. Distance in miles and direction from nearest town or post office* 33 miles		11. Sec., T. R. M. or Blk. and Survey or Area SEC 18 / T26S / R33E / NMP
15. Distance from proposed* location to nearest property or lease line, ft. (Also to nearest drig. unit line, if any) 455 feet	16. No. of acres in lease 1517.74	12. County or Parish LEA
17. Spacing Unit dedicated to this well 320	18. Distance from proposed location* to nearest well, drilling, completed, 25 feet applied for, on this lease, ft.	13. State NM
19. Proposed Depth 12140 feet / 23000 feet	20. BLM/BIA Bond No. on file FED: CA0329	
21. Elevations (Show whether DF, KDB, RT, GL, etc.) 3222 feet	22. Approximate date work will start* 01/01/2018	23. Estimated duration 120 days

24. Attachments

The following, completed in accordance with the requirements of Onshore Oil and Gas Order No.1, must be attached to this form:

- Well plat certified by a registered surveyor.
- A Drilling Plan.
- A Surface Use Plan (if the location is on National Forest System Lands, the SUPO must be filed with the appropriate Forest Service Office).
- Bond to cover the operations unless covered by an existing bond on file (see Item 20 above).
- Operator certification
- Such other site specific information and/or plans as may be required by the BLM.

25. Signature (Electronic Submission)	Name (Printed/Typed) Denise Pinkerton / Ph: (432)687-7375	Date 06/22/2017
Title Regulatory Specialist		
Approved by (Signature) (Electronic Submission)	Name (Printed/Typed) Cody Layton / Ph: (575)234-5959	Date 10/11/2017
Title Supervisor Multiple Resources		

Application approval does not warrant or certify that the applicant holds legal or equitable title to those rights in the subject lease which would entitle the applicant to conduct operations thereon.
Conditions of approval, if any, are attached.

Title 18 U.S.C. Section 1001 and Title 43 U.S.C. Section 1212, make it a crime for any person knowingly and willfully to make to any department or agency of the United States any false, fictitious or fraudulent statements or representations as to any matter within its jurisdiction.

(Continued on page 2)

*(Instructions on page 2)

APPROVED WITH CONDITIONS

KZ
10/20/17

REQUIRES NSL ORDER



U.S. Department of the Interior
BUREAU OF LAND MANAGEMENT

Application Data Report

10/12/2017

APD ID: 10400014975

Submission Date: 06/22/2017

Highlighted data
reflects the most
recent changes

Operator Name: CHEVRON USA INCORPORATED

Well Name: SD EA 18 19 FED COM P13

Well Number: 10H

[Show Final Text](#)

Well Type: OIL WELL

Well Work Type: Drill

Section 1 - General

APD ID: 10400014975

Tie to previous NOS?

Submission Date: 06/22/2017

BLM Office: CARLSBAD

User: Denise Pinkerton

Title: Regulatory Specialist

Federal/Indian APD: FED

Is the first lease penetrated for production Federal or Indian? FED

Lease number: NMNM27506

Lease Acres: 1517.74

Surface access agreement in place?

Allotted?

Reservation:

Agreement in place? NO

Federal or Indian agreement:

Agreement number:

Agreement name:

Keep application confidential? NO

Permitting Agent? NO

APD Operator: CHEVRON USA INCORPORATED

Operator letter of designation:

HOBBS OCD
OCT 20 2017
RECEIVED

Operator Info

Operator Organization Name: CHEVRON USA INCORPORATED

Operator Address: 6301 Deauville Blvd.

Zip: 79706

Operator PO Box:

Operator City: Midland

State: TX

Operator Phone: (432)687-7866

Operator Internet Address:

Section 2 - Well Information

Well in Master Development Plan? NO

Mater Development Plan name:

Well in Master SUPO? NO

Master SUPO name:

Well in Master Drilling Plan? NO

Master Drilling Plan name:

Well Name: SD EA 18 19 FED COM P13

Well Number: 10H

Well API Number:

Field/Pool or Exploratory? Field and Pool

Field Name:
WC025G09S263327G

Pool Name: UPPER
WOLFCAMP

Is the proposed well in an area containing other mineral resources? OIL

Operator Name: CHEVRON USA INCORPORATED

Well Name: SD EA 18 19 FED COM P13

Well Number: 10H

Describe other minerals:

Is the proposed well in a Helium production area? N Use Existing Well Pad? NO New surface disturbance?

Type of Well Pad: MULTIPLE WELL

Multiple Well Pad Name: SD EA Number: 8,9,10,11

Well Class: HORIZONTAL

18 19 FED COM P13

Number of Legs: 1

Well Work Type: Drill

Well Type: OIL WELL

Describe Well Type:

Well sub-Type: INFILL

Describe sub-type:

Distance to town: 33 Miles

Distance to nearest well: 25 FT

Distance to lease line: 455 FT

Reservoir well spacing assigned acres Measurement: 320 Acres

Well plat: SD_EA_18_19_Fed_Com_P13_10H_Well_Plat_06-07-2017.pdf

SD_EA_18_19_P13_10H_C102_06-07-2017.pdf

Well work start Date: 01/01/2018

Duration: 120 DAYS

Section 3 - Well Location Table

Survey Type: RECTANGULAR

Describe Survey Type:

Datum: NAD83

Vertical Datum: NGVD29

Survey number:

	NS-Foot	NS Indicator	EW-Foot	EW Indicator	Twsp	Range	Section	Aliquot/Lot/Tract	Latitude	Longitude	County	State	Meridian	Lease Type	Lease Number	Elevation	MD	TVD
SHL Leg #1	455	FNL	120 1	FWL	26S	33E	18	Lot 1	32.04953	- 103.6159 34	LEA	NEW MEXI CO	NEW MEXI CO	F	NMNM 27506	322 2	0	0
KOP Leg #1	455	FNL	120 1	FWL	26S	33E	18	Lot 1	32.04953	- 103.6159 34	LEA	NEW MEXI CO	NEW MEXI CO	F	NMNM 27506	322 2	0	0
PPP Leg #1	330	FNL	126 0	FWL	26S	33E	18	Lot 1	32.04987 3	- 103.6157 45	LEA	NEW MEXI CO	NEW MEXI CO	F	NMNM 27506	322 2	0	0

Operator Name: CHEVRON USA INCORPORATED

Well Name: SD EA 18 19 FED COM P13

Well Number: 10H

	NS-Foot	NS Indicator	EW-Foot	EW Indicator	Twsp	Range	Section	Aliquot/Lot/Tract	Latitude	Longitude	County	State	Meridian	Lease Type	Lease Number	Elevation	MD	TVD
EXIT Leg #1	330	FSL	126 0	FWL	26S	33E	19	Lot 4	32.02265 6	- 103.6157 59	LEA	NEW MEXI CO	NEW MEXI CO	F	NMLC0 65880A	- 892 8	121 50	121 50
BHL Leg #1	180	FSL	126 0	FWL	26S	33E	19	Lot 4	32.02224 4	- 103.6157 59	LEA	NEW MEXI CO	NEW MEXI CO	F	NMLC0 65880A	- 891 8	230 00	121 40



U.S. Department of the Interior
BUREAU OF LAND MANAGEMENT

Drilling Plan Data Report

10/12/2017

APD ID: 10400014975

Submission Date: 06/22/2017

Highlighted data
reflects the most
recent changes

Operator Name: CHEVRON USA INCORPORATED

Well Name: SD EA 18 19 FED COM P13

Well Number: 10H

[Show Final Text](#)

Well Type: OIL WELL

Well Work Type: Drill

Section 1 - Geologic Formations

Formation ID	Formation Name	Elevation	True Vertical Depth	Measured Depth	Lithologies	Mineral Resources	Producing Formation
1	RUSTLER	3222	800	800	ANHYDRITE	NONE	No
2	CASTILE	-258	3480	3480	DOLOMITE	NONE	No
3	LAMAR	-1678	4900	4900	LIMESTONE	NONE	No
4	BELL CANYON	-1708	4930	4930	SANDSTONE	NONE	No
5	CHERRY CANYON	-2748	5970	5970	SANDSTONE	NONE	No
6	BRUSHY CANYON	-4398	7620	7620	SANDSTONE	NONE	No
7	BONE SPRING LIME	-5868	9090	9090	LIMESTONE	NONE	No
8	UPPER AVALON SHALE	-5898	9120	9120	SHALE	NONE	No
9	BONE SPRING 1ST	-6818	10040	10040	LIMESTONE	NONE	No
10	BONE SPRING 2ND	-7478	10700	10700	LIMESTONE	NONE	No
11	BONE SPRING 3RD	-8518	11740	11740	LIMESTONE	NONE	No
12	WOLFCAMP	-8918	12140	23000	SHALE	OIL	Yes

Section 2 - Blowout Prevention

Pressure Rating (PSI): 10M

Rating Depth: 12213

Equipment: MINIMUM OF 10000 PSI RIG STACK (SEE PROPOSED SCHEMATIC FOR DRILL OUT BELOW INTERMEDIATE CASING) WOLFCAMP IS NOT EXPOSED UNTIL DRILLOUT OF INTER CSG. COULD POSSIBLY USE THE 5000PSI RIG STACK FOR DRILL OUT BELOW SURF CSG DUE TO AVAILABILITY OF 10M ANNULAR. BATCH DRILLING OF THE SURF, INTER, AND PROD WILL TAKE PLACE.

Requesting Variance? YES

Variance request: FMC UH2 MULTIBOWL WELLHEAD, WHICH WILL BE RUN THROUGH THE RIG FLOOR ON SURFACE CASING. BOPE WILL BE NIPPLED UP AND TESTED AFTER CEMENTING SURF CSG. SUBSEQUENT TESTS WILL BE PERFORMED AS NEEDED, NOT TO EXCEED 30 DAYS. ALSO, REQUEST VARIANCE FOR FLEX

Operator Name: CHEVRON USA INCORPORATED

Well Name: SD EA 18 19 FED COM P13

Well Number: 10H

CHOKE HOSE TO BE USED ON ALL WELLS ON PAD. (SEE ATTACHED SPEC)

Testing Procedure: STACK WILL BE TESTED AS SPECIFIED IN THE ATTACHED TESTING REQUIREMENTS. BATCH DRILLING OF THE SURF, INTER, AND PROD WILL TAKE PLACE. A FULL BOP TEST WILL BE PERFORMED UNLESS APPROVAL FROM BLM IS RECVD OTHERWISE. FLEX CHOKE HOSE WILL BE USED FOR ALL WELLS ON THE PAD. BOP TEST WILL BE CONDUCTED BY A 3RD PARTY. THE FIELD REPORT FROM FMC AND BOP TEST INFO WILL BE PROVIDED IN A SUBSEQUENT REPORT AT THE END OF THE WELL. AN INSTALLATION MANUAL HAS BEEN PLACED ON FILE WITH THE BLM OFFICE AND REMAINS UNCHANGED FROM PREVIOUS SUBMITTAL.

Choke Diagram Attachment:

Choke_hose_Spec_X30_20170906102031.pdf

1684_001_20170906102101.pdf

BOP Diagram Attachment:

UH_2_10K_20170906102125.pdf

10M_BOP_Choke_Schematics_BLM_new_20170915095213.pdf

Section 3 - Casing

Casing ID	String Type	Hole Size	Csg Size	Condition	Standard	Tapered String	Top Set MD	Bottom Set MD	Top Set TVD	Bottom Set TVD	Top Set MSL	Bottom Set MSL	Calculated casing length MD	Grade	Weight	Joint Type	Collapse SF	Burst SF	Joint SF Type	Joint SF	Body SF Type	Body SF
1	SURFACE	17.5	13.375	NEW	API	N	0	800	0	-800	-8918	-8118	800	J-55	55	STC	3.12	1.36	DRY	3.17	DRY	1.7
2	INTERMEDIATE	12.25	9.625	NEW	API	N	0	11500	0	-11500	-8918	2582	11500	HCL-80	43.5	LTC	1.44	1.12	DRY	1.93	DRY	1.37
3	PRODUCTION	8.5	5.5	NEW	API	N	0	23000	0	-23000	-8918	14082	23000	P-110	20	OTHER - TXP BTC	1.23	1.11	DRY	1.97	DRY	1.37

Casing Attachments

Operator Name: CHEVRON USA INCORPORATED

Well Name: SD EA 18 19 FED COM P13

Well Number: 10H

Casing Attachments

Casing ID: 1 **String Type:** SURFACE

Inspection Document:

Spec Document:

Tapered String Spec:

Casing Design Assumptions and Worksheet(s):

SD__EA_1819_FED_COM_P13_10H_9_PT_PLAN_20170906102250.pdf

Casing ID: 2 **String Type:** INTERMEDIATE

Inspection Document:

Spec Document:

Tapered String Spec:

Casing Design Assumptions and Worksheet(s):

SD__EA_1819_FED_COM_P13_10H_9_PT_PLAN_20170906102322.pdf

9.625_43.5lb_L80IC_LTC_20170906102429.pdf

Casing ID: 3 **String Type:** PRODUCTION

Inspection Document:

Spec Document:

Tapered String Spec:

Casing Design Assumptions and Worksheet(s):

SD__EA_1819_FED_COM_P13_10H_9_PT_PLAN_20170906102358.pdf

Section 4 - Cement

Operator Name: CHEVRON USA INCORPORATED

Well Name: SD EA 18 19 FED COM P13

Well Number: 10H

String Type	Lead/Tail	Stage Tool Depth	Top MD	Bottom MD	Quantity(sx)	Yield	Density	Cu Ft	Excess%	Cement type	Additives
SURFACE	Lead		0	800	650	1.33	14.8	6.57	50	CLASS C	NONE

INTERMEDIATE	Lead		4870	1065 0	1024	2.21	11.9	12.18	25	50:50 POZ CLASS C	NONE
INTERMEDIATE	Tail		1065 0	1115 0	184	1.22	15.6	5.37	25	CLASS H	NON3
PRODUCTION	Lead		1035 0	2300 0	1362	1.2	15.6	5.05	17	ACID SOLUBLE	NONE

Section 5 - Circulating Medium

Mud System Type: Closed

Will an air or gas system be Used? NO

Description of the equipment for the circulating system in accordance with Onshore Order #2:

Diagram of the equipment for the circulating system in accordance with Onshore Order #2:

Describe what will be on location to control well or mitigate other conditions: IN COMPLIANCE WITH ONSHORE ORDER #2

Describe the mud monitoring system utilized: VISUAL MUD MONITORING EQPT, PVT, STROKE COUNTER, FLOW SENSOR IN COMPLIANCE WITH ONSHORE ORDER #2

Circulating Medium Table

Top Depth	Bottom Depth	Mud Type	Min Weight (lbs/gal)	Max Weight (lbs/gal)	Density (lbs/cu ft)	Gel Strength (lbs/100 sqft)	PH	Viscosity (CP)	Salinity (ppm)	Filtration (cc)	Additional Characteristics
0	800	SPUD MUD	8.3	8.7							
800	1115 0	OIL-BASED MUD	8.7	9.2							
1115 0	1230 0	OIL-BASED MUD	9.5	13.5							

Operator Name: CHEVRON USA INCORPORATED

Well Name: SD EA 18 19 FED COM P13

Well Number: 10H

Top Depth	Bottom Depth	Mud Type	Min Weight (lbs/gal)	Max Weight (lbs/gal)	Density (lbs/cu ft)	Gel Strength (lbs/100 sqft)	PH	Viscosity (CP)	Salinity (ppm)	Filtration (cc)	Additional Characteristics
1230 0	2230 0	OIL-BASED MUD	9.5	13.5							

Section 6 - Test, Logging, Coring

List of production tests including testing procedures, equipment and safety measures:

DRILL STEM TESTS ARE NOT PLANNED

List of open and cased hole logs run in the well:

MWD

Coring operation description for the well:

CONVENTIONAL WHOLE CORE SAMPLES ARE NOT PLANNED

Section 7 - Pressure

Anticipated Bottom Hole Pressure: 8573

Anticipated Surface Pressure: 5900

Anticipated Bottom Hole Temperature(F): 160

Anticipated abnormal pressures, temperatures, or potential geologic hazards? NO

Describe:

Contingency Plans geohazards description:

Contingency Plans geohazards attachment:

Hydrogen Sulfide drilling operations plan required? YES

Hydrogen sulfide drilling operations plan:

SD_EA_18_19_Fed_Com_P13_9H_H2S_06-22-2017.pdf

Operator Name: CHEVRON USA INCORPORATED

Well Name: SD EA 18 19 FED COM P13

Well Number: 10H

Section 8 - Other Information

Proposed horizontal/directional/multi-lateral plan submission:

SD_EA_18_19_Fed_Com_P13_10H_Plot_06-22-2017.pdf

SD_EA_18_19_Fed_Com_P13_10H_Direc_Surv_06-22-2017.pdf

Other proposed operations facets description:

Other proposed operations facets attachment:

Gas_Capture_Plan_Form_Pad_13_20170906102735.pdf

Other Variance attachment:



APD ID: 10400014975

Submission Date: 06/22/2017

Operator Name: CHEVRON USA INCORPORATED

Well Name: SD EA 18 19 FED COM P13

Well Number: 10H

Well Type: OIL WELL

Well Work Type: Drill

Highlighted data
reflects the most
recent changes

[Show Final Text](#)

Section 1 - Existing Roads

Will existing roads be used? YES

Existing Road Map:

SD_EA_18_19_Fed_Com_P13_10H_Road_Plat_08-09-2017.pdf

Existing Road Purpose: ACCESS, FLUID TRANSPORT

Row(s) Exist? NO

ROW ID(s)

ID:

Do the existing roads need to be improved? YES

Existing Road Improvement Description: REPAIR POT HOLES, CLEAR DITCHES, REPAIR CROWN, ETC.

Existing Road Improvement Attachment:

Section 2 - New or Reconstructed Access Roads

Will new roads be needed? YES

New Road Map:

SD_EA_18_19_Fed_Com_P13_10H_Well_Plat_06-07-2017.pdf

New road type: LOCAL

Length: 6406.68

Feet

Width (ft.): 25

Max slope (%): 2

Max grade (%): 3

Army Corp of Engineers (ACOE) permit required? NO

ACOE Permit Number(s):

New road travel width: 25

New road access erosion control: WILL HAVE A DUST ABATEMENT POLYMER COATING TO DECREASE DUST AS WELL AS HELP MAINTAIN THE ROAD.

New road access plan or profile prepared? NO

New road access plan attachment:

Access road engineering design? NO

Access road engineering design attachment:

Operator Name: CHEVRON USA INCORPORATED

Well Name: SD EA 18 19 FED COM P13

Well Number: 10H

Access surfacing type: OTHER

Access topsoil source: ONSITE

Access surfacing type description: CALICHE

Access onsite topsoil source depth: 0

Offsite topsoil source description:

Onsite topsoil removal process: NONE NEEDED

Access other construction information:

Access miscellaneous information:

Number of access turnouts: 60

Access turnout map:

Drainage Control

New road drainage crossing: CROSSING,LOW WATER

Drainage Control comments: DITCHING WILL BE CONSTRUCTED ON BOTH SIDES OF ROAD.

Road Drainage Control Structures (DCS) description: DITCHING WILL BE CONSTRUCTED ON BOTH SIDES OF ROAD

Road Drainage Control Structures (DCS) attachment:

Access Additional Attachments

Additional Attachment(s):

Section 3 - Location of Existing Wells

Existing Wells Map? YES

Attach Well map:

Location_of_Existing_Wells_P13_10H_06-07-2017.pdf

Existing Wells description:

Section 4 - Location of Existing and/or Proposed Production Facilities

Submit or defer a Proposed Production Facilities plan? SUBMIT

Estimated Production Facilities description:

Production Facilities description:

Production Facilities map:

SD_EA_18_19_Fed_Com_P13_10H_Work_Aerial_Detail_06-07-2017.pdf

SD_EA_18_19_Fed_Com_P13_PrelimEDS_Line_20170906140247.pdf

SD_EA_18_19_Fed_Com_P13_PrelimFlowlines_20170906140304.pdf

SD_EA_18_19_Fed_Com_P13_PrelimGas_Lift_Lines_20170906140321.pdf

Operator Name: CHEVRON USA INCORPORATED

Well Name: SD EA 18 19 FED COM P13

Well Number: 10H

Section 5 - Location and Types of Water Supply

Water Source Table

Water source use type: INTERMEDIATE/PRODUCTION CASING, STIMULATION, SURFACE CASING

Water source type: OTHER

Describe type: INTERMEDIATE/PRODUCTION CASING, SURFACE CASING, STIMULATION

Source longitude:

Source latitude:

Source datum:

Water source permit type: PRIVATE CONTRACT

Source land ownership: FEDERAL

Water source transport method: PIPELINE

Source transportation land ownership: FEDERAL

Water source volume (barrels): 659461.25

Source volume (acre-feet): 85

Source volume (gal): 27697372

Water source and transportation map:

SD_EA_18_19_Fed_Com_P13_10H_Work_Aerial_Detail_06-07-2017.pdf

Water source comments: EXISTING PONDS IN SEC 19,T26S-R33E - FW & SEC 23 T26S-R32 & SEC 13 T26S-R32 - RECYCLED WTR. SEE SURFACE USE PLAN

New water well? NO

New Water Well Info

Well latitude:

Well Longitude:

Well datum:

Well target aquifer:

Est. depth to top of aquifer(ft):

Est thickness of aquifer:

Aquifer comments:

Aquifer documentation:

Well depth (ft):

Well casing type:

Well casing outside diameter (in.):

Well casing inside diameter (in.):

New water well casing?

Used casing source:

Drilling method:

Drill material:

Grout material:

Grout depth:

Casing length (ft.):

Casing top depth (ft.):

Well Production type:

Completion Method:

Water well additional information:

State appropriation permit:

Operator Name: CHEVRON USA INCORPORATED

Well Name: SD EA 18 19 FED COM P13

Well Number: 10H

Additional information attachment:

Section 6 - Construction Materials

Construction Materials description: CALICHE WILL BE USED TO CONSTRUCT WELL PAD & ROADS & PURCHASED FROM THE PRIVATE LAND OWNER, OLIVER KIEHNE. CALICHE PIT LOCATED IN SEC 27, T26, R33E, LEA COUNTY, NM. And ALTERNATIVE @ N2 SEC 21, T26S, R33E, LEA CNTY, NM. THE PROPOSED SOURCE OF CONSTRUCTION MATERIAL WILL BE LOCATED AND PURCHASED BY CHEVRON U.S.A. INC. NOTIFICATION SHALL BE GIVEN TO BLM AT LEAST 3 WORKING DAYS PRIOR TO COMMENCING CONSTRUCTION OF ACCESS ROAD AND/OR WELL PAD.
Construction Materials source location attachment:

Section 7 - Methods for Handling Waste

Waste type: GARBAGE

Waste content description: GARBAGE & TRASH

Amount of waste: 200 pounds

Waste disposal frequency : Daily

Safe containment description: WILL BE COLLECTED IN TRASH CONTAINER & DISPOSED OF AT STATE APPROVED FACILITY

Safe containmant attachment:

Waste disposal type: HAUL TO COMMERCIAL FACILITY **Disposal location ownership:** STATE

Disposal type description:

Disposal location description: STATE APPROVED FACILITY

Reserve Pit

Reserve Pit being used? NO

Temporary disposal of produced water into reserve pit?

Reserve pit length (ft.) **Reserve pit width (ft.)**

Reserve pit depth (ft.) **Reserve pit volume (cu. yd.)**

Is at least 50% of the reserve pit in cut?

Reserve pit liner

Reserve pit liner specifications and installation description

Cuttings Area

Cuttings Area being used? NO

Are you storing cuttings on location? NO

Description of cuttings location

Operator Name: CHEVRON USA INCORPORATED

Well Name: SD EA 18 19 FED COM P13

Well Number: 10H

Cuttings area length (ft.)

Cuttings area width (ft.)

Cuttings area depth (ft.)

Cuttings area volume (cu. yd.)

Is at least 50% of the cuttings area in cut?

WCuttings area liner

Cuttings area liner specifications and installation description

Section 8 - Ancillary Facilities

Are you requesting any Ancillary Facilities?: NO

Ancillary Facilities attachment:

Comments:

Section 9 - Well Site Layout

Well Site Layout Diagram:

SD_EA_18_19_Fed_Com_P13_10H_Well_Plat_06-07-2017.pdf

SD_EA_18_19_P13_8H_Rig_Layout_06-22-2017.pdf

Comments:

Section 10 - Plans for Surface Reclamation

Type of disturbance: NEW

Recontouring attachment:

SD_EA_18_19_Fed_Com_P13_10H_Reclamation_Plat_06-07-2017.pdf

P13_10H_APD_SUPO_06-07-2017.pdf

Drainage/Erosion control construction: SEE SURFACE USE PLAN

Drainage/Erosion control reclamation: SEE SURFACE USE PLAN

Wellpad long term disturbance (acres): 2

Wellpad short term disturbance (acres): 4

Access road long term disturbance (acres): 3.68

Access road short term disturbance (acres): 0

Pipeline long term disturbance (acres): 4.1673555

Pipeline short term disturbance (acres): 5.78719

Other long term disturbance (acres): 0

Other short term disturbance (acres): 0

Total long term disturbance: 9.847356

Total short term disturbance: 9.78719

Reconstruction method: SEE SURFACE USE PLAN

Topsoil redistribution: SEE SURFACE USE PLAN

Soil treatment: SEE SURFACE USE PLAN

Existing Vegetation at the well pad: MESQUITE, SHRUBS, GRASS

Operator Name: CHEVRON USA INCORPORATED

Well Name: SD EA 18 19 FED COM P13

Well Number: 10H

Existing Vegetation at the well pad attachment:

Existing Vegetation Community at the road: MESQUITE, SHRUBS, GRASS

Existing Vegetation Community at the road attachment:

Existing Vegetation Community at the pipeline: MESQUITE, SHRUBS, GRASS

Existing Vegetation Community at the pipeline attachment:

Existing Vegetation Community at other disturbances: MESQUITE, SHRUBS, GRASS

Existing Vegetation Community at other disturbances attachment:

Non native seed used? NO

Non native seed description:

Seedling transplant description:

Will seedlings be transplanted for this project? NO

Seedling transplant description attachment:

Will seed be harvested for use in site reclamation? NO

Seed harvest description:

Seed harvest description attachment:

Seed Management

Seed Table

Seed type:

Seed source:

Seed name:

Source name:

Source address:

Source phone:

Seed cultivar:

Seed use location:

PLS pounds per acre:

Proposed seeding season:

Seed Summary

Total pounds/Acre:

Seed Type

Pounds/Acre

Seed reclamation attachment:

Operator Contact/Responsible Official Contact Info

First Name:

Last Name:

Phone:

Email:

Operator Name: CHEVRON USA INCORPORATED

Well Name: SD EA 18 19 FED COM P13

Well Number: 10H

Seedbed prep:

Seed BMP:

Seed method:

Existing invasive species? NO

Existing invasive species treatment description:

Existing invasive species treatment attachment:

Weed treatment plan description: NONE NEEDED

Weed treatment plan attachment:

Monitoring plan description: NONE NEEDED

Monitoring plan attachment:

Success standards: N/A

Pit closure description: N/A

Pit closure attachment:

Section 11 - Surface Ownership

Disturbance type: NEW ACCESS ROAD

Describe:

Surface Owner: BUREAU OF LAND MANAGEMENT

Other surface owner description:

BIA Local Office:

BOR Local Office:

COE Local Office:

DOD Local Office:

NPS Local Office:

State Local Office:

Military Local Office:

USFWS Local Office:

Other Local Office:

USFS Region:

USFS Forest/Grassland:

USFS Ranger District:

Operator Name: CHEVRON USA INCORPORATED

Well Name: SD EA 18 19 FED COM P13

Well Number: 10H

Disturbance type: EXISTING ACCESS ROAD

Describe:

Surface Owner: BUREAU OF LAND MANAGEMENT

Other surface owner description:

BIA Local Office:

BOR Local Office:

COE Local Office:

DOD Local Office:

NPS Local Office:

State Local Office:

Military Local Office:

USFWS Local Office:

Other Local Office:

USFS Region:

USFS Forest/Grassland:

USFS Ranger District:

Disturbance type: WELL PAD

Describe:

Surface Owner: BUREAU OF LAND MANAGEMENT

Other surface owner description:

BIA Local Office:

BOR Local Office:

COE Local Office:

DOD Local Office:

NPS Local Office:

State Local Office:

Military Local Office:

USFWS Local Office:

Other Local Office:

USFS Region:

USFS Forest/Grassland:

USFS Ranger District:

Operator Name: CHEVRON USA INCORPORATED

Well Name: SD EA 18 19 FED COM P13

Well Number: 10H

Disturbance type: PIPELINE

Describe:

Surface Owner: BUREAU OF LAND MANAGEMENT

Other surface owner description:

BIA Local Office:

BOR Local Office:

COE Local Office:

DOD Local Office:

NPS Local Office:

State Local Office:

Military Local Office:

USFWS Local Office:

Other Local Office:

USFS Region:

USFS Forest/Grassland:

USFS Ranger District:

Section 12 - Other Information

Right of Way needed? YES

Use APD as ROW? YES

ROW Type(s): 288100 ROW – O&G Pipeline

ROW Applications

SUPO Additional Information: 8 -4" BURIED PIPELINES, APPROX 6285.92' WILL BE LAID FROM WELL RUNNING TO LEASE ROAD THEN ADJACENT TO LEASE ROAD TO PROD FAC IN SEC 19. 2 -4" BURIED GAS LIFT PIPELINES, APPROX 6269.92' WILL BE LAID FROM WELL RUNNING TO LEASE ROAD THEN ADJACENT TO LEASE ROAD TO COMP FAC IN SEC 19. SEE ATTACHED WELL PLAT.

Use a previously conducted onsite? YES

Previous Onsite information: ON SITE PERFORMED BY BLM NRS: PAUL MURPHY 4/13/2017

Other SUPO Attachment

SD_EA_18_19_Fed_Com_P13_10H_Well_Plat_08-09-2017.pdf

DIRECTIONS TO LOCATION: From Hwy 1 (Orla Road), head Easterly on Battle Axe Road approximately 6.80 miles to an existing lease road. Head Northwesterly along existing lease roads approximately 2.17 miles to the proposed access road entrance on the North side of the road.

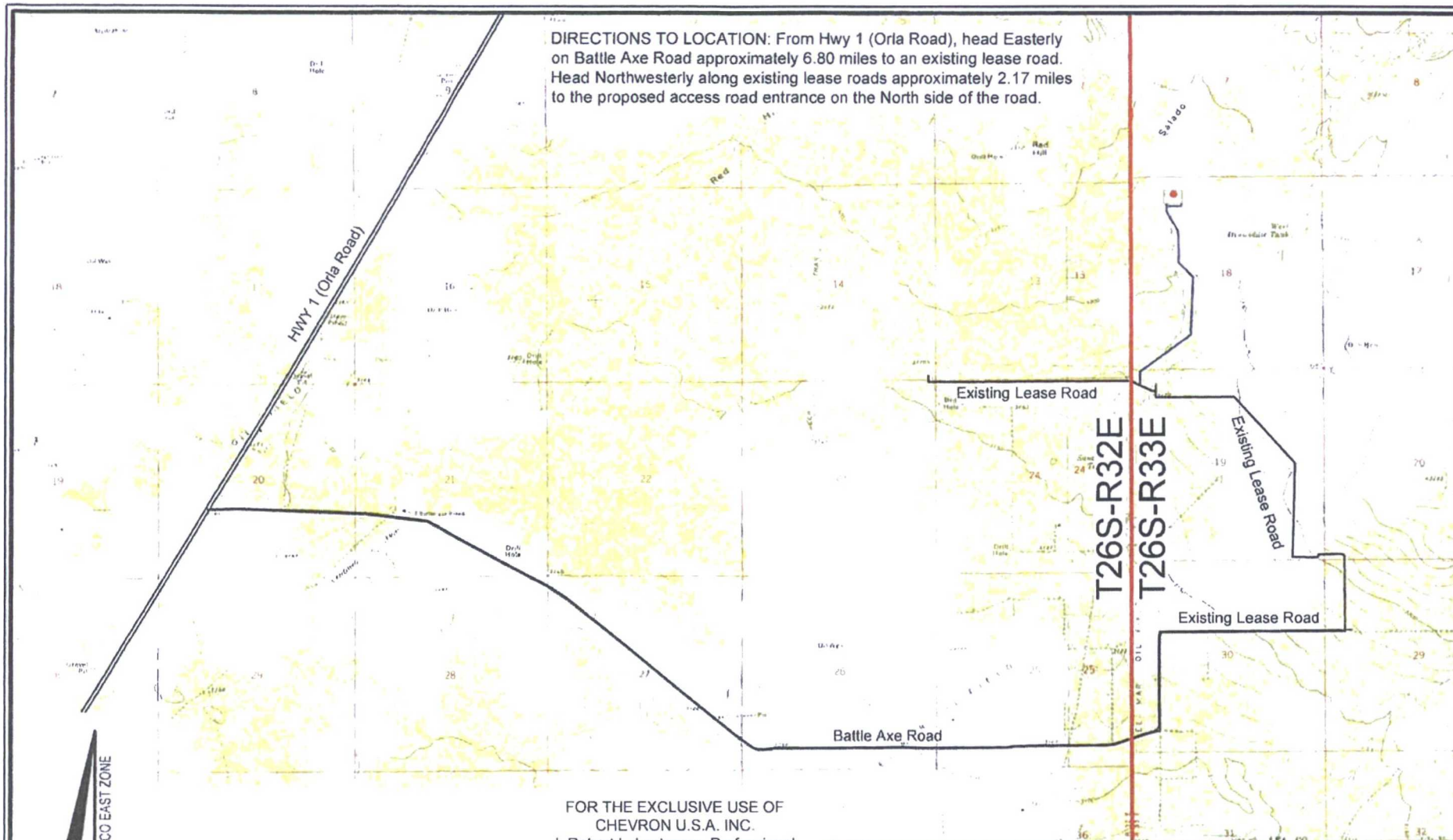

NAD 27 NEW MEXICO EAST ZONE

LEGEND

- Proposed Well
- Proposed Access Road
- Proposed Drillsite
- Existing Road
- Township/Range Line

Scale: 1" = 4,000'

4,000' 0 2,000' 4,000'

FOR THE EXCLUSIVE USE OF
CHEVRON U.S.A. INC.

I, Robert L. Lastrapes, Professional
Surveyor, do hereby state this plat is true
and correct to the best of my knowledge.



Robert L. Lastrapes
Registration No. 23006

ROAD PLAT

CHEVRON U.S.A. INC.

SD EA 18 19 FED COM P13 NO. 10H WELL
LOCATED 455' FNL & 1201' FWL
SECTION 18, T26S-R33E
LEA COUNTY, NEW MEXICO

DRAWN BY: BOR

REVISIONS

PROJ. MGR.: VHV

No. 1

DATE: 04/03/2017

REVISED BY: TBD

DATE: 03/22/2017

No. 2

DATE: 05/22/2017

REVISED BY: BOR

FILENAME: T:\2017\2175521\DWG\SD EA 18 19 Fed Com P13 10H_Road Plat.dwg



C. H. Fenstermaker & Associates, L.L.C.
135 Regency Sq. Lafayette, LA 70508
Ph. 337-237-2200 Fax. 337-232-3299
www.fenstermaker.com



Section 1 - General

Would you like to address long-term produced water disposal? NO

Section 2 - Lined Pits

Would you like to utilize Lined Pit PWD options? NO

Produced Water Disposal (PWD) Location:

PWD surface owner:

PWD disturbance (acres):

Lined pit PWD on or off channel:

Lined pit PWD discharge volume (bbl/day):

Lined pit specifications:

Pit liner description:

Pit liner manufacturers information:

Precipitated solids disposal:

Describe precipitated solids disposal:

Precipitated solids disposal permit:

Lined pit precipitated solids disposal schedule:

Lined pit precipitated solids disposal schedule attachment:

Lined pit reclamation description:

Lined pit reclamation attachment:

Leak detection system description:

Leak detection system attachment:

Lined pit Monitor description:

Lined pit Monitor attachment:

Lined pit: do you have a reclamation bond for the pit?

Is the reclamation bond a rider under the BLM bond?

Lined pit bond number:

Lined pit bond amount:

Additional bond information attachment:

Section 3 - Unlined Pits

Would you like to utilize Unlined Pit PWD options? NO

Produced Water Disposal (PWD) Location:

PWD surface owner:

PWD disturbance (acres):

Unlined pit PWD on or off channel:

Unlined pit PWD discharge volume (bbl/day):

Unlined pit specifications:

Precipitated solids disposal:

Describe precipitated solids disposal:

Precipitated solids disposal permit:

Unlined pit precipitated solids disposal schedule:

Unlined pit precipitated solids disposal schedule attachment:

Unlined pit reclamation description:

Unlined pit reclamation attachment:

Unlined pit Monitor description:

Unlined pit Monitor attachment:

Do you propose to put the produced water to beneficial use?

Beneficial use user confirmation:

Estimated depth of the shallowest aquifer (feet):

Does the produced water have an annual average Total Dissolved Solids (TDS) concentration equal to or less than that of the existing water to be protected?

TDS lab results:

Geologic and hydrologic evidence:

State authorization:

Unlined Produced Water Pit Estimated percolation:

Unlined pit: do you have a reclamation bond for the pit?

Is the reclamation bond a rider under the BLM bond?

Unlined pit bond number:

Unlined pit bond amount:

Additional bond information attachment:

Section 4 - Injection

Would you like to utilize Injection PWD options? NO

Produced Water Disposal (PWD) Location:

PWD surface owner:

PWD disturbance (acres):

Injection PWD discharge volume (bbl/day):

Injection well mineral owner:

Injection well type:

Injection well number:

Injection well name:

Assigned injection well API number?

Injection well API number:

Injection well new surface disturbance (acres):

Minerals protection information:

Mineral protection attachment:

Underground Injection Control (UIC) Permit?

UIC Permit attachment:

Section 5 - Surface Discharge

Would you like to utilize Surface Discharge PWD options? NO

Produced Water Disposal (PWD) Location:

PWD surface owner:

PWD disturbance (acres):

Surface discharge PWD discharge volume (bbl/day):

Surface Discharge NPDES Permit?

Surface Discharge NPDES Permit attachment:

Surface Discharge site facilities information:

Surface discharge site facilities map:

Section 6 - Other

Would you like to utilize Other PWD options? NO

Produced Water Disposal (PWD) Location:

PWD surface owner:

PWD disturbance (acres):

Other PWD discharge volume (bbl/day):

Other PWD type description:

Other PWD type attachment:

Have other regulatory requirements been met?

Other regulatory requirements attachment:



U.S. Department of the Interior
BUREAU OF LAND MANAGEMENT

Bond Info Data Report

10/12/2017

Bond Information

Federal/Indian APD: FED

BLM Bond number: CA0329

BIA Bond number:

Do you have a reclamation bond? NO

Is the reclamation bond a rider under the BLM bond?

Is the reclamation bond BLM or Forest Service?

BLM reclamation bond number:

Forest Service reclamation bond number:

Forest Service reclamation bond attachment:

Reclamation bond number:

Reclamation bond amount:

Reclamation bond rider amount:

Additional reclamation bond information attachment:



U.S. Department of the Interior
BUREAU OF LAND MANAGEMENT

Operator Certification Data Report

10/12/2017

Operator Certification

I hereby certify that I, or someone under my direct supervision, have inspected the drill site and access route proposed herein; that I am familiar with the conditions which currently exist; that I have full knowledge of state and Federal laws applicable to this operation; that the statements made in this APD package are, to the best of my knowledge, true and correct; and that the work associated with the operations proposed herein will be performed in conformity with this APD package and the terms and conditions under which it is approved. I also certify that I, or the company I represent, am responsible for the operations conducted under this application. These statements are subject to the provisions of 18 U.S.C. 1001 for the filing of false statements.

NAME: Denise Pinkerton

Signed on: 06/07/2017

Title: Regulatory Specialist

Street Address: 6301 Deauville Blvd

City: Midland

State: TX

Zip: 79706

Phone: (432)687-7375

Email address: leakejd@chevron.com

Field Representative

Representative Name:

Street Address:

City:

State:

Zip:

Phone:

Email address:

HOBBS OCD
OCT 20 2017
RECEIVED