

District I  
1625 N. French Dr., Hobbs, NM 88240  
Phone: (575) 393-6161 Fax: (575) 393-0720  
District II  
811 S. First St., Artesia, NM 88210  
Phone: (575) 748-1283 Fax: (575) 748-9720  
District III  
1000 Rio Brazos Road, Aztec, NM 87410  
Phone: (505) 334-6178 Fax: (505) 334-6170  
District IV  
1220 S. St. Francis Dr., Santa Fe, NM 87505  
Phone: (505) 476-3460 Fax: (505) 476-3462

State of New Mexico  
Energy, Minerals & Natural Resources Department  
OIL CONSERVATION DIVISION  
1220 South St. Francis Dr.  
Santa Fe, NM 87505

Form C-102  
Revised August 1, 2011  
Submit one copy to appropriate  
District Office

☒ AMENDED REPORT

WELL LOCATION AND ACREAGE DEDICATION PLAT

<sup>1</sup> API Number <b>30-025-26370</b>	<sup>2</sup> Pool Code <b>96173</b>	<sup>3</sup> Pool Name <b>BSW; Salado</b>
<sup>4</sup> Property Code	<sup>5</sup> Property Name <b>State '4'</b>	<sup>6</sup> Well Number <b>001</b>
<sup>7</sup> OGRID No. <b>370661</b>	<sup>8</sup> Operator Name <b>Llano Disposal, LLC</b>	<sup>9</sup> Elevation <b>3997</b>

<sup>10</sup> Surface Location

UL or lot no. <b>E</b>	Section <b>4</b>	Township <b>13S</b>	Range <b>36E</b>	Lot Idn	Feet from the <b>1980</b>	North/South line <b>N</b>	Feet from the <b>660</b>	East/West line <b>W</b>	County <b>Lea</b>
---------------------------	---------------------	------------------------	---------------------	---------	------------------------------	------------------------------	-----------------------------	----------------------------	----------------------

<sup>11</sup> Bottom Hole Location If Different From Surface

UL or lot no.	Section	Township	Range	Lot Idn	Feet from the	North/South line	Feet from the	East/West line	County
---------------	---------	----------	-------	---------	---------------	------------------	---------------	----------------	--------

<sup>12</sup> Dedicated Acres <b>40</b>	<sup>13</sup> Joint or Infill	<sup>14</sup> Consolidation Code	<sup>15</sup> Order No. <b>(Pending WQCC Discharge Permit approval)</b>
--	-------------------------------	----------------------------------	--

No allowable will be assigned to this completion until all interests have been consolidated or a non-standard unit has been approved by the division. **33.2225075, -103.3154755 NAD83**

<sup>16</sup> 	<sup>17</sup> <b>OPERATOR CERTIFICATION</b> <i>I hereby certify that the information contained herein is true and complete to the best of my knowledge and belief, and that this organization either owns a working interest or unleased mineral interest in the land including the proposed bottom hole location or has a right to drill this well at this location pursuant to a contract with an owner of such a mineral or working interest, or to a voluntary pooling agreement or a compulsory pooling order heretofore entered by the division.</i> <div style="display: flex; justify-content: space-between;"> <div>   Signature </div> <div> 1/5/2018  Date </div> </div> <div style="border-top: 1px solid black; padding-top: 5px;"> <b>Danny J. Holcomb – Agent for Llano Disposal</b>  Printed Name </div> <div style="border-top: 1px solid black; padding-top: 5px;"> <b>danny@pwillc.net</b>  E-mail Address </div>	
	<sup>18</sup> <b>SURVEYOR CERTIFICATION</b> <i>I hereby certify that the well location shown on this plat was plotted from field notes of actual surveys made by me or under my supervision, and that the same is true and correct to the best of my belief.</i> <p style="text-align: center;">See Original Survey dated 7/6/1979 attached</p>	
	Date of Survey Signature and Seal of Professional Surveyor:  <p style="text-align: center;">See Original Survey dated 7/6/1979 attached</p>	
	Certificate Number	

NEW MEXICO OIL CONSERVATION COMMISSION  
WELL LOCATION AND ACREAGE DEDICATION PLAT

Form C-102  
Supersedes C-128  
Effective 1-1-55

All distances must be from the outer boundaries of the Section.

Operator <b>DOBE OIL &amp; GAS CORPORATION</b>			Lease <b>STATE "4"</b>		Well No. <b>1</b>
1st Letter <b>"E"</b>	Section <b>4</b>	Township <b>13-S</b>	Range <b>36-E</b>	County <b>LEA</b>	
Actual Footage Location of Well:					
1980 feet from the		NORTH line and		660 feet from the WEST line	
Sound Level Elev. <b>3997</b>	Producing Formation <b>MISSISSIPPIAN</b>		Pool <b>WILDCAT</b>		Dedicated Acreage: <b>320</b> Acres

1. Outline the acreage dedicated to the subject well by colored pencil or hachure marks on the plat below.
2. If more than one lease is dedicated to the well, outline each and identify the ownership thereof (both as to working interest and royalty).
3. If more than one lease of different ownership is dedicated to the well, have the interests of all owners been consolidated by communitization, unitization, force-pooling, etc?

☐ Yes ☐ No If answer is "yes," type of consolidation \_\_\_\_\_

If answer is "no," list the owners and tract descriptions which have actually been consolidated. (Use reverse side of this form if necessary.) \_\_\_\_\_

No allowable will be assigned to the well until all interests have been consolidated (by communitization, unitization, forced-pooling, or otherwise) or until a non-standard unit, eliminating such interests, has been approved by the Commission.

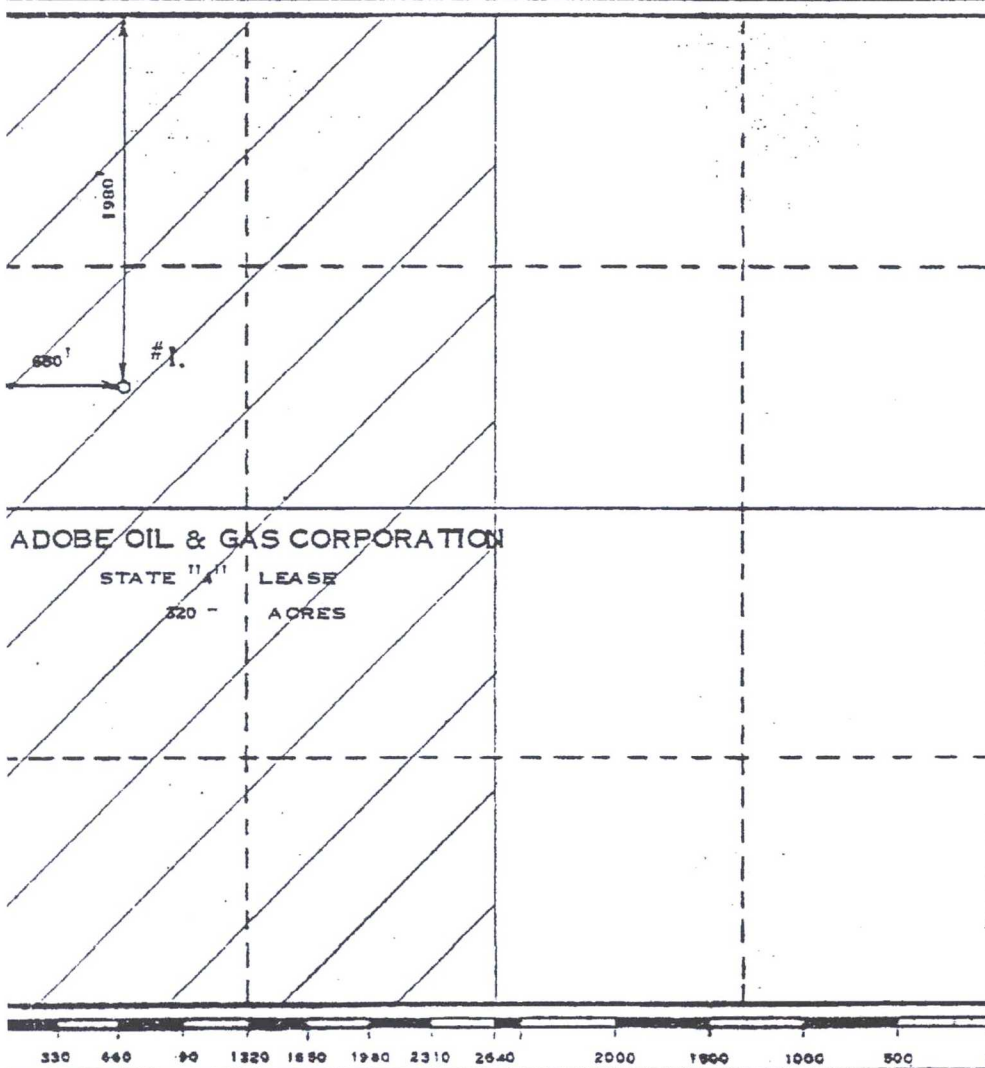

CERTIFICATION

I hereby certify that the information contained herein is true and complete to the best of my knowledge and belief.

Name

M. D. Rogers

Position

Vice President

Company

Adobe Oil & Gas Corporation

Date

July 6, 1979

I hereby certify that the well location shown on this plat was plotted from field notes of actual surveys made by me or under my supervision, and that the same is true and correct to the best of my knowledge and belief.

Date Surveyed

JUNE 29, 1979

Registered Professional Engineer and/or Land Surveyor

KEA & A. SCHWENK JR.

Certificate No.

1510



# CURRENT WELLBORE

## P&A Well

Llano Disposal, LLC

State '4' #1

API # 30-025-26370

1980' FNL x 660' FWL, UL 'E', Sec 4, T13S, R36E, Lea County, NM

