

UNITED STATES
DEPARTMENT OF THE INTERIOR
BUREAU OF LAND MANAGEMENTNMOCD
Hobbs
4FORM APPROVED
OMB NO. 1004-0137
Expires: January 31, 2018**SUNDRY NOTICES AND REPORTS ON WELLS**
*Do not use this form for proposals to drill or to re-enter an abandoned well. Use form 3160-3 (APD) for such proposals.*5. Lease Serial No.
NMNM16353

6. If Indian, Allottee or Tribe Name

7. If Unit or CA/Agreement, Name and/or No.

8. Well Name and No.
OUTRIDER FEDERAL CTB SEE BELOW

9. API Well No.

10. Field and Pool or Exploratory Area
WC-025 G06 S253206M11. County or Parish, State
LEA COUNTY, NM**SUBMIT IN TRIPLICATE - Other instructions on page 2**

1. Type of Well

☒ Oil Well ☐ Gas Well ☐ Other2. Name of Operator
XTO ENERGY INC.Contact: PATTY R URIAS
E-Mail: patty_urias@xtoenergy.com3a. Address
500 W. ILLINOIS SUITE 100
MIDLAND, TX 797013b. Phone No. (include area code)
Ph: 432-620-4318
Fx: 432-618-3530

4. Location of Well (Footage, Sec., T., R., M., or Survey Description)

Sec 27 T24S R32E Mer NMP 170FNL 2115FWL

12. CHECK THE APPROPRIATE BOX(ES) TO INDICATE NATURE OF NOTICE, REPORT, OR OTHER DATA

TYPE OF SUBMISSION	TYPE OF ACTION			
<input checked="" type="checkbox"/> Notice of Intent	<input type="checkbox"/> Acidize	<input type="checkbox"/> Deepen	<input type="checkbox"/> Production (Start/Resume)	<input type="checkbox"/> Water Shut-Off
<input type="checkbox"/> Subsequent Report	<input type="checkbox"/> Alter Casing	<input type="checkbox"/> Hydraulic Fracturing	<input type="checkbox"/> Reclamation	<input type="checkbox"/> Well Integrity
<input type="checkbox"/> Final Abandonment Notice	<input type="checkbox"/> Casing Repair	<input type="checkbox"/> New Construction	<input type="checkbox"/> Recomplete	<input checked="" type="checkbox"/> Other Venting and/or Flaring
	<input type="checkbox"/> Change Plans	<input type="checkbox"/> Plug and Abandon	<input type="checkbox"/> Temporarily Abandon	
	<input type="checkbox"/> Convert to Injection	<input type="checkbox"/> Plug Back	<input type="checkbox"/> Water Disposal	

13. Describe Proposed or Completed Operation: Clearly state all pertinent details, including estimated starting date of any proposed work and approximate duration thereof. If the proposal is to deepen directionally or recompleat horizontally, give subsurface locations and measured and true vertical depths of all pertinent markers and zones. Attach the Bond under which the work will be performed or provide the Bond No. on file with BLM/BIA. Required subsequent reports must be filed within 30 days following completion of the involved operations. If the operation results in a multiple completion or recompleat in a new interval, a Form 3160-4 must be filed once testing has been completed. Final Abandonment Notices must be filed only after all requirements, including reclamation, have been completed and the operator has determined that the site is ready for final inspection.

REQUEST FOR FLARE METERING EXCEPTION**OUTRIDER CTB**

Because there is no flare meter at the OUTRIDER CTB, XTO Energy Inc. is requesting the BLM acknowledge that its method for estimating volumes of flared production from Avalon Delaware Unit TB complies with NTL-4A and, therefore, that no flare meter is required at the OUTRIDER CTB.

XTO estimates the flare start date based on a comparison of the metered sales volume to the daily average sales volumes. Specifically, XTO divides the theoretical flare volume (derived by the difference between the average sales volumes and the actual sales volume for a given duration) by the average daily sales volume and then multiplies that figure by 24 to determine an estimated

**SEE ATTACHED FOR
CONDITIONS OF APPROVAL**

14. I hereby certify that the foregoing is true and correct.

**Electronic Submission #385899 verified by the BLM Well Information System
For XTO ENERGY INC. sent to the Hobbs
Committed to AFMSS for processing by DEBORAH MCKINNEY on 11/09/2017 ()**

Name (Printed/Typed) PATTY R URIAS

Title REGULATORY ANALYST

Signature (Electronic Submission)

Date 08/24/2017

THIS SPACE FOR FEDERAL OR STATE OFFICE USE**APPROVED****FEB 22 2018**

Approved By

Title

Date

Conditions of approval, if any, are attached. Approval of this notice does not warrant or certify that the applicant holds legal or equitable title to those rights in the subject lease which would entitle the applicant to conduct operations thereon.

Office

**BUREAU OF LAND MANAGEMENT
CARLSBAD FIELD OFFICE**

Title 18 U.S.C. Section 1001 and Title 43 U.S.C. Section 1212, make it a crime for any person knowingly and willfully to make to any department or agency of the United States any false, fictitious or fraudulent statements or representations as to any matter within its jurisdiction.

(Instructions on page 2)

**** OPERATOR-SUBMITTED ** OPERATOR-SUBMITTED ** OPERATOR-SUBMITTED ****

Additional data for EC transaction #385899 that would not fit on the form

32. Additional remarks, continued

number of hours.

The sales meter is the first meter for the production (there is no separate production meter). XTO determines the flared volumes by comparing the sales volume during the period of flaring to the average sales volume. Specifically, XTO subtracts the actual sales volume from an average of sales volume (both figures taken from the sales meter). XTO will use a rolling 12 month production average as requested by the BLM for future sundries, as we as revise our prior sundries and OGORs based on the 12 month average.

OUTRIDER FEDERAL CTB

Associated Well(s):

Outrider Federal 6H - API 30-025-42932

Charro Federal 1H - API 30-025-42794

NMM 135839

OUTRIDER FLARE

Month/Year	Avg <u>Daily</u> total	Rolling 12				
		Mo Hourly Avg	Mo Daily Avg			
2015						
January	0					
February	0					
March	0					
April	0					
May	0					
June	0					
July	0					
August	0					
September	0					
October	0					
November	315					
December	775					
12 Month Total						
2016						
January	725	6	151	Total Rolling 12 Months	February-15	to January-16
February	0	6	151	Total Rolling 12 Months	March-15	to February-16
March	1237	11	254	Total Rolling 12 Months	April-15	to March-16
April	190	11	270	Total Rolling 12 Months	May-15	to April-16
May	459	13	308	Total Rolling 12 Months	June-15	to May-16
June	488	15	349	Total Rolling 12 Months	July-15	to June-16
July	537	16	394	Total Rolling 12 Months	August-15	to July-16
August	537	18	439	Total Rolling 12 Months	September-15	to August-16
September	584	20	487	Total Rolling 12 Months	October-15	to September-16
October	774	23	552	Total Rolling 12 Months	November-15	to October-16
November	643	24	579	Total Rolling 12 Months	December-15	to November-16
December	647	24	568	Total Rolling 12 Months	January-16	to December-16
12 Month Total						
2017						
January	732	24	569	Total Rolling 12 Months	February-16	to January-17
February	796	26	635	Total Rolling 12 Months	March-16	to February-17
March	595	24	582	Total Rolling 12 Months	April-16	to March-17
April	335	25	594	Total Rolling 12 Months	May-16	to April-17
May				Total Rolling 12 Months	June-16	to May-17
June				Total Rolling 12 Months	July-16	to June-17
July				Total Rolling 12 Months	August-16	to July-17
August				Total Rolling 12 Months	September-16	to August-17
September				Total Rolling 12 Months	October-16	to September-17
October				Total Rolling 12 Months	November-16	to October-17
November				Total Rolling 12 Months	December-16	to November-17
December				Total Rolling 12 Months	January-17	to December-17
12 Month Total						

V-100
2 PHASE
TEST
SEPARATOR
3' x 10'
1440#

V-200
3 PHASE
TEST
SEPARATOR
3' x 15'
250#

V-300
2 PHASE
TEST
SEPARATOR
3' x 10'
1440#

V-400
3 PHASE
TEST
SEPARATOR
3' x 15'
250#

V-500
L.P. SCRUBBER
3' x 10'
HORIZONTAL
250#

V-600
(FUTURE) PROD
VESSEL
3' x 10'
VERTICAL
250#

V-700
(FUTURE) PROD
VESSEL
3' x 10'
HORIZONTAL
250#

V-800
(FUTURE) TEST
VESSEL
3' x 10'
VERTICAL
250#

T-100
Gun Barrel
750 BBL
15'-8" x 24'

T-200
OIL TANK
1000 BBL
21'-6" x 16'

T-300
OIL TANK
1000 BBL
21'-6" x 16'

T-400
FUTURE OIL TANK
1000 BBL
21'-6" x 16'

T-500
FUTURE SKIM TANK
TANK
1000 BBL
21'-6" x 16'

T-600
WATER TANK
1000 BBL
21'-6" x 16'

T-700
OIL SWING TANK
1000 BBL
21'-6" x 16'

T-800
FUTURE WATER
TANK
1000 BBL
21'-6" x 16'

P-100
2" ROVER
GEAR PUMP
1.5 H.P.
1200RPM

F-100
FLARE
45' TORNADO

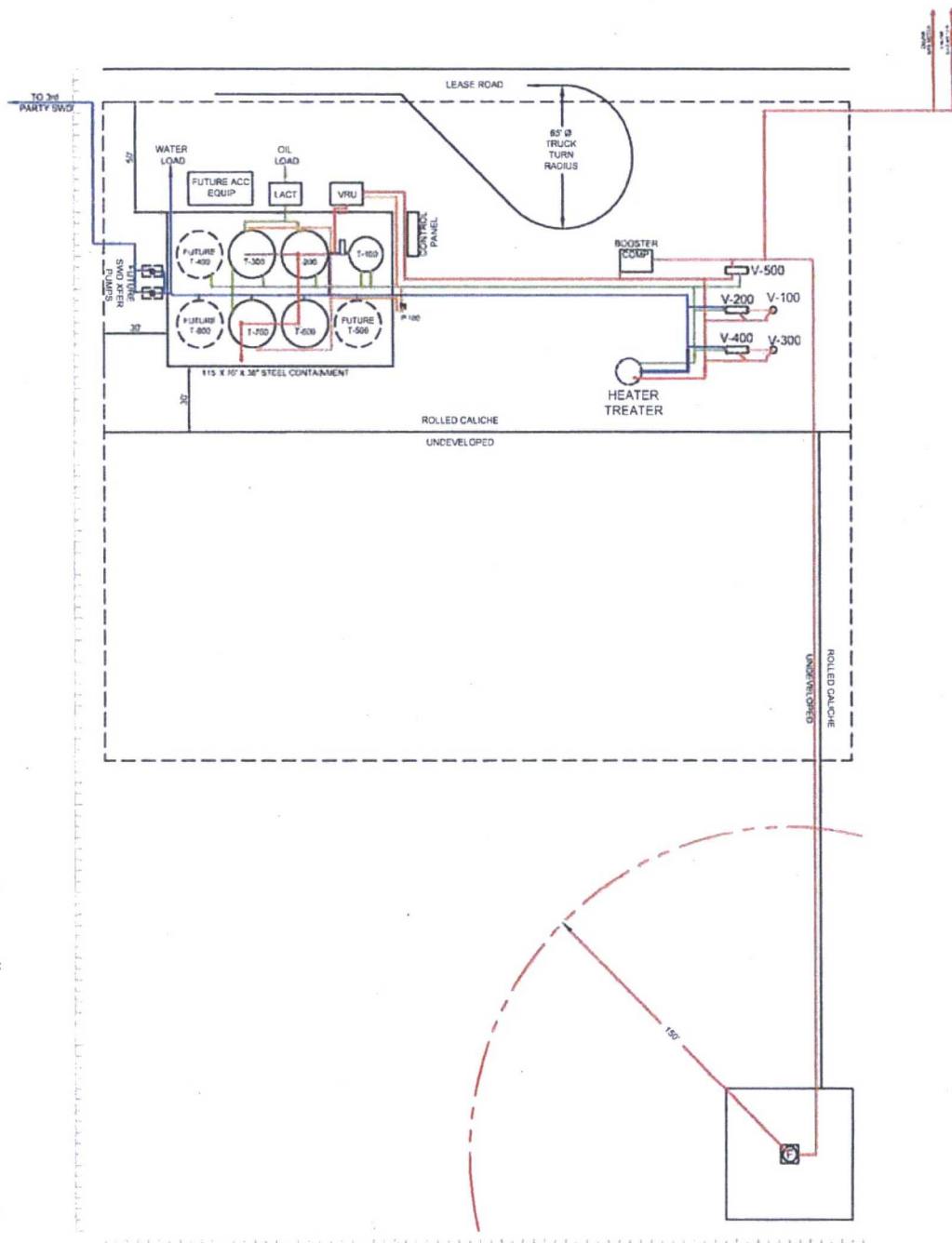

NOTE:

- 1) FLARE LINE TO BE BURIED OR STEEL TO 150' FROM FLARE
- 2) SET FLARE CONTROLS AT LEAST 150' FROM FLARE

Revision	Description of Change	Date	By
0	FLARE REPORTING	10/21/11	DWS



OUTRIDER
CENTRAL TANK BATTERY
LEA COUNTY, NEW MEXICO

LEASE FLOW DIAGRAM

OUTRIDER CTB LEASE FLOW DIAGRAM

Company	Division	Fed	State	Disc Type	Equip	Disc If	Revised
---------	----------	-----	-------	-----------	-------	---------	---------

BUREAU OF LAND MANAGEMENT
Carlsbad Field Office
620 East Greene Street
Carlsbad, New Mexico 88220
575-234-5972

Condition of Approval to Flare Gas

1. Subject to like approval from NMOCD
2. Flared volumes are considered "avoidably lost" and will require payment of royalties. Volumes shall be reported on OGOR "B" reports as disposition code "08
3. Approval not to exceed 90 days, if flaring is still required past 90 days submit new request for approval.
4. Submit Subsequent Report with actual volumes of gas flared for each month gas is flared on a sundry form 3160-5.
5. ~~5.~~ *(variance approved for meter exception)* "Avoidably lost" flare volumes shall be metered due to their royalty bearing status. Install gas meter on vent/flare line to measure gas prior to venting/flaring operations if it is not equipped as such at this time.
6. This approval does not authorize any additional surface disturbance.

43CFR §3162.7-1 Disposition of production.

(a) The operator shall put into marketable condition, if economically feasible, all oil, other hydrocarbons, gas, and sulphur produced from the leased land.

(d) The operator shall conduct operations in such a manner as to prevent avoidable loss of oil and gas. A operator shall be liable for royalty payments on oil or gas lost or wasted from a lease site, or allocated to a lease site, when such loss or waste is due to negligence on the part of the operator of such lease, or due to the failure of the operator to comply with any regulation, order or citation issued pursuant to this part.