

UNITED STATES
DEPARTMENT OF THE INTERIOR
BUREAU OF LAND MANAGEMENT

OCD Hobbs

FORM APPROVED
OMB NO. 1004-0135
Expires: July 31, 2010

SUNDRY NOTICES AND REPORTS ON WELLS
Do not use this form for proposals to drill or to re-enter an abandoned well. Use form 3160-3 (APD) for such proposals.

HOBBS

5. Lease Serial No.
NMNM34850

6. If Indian, Allottee or Tribe Name

7. Unit or CA/Agreement, Name and/or No.

SUBMIT IN TRIPLICATE - Other instructions on reverse side.

MAY 08 2018

RECEIVED

1. Type of Well <input checked="" type="checkbox"/> Oil Well <input type="checkbox"/> Gas Well <input type="checkbox"/> Other		8. Well Name and No. MALACHITE 22 FEDERAL 2H
2. Name of Operator DEVON ENERGY PRODUCTION CO Contact: DENISE MENOUD Email: Denise.Menoud@dev.com		9. API Well No. 30-025-40389
3a. Address PO BOX 250 ARTESIA, NM 88211	3b. Phone No. (include area code) Ph: 575-746-5544	10. Field and Pool, or Exploratory TONTON; BONE SPRING
4. Location of Well (Footage, Sec., T., R., M., or Survey Description) Sec 22 T19S R33E NENW 330FNL 1465FWL 32.652046 N Lat, 103.654800 W Lon		11. County or Parish, and State LEA COUNTY, NM

12. CHECK APPROPRIATE BOX(ES) TO INDICATE NATURE OF NOTICE, REPORT, OR OTHER DATA

TYPE OF SUBMISSION	TYPE OF ACTION			
<input type="checkbox"/> Notice of Intent	<input type="checkbox"/> Acidize	<input type="checkbox"/> Deepen	<input type="checkbox"/> Production (Start/Resume)	<input type="checkbox"/> Water Shut-Off
<input checked="" type="checkbox"/> Subsequent Report	<input type="checkbox"/> Alter Casing	<input type="checkbox"/> Fracture Treat	<input checked="" type="checkbox"/> Reclamation	<input type="checkbox"/> Well Integrity
<input type="checkbox"/> Final Abandonment Notice	<input type="checkbox"/> Casing Repair	<input type="checkbox"/> New Construction	<input type="checkbox"/> Recomplete	<input type="checkbox"/> Other
	<input type="checkbox"/> Change Plans	<input type="checkbox"/> Plug and Abandon	<input type="checkbox"/> Temporarily Abandon	
	<input type="checkbox"/> Convert to Injection	<input type="checkbox"/> Plug Back	<input type="checkbox"/> Water Disposal	

13. Describe Proposed or Completed Operation (clearly state all pertinent details, including estimated starting date of any proposed work and approximate duration thereof. If the proposal is to deepen directionally or recomple horizontally, give subsurface locations and measured and true vertical depths of all pertinent markers and zones. Attach the Bond under which the work will be performed or provide the Bond No. on file with BLM/BIA. Required subsequent reports shall be filed within 30 days following completion of the involved operations. If the operation results in a multiple completion or recomple in a new interval, a Form 3160-4 shall be filed once testing has been completed. Final Abandonment Notices shall be filed only after all requirements, including reclamation, have been completed, and the operator has determined that the site is ready for final inspection.)

THIS LOCATION HAS BEEN DOWNSIZED. TOTAL ACRES RECLAIMED = 1.3464

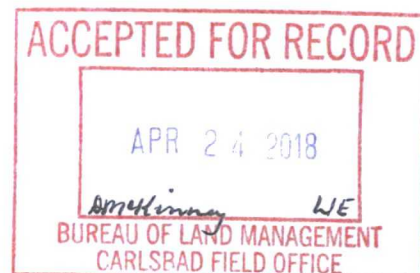

4/24/18 - OK to approve (HP)

14. I hereby certify that the foregoing is true and correct. Electronic Submission #318848 verified by the BLM Well Information System For DEVON ENERGY PRODUCTION CO LP, sent to the Hobbs Committed to AFMSS for processing by LINDA JIMENEZ on 10/21/2015 ()	
Name (Printed/Typed) DENISE MENOUD	Title AUTHORIZED REPRESENTATIVE
Signature (Electronic Submission)	Date 10/06/2015

THIS SPACE FOR FEDERAL OR STATE OFFICE USE

Approved By _____	Title _____	Date _____
Conditions of approval, if any, are attached. Approval of this notice does not warrant or certify that the applicant holds legal or equitable title to those rights in the subject lease which would entitle the applicant to conduct operations thereon.		Office _____

Title 18 U.S.C. Section 1001 and Title 43 U.S.C. Section 1212, make it a crime for any person knowingly and willfully to make to any department or agency of the United States any false, fictitious or fraudulent statements or representations as to any matter within its jurisdiction.

** OPERATOR-SUBMITTED ** OPERATOR-SUBMITTED ** OPERATOR-SUBMITTED **

For Record Only
MUS/ocd 5/8/2018



**Interim
Site
Reclamation**

Devon Energy Prod. Co.

Malachite 22 Fed 2H
API #30-025-40389

Sec. 22-T19S-R33E

Lea County, NM



 Area
Reclaimed
= 1.3464 Acres

D. Menoud

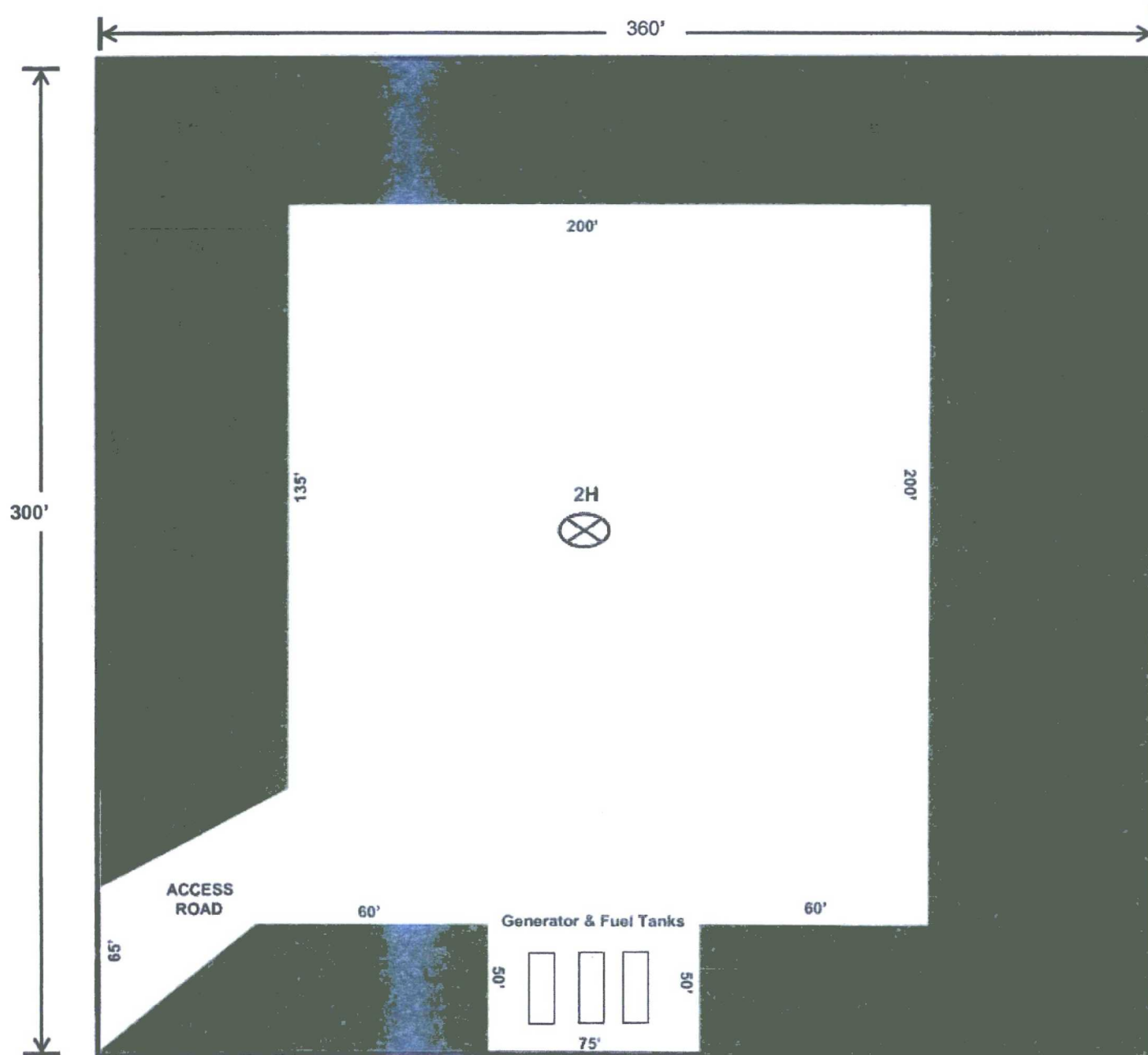

devon

**Proposed Interim
Site Reclamation**

Devon Energy Production Co.

Malachite 22 Federal 2H
330' FNL & 1,465' FWL
Sec. 22 - T19S - R33E
Lea County, NM

Proposed
Reclamation Area



1" : 60'

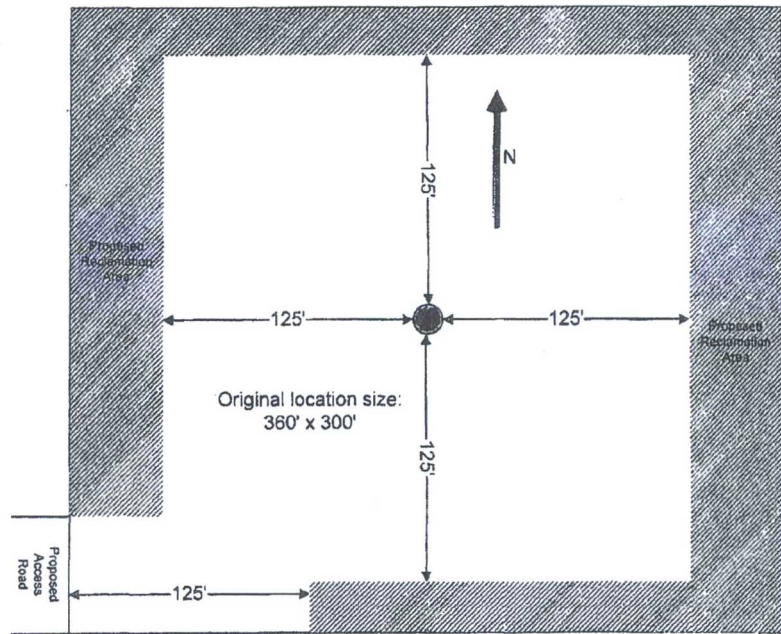

Production/Interim Reclamation Inspection/Monitoring - Environmental

Case #: **NMNM 34850**

Lease #: **NMNM 34850**

Operator: **Devon** Present: Yes ☐ No ☒

Twn: **19S** Rng: **33E** County: **Lea**

Sec: **22** Qtr: **NE** State: **NM**

N/S Foot: **330** E/W Foot: **1465** Lat.: Long.:

Surface Owner: **BLM** Present: Yes ☒ No ☐

Well Name: **MALACHITE 22 fed 2004**

Well #: **24**

API #: **30-025-40389**

Facility ID:

Facility Name:

H2S: Yes ☐ No ☐

Inspection Activity: ES-- Choose

an item **12**

Office Time:

Travel Time: **1.5**

Inspection Time: **1.0**

Trips: **1**

Inspection Open Date: Click

Inspection Close Date: Click here to

Inspector:

here to enter a date **3/30/18**

enter a date.

H. Prieto

Inspection Items

Constructed as Per the Permit Requirements and Utilizing BMPs as Appropriate?

Unauthorized Disturbance?

Met	Not Met	N/A	Order/INC
<input checked="" type="checkbox"/>	<input type="checkbox"/>	<input type="checkbox"/>	<input type="checkbox"/>
<input checked="" type="checkbox"/>	<input type="checkbox"/>	<input type="checkbox"/>	<input type="checkbox"/>

Interim Reclamation: Pads and Roads

1. Facilities Clustered and Sited to Maximize Interim Reclamation

2. Recontoured and Compacted Areas Ripped

3. Topsoil Redistributed on Majority of the Disturbed Areas

4. Seeded- Yes ☐ No ☐ Method: **Not sure. Mostly Annuals on location.**

5. Reveg. Close to the Wellhead

6. Reveg. Close to Road Surface

7. Revegetation Success **Good coverage (annuals). But recommend seeding**

8. Erosion and Runoff Controlled **Erosion issues @ entrance.**

9. Mulch? Yes ☐ No ☐ Type: Fertilized? Yes ☐ No ☐

10. Free of Noxious & Invasive Weeds

Interim Reclamation Approved? Yes ☐ No ☒ Work Needed- **seeding.**

<input checked="" type="checkbox"/>	<input type="checkbox"/>	<input type="checkbox"/>	<input type="checkbox"/>
<input checked="" type="checkbox"/>	<input type="checkbox"/>	<input type="checkbox"/>	<input type="checkbox"/>
<input type="checkbox"/>	<input checked="" type="checkbox"/>	<input type="checkbox"/>	<input type="checkbox"/>
<input type="checkbox"/>	<input checked="" type="checkbox"/>	<input type="checkbox"/>	<input type="checkbox"/>
<input checked="" type="checkbox"/>	<input type="checkbox"/>	<input type="checkbox"/>	<input type="checkbox"/>
<input type="checkbox"/>	<input checked="" type="checkbox"/>	<input type="checkbox"/>	<input type="checkbox"/>
<input type="checkbox"/>	<input checked="" type="checkbox"/>	<input type="checkbox"/>	<input type="checkbox"/>
<input checked="" type="checkbox"/>	<input type="checkbox"/>	<input checked="" type="checkbox"/>	<input type="checkbox"/>
<input checked="" type="checkbox"/>	<input type="checkbox"/>	<input type="checkbox"/>	<input type="checkbox"/>
<input type="checkbox"/>	<input checked="" type="checkbox"/>	<input type="checkbox"/>	<input type="checkbox"/>

Roads:

1. Proper Drainage

2. Culverts

3. Surface Material

4. Gates

5. Cattleguards

6. Maintenance

<input checked="" type="checkbox"/>	<input type="checkbox"/>	<input type="checkbox"/>	<input type="checkbox"/>
<input type="checkbox"/>	<input type="checkbox"/>	<input checked="" type="checkbox"/>	<input type="checkbox"/>
<input checked="" type="checkbox"/>	<input type="checkbox"/>	<input type="checkbox"/>	<input type="checkbox"/>
<input type="checkbox"/>	<input type="checkbox"/>	<input checked="" type="checkbox"/>	<input type="checkbox"/>
<input type="checkbox"/>	<input type="checkbox"/>	<input checked="" type="checkbox"/>	<input type="checkbox"/>
<input checked="" type="checkbox"/>	<input type="checkbox"/>	<input checked="" type="checkbox"/>	<input type="checkbox"/>

Pipeline and Power Line Corridors:

1. Erosion Controlled

2. Final Reclamation

Approved Yes ☒ No ☐

3. Power Lines Exclude Raptors **no.**

<input checked="" type="checkbox"/>	<input type="checkbox"/>	<input type="checkbox"/>	<input type="checkbox"/>
<input checked="" type="checkbox"/>	<input type="checkbox"/>	<input type="checkbox"/>	<input type="checkbox"/>
<input checked="" type="checkbox"/>	<input checked="" type="checkbox"/>	<input type="checkbox"/>	<input type="checkbox"/>

Production Facilities:

Color/Screening: Painted to Blend with the Vegetated Background **black/brown**

Tank Berm: Maintained and Adequate Capacity

Exhaust Stacks: Constructed to Prevent Bird/Bat Mortality

Number and Types of Facilities:

<input type="checkbox"/>	<input type="checkbox"/>	<input type="checkbox"/>	<input type="checkbox"/>
<input type="checkbox"/>	<input type="checkbox"/>	<input type="checkbox"/>	<input type="checkbox"/>
<input type="checkbox"/>	<input type="checkbox"/>	<input type="checkbox"/>	<input type="checkbox"/>
<input type="checkbox"/>	<input type="checkbox"/>	<input type="checkbox"/>	<input type="checkbox"/>

Management of Wastes and Spills:

1. Spills or leaks **none found**

<input checked="" type="checkbox"/>	<input type="checkbox"/>	<input type="checkbox"/>	<input type="checkbox"/>
-------------------------------------	--------------------------	--------------------------	--------------------------

**Pumpjack painted Tan.
Berms present around the well pad.**