

DISTRICT I  
1625 N. French Dr., Hobbs, NM 88240  
Phone: (575) 393-6161 Fax: (575) 393-0720

DISTRICT II  
811 S. First St., Artesia, NM 88210  
Phone: (575) 748-1283 Fax: (575) 748-3531

DISTRICT III  
1000 Rio Brazos Road, Aztec, NM 87410  
Phone: (505) 334-6178 Fax: (505) 334-6170

DISTRICT IV  
1220 S. St. Francis Dr., Santa Fe, NM 87505  
Phone: (505) 476-3460 Fax: (505) 476-3462

State of New Mexico  
Energy, Minerals & Natural Resources Department  
OIL CONSERVATION DIVISION  
1220 South St. Francis Dr.  
Santa Fe, New Mexico 87505

Form C-102  
Revised August 1, 2011  
Submit one copy to appropriate  
District Office

AMENDED REPORT

WELL LOCATION AND ACREAGE DEDICATION PLAT

API Number 30-025-42849	Pool Code 97838	Pool Name JENNINGS; UPPER BONE SPRING SHALE
Property Code 305301	Property Name MESA 8105 JV-P	Well Number 13H
OGRID No 260297	Operator Name BTA OIL PRODUCERS, LLC	Elevation 3315'

Surface Location

UL or lot No.	Section	Township	Range	Lot Idn	Feet from the	North/South line	Feet from the	East/West line	County
O	1	26-S	32-E		310	SOUTH	1334	EAST	LEA

As-Drilled Bottom Hole Location If Different From Surface

UL or lot No.	Section	Township	Range	Lot Idn	Feet from the	North/South line	Feet from the	East/West line	County
P	12	26-S	32-E		223.8	SOUTH	1295.2	EAST	LEA

Dedicated Acres 160	Joint or Infill	Consolidation Code	Order No.
------------------------	-----------------	--------------------	-----------

NO ALLOWABLE WILL BE ASSIGNED TO THIS COMPLETION UNTIL ALL INTERESTS HAVE BEEN CONSOLIDATED OR A NON-STANDARD UNIT HAS BEEN APPROVED BY THE DIVISION

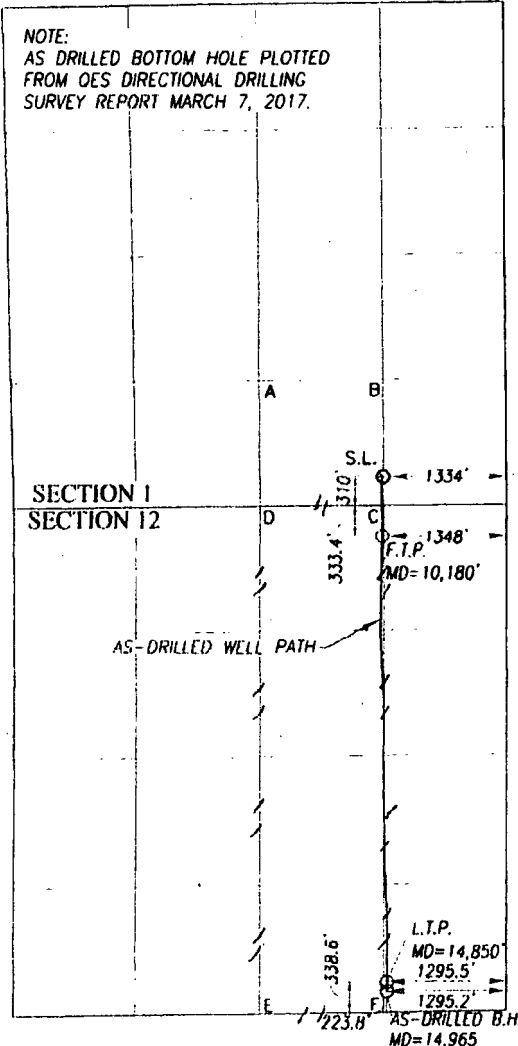

SCALE: 1"=2000'

GEODETIC COORDINATES	GEODETIC COORDINATES
NAD 27 NME	NAD 83 NME
SURFACE LOCATION	SURFACE LOCATION
Y=388375.7 N	Y=388433.1 N
X=719843.0 E	X=761029.8 E
LAT.=32.065773° N	LAT.=32.065898° N
LONG.=103.623651° W	LONG.=103.624121° W
FIRST TAKE POINT	FIRST TAKE POINT
NAD 27 NME	NAD 83 NME
Y=387732.3 N	Y=387789.7 N
X=719835.3 E	X=761022.2 E
LAT.=32.064005° N	LAT.=32.064130° N
LONG.=103.623690° W	LONG.=103.624160° W
CORNER COORDINATES TABLE	CORNER COORDINATES TABLE
NAD 27 NME	NAD 83 NME
A - Y=389391.1 N, X=718504.7 E	A - Y=389448.6 N, X=759691.5 E
B - Y=389405.1 N, X=719835.1 E	B - Y=389462.5 N, X=761021.8 E
C - Y=388065.8 N, X=719852.3 E	C - Y=388123.2 N, X=761039.1 E
D - Y=388053.0 N, X=718523.7 E	D - Y=388110.4 N, X=759710.5 E
E - Y=382711.4 N, X=718554.5 E	E - Y=382768.7 N, X=759741.5 E
F - Y=382729.0 N, X=719884.8 E	F - Y=382786.2 N, X=761071.9 E
CORNER COORDINATES TABLE	CORNER COORDINATES TABLE
NAD 83 NME	NAD 83 NME
A - Y=389391.1 N, X=718504.7 E	A - Y=389448.6 N, X=759691.5 E
B - Y=389405.1 N, X=719835.1 E	B - Y=389462.5 N, X=761021.8 E
C - Y=388065.8 N, X=719852.3 E	C - Y=388123.2 N, X=761039.1 E
D - Y=388053.0 N, X=718523.7 E	D - Y=388110.4 N, X=759710.5 E
E - Y=382711.4 N, X=718554.5 E	E - Y=382768.7 N, X=759741.5 E
F - Y=382729.0 N, X=719884.8 E	F - Y=382786.2 N, X=761071.9 E
LAST TAKE POINT	LAST TAKE POINT
NAD 27 NME	NAD 83 NME
Y=383068.0 N	Y=383125.3 N
X=719917.8 E	X=761104.8 E
LAT.=32.051182° N	LAT.=32.051307° N
LONG.=103.623522° W	LONG.=103.623992° W
GEODETIC COORDINATES	GEODETIC COORDINATES
NAD 27 NME	NAD 83 NME
AS-DRILLED	AS-DRILLED
BOTTOM HOLE LOCATION	BOTTOM HOLE LOCATION
Y=382953.2 N	Y=383010.5 N
X=719918.7 E	X=761105.8 E
LAT.=32.050866° N	LAT.=32.050991° N
LONG.=103.623522° W	LONG.=103.623991° W

**OPERATOR CERTIFICATION**

I hereby certify that the information herein is true and complete to the best of my knowledge and belief, and that this organization either owns a working interest or unleased mineral interest in the land including the proposed bottom hole location or has a right to drill this well at this location pursuant to a contract with an owner of such mineral or working interest, or to a voluntary pooling agreement or a compulsory pooling order heretofore entered by the division.

Signature: *Kayla McConnell* Date: 5/11/18

Printed Name: KAYLA MCCONNELL

E-mail Address: KMCCONNELL@BTAOIL.COM

**SURVEYOR CERTIFICATION**

I hereby certify that the well location shown on this plat was plotted from field notes of actual surveys made by me or under my supervision, and that the same is true and correct to the best of my belief.

Date of Survey: AUGUST 18, 2014

Signature: *Ronald J. Eidson*

Professional Surveyor

NEW MEXICO

3239

Certificate Number: 12641

Ronald J. Eidson

DSS REL W O 17 13 0988 JWSC W O: 18 13 0459