

UNITED STATES
DEPARTMENT OF THE INTERIOR
BUREAU OF LAND MANAGEMENTCarlsbad Field Office
OCD HobbsFORM APPROVED
OMB NO. 1004-0137
Expires: January 31, 2018

SUNDRY NOTICES AND REPORTS ON WELLS

Do not use this form for proposals to drill or to re-enter an
abandoned well. Use form 3160-3 (APD) for such proposals.5. Lease Serial No.
NMNM43564

6. If Indian, Allottee or Tribe Name

7. If Unit or CA/Agreement, Name and/or No.

8. Well Name and No.
GAUCHO 21 FED 6H9. API Well No.
30-025-44178-00-X110. Field and Pool or Exploratory Area
WC025G06S223421L-BONE SPRING11. County or Parish, State
LEA COUNTY, NM

SUBMIT IN TRIPLICATE - Other instructions on page 2

AUG 16 2018

RECEIVED

1. Type of Well

☒ Oil Well ☐ Gas Well ☐ Other

2. Name of Operator

DEVON ENERGY PRODUCTION COMPANY

Contact: TRAVIS D PHIBBS
Email: travis.phibbs@dev.com

3a. Address

333 WEST SHERIDAN AVENUE
OKLAHOMA CITY, OK 73102

3b. Phone No. (include area code)

Ph: 865-804-3856

4. Location of Well (Footage, Sec., T., R., M., or Survey Description)

Sec 21 T22S R34E 175FSL 185FEL
32.370411 N Lat, 103.467056 W Lon

12. CHECK THE APPROPRIATE BOX(ES) TO INDICATE NATURE OF NOTICE, REPORT, OR OTHER DATA

TYPE OF SUBMISSION	TYPE OF ACTION			
<input checked="" type="checkbox"/> Notice of Intent	<input type="checkbox"/> Acidize	<input type="checkbox"/> Deepen	<input type="checkbox"/> Production (Start/Resume)	<input type="checkbox"/> Water Shut-Off
<input type="checkbox"/> Subsequent Report	<input type="checkbox"/> Alter Casing	<input type="checkbox"/> Hydraulic Fracturing	<input type="checkbox"/> Reclamation	<input type="checkbox"/> Well Integrity
<input type="checkbox"/> Final Abandonment Notice	<input type="checkbox"/> Casing Repair	<input type="checkbox"/> New Construction	<input type="checkbox"/> Recomplete	<input checked="" type="checkbox"/> Other
	<input type="checkbox"/> Change Plans	<input type="checkbox"/> Plug and Abandon	<input type="checkbox"/> Temporarily Abandon	Surface Disturbance
	<input type="checkbox"/> Convert to Injection	<input type="checkbox"/> Plug Back	<input type="checkbox"/> Water Disposal	

13. Describe Proposed or Completed Operation: Clearly state all pertinent details, including estimated starting date of any proposed work and approximate duration thereof. If the proposal is to deepen directionally or recompleat horizontally, give subsurface locations and measured and true vertical depths of all pertinent markers and zones. Attach the Bond under which the work will be performed or provide the Bond No. on file with BLM/BIA. Required subsequent reports must be filed within 30 days following completion of the involved operations. If the operation results in a multiple completion or recompleat in a new interval, a Form 3160-4 must be filed once testing has been completed. Final Abandonment Notices must be filed only after all requirements, including reclamation, have been completed and the operator has determined that the site is ready for final inspection.

Respectfully request approval to build road to access Gaucho 21 Well Pad 2 and CTB 7.

Please see attached plat. This road is pre-approved in Gaucho MDP 1, but not included in the APD for the Gaucho 21 Fed 6H.

NRS JB 7-17-2018 OK DOI-BLM-NM-P020-2017-0467-EA

14. I hereby certify that the foregoing is true and correct.

Electronic Submission #427279 verified by the BLM Well Information System

For DEVON ENERGY PRODUCTION COMPANY, sent to the Hobbs

Committed to AFMSS for processing by PRISCILLA PEREZ on 07/16/2018 (18PP1450SE)

Name (Printed/Typed) TRAVIS D PHIBBS

Title FIELD LANDMAN

Signature (Electronic Submission)

Date 07/13/2018

THIS SPACE FOR FEDERAL OR STATE OFFICE USE

Approved By

Cody R. Lytle

Title

AFM - C & M

Date

08/14/2018

Conditions of approval, if any, are attached. Approval of this notice does not warrant or certify that the applicant holds legal or equitable title to those rights in the subject lease which would entitle the applicant to conduct operations thereon.

Office

CFO

Title 18 U.S.C. Section 1001 and Title 43 U.S.C. Section 1212, make it a crime for any person knowingly and willfully to make to any department or agency of the United States any false, fictitious or fraudulent statements or representations as to any matter within its jurisdiction.

(Instructions on page 2)

** BLM REVISED ** BLM REVISED ** BLM REVISED ** BLM REVISED ** BLM REVISED **

MLB/OCD
8/20/2018

ACCESS ROAD TO THE GAUCHO 21 FEDERAL 3H & 4H AND GAUCHO 21-21 PAD/CTB 8, 6, 7, & 2

17 16
BC 1913 N89°24'06"E 2638.77 FT BC 1913 N89°40'23"E 2651.63 FT 16 15
20 21 21 22 BC 1913

00°22'59"W 2641.20 FT
STA 0+00 B.O.R. AT EXIST. 20' CLR
STA 4+58.2 PI LEFT

STA 14+98.3 PI LEFT
STA 19+72.4 PI RIGHT
STA 36+17.4 PI RIGHT "T" LEFT
STA 41+87.6 PI LEFT "T" LEFT
STA 47+38.1 PI RIGHT
STA 48+58.3 E.O.R.

00°18'37"E 2640.31 FT

SEC 21
T.22S., R.34E.
BLM

(TIE)
S85°09'04"W
709.73 FT
(TIE)
S47°05'49"W
965.48 FT
STA 0+00 BEGIN SW RD.
STA 36+17.4 MAIN RD.
STA 0+30.0 PROP. DEVON ELEC.
STA 5+97.3 END SW RD.

GAUCHO 21-21
PAD/CIB 5
SW ROAD
N00°00'10"E
597.27 FT
SE ROAD
N00°00'07"W
602.96 FT
STA 0+00 BEGIN SE RD.
STA 41+87.6 MAIN RD.
STA 0+35.3 PROP. DEVON ELEC.
PROP. POLE #8 TO BE RELOCATED
STA 6+03.0 END SE RD.
GAUCHO 21-21
PAD/CIB 2
GAUCHO 21-21
PAD/CIB 7
EXISTING
20' CLR
GAUCHO 21
FEDERAL 3- & 4-
S00°00'09"E
458.24 FT
N89°59'59"E
1040.06 FT
N89°59'56"E
570.23 FT
S85°55'23"E
121.12 FT
N89°59'56"E
570.23 FT
S85°55'23"E
121.12 FT
S89°40'20"W 2651.02 FT
N87°59'50"E 474.05 FT
N89°28'00"E 1645.00 FT
BC 1913
S89°25'21"W 2644.08 FT
N88°55'07"E 550.56 FT
S87°06'25"E 696.14 FT
(TIE)
1/2" REB

00°08'08"W 2638.50 FT
00°57'W 9.69 FT
20 21 21 22
29 28 28 27

MADRON SURVEYING, INC. 301 SOUTH CANAL
(575) 234-3641 CARLSBAD, NEW MEXICO

MADRON SURVEYING, INC
301 SOUTH CANAL
CARLSBAD, NEW MEXICO 88220
Phone (575) 234-3341

SURVEY NO. 4483B

ACCESS ROAD PLAT

ACCESS ROAD TO THE GAUCHO 21 FEDERAL 3H & 4H AND GAUCHO 21-21 PAD/CTB 8, 6, 7, & 2

DEVON ENERGY PRODUCTION COMPANY, L.P.
CENTERLINE SURVEY OF AN ACCESS ROAD CROSSING
SECTION 21, TOWNSHIP 22 SOUTH, RANGE 34 EAST, N.M.P.M.
LEA COUNTY, STATE OF NEW MEXICO
JULY 13, 2018

DESCRIPTION

A STRIP OF LAND 30 FEET WIDE CROSSING BUREAU OF LAND MANAGEMENT LAND IN SECTION 21, TOWNSHIP 22 SOUTH, RANGE 34 EAST, N.M.P.M., LEA COUNTY, STATE OF NEW MEXICO AND BEING 15 FEET EACH SIDE OF THE FOLLOWING DESCRIBED CENTERLINE SURVEY:

MAIN ACCESS ROAD

BEGINNING AT A POINT WITHIN THE SW/4 SW/4 OF SAID SECTION 21, TOWNSHIP 22 SOUTH, RANGE 34 EAST, N.M.P.M., WHENCE THE SOUTHWEST CORNER OF SAID SECTION 21, TOWNSHIP 22 SOUTH, RANGE 34 EAST, N.M.P.M. BEARS S21°40'57"W, A DISTANCE OF 539.69 FEET;

THENCE S00°00'09"E A DISTANCE OF 458.24 FEET TO AN ANGLE POINT OF THE LINE HEREIN DESCRIBED;
THENCE N89°59'59"E A DISTANCE OF 1040.06 FEET TO AN ANGLE POINT OF THE LINE HEREIN DESCRIBED;
THENCE N87°59'50"E A DISTANCE OF 474.05 FEET TO AN ANGLE POINT OF THE LINE HEREIN DESCRIBED;
THENCE N89°28'00"E A DISTANCE OF 1645.00 FEET TO AN ANGLE POINT OF THE LINE HEREIN DESCRIBED;
THENCE N89°59'56"E A DISTANCE OF 570.23 FEET TO AN ANGLE POINT OF THE LINE HEREIN DESCRIBED;
THENCE N88°55'07"E A DISTANCE OF 550.56 FEET TO AN ANGLE POINT OF THE LINE HEREIN DESCRIBED;
THENCE S85°55'23"E A DISTANCE OF 121.12 FEET THE TERMINUS OF THIS CENTERLINE SURVEY, WHENCE THE SOUTHEAST CORNER OF SAID SECTION 21, TOWNSHIP 22 SOUTH, RANGE 34 EAST, N.M.P.M. BEARS S87°06'25"E, A DISTANCE OF 696.14 FEET;

SAID STRIP OF LAND BEING 4859.26 FEET OR 294.50 RODS IN LENGTH, CONTAINING 3.347 ACRES MORE OR LESS AND BEING ALLOCATED BY FORTIES AS FOLLOWS:

SW/4 SW/4	1584.18 L.F.	96.01 RODS	1.091 ACRES
SE/4 SW/4	1325.58 L.F.	80.34 RODS	0.913 ACRES
SW/4 SE/4	1322.09 L.F.	80.13 RODS	0.911 ACRES
SE/4 SE/4	627.41 L.F.	38.02 RODS	0.432 ACRES

SOUTHWEST ACCESS ROAD

BEGINNING AT A POINT WITHIN THE SW/4 SE/4 OF SAID SECTION 21, TOWNSHIP 22 SOUTH, RANGE 34 EAST, N.M.P.M., WHENCE THE SOUTH QUARTER CORNER OF SAID SECTION 21, TOWNSHIP 22 SOUTH, RANGE 34 EAST, N.M.P.M. BEARS S85°09'04"W, A DISTANCE OF 709.73 FEET;

THENCE N00°00'10"E A DISTANCE OF 597.27 FEET THE TERMINUS OF THIS CENTERLINE SURVEY, WHENCE THE SOUTH QUARTER CORNER OF SAID SECTION 21, TOWNSHIP 22 SOUTH, RANGE 34 EAST, N.M.P.M. BEARS S47°05'49"W, A DISTANCE OF 965.48 FEET;

SAID STRIP OF LAND BEING 597.27 FEET OR 36.20 RODS IN LENGTH, CONTAINING 0.411 ACRES MORE OR LESS AND BEING ALLOCATED BY FORTIES AS FOLLOWS:

SW/4 SE/4	597.27 L.F.	36.20 RODS	0.411 ACRES
-----------	-------------	------------	-------------

SOUTHEAST ACCESS ROAD

BEGINNING AT A POINT WITHIN THE SW/4 SE/4 OF SAID SECTION 21, TOWNSHIP 22 SOUTH, RANGE 34 EAST, N.M.P.M., WHENCE THE SOUTHEAST CORNER OF SAID SECTION 21, TOWNSHIP 22 SOUTH, RANGE 34 EAST, N.M.P.M. BEARS S88°36'07"E, A DISTANCE OF 1366.93 FEET;

THENCE N00°00'07"W A DISTANCE OF 602.96 FEET THE TERMINUS OF THIS CENTERLINE SURVEY, WHENCE THE SOUTHEAST CORNER OF SAID SECTION 21, TOWNSHIP 22 SOUTH, RANGE 34 EAST, N.M.P.M. BEARS S65°01'53"E, A DISTANCE OF 1507.43 FEET;

SAID STRIP OF LAND BEING 602.96 FEET OR 36.54 RODS IN LENGTH, CONTAINING 0.415 ACRES MORE OR LESS AND BEING ALLOCATED BY FORTIES AS FOLLOWS:

SW/4 SE/4	602.96 L.F.	36.54 RODS	0.415 ACRES
-----------	-------------	------------	-------------

SURVEYOR CERTIFICATE

I, FILMON F. JARAMILLO, A NEW MEXICO PROFESSIONAL SURVEYOR NO. 12797, HEREBY CERTIFY THAT I HAVE CONDUCTED AND AM RESPONSIBLE FOR THIS SURVEY, THAT THIS SURVEY IS TRUE AND CORRECT TO THE BEST OF MY KNOWLEDGE AND BELIEF, AND THAT THIS SURVEY AND PLAT MEET THE MINIMUM STANDARDS FOR LAND SURVEYING IN THE STATE OF NEW MEXICO.

IN WITNESS WHEREOF, THIS CERTIFICATE IS EXECUTED AT CARLSBAD,

NEW MEXICO, THIS 13 DAY OF JULY 2018.

Filmon F. Jaramillo
FILMON F. JARAMILLO, PLS. #12797

MADRON SURVEYING, INC.
301 SOUTH CANAL
CARLSBAD, NEW MEXICO 88220
Phone (575) 234-1341

GENERAL NOTES

1.) THE INTENT OF THIS ROUTE SURVEY IS TO ACQUIRE AN EASEMENT.

2.) BASIS OF BEARING AND DISTANCE IS NMSP EAST (NAD83) MODIFIED TO SURFACE COORDINATES. NAD 83 (FEET) AND NAVD 88 (FEET) COORDINATE SYSTEMS USED IN THE SURVEY.

SHEET: 2-4

MADRON SURVEYING, INC. 301 SOUTH CANAL CARLSBAD, NEW MEXICO
(575) 234-1341

SURVEY NO. 4483B

ACCESS ROAD TO THE GAUCHO 21 FEDERAL 3H & 4H AND GAUCHO 21-21 PAD/CTB 8, 6, 7, & 2

[illegible]

SURVEY NO. 4483B.

MADRON SURVEYING, INC. 301 SOUTH CANAL
(575) 234-3341 CARLSBAD, NEW MEXICO

ACCESS ROAD PLAT

ACCESS ROAD TO THE GAUCHO 21 FEDERAL 3H & 4H AND GAUCHO 21-21 PAD/CTB 8, 6, 7, & 2

DEVON ENERGY PRODUCTION COMPANY, L.P.
CENTERLINE SURVEY OF AN ACCESS ROAD CROSSING
SECTION 21, TOWNSHIP 22 SOUTH, RANGE 34 EAST, N.M.P.M.
LEA COUNTY, STATE OF NEW MEXICO
JULY 13, 2018

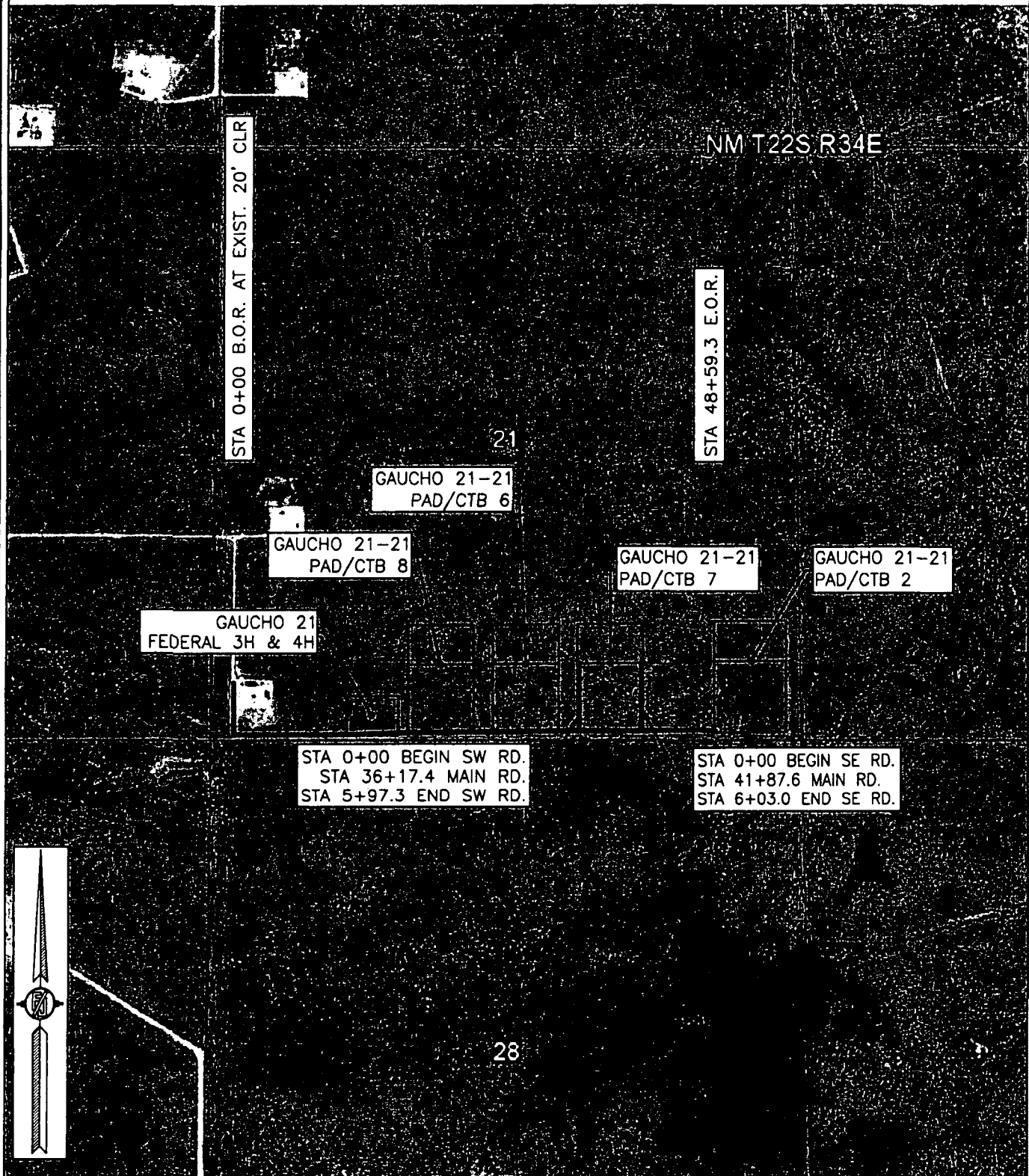

SHEET: 4-4

SURVEY NO. 4483B

MADRON SURVEYING, INC. 301 SOUTH CANAL (575) 234-3341 CARLSBAD, NEW MEXICO

Company: Devon Energy Production Company
Well Name: Gaucho 21 Fed 6H
Reference Number: NMNM 43564

ON LEASE ACCESS ROADS

Road Width

The access road shall have a driving surface that creates the smallest possible surface disturbance and does not exceed fourteen (14) feet in width. The maximum width of surface disturbance, when constructing the access road, shall not exceed twenty-five (25) feet.

Surfacing

Surfacing material is not required on the new access road driving surface. If the operator elects to surface the new access road or pad, the surfacing material may be required to be removed at the time of reclamation.

Where possible, no improvements should be made on the unsurfaced access road other than to remove vegetation as necessary, road irregularities, safety issues, or to fill low areas that may sustain standing water.

The Authorized Officer reserves the right to require surfacing of any portion of the access road at any time deemed necessary. Surfacing may be required in the event the road deteriorates, erodes, road traffic increases, or it is determined to be beneficial for future field development. The surfacing depth and type of material will be determined at the time of notification.

Crowning

Crowning shall be done on the access road driving surface. The road crown shall have a grade of approximately 2% (i.e., a 1" crown on a 14' wide road). The road shall conform to Figure 1; cross section and plans for typical road construction.

Ditching

Ditching shall be required on both sides of the road.

Turnouts

Vehicle turnouts shall be constructed on the road. Turnouts shall be intervisible with interval spacing distance less than 1000 feet. Turnouts shall conform to Figure 1; cross section and plans for typical road construction.

Drainage

Drainage control systems shall be constructed on the entire length of road (e.g. ditches, sidehill outsloping and insloping, lead-off ditches, culvert installation, and low water crossings).

A typical lead-off ditch has a minimum depth of 1 foot below and a berm of 6 inches above natural ground level. The berm shall be on the down-slope side of the lead-off ditch.

Cross Section of a Typical Lead-off Ditch

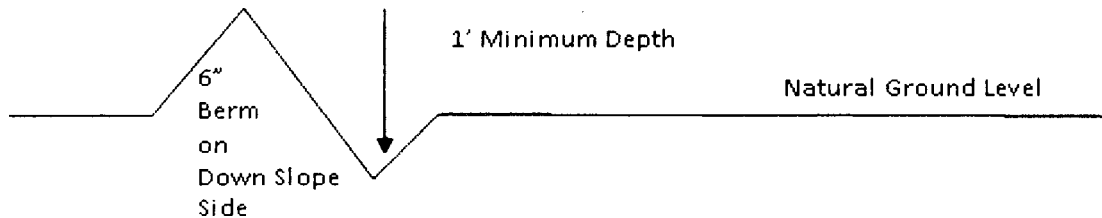

All lead-off ditches shall be graded to drain water with a 1 percent minimum to 3 percent maximum ditch slope. The spacing interval are variable for lead-off ditches and shall be determined according to the formula for spacing intervals of lead-off ditches, but may be amended depending upon existing soil types and centerline road slope (in %);

Formula for Spacing Interval of Lead-off Ditches

Example - On a 4% road slope that is 400 feet long, the water flow shall drain water into a lead-off ditch. Spacing interval shall be determined by the following formula:

$$400 \text{ foot road with } 4\% \text{ road slope: } \frac{400'}{4\%} + 100' = 200' \text{ lead-off ditch interval}$$

Cattleguards

An appropriately sized cattleguard sufficient to carry out the project shall be installed and maintained at fence/road crossings. Any existing cattleguards on the access road route shall be repaired or replaced if they are damaged or have deteriorated beyond practical use. The operator shall be responsible for the condition of the existing cattleguards that are in place and are utilized during lease operations.

Fence Requirement

Where entry is granted across a fence line, the fence shall be braced and tied off on both sides of the passageway prior to cutting. The operator shall notify the private surface landowner or the grazing allotment holder prior to crossing any fences.

Public Access

Public access on this road shall not be restricted by the operator without specific written approval granted by the Authorized Officer.

Construction Steps

1. Salvage topsoil
2. Construct road

3. Redistribute topsoil
4. Revegetate slopes

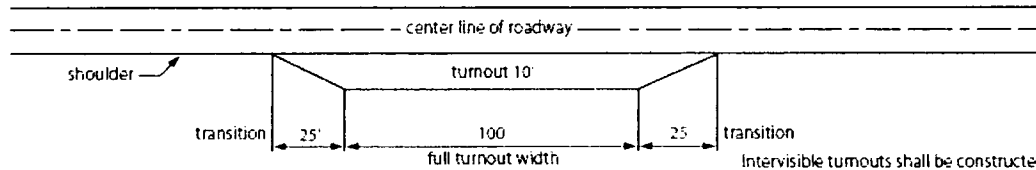

Typical Turnout Plan

Intervisible turnouts shall be constructed on all single lane roads on all blind curves with additional turnouts as needed to keep spacing below 1000 feet.

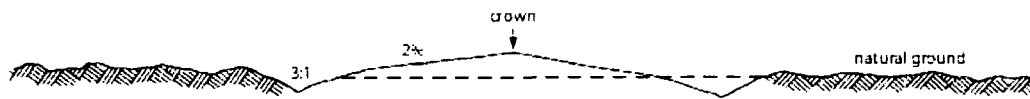

Level Ground Section

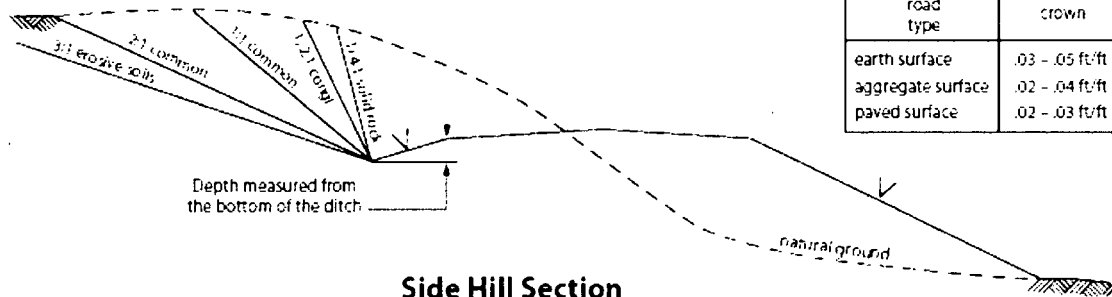

Side Hill Section

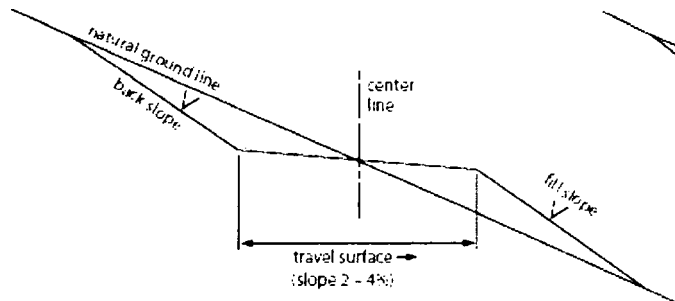

Typical Outsloped Section

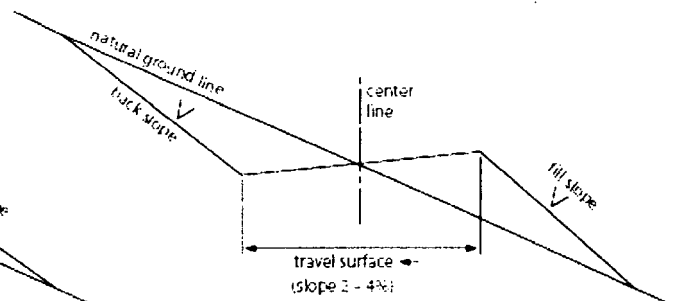

Typical Insloped Section

Figure 1. Cross-sections and plans for typical road sections representative of BLM resource or FS local and higher-class roads.

Special Stipulations:

Timing Limitation Stipulation/Condition of Approval for Lesser Prairie-Chicken:

Oil and gas activities including 3-D geophysical exploration, and drilling will not be allowed in lesser prairie-chicken habitat during the period from March 1st through June 15th annually.

During that period, other activities that produce noise or involve human activity, such as the maintenance of oil and gas facilities, geophysical exploration other than 3-D operations, and pipeline, road, and well pad construction, will be allowed except between 3:00 am and 9:00 am.

The 3:00 am to 9:00 am restriction will not apply to normal, around-the-clock operations, such as venting, flaring, or pumping, which do not require a human presence during this period.

Additionally, no new drilling will be allowed within up to 200 meters of leks known at the time of permitting. Normal vehicle use on existing roads will not be restricted. Exhaust noise from pump jack engines must be muffled or otherwise controlled so as not to exceed 75 db measured at 30 ft. from the source of the noise.

Timing Limitation Exceptions:

The Carlsbad Field Office will publish an annual map of where the LPC timing and noise stipulations and conditions of approval (Limitations) will apply for the identified year (between March 1 and June 15) based on the latest survey information. The LPC Timing Area map will identify areas which are Habitat Areas (HA), Isolated Population Area (IPA), and Primary Population Area (PPA). The LPC Timing Area map will also have an area in red crosshatch.

The red crosshatch area is the only area where an operator is required to submit a request for exception to the LPC Limitations. If an operator is operating outside the red crosshatch area, the LPC Limitations do not apply for that year and an exception to LPC Limitations is not required.