

UNITED STATES
DEPARTMENT OF THE INTERIOR
BUREAU OF LAND MANAGEMENTFORM APPROVED
OMB NO. 1004-0137
Expires: January 31, 2018**SUNDRY NOTICES AND REPORTS ON WELLS**
Do not use this form for proposals to drill or to re-enter an abandoned well. Use form 3160-3 (APD) for such proposals.**SUBMIT IN TRIPLICATE - Other instructions on page 2**

1. Type of Well

☐ Oil Well ☒ Gas Well ☐ Other

2. Name of Operator

MARATHON OIL PERMIAN LLC

Contact: JENNIFER VAN CUREN

E-Mail: jvancuren@marathonoil.co

3a. Address

5555 SAN FELIPE STREET
HOUSTON, TX 77056

3b. Phone No. (include area code)

Ph: 713-296-2500

4. Location of Well (Footage, Sec., T., R., M., or Survey Description)

Sec 19 T26S R35E SESW 352FSL 1338FWL
32.022530 N Lat, 103.410797 W Lon5. Lease Serial No.
NMNM093223

6. If Indian, Allottee or Tribe Name

7. If Unit or CA/Agreement, Name and/or No.

Well Name and No.

MADERA 19 FEDERAL 26 35 19 WA 2H

9. All Well Records
10. Field and Pool or Exploratory Area
MADERA

11. County or Parish, State

LEA COUNTY, NM

12. CHECK THE APPROPRIATE BOX(ES) TO INDICATE NATURE OF NOTICE, REPORT, OR OTHER DATA

TYPE OF SUBMISSION	TYPE OF ACTION			
<input checked="" type="checkbox"/> Notice of Intent	<input type="checkbox"/> Acidize	<input type="checkbox"/> Deepen	<input type="checkbox"/> Production (Start/Resume)	<input type="checkbox"/> Water Shut-Off
<input type="checkbox"/> Subsequent Report	<input type="checkbox"/> Alter Casing	<input type="checkbox"/> Hydraulic Fracturing	<input type="checkbox"/> Reclamation	<input type="checkbox"/> Well Integrity
<input type="checkbox"/> Final Abandonment Notice	<input type="checkbox"/> Casing Repair	<input type="checkbox"/> New Construction	<input type="checkbox"/> Recomplete	<input checked="" type="checkbox"/> Other
	<input type="checkbox"/> Change Plans	<input type="checkbox"/> Plug and Abandon	<input type="checkbox"/> Temporarily Abandon	Change to Original APD
	<input type="checkbox"/> Convert to Injection	<input type="checkbox"/> Plug Back	<input type="checkbox"/> Water Disposal	

13. Describe Proposed or Completed Operation: Clearly state all pertinent details, including estimated starting date of any proposed work and approximate duration thereof. If the proposal is to deepen directionally or recompleat horizontally, give subsurface locations and measured and true vertical depths of all pertinent markers and zones. Attach the Bond under which the work will be performed or provide the Bond No. on file with BLM/BIA. Required subsequent reports must be filed within 30 days following completion of the involved operations. If the operation results in a multiple completion or recompletion in a new interval, a Form 3160-4 must be filed once testing has been completed. Final Abandonment Notices must be filed only after all requirements, including reclamation, have been completed and the operator has determined that the site is ready for final inspection.

Marathon Oil Permian LLC requests to make the following changes to APD:

Change name:

From Madera 19 Federal 26 35 19 WA 2H to Madera 19 WA Fed.Com.2H

Casing Changes:

Adjusted 7" casing point to above the 3rd Bone Spring Sand

Adjusted surface casing set depth to 1165' as per COAs

Cementing Program Changes:

Revised cement volumes due to change in surface and 7" casing point.

All previous COAs still apply.

14. I hereby certify that the foregoing is true and correct.

Electronic Submission #439046 verified by the BLM Well Information System

For MARATHON OIL PERMIAN LLC, sent to the Hobbs

Committed to AFMSS for processing by PRISCILLA PEREZ on 10/11/2018 (19PP0106SE)

Name (Printed/Typed) JENNIFER VAN CUREN

Title SR. REGULATORY COMPLIANCE REP

Signature (Electronic Submission)

Date 10/10/2018

THIS SPACE FOR FEDERAL OR STATE OFFICE USE

Approved By ZOTA STEVENS

Title PETROLEUM ENGINEER

Date 10/12/2018

Conditions of approval, if any, are attached. Approval of this notice does not warrant or certify that the applicant holds legal or equitable title to those rights in the subject lease which would entitle the applicant to conduct operations thereon.

Office Hobbs

Title 18 U.S.C. Section 1001 and Title 43 U.S.C. Section 1212, make it a crime for any person knowingly and willfully to make to any department or agency of the United States any false, fictitious or fraudulent statements or representations as to any matter within its jurisdiction.

(Instructions on page 2)

** BLM REVISED ** BLM REVISED ** BLM REVISED ** BLM REVISED ** BLM REVISED **

Ka

Additional data for EC transaction #439046 that would not fit on the form

32. Additional remarks, continued

Please see highlighted areas for all changes on attached detail.

State of New Mexico
Energy, Minerals & Natural Resources Department
OIL CONSERVATION DIVISION
1220 South St. Francis Dr.
Santa Fe, NM 87505

☐ AMENDED REPORT

¹ API Number 30-025-44900	² Pool Code 96776	³ Pool Name JABALINA; WOLFCAMP, SOUTHWEST
⁴ Property Code	⁵ Property Name MADERA 19 WA FED COM	⁶ Well Number 2H
⁷ OGRID No. 372098	⁸ Operator Name MARATHON OIL PERMIAN LLC	⁹ Elevation 3185'

UL or lot no.	Section	Township	Range	Lot Idn	Feet from the	North/South line	Feet from the	East/West line	County
M (LOT 4)	19	T26S	R35E		352'	SOUTH	1338'	WEST	LEA

UL or lot no.	Section	Township	Range	Lot Idn	Feet from the	North/South line	Feet from the	East/West line	County
L (LOT 3)	18	T26S	R35E		2312'	SOUTH	330'	WEST	LEA

¹² Dedicated Acres 245.60	¹³ Joint or Infill	¹⁴ Consolidation Code	¹⁵ Order No.
---	-------------------------------	----------------------------------	-------------------------

<p>16</p> <p>SECTION 12</p> <p>SECTION 13</p> <p>LAST TAKE POINT/BOTTOM HOLE LOCATION 2312' FSL 330' FWL, SECTION 18 NAD 83, SPCS NM EAST Y:380390.52 / X:826175.70 LAT:32.04244067N / LON:103.41405873W NAD 27, SPCS NM EAST Y:380333.25 / X:784987.73 LAT:32.04231452N / LON:103.41359699W</p>	<p>SECTION 7</p> <p>SECTION 18</p>	<p>SECTION 8</p> <p>SECTION 17</p>	<p>17 OPERATOR CERTIFICATION</p> <p><i>I hereby certify that the information contained herein is true and complete to the best of my knowledge and belief, and that this organization either owns a working interest or unleased mineral interest in the land including the proposed bottom hole location or has a right to drill this well at this location pursuant to a contract with an owner of such a mineral or working interest or to a voluntary pooling agreement or a compulsory pooling order heretofore entered by the division.</i></p> <p style="text-align: right;">10/10/2018</p> <p>Signature: <u>Adrian Covarrubias</u> Date: _____</p> <p>Printed Name: <u>Adrian Covarrubias</u></p> <p>E-mail Address: _____</p>
<p>SECTION 13</p> <p>SECTION 24</p> <p>FIRST TAKE POINT 330' FSL 330' FWL, SECTION 19 NAD 83, SPCS NM EAST Y:373127.66 / X:826238.84 LAT:32.02247623N / LON:103.41405445W NAD 27, SPCS NM EAST Y:373070.58 / X:785050.54 LAT:32.02234997N / LON:103.41359387W</p> <p>SURFACE HOLE LOCATION 352' FSL 1338' FWL, SECTION 19 NAD 83, SPCS NM EAST Y:373155.99 / X:827247.05 LAT:32.02253049N / LON:103.41080086W NAD 27, SPCS NM EAST Y:373098.98 / X:786058.75 LAT:32.02240420N / LON:103.41034038W</p>	<p>SECTION 18</p> <p>SECTION 19</p> <p>SECTION 30</p>	<p>SECTION 17</p> <p>SECTION 20</p> <p>SECTION 29</p>	<p>18 SURVEYOR CERTIFICATION</p> <p><i>I hereby certify that the well location shown on this plat was plotted from field notes of actual surveys made by me or under my supervision, and that the same is true and correct to the best of my belief.</i></p> <p style="text-align: right;">MARCH 05, 2018</p> <p>Date of Survey: _____</p> <p>Signature and Seal of Professional Surveyor: <u>Lloyd P. Short</u></p> <p>Certificate Number: <u>21653</u></p>

3	03/05/2018	CAP
REV.	DATE	BY

Marathon Oil Permian, LLC

Madera 19 Federal 26 35 19 WXY 6H

API# 30-025-44902

SHL: 351' FSL & 1428' FWL / Sec 19 – T26S – R35E

BHL: 2312' FSL & 1356' FWL / Sec 18 – T26S – R35E

Lea County, New Mexico

Drilling Program Changes

1. Casing Changes:

- Adjusted 7" casing point to above the 3rd Bone Spring sand
- Adjusted surface casing set depth to 1,165' as per COA's

String Type	Hole Size	Csg Size	Top Set MD	Bottom Set MD	Top Set TVD	Bottom Set TVD	Weight (lbs/ft)	Grade	Conn.	SF Collapse	SF Burst	SF Tension
Surface	<u>17</u> <u>1/2</u>	<u>13</u> <u>3/8</u>	<u>0</u>	<u>1165</u>	<u>0</u>	<u>1050</u>	<u>54.5</u>	<u>J55</u>	<u>STC</u>	<u>5.52</u>	<u>2.4</u>	<u>2.5</u>
Intermediate I	<u>12</u> <u>1/4</u>	<u>9 5/8</u>	<u>0</u>	<u>5400</u>	<u>0</u>	<u>5270</u>	<u>40</u>	<u>J55</u>	<u>LTC</u>	<u>1.24</u>	<u>1.15</u>	<u>2.19</u>
Intermediate II	<u>8</u> <u>3/4</u>	<u>7</u>	<u>0</u>	<u>11950</u>	<u>0</u>	<u>11472</u>	<u>29</u>	<u>P110</u>	<u>BTC</u>	<u>2.20</u>	<u>1.18</u>	<u>1.9</u>
Production Liner	<u>6</u> <u>1/8</u>	<u>4 1/2</u>	<u>11950</u>	<u>19950</u>	<u>11600</u>	<u>12682</u>	<u>13.5</u>	<u>P110</u>	<u>BTC</u>	<u>1.32</u>	<u>1.56</u>	<u>1.73</u>

Minimum safety factors: Burst 1.125 Collapse 1.125 Tension 1.8 Wet/1.6 Dry

2. Cementing Program:

Changes:

- Revised cement volumes due to change in surface and 7" casing point

String Type	Lead/Tail	Stage Tool Depth	Top MD	Bottom MD	Quantity (sks)	Yield (ft ³ /sks)	Density (ppg)	Slurry Volume (ft ³)	Excess (%)	Cement Type	Additives
Surface	Lead	--	0	12	41	1.75	13.5	226	100	Class C	3 lbm/sk granular LCM + 0.1250 lbm/sk Poly-E-Flake
Surface	Tail	--	12	165	47	1.4	14.8	21	100	Class C	
Intermediate I	Lead	--	0	100	101	1.2	12.8	445	75	Class C	0.02 Gal/Sk Defoamer + 0.5% Extender + 1% Accelerator
Intermediate I	Tail	--	100	5400	47	1.33	14.8	50		Class C	
Intermediate II	Lead	--	500	1000	31	2.7	11	102	70	Class C	0.85% retarder + 10% extender + 0.02 gal/sk defoamer + 2.0% Extender + 0.15% Viscosifier
Intermediate II	Tail	--	1000	1020	10	1.09	15.6	22	30	Class H	3% extender + 0.15% Dispersant + 0.03 gal/sk retarder
Production Liner	Tail	--	1020	19950	10	1.22	14.5	106	30	Class H	0.1% retarder + 0.5% extender + 0.02 gal/sk Dispersant

LOCATION VERIFICATION MAP

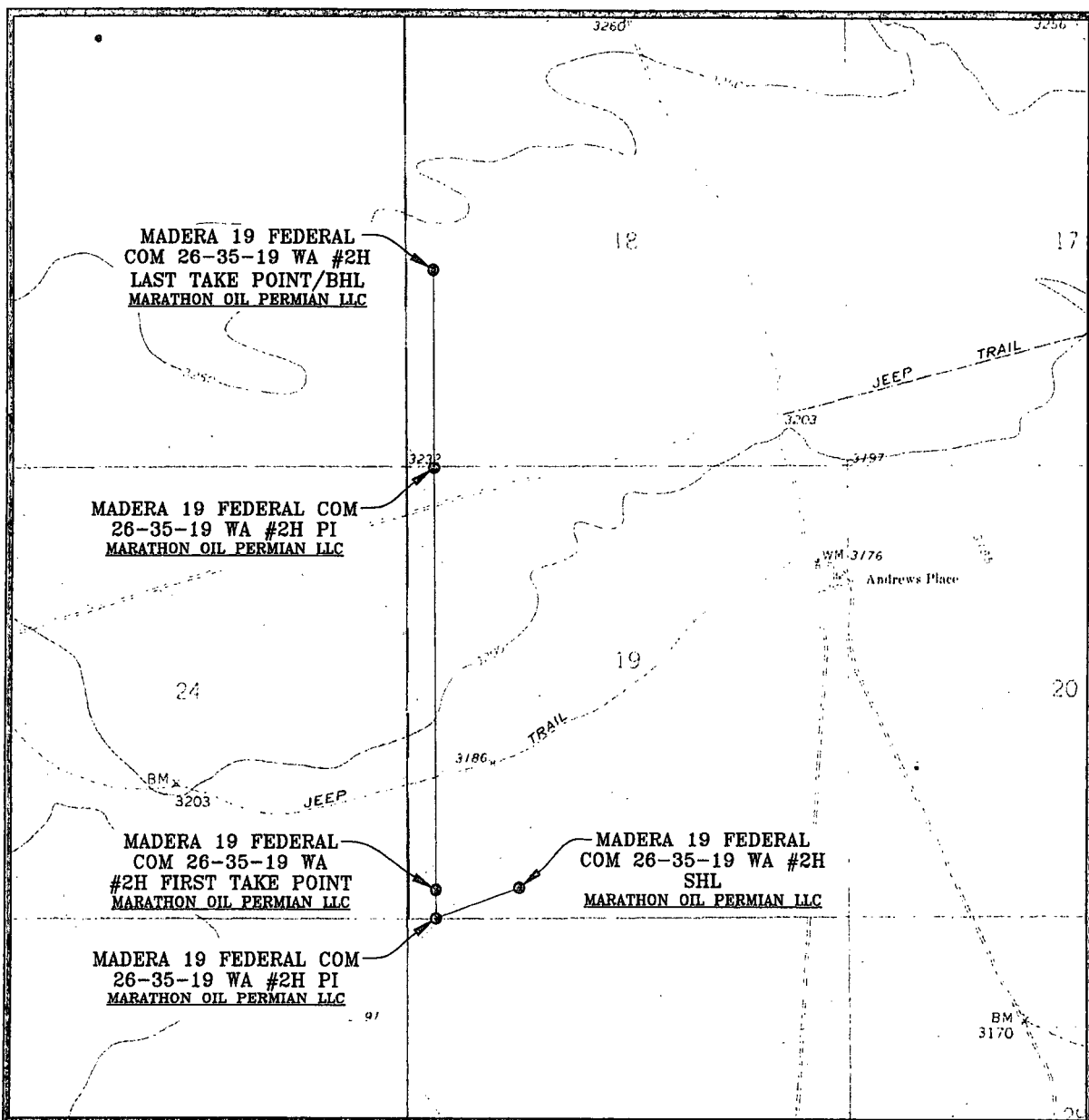

SEC. 19 TWP. 26-S RGE. 35-E
 SURVEY: N.M.P.M.
 COUNTY: LEA
 DESCRIPTION: 352' FSL & 1338' FWL
 ELEVATION: 3185'
 OPERATOR: MARATHON OIL PERMIAN LLC
 LEASE: MADERA 19 FEDERAL COM 26-35-19
 U.S.G.S. TOPOGRAPHIC MAP: ANDREWS PLACE, N.M.

SCALE: 1" = 2000'
 CONTOUR INTERVAL = 10'

PREPARED BY:
 R-SQUARED GLOBAL, LLC
 1309 LOUISVILLE AVENUE, MONROE, LA 71201
 318-323-8900 OFFICE
 JOB No. R3817_001

VICINITY MAP

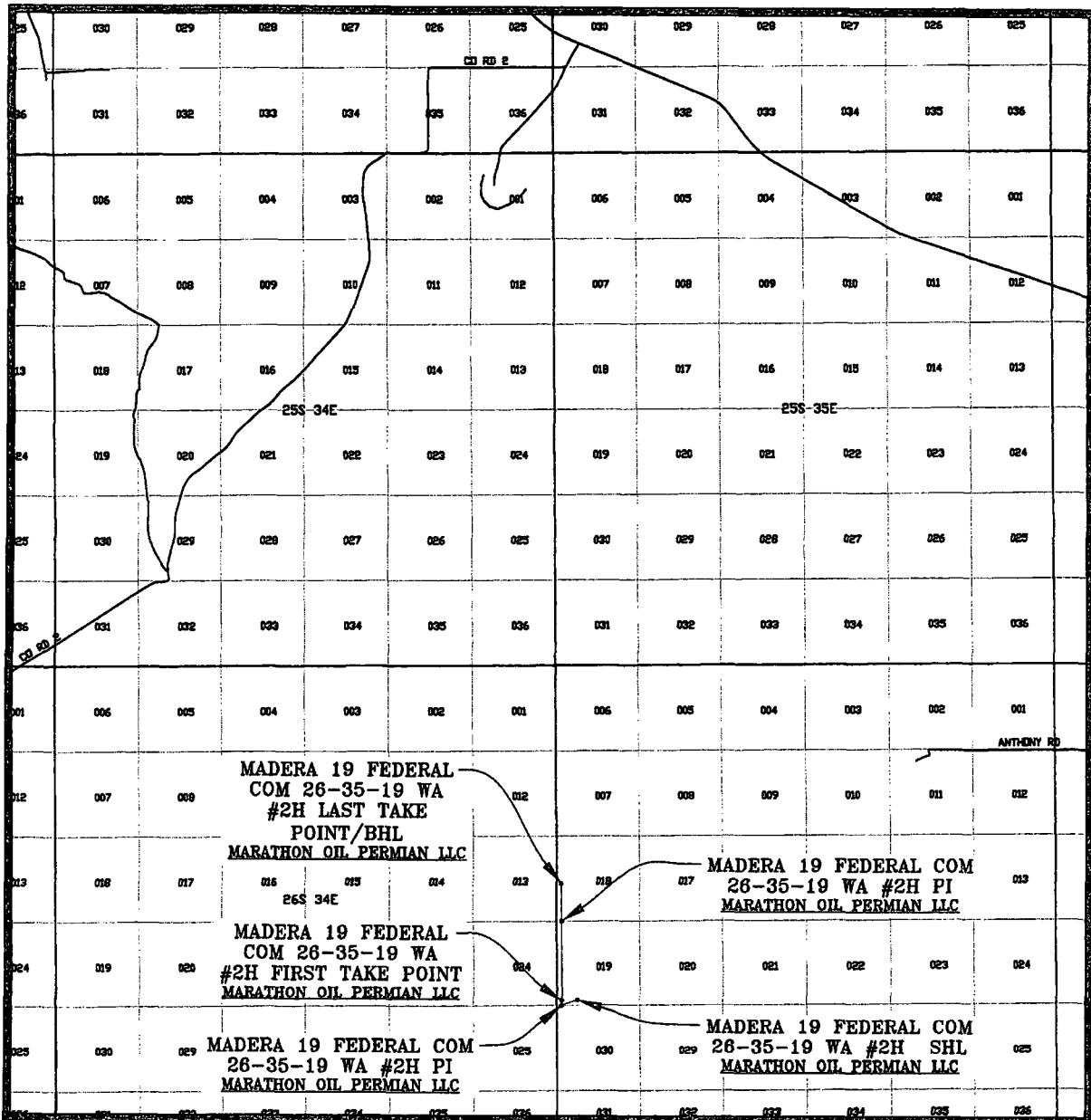

SEC. 19 TWP. 26-S RGE. 35-E
 SURVEY: N.M.P.M.
 COUNTY: LEA
 DESCRIPTION: 352' FSL & 1338' FWL
 ELEVATION: 3185'
 OPERATOR: MARATHON OIL PERMIAN LLC
 LEASE: MADERA 19 FEDERAL COM 26-35-19
 U.S.G.S. TOPOGRAPHIC MAP: ANDREWS PLACE, N.M.

SCALE: 1" = 2 MILES

PREPARED BY:
 R-SQUARED GLOBAL, LLC
 1309 LOUISVILLE AVENUE, MONROE, LA 71201
 318-323-6900 OFFICE
 JOB No. R3817_001