

UNITED STATES
DEPARTMENT OF THE INTERIOR
BUREAU OF LAND MANAGEMENT

Alameda Field Office

FORM APPROVED
OMB NO. 1004-0137
Expires: January 31, 2018

SUNDRY NOTICES AND REPORTS ON WELLS

Do not use this form for proposals to drill or to re-enter an abandoned well. Use form 3160-3 (APD) for such proposals.

Lease Serial No.
NMNM26394

6. If Indian, Allottee or Tribe Name

7. If Unit or CA/Agreement, Name and/or No.

8. Well Name and No.
VACA DRAW 20 17 FEDERAL 12H9. API Well No.
30-025-4435810. Field and Pool or Exploratory Area
WILDCAT; WOLFCAMP (98250)11. County or Parish, State
LEA COUNTY, NM

SUBMIT IN TRIPLICATE - Other instructions on page 2

1. Type of Well

☐ Oil Well ☒ Gas Well ☐ Other

2. Name of Operator

CIMAREX ENERGY COMPANY

Contact: FATIMA VASQUEZ

E-Mail: fvasquez@cimarex.com

3a. Address

600 N MARIENFELD ST SUITE 600
MIDLAND, TX 79701

3b. Phone No. (include area code)

Ph: 432-620-1933

4. Location of Well (Footage, Sec., T., R., M., or Survey Description)

Sec 20 T25S R33E SESW 330FSL 2050FWL
32.109742 N Lat, 103.596228 W Lon

12. CHECK THE APPROPRIATE BOX(ES) TO INDICATE NATURE OF NOTICE, REPORT, OR OTHER DATA

TYPE OF SUBMISSION	TYPE OF ACTION			
<input checked="" type="checkbox"/> Notice of Intent	<input type="checkbox"/> Acidize	<input type="checkbox"/> Deepen	<input type="checkbox"/> Production (Start/Resume)	<input type="checkbox"/> Water Shut-Off
<input type="checkbox"/> Subsequent Report	<input type="checkbox"/> Alter Casing	<input type="checkbox"/> Hydraulic Fracturing	<input type="checkbox"/> Reclamation	<input type="checkbox"/> Well Integrity
<input type="checkbox"/> Final Abandonment Notice	<input type="checkbox"/> Casing Repair	<input type="checkbox"/> New Construction	<input type="checkbox"/> Recomplete	<input checked="" type="checkbox"/> Other
	<input type="checkbox"/> Change Plans	<input type="checkbox"/> Plug and Abandon	<input type="checkbox"/> Temporarily Abandon	Change to Original A
	<input type="checkbox"/> Convert to Injection	<input type="checkbox"/> Plug Back	<input type="checkbox"/> Water Disposal	PD

13. Describe Proposed or Completed Operation: Clearly state all pertinent details, including estimated starting date of any proposed work and approximate duration thereof. If the proposal is to deepen directionally or recompleat horizontally, give subsurface locations and measured and true vertical depths of all pertinent markers and zones. Attach the Bond under which the work will be performed or provide the Bond No. on file with BLM/BIA. Required subsequent reports must be filed within 30 days following completion of the involved operations. If the operation results in a multiple completion or recompleat in a new interval, a Form 3160-4 must be filed once testing has been completed. Final Abandonment Notices must be filed only after all requirements, including reclamation, have been completed and the operator has determined that the site is ready for final inspection.

Cimarex respectfully requests to upsize the flowlines & gas lift pipelines as follows to service the Vaca Draw 20-17 Federal #12H:

- (1) - 1,533' buried 6" steel flowline pipeline
(1) - 1,588' buried 6" steel gas lift pipeline.

The pipelines will be buried in the same ditch and will go to the Vaca Draw 20-17 CTB located in the W2 of Sec. 20 as previously approved in the APD.

The 6" pipelines replace the previously approved 4" pipelines.

No additional disturbance required.

Surface good 10-31-2018 JR

14. I hereby certify that the foregoing is true and correct.

Electronic Submission #435842 verified by the BLM Well Information System
For CIMAREX ENERGY COMPANY, sent to the Hobbs
Committed to AFMSS for processing by PRISCILLA PEREZ on 09/19/2018 ()

Name (Printed/Typed) FATIMA VASQUEZ

Title REGULATORY ANALYST

Signature (Electronic Submission)

Date 09/18/2018

THIS SPACE FOR FEDERAL OR STATE OFFICE USE

Approved By

Title

Assoc Field Mgr

Date

10/31/18

Conditions of approval, if any, are attached. Approval of this notice does not warrant or certify that the applicant holds legal or equitable title to those rights in the subject lease which would entitle the applicant to conduct operations thereon.

Office

OFO

Title 18 U.S.C. Section 1001 and Title 43 U.S.C. Section 1212, make it a crime for any person knowingly and willfully to make to any department or agency of the United States any false, fictitious or fraudulent statements or representations as to any matter within its jurisdiction.

(Instructions on page 2)

** OPERATOR-SUBMITTED ** OPERATOR-SUBMITTED ** OPERATOR-SUBMITTED **

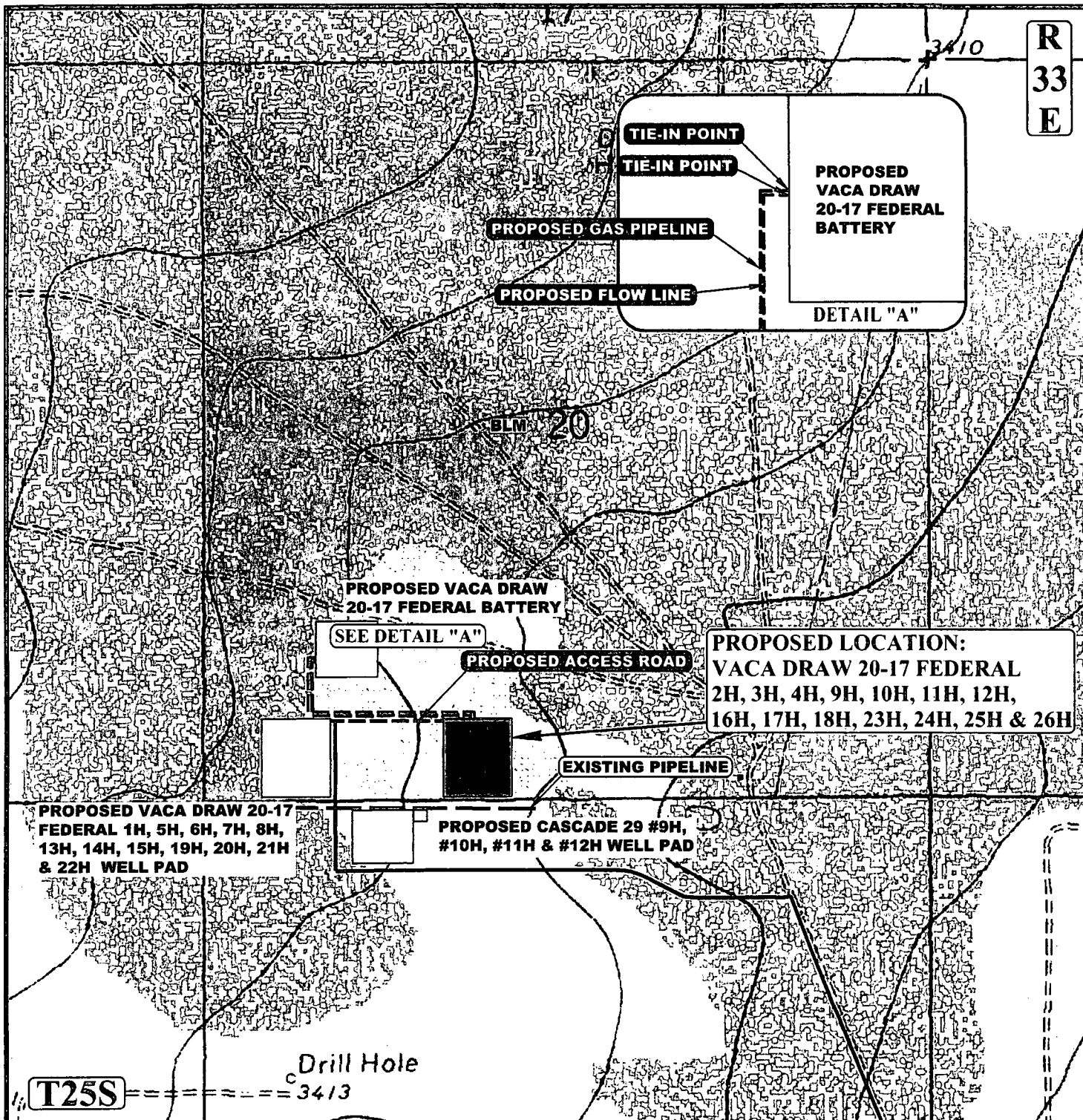

APPROXIMATE TOTAL GAS PIPELINE DISTANCE = 1,588' +/-

APPROXIMATE TOTAL FLOW LINE DISTANCE = 1,533' +/-

NOTE: PARCEL DATA SHOWN HAS BEEN OBTAINED FROM VARIOUS SOURCES AND SHOULD BE USED FOR MAPPING, GRAPHIC AND PLANNING PURPOSES ONLY. NO WARRANTY IS MADE BY UTAH ENGINEERING AND LAND SURVEYING (UELS) FOR ACCURACY OF THE PARCEL DATA.

LEGEND:

- EXISTING ROAD
- PROPOSED ROAD
- - - PROPOSED GAS PIPELINE
- - - PROPOSED FLOW LINE
- - - PROPOSED POWER LINE (SERVICING OTHER WELLS)



UELS, LLC
Corporate Office * 85 South 200 East
Vernal, UT 84078 * (435) 789-1017



CIMAREX ENERGY CO.

VACA DRAW 20-17 FEDERAL 2H, 3H, 4H, 9H,
10H, 11H, 12H, 16H, 17H, 18H, 23H, 24H, 25H & 26H
SE 1/4 SW 1/4, SECTION 20, T25S, R33E, N.M.P.M.
LEA COUNTY, NEW MEXICO

SURVEYED BY	C.J., D.J.	01-20-17	SCALE
DRAWN BY	C.I.	01-28-17	1 : 12,000
GAS PIPELINE / FLOW LINE MAP EXHIBIT G			

CIMAREX ENERGY CO.-VACA DRAW 20-17 FEDERAL 2H, 3H, 4H, 9H, 10H, 11H, 12H, 16H, 17H, 18H, 23H, 24H, 25H & 26H			
SECTION CORNER	DESCRIPTION	LATITUDE (NAD 83)	LONGITUDE (NAD 83)
NW COR. SEC. 20, T25S, R33E	2" IRON PIPE W/ BRASS CAP, 1918	N 32°07'24.04"	W 103°36'10.23"
N 1/4 COR. SEC. 20, T25S, R33E	1" IRON PIPE W/ BRASS CAP, 1918	N 32°07'24.02"	W 103°35'39.47"
NE COR. SEC. 20, T25S, R33E	2" IRON PIPE W/ BRASS CAP, 1913	N 32°07'24.02"	W 103°35'08.74"
E 1/4 COR. SEC. 20, T25S, R33E	1" IRON PIPE W/ BRASS CAP, 1913	N 32°06'57.88"	W 103°35'08.76"
W 1/4 COR. SEC. 20, T25S, R33E	1" IRON PIPE W/ BRASS CAP, 1913	N 32°06'57.92"	W 103°36'10.23"
SW COR. SEC. 20, T25S, R33E	2" IRON PIPE W/ BRASS CAP	N 32°06'31.79"	W 103°36'10.25"
S 1/4 COR. SEC. 20, T25S, R33E	1" IRON PIPE W/ BRASS CAP	N 32°06'31.80"	W 103°35'39.51"
SE COR. SEC. 20, T25S, R33E	2" IRON PIPE W/ BRASS CAP	N 32°06'31.76"	W 103°35'08.77"

CIMAREX ENERGY CO.-VACA DRAW 20-17 FEDERAL 2H, 3H, 4H, 9H, 10H, 11H, 12H, 16H, 17H, 18H, 23H, 24H, 25H & 26H			
NUMBER	STATION	LATITUDE (NAD 83)	LONGITUDE (NAD 83)
BEGIN	0+00	N 32°06'37.54"	W 103°35'47.82"
1	0+25.02	N 32°06'37.79"	W 103°35'47.82"
2	11+75.41	N 32°06'37.78"	W 103°36'01.19"
3	15+08.08	N 32°06'41.07"	W 103°36'01.19"
END	15+33.12	N 32°06'41.07"	W 103°36'00.90"

CERTIFICATE
THIS IS TO CERTIFY THAT THIS EASEMENT PLAT AND
THE ACTUAL SURVEY ON THE GROUND UPON WHICH IT
IS BASED WERE PERFORMED BY ME OR UNDER MY
DIRECT SUPERVISION. THAT I AM RESPONSIBLE FOR
THIS SURVEY, THAT THIS SURVEY MEETS THE
MINIMUM STANDARDS FOR SURVEYING IN NEW
MEXICO, AND THAT IT IS TRUE AND CORRECT TO THE
BEST OF MY KNOWLEDGE AND BELIEF.

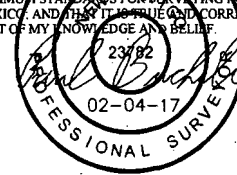

FILE: 61383-B

Sheet 2 of 2

NOTES:

CIMAREX ENERGY CO.

VACA DRAW 20-17 FEDERAL 2H, 3H, 4H, 9H, 10H,
11H, 12H, 16H, 17H, 18H, 23H, 24H, 25H & 26H
SECTION 20, T25S, R33E, N.M.P.M.
LEA COUNTY, NEW MEXICO

SURVEYED BY	C.J. D.J.	01-20-17	SCALE
DRAWN BY	B.D.H.	02-04-17	N/A

FLOW LINE R-O-W



UELS, LLC
Corporate Office * 85 South 200 East
Vernal, UT 84078 * (435) 789-1017

CIMAREX ENERGY CO.-VACA DRAW 20-17 FEDERAL 2H, 3H, 4H, 9H, 10H, 11H, 12H, 16H, 17H, 18H, 23H, 24H, 25H & 26H			
SECTION CORNER	DESCRIPTION	LATITUDE (NAD 83)	LONGITUDE (NAD 83)
NW COR. SEC. 20, T25S, R33E	2" IRON PIPE W/ BRASS CAP, 1918	N 32°07'24.04"	W 103°36'10.23"
N 1/4 COR. SEC. 20, T25S, R33E	1" IRON PIPE W/ BRASS CAP, 1918	N 32°07'24.02"	W 103°35'39.47"
NE COR. SEC. 20, T25S, R33E	2" IRON PIPE W/ BRASS CAP, 1913	N 32°07'24.02"	W 103°35'08.74"
E 1/4 COR. SEC. 20, T25S, R33E	1" IRON PIPE W/ BRASS CAP, 1913	N 32°06'57.88"	W 103°35'08.76"
W 1/4 COR. SEC. 20, T25S, R33E	1" IRON PIPE W/ BRASS CAP, 1913	N 32°06'57.92"	W 103°36'10.23"
SW COR. SEC. 20, T25S, R33E	2" IRON PIPE W/ BRASS CAP	N 32°06'31.79"	W 103°36'10.25"
S 1/4 COR. SEC. 20, T25S, R33E	1" IRON PIPE W/ BRASS CAP	N 32°06'31.80"	W 103°35'39.51"
SE COR. SEC. 20, T25S, R33E	2" IRON PIPE W/ BRASS CAP	N 32°06'31.76"	W 103°35'08.77"

CIMAREX ENERGY CO.-VACA DRAW 20-17 FEDERAL 2H, 3H, 4H, 9H, 10H, 11H, 12H, 16H, 17H, 18H, 23H, 24H, 25H & 26H			
NUMBER	STATION	LATITUDE (NAD 83)	LONGITUDE (NAD 83)
BEGIN	0+00	N 32°06'41.62"	W 103°36'00.90"
1	0+24.98	N 32°06'41.62"	W 103°36'01.19"
2	4+12.88	N 32°06'37.78"	W 103°36'01.19"
3	15+63.27	N 32°06'37.79"	W 103°35'47.82"
END	15+88.29	N 32°06'37.54"	W 103°35'47.82"

CERTIFICATE
THIS IS TO CERTIFY THAT THIS EASEMENT PLAT AND
THE ACTUAL SURVEY FOR THE GROUND UPON WHICH IT
IS BASED WERE PERFORMED BY ME OR UNDER MY
DIRECT SUPERVISION, THAT I AM RESPONSIBLE FOR
THIS SURVEY, THAT THIS SURVEY MEETS THE
MINIMUM STANDARDS FOR SURVEYING IN NEW
MEXICO, AND THAT IT IS TRUE AND CORRECT TO THE
BEST OF MY KNOWLEDGE AND BELIEF.

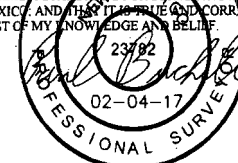

FILE: 61382-B

Sheet 2 of 2

NOTES:

CIMAREX ENERGY CO.

VACA DRAW 20-17 FEDERAL 2H, 3H, 4H, 9H, 10H,
11H, 12H, 16H, 17H, 18H, 23H, 24H, 25H & 26H
SECTION 20, T25S, R33E, N.M.P.M.
LEA COUNTY, NEW MEXICO

SURVEYED BY	C.J., D.J.	01-20-17	SCALE
DRAWN BY	B.D.H.	02-04-17	N/A
GAS LIFT LINE R-O-W			



UELS, LLC
Corporate Office * 85 South 200 East
Vernal, UT 84078 * (435) 789-1017