

District I  
1625 N. French Dr., Hobbs, NM 88240  
Phone: (575) 393-6161 Fax: (575) 393-0720  
District II  
811 S. First St., Artesia, NM 88210  
Phone: (575) 748-1283 Fax: (575) 748-9720  
District III  
1000 Rio Brazos Road, Aztec, NM 87410  
Phone: (505) 334-6178 Fax: (505) 334-6170  
District IV  
1220 S. St. Francis Dr., Santa Fe, NM 87505  
Phone: (505) 476-3460 Fax: (505) 476-3462

State of New Mexico  
Energy, Minerals & Natural Resources Department  
OIL CONSERVATION DIVISION  
1220 South St. Francis Dr.  
Santa Fe, NM 87505

Form C-102  
Revised August 1, 2011  
Submit one copy to appropriate  
District Office

☒ AMENDED REPORT  
"As-Drilled"

WELL LOCATION AND ACREAGE DEDICATION PLAT

<sup>1</sup> API Number 30-025-42443	<sup>2</sup> Pool Code 98307	<sup>3</sup> Pool Name NEEDMORE TANK; BONE SPRING POOL
<sup>4</sup> Property Code	<sup>5</sup> Property Name SALADO DRAW 29 26 33 FED COM	<sup>6</sup> Well Number 8H
<sup>7</sup> OGRID No. 4323	<sup>8</sup> Operator Name CHEVRON U.S.A. INC.	<sup>9</sup> Elevation 3246'

<sup>10</sup> Surface Location

UL or lot no.	Section	Township	Range	Lot Idn	Feet from the	North/South line	Feet from the	East/West line	County
B	29	26 SOUTH	33 EAST, N.M.P.M.		136'	NORTH	1382'	EAST	LEA

<sup>11</sup> Bottom Hole Location If Different From Surface

UL or lot no.	Section	Township	Range	Lot Idn	Feet from the	North/South line	Feet from the	East/West line	County
H	32	26 SOUTH	33 EAST, N.M.P.M.		280'	SOUTH	355'	EAST	LEA

<sup>12</sup> Dedicated Acres 949.56	<sup>13</sup> Joint or Infill	<sup>14</sup> Consolidation Code	<sup>15</sup> Order No. R-20300
---	-------------------------------	----------------------------------	------------------------------------

No allowable will be assigned to this completion until all interests have been consolidated or a non-standard unit has been approved by the division.

SALADO DRAW 29 26 33 FED COM NO. 8H WELL	
X=	730,460 NAD 27
Y=	372,254
LAT.	32.021261
LONG.	103.589737
X=	771,648 NAD83
Y=	372,311
LAT.	32.021386
LONG.	103.590204
ELEVATION +3246' NAVD 88	

PROPOSED BOTTOM HOLE LOCATION	
X=	731,544 NAD 27
Y=	364,850
LAT.	32.000887
LONG.	103.586408
X=	772,732 NAD83
Y=	364,907
LAT.	32.001012
LONG.	103.586873

CORNER COORDINATES TABLE (NAD 27)

A - Y=372382.09, X=729197.59  
B - Y=372390.91, X=730519.68  
C - Y=372399.73, X=731841.78  
D - Y=371062.70, X=729207.78  
E - Y=371072.13, X=730529.72  
F - Y=367115.79, X=730559.81  
G - Y=367127.04, X=731881.26  
H - Y=364563.17, X=730579.96  
I - Y=364572.35, X=731900.79

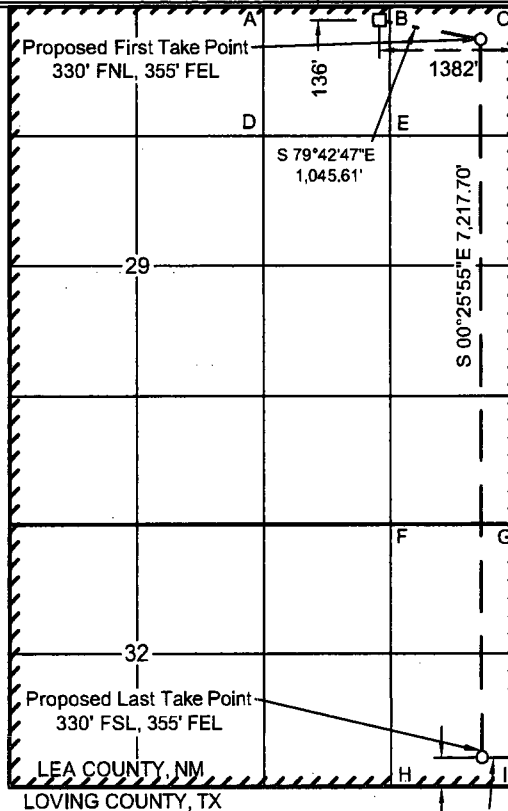

LEA COUNTY, NM  
LOVING COUNTY, TX

<sup>17</sup> OPERATOR CERTIFICATION

I hereby certify that the information contained herein is true and complete to the best of my knowledge and belief, and that this organization either owns a working interest or unleased mineral interest in the land including the proposed bottom hole location or has a right to drill this well at this location pursuant to a contract with an owner of such a mineral or working interest, or to a voluntary pooling agreement or a compulsory pooling order heretofore entered by the division.

  
Signature Date 2/8/2019

Laura Becerra

Printed Name

LBecerra@Chevron.com

E-mail Address

<sup>18</sup> SURVEYOR CERTIFICATION

I hereby certify that the well location shown on this plat was plotted from field notes of actual surveys made by me or under my supervision, and that the same is true and correct to the best of my belief.

02/20/2015

Date of Survey

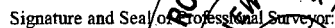
  
Signature and Seal of Professional Surveyor

02/08/2019

23006

Certificate Number

