

District I
1625 N. French Dr., Hobbs, NM 88240
Phone: (575) 393-6161 Fax: (575) 393-0720
District II
811 S. First St., Artesia, NM 88210
Phone: (575) 748-1283 Fax: (575) 748-9720
District III
1000 Rio Brazos Road, Aztec, NM 87410
Phone: (505) 334-6178 Fax: (505) 334-6170
District IV
1220 S. St. Francis Dr., Santa Fe, NM 87505
Phone: (505) 476-3460 Fax: (505) 476-3462

State of New Mexico
Energy, Minerals & Natural Resources
Department
OIL CONSERVATION DIVISION
1220 South St. Francis Dr.
Santa Fe, NM 87505

HOBBS OCD
RECEIVED
JUL 22 2019

FORM C-102
Revised August 1, 2011
Submit one copy to appropriate
District Office

☒ AMENDED REPORT
As Drilled Plot

WELL LOCATION AND ACREAGE DEDICATION PLAT

¹ API Number 30-025-44918		² Pool Code 2220	³ Pool Name Antelope Ridge; Wolfcamp
⁴ Property Code 321609	⁵ Property Name CARL MOTTEK FEDERAL		⁶ Well Number 211H
⁷ OGRID No. 228937	⁸ Operator Name MATADOR PRODUCTION COMPANY		⁹ Elevation 3578'

¹⁰Surface Location

UL or lot no.	Section	Township	Range	Lot Idn	Feet from the	North/South line	Feet from the	East/West line	County
D	17	24-S	34-E	-	326'	NORTH	380'	WEST	LEA

UL or lot no.	Section	Township	Range	Lot Idn	Feet from the	North/South line	Feet from the	East/West line	County
M	17	24-S	34-E	-	101'	SOUTH	354'	WEST	LEA

¹¹ Dedicated Acres 160	¹² Joint or Infill	¹³ Consolidation Code	¹⁴ Order No.
--------------------------------------	-------------------------------	----------------------------------	-------------------------

No allowable will be assigned to this completion until all interests have been consolidated or a non-standard unit has been approved by the division.

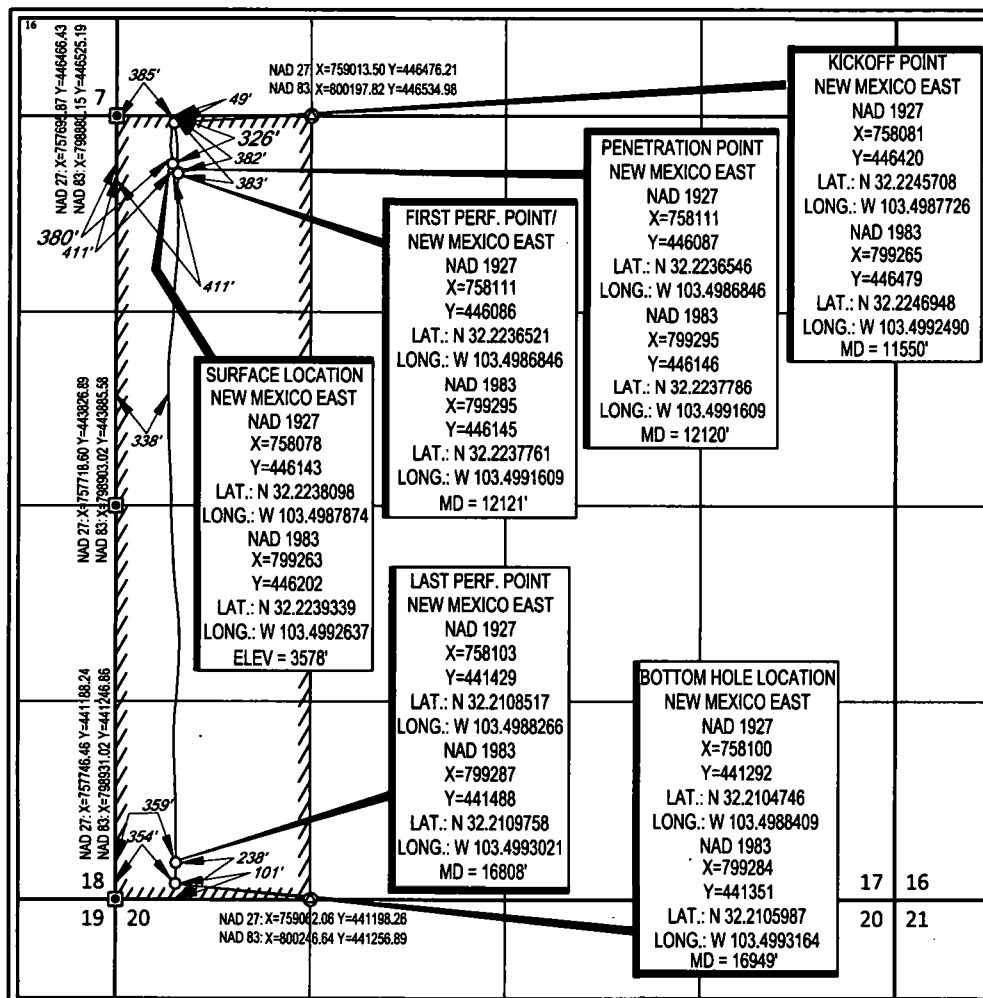

¹⁷OPERATOR CERTIFICATION

I hereby certify that the information contained herein is true and complete to the best of my knowledge and belief, and that this organization either owns a working interest or unleased mineral interest in the land including the proposed bottom hole location or has a right to drill this well at this location pursuant to a contract with an owner of such a mineral or working interest, or to a voluntary pooling agreement or a compulsory pooling order heretofore entered by the division.

Tammy R. Link 7/16/2019
Signature Date

Tammy R. Link

Printed Name

mlink@matadorresources.com

E-mail Address

¹⁸SURVEYOR CERTIFICATION

I hereby certify that the well location shown on this plat was plotted from field notes of actual surveys made by me or under my supervision, and that the same is true to the best of my belief.

09/13/2017

Date of Survey
Signature and Seal of Registered Surveyor

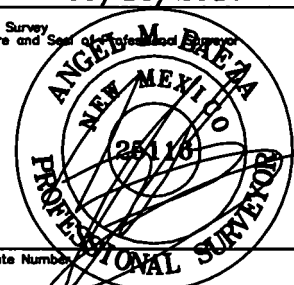

Certificate Number

SCALE: 1" = 1000'
0' 500' 1000'

FND. BRASS CAP.
U.S. G.L.O. SUR.
1913

SECTION 17, TOWNSHIP 24-S, RANGE 34-E, N.M.P.M.
LEA COUNTY, NEW MEXICO

FND. BRASS CAP.
U.S. G.L.O. SUR.
1913

FND. BRASS CAP.
U.S. G.L.O. SUR.
1913

FND. BRASS CAP.
U.S. G.L.O. SUR.
1913

SURFACE LOCATION
NEW MEXICO EAST
NAD 1927
X=758078
Y=446143
LAT.: N 32.2238098
LONG.: W 103.4987874
NAD 1983
X=799263
Y=446202
LAT.: N 32.2239339
LONG.: W 103.4992637
ELEV = 3578'

PENETRATION POINT
NEW MEXICO EAST
NAD 1927
X=758111
Y=446087
LAT.: N 32.2236546
LONG.: W 103.4986846
NAD 1983
X=799295
Y=446146
LAT.: N 32.2237786
LONG.: W 103.4991609
MD = 12120'

KICKOFF POINT
NEW MEXICO EAST
NAD 1927
X=758081
Y=446420
LAT.: N 32.2245708
LONG.: W 103.4987726
NAD 1983
X=799265
Y=446479
LAT.: N 32.2246948
LONG.: W 103.4992490
MD = 11550'

FIRST PERF. POINT/
NEW MEXICO EAST
NAD 1927
X=758111
Y=446086
LAT.: N 32.2236521
LONG.: W 103.4986846
NAD 1983
X=799295
Y=446145
LAT.: N 32.2237761
LONG.: W 103.4991609
MD = 12121'

LAST PERF. POINT
NEW MEXICO EAST
NAD 1927
X=758103
Y=441429
LAT.: N 32.2108517
LONG.: W 103.4988266
NAD 1983
X=799287
Y=441488
LAT.: N 32.2109758
LONG.: W 103.4993021
MD = 16808'

BOTTOM HOLE LOCATION
NEW MEXICO EAST
NAD 1927
X=758100
Y=441292
LAT.: N 32.2104746
LONG.: W 103.4988409
NAD 1983
X=799284
Y=441351
LAT.: N 32.2105987
LONG.: W 103.4993164
MD = 16949'

CALCULATED
CORNER

CALCULATED
CORNER

CALCULATED
CORNER

LEASE NAME & WELL NO.: CARL MOTTEK FEDERAL 211H
SECTION 17 TWP 24-S RGE 34-E SURVEY N.M.P.M.
COUNTY LEA STATE NM ELEVATION 3578'
DESCRIPTION 326' FNL & 380' FWL



TOPOGRAPHIC
LOYALTY INNOVATION LEGACY

1400 EVERMAN PARKWAY, Ste. 146 - FT. WORTH, TEXAS 76140
TELEPHONE: (817) 744-7512 - FAX (817) 744-7554
2803 NORTH BIG SPRING - MIDLAND, TEXAS 79705
TELEPHONE: (432) 682-1653 OR (800) 787-1653 - FAX (432) 682-1743
WWW.TOPOGRAPHIC.COM

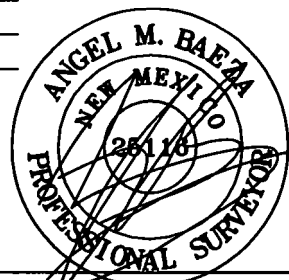

Angel M. Baeza, P.S. No. 25116
JULY 03, 2019

CARL MOTTEK 211H
AS-COMPLETED

REVISION:

NOTES:

1. ORIGINAL DOCUMENT SIZE: 8.5" X 11"
2. ALL BEARINGS, DISTANCES, AND COORDINATE VALUES CONTAINED HEREIN ARE GRID BASED UPON THE NEW MEXICO COORDINATE SYSTEM OF 1983, EAST ZONE, U.S. SURVEY FEET.
3. THIS WELL LOCATION SHOWN HEREON HAS BEEN SURVEYED ON THE GROUND UNDER MY SUPERVISION AND PREPARED ACCORDING TO THE EVIDENCE FOUND AT THE TIME OF SURVEY, AND DATA PROVIDED BY MATADOR PRODUCTION COMPANY. THIS CERTIFICATION IS MADE AND LIMITED TO THOSE PERSONS OR ENTITIES SHOWN ON THE FACE OF THIS PLAT AND IS NON-TRANSFERABLE. THIS SURVEY IS CERTIFIED FOR THIS TRANSACTION ONLY.

DATE: 07/03/2019

FILE:AD_CARL_MOTTEK_211H

DRAWN BY: H.B.

SHEET: 1 OF 1