

Submit 1 Copy To Appropriate District Office

District I - (575) 393-6161  
1625 N. French Dr., Hobbs, NM 88240  
District II - (575) 748-1283  
811 S. First St., Artesia, NM 88210  
District III - (505) 334-6178  
1000 Rio Brazos Rd., Aztec, NM 87410  
District IV - (505) 476-3460  
1220 S. St. Francis Dr., Santa Fe, NM 87505

State of New Mexico  
Energy, Minerals and Natural Resources

OIL CONSERVATION DIVISION

1000 South St. Francis Dr.  
Santa Fe, NM 87505

OCT 30 2019

Form C-103  
Revised July 18, 2013

<b>SUNDRY NOTICES AND REPORTS ON WELLS</b> (DO NOT USE THIS FORM FOR PROPOSALS TO DRILL OR TO DEEPEN OR PLUG BACK TO A DIFFERENT RESERVOIR. USE "APPLICATION FOR DEED" (FORM C-101) FOR SUCH PROPOSALS.)		WELL API NO. 30-025-28509
1. Type of Well: Oil Well <input type="checkbox"/> Gas Well <input checked="" type="checkbox"/> Other: Water Injector		5. Indicate Type of Lease STATE <input checked="" type="checkbox"/> FEE <input type="checkbox"/>
2. Name of Operator Blackbeard Operating, LLC		6. State Oil & Gas Lease No. A-983
3. Address of Operator 200 N. Lorraine, Suite 300 Midland, TX 79705		7. Lease Name or Unit Agreement Name STATE A A/C 3
4. Well Location Unit Letter <u>G</u> : <u>1345</u> feet from the <u>NORTH</u> line and <u>1480</u> feet from the <u>East</u> line Section <u>10</u> Township <u>23S</u> Range <u>36E</u> NMPM County <u>LEA</u>		8. Well Number <u>10</u>
11. Elevation (Show whether DR, RKB, RT, GR, etc.) 3650' (GL)		9. OGRID Number <u>3707367</u>
		10. Pool name or Wildcat LANGUE MATIX; 7 RVRS-Q-GRAYBURG

12. Check Appropriate Box to Indicate Nature of Notice, Report or Other Data

NOTICE OF INTENTION TO:

PERFORM REMEDIAL WORK ☐ PLUG AND ABANDON ☐  
TEMPORARILY ABANDON ☒ CHANGE PLANS ☐  
PULL OR ALTER CASING ☐ MULTIPLE COMPL ☐  
DOWNHOLE COMMINGLE ☐  
CLOSED-LOOP SYSTEM ☐  
OTHER: ☐

SUBSEQUENT REPORT OF:

REMEDIAL WORK ☐ ALTERING CASING ☐  
COMMENCE DRILLING OPNS. ☐ P AND A ☐  
CASING/CEMENT JOB ☐  
OTHER: ☐

13. Describe proposed or completed operations. (Clearly state all pertinent details, and give pertinent dates, including estimated date of starting any proposed work). SEE RULE 19.15.7.14 NMAC. For Multiple Completions: Attach wellbore diagram of proposed completion or recompletion.

Update to TA status from Shut in Water Injector

1. MIRU Plugging company. ND Wellhead. NU BOP.
2. Pull Tubing/Packer.
3. MU and RIH w/CIBP and set CIBP at 3575' MD
4. RIH w/tubing, tag CIBP at 3575' MD. Spot 25SX of 14.8ppg 1.32ft<sup>3</sup>/sx Class C cement at 3575' MD. POOH above TOC (~3334'), Circulate clean to surface. POOH w/10 joints. WOC.
5. RIH, Tag cement, Circulate MLF 10.0ppg Fluid, Test casing to 500psi, record results.

Spud Date:

Rig Release Date:

I hereby certify that the information above is true and complete to the best of my knowledge and belief.

SIGNATURE

TITLE

DATE

Type or print name

E-mail address:

PHONE:

For State Use Only

APPROVED BY:

TITLE

DATE

Conditions of Approval (if any):

Condition of Approval: notify

OCD Hobbs office 24 hours

prior of running MIT Test & Chart

Condition of Approval: notify

OCD Hobbs office 24 hours

prior of running MIT Test & Chart

State A A/C-3 #10 (Current)  
Pool: Langlie Mattix-7RVRS-Queen-Grayburg  
SU-T-R: 10G-23S-36E  
1345'FNL; 1480' FEL  
Lea, NM  
API: 30-025-28509



**BLACKBEARD  
OPERATING**

K.B. Elev. 3,474'  
Ground Level 3,650'

Spud Date: 2/6/1984

### Surface Casing

Hole Size: 12-1/4"

8-5/8", 24# @ 457' w/ 275 sx cmt. TOC @ surface,  
60SX to Surface  
Casing Head: 8-5/8" x 5-1/2" Larkin

### Well History:

#### Initial Completion (2/6/1984):

Drilled as injector and completed in 2 stages.

#### 4/1984 Produced well

After initial completion it was produced until injection  
facilities could be installed.

1<sup>st</sup> test: 15 BOPD, 10MCFD, 166 BWPD.

#### 8/1984 Convert to Injector

#### 10/1992: Pressure test Casing to 500psi.

Casing tests passed: 10/1992, 10/1997, 3/2003, 1/2009

#### Acid Stimulations:

11-1997, 1-1996,

#### 5/2019 MIT test (OCD onsite)

Test failed, did not pressure up, established injection  
very easily.

2019\_10: Pending PA

### Production Casing

Hole Size: 7-7/8"

5-1/2", 14# @ 3,800' TOC @ 2750' MD per Log  
Lead CMT: 650 SX LITE CMT  
Tail CMT: 200 SX 50-50 C & POZ.  
No CMT to surface, Circulation sporadic during job.

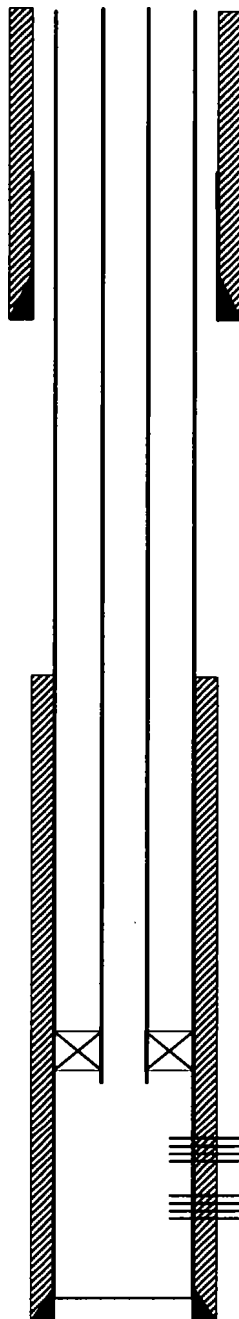

2-3/8" Tubing Cement Lined  
N Profile: 1.5" ID  
On/Off tool  
EOT @ 3559' MD

Otis Perma-latch Packer @ 3559' MD  
set w/7000' tension.

#### Grayburg Completion:

Perfs: 3655' - 3700' (1 SPF, 46 holes)  
Acidized w/4000gal 15% NEFE.

Perfs: 3700' - 3710' (1 SPF, 10 holes)  
Acidized w/1000gal 15% NEFE

TD - 3,800'  
PBTD - 3,758'

#### Est. tops

Rustler = 1235'  
Tansill = 2824'  
Yates = 2977'  
7 Rivers = 3164'  
Queen = 3518'  
G-Burg = 3710'

Last Dated: 10/22/2019  
Author: P. Tinar

**State A A/C-3 #10 (Proposed)**  
**Pool: Langlie Mattix-7RVRS-Queen-Grayburg**  
**SU-T-R: 10G-23S-36E**  
**1345'FNL; 1480' FEL**  
**Lea, NM**  
**API: 30-025-28509**



**BLACKBEARD**  
**OPERATING**

**K.B. Elev. 3,474'**  
**Ground Level 3,650'**

**Spud Date: 2/6/1984**

### **Surface Casing**

**Hole Size: 12-1/4"**

**8-5/8", 24# @ 457' w/ 275 sx cmt. TOC @ surface,**  
**60SX to Surface**  
**Casing Head: 8-5/8" x 5-1/2" Larkin**

### **Well History:**

#### **Initial Completion (2/6/1984):**

**Drilled as injector and completed in 2 stages.**

#### **4/1984 Produced well**

**After initial completion it was produced until injection facilities could be installed.**

**1<sup>st</sup> test: 15 BOPD, 10MCFD, 166 BWPD.**

#### **8/1984 Convert to Injector**

#### **10/1992: Pressure test Casing to 500psi.**

**Casing tests passed: 10/1992, 10/1997, 3/2003, 1/2009**

#### **Acid Stimulations:**

**11-1997, 1-1996,**

#### **5/2019 MIT test (OCD onsite)**

**Test failed, did not pressure up, established injection very easily.**

**Last Injection: 9/2018**

**2019\_10: Pending TA**

### **Production Casing**

**Hole Size: 7-7/8"**

**5-1/2", 14# @ 3,800' TOC @ 2750' MD per Log**  
**Lead CMT: 650 SX LITE CMT**  
**Tail CMT: 200 SX 50-50 C & POZ.**  
**No CMT to surface, Circulation sporadic during job.**

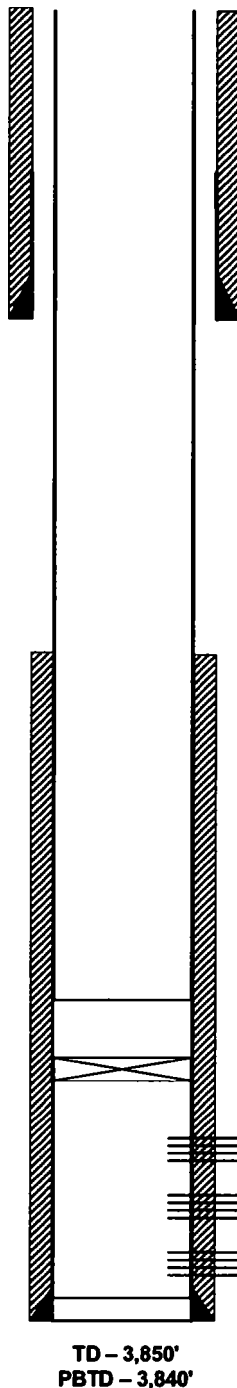

**CIBP @ 3575' MD w/ 25 Sx cement on top.**  
**Estimated TOC @ 3334' MD**

#### **Grayburg Completion:**

**Perfs: 3655' - 3700' (1 SPF, 46 holes)**  
**Acidized w/4000gal 15% NEFE.**

**Perfs: 3700' - 3710' (1 SPF, 10 holes)**  
**Acidized w/1000gal 15% NEFE**

**Est. tops**  
**Rustler = 1235'**  
**Tansill = 2824'**  
**Yates = 2977'**  
**7 Rivers = 3164'**  
**Queen = 3518'**  
**G-Burg = 3710'**

**Last Dated: 10/22/2019**  
**Author: P. Tinar**

	Plug 1
	14.8 ppg
	25 sx
	1.32 ft <sup>3</sup> /sx
	33 ft <sup>3</sup>
	5.9 bbls
Plug length	241 ft
Base	3575 ft
TOC	3334 ft

5-1/2" 14ppf  
Casing Capacity  
0.0244 bbl/ft

[illegible]

# INSTRUCTIONS

This form is to be filed with the appropriate District Office of the Division not later than 20 days after the completion of any newly-drilled or deepened well. It shall be accompanied by one copy of all electrical and radio-activity logs run on the well and a summary of all special tests conducted, including drill stem tests. All depths reported shall be measured depths. In the case of directionally drilled wells, true vertical depths shall also be reported. For multiple completions, items 30 through 34 shall be reported for each zone. The form is to be filed in quintuplicate except on state land, where six copies are required. See Rule 1105.

## INDICATE FORMATION TOPS IN CONFORMANCE WITH GEOGRAPHICAL SECTION OF STATE

### Southeastern New Mexico

### Northwestern New Mexico

T. Anhy <u>1235</u>	T. Canyon	T. Ojo Alamo	T. Penn. "B"
T. Salt	T. Strawn	T. Kirtland-Fruitland	T. Penn. "C"
B. Salt	T. Atoka	T. Pictured Cliffs	T. Penn. "D"
T. Yates <u>2977</u>	T. Miss	T. Cliff House	T. Leadville
T. 7 Rivers <u>3164</u>	T. Devonian	T. Menefee	T. Madison
T. Queen <u>3518</u>	T. Silurian	T. Point Lookout	T. Elbert
T. Grayburg <u>3710</u>	T. Montoya	T. Mancos	T. McCracken
T. San Andras	T. Simpson	T. Gallup	T. Ignacio Qtzite
T. Glorieta	T. McKee	Base Greenhorn	T. Granite
T. Paddock	T. Ellenburger	T. Dakota	
T. Blinberry	T. Gr. Wash	T. Morrison	
T. Tubb	T. Granite	T. Todillo	
T. Drinkard	T. Delaware Sand	T. Entrada	
T. Abo	T. Bone Springs	T. Wingate	
T. Wolfcamp	T. Tansill <u>2824</u>	T. Chinle	
T. Penn.		T. Permian	
T. Cisco (Bough C)		T. Penn. "A"	

### OIL OR GAS SANDS OR ZONES

No. 1, from <u>3655</u> to <u>3710</u>	No. 4, from _____ to _____
No. 2, from _____ to _____	No. 5, from _____ to _____
No. 3, from _____ to _____	No. 6, from _____ to _____

### IMPORTANT WATER SANDS

Include data on rate of water inflow and elevation to which water rose in hole.

No. 1, from _____ to _____	feet.
No. 2, from _____ to _____	feet.
No. 3, from _____ to _____	feet.
No. 4, from _____ to _____	feet.

### FORMATION RECORD (Attach additional sheets if necessary)

From	To	Thickness in Feet	Formation	From	To	Thickness in Feet	Formation
1235	2824	1589'	Anhydrite and salt	3710	3790	80'	Dolomite
2824	2977	153'	Sandstone, Dolomite, thin Interbedded Shales				
2977	3164	187'	Sandstone, thin Dolomites, Dolomitic Sands				
3164	3518	354'	Dolomite, Sandstone, Sandy Dolomites,				
3518	3710	192'	Sandstone, Dolomite, Sandy Dolomites, Dolomitic Sands				

RECEIVED

APR 16 1964

O.C.D.  
HOBBS OFFICE

**MEXICO OIL CONSERVATION COMMISSION  
WELL LOCATION AND ACREAGE DEDICATION PLAT**

Form C-102  
Supersedes C-128  
Effective 1-4-65

All distances must be from the outer boundaries of the Section.

Operator <b>SUN Exploration &amp; Production Co.</b>			Lease <b>STATE "A" A/C-3</b>		Well No. <b>10</b>
Unit Letter <b>G</b>	Section <b>10</b>	Township <b>23 SOUTH</b>	Range <b>36 EAST</b>	County <b>LEA</b>	
Actual Footage Location of Well: <b>1345</b> feet from the <b>North</b> line and <b>1480</b> feet from the <b>East</b> line					
Grid and Level Elev. <b>3462.3</b>	Producing Formation <b>Seven Rivers/Queen</b>		Pool <b>Langlie-Mattix</b>	Dedicated Acreage: <b>None-WIW</b> Acres	

1. Outline the acreage dedicated to the subject well by colored pencil or hachure marks on the plat below.
2. If more than one lease is dedicated to the well, outline each and identify the ownership thereof (both as to working interest and royalty).
3. If more than one lease of different ownership is dedicated to the well, have the interests of all owners been consolidated by communitization, unitization, force-pooling, etc?

☐ Yes ☐ No If answer is "yes," type of consolidation \_\_\_\_\_

If answer is "no," list the owners and tract descriptions which have actually been consolidated. (Use reverse side of this form if necessary.) \_\_\_\_\_

No allowable will be assigned to the well until all interests have been consolidated (by communitization, unitization, forced-pooling, or otherwise) or until a non-standard unit, eliminating such interests, has been approved by the Commission.

**CERTIFICATION**

I hereby certify that the information contained herein is true and complete to the best of my knowledge and belief.

*Maria L. Perez*  
Name

Maria L. Perez

Position

Sr. Acctng. Asst.

Company

Sun Exploration & Production Co.

Date

11/7/83

I hereby certify that the well location shown on this plat was plotted from field notes of actual surveys made by me or under my supervision, and that the same is true and correct to the best of my knowledge and belief.

Date Surveyed

OCTOBER 25, 1983

Registered Professional Engineer  
and/or Land Surveyor

*John W. West*

Certificate No. JOHN W. WEST, 676

RONALD J. EIDSON, 3239

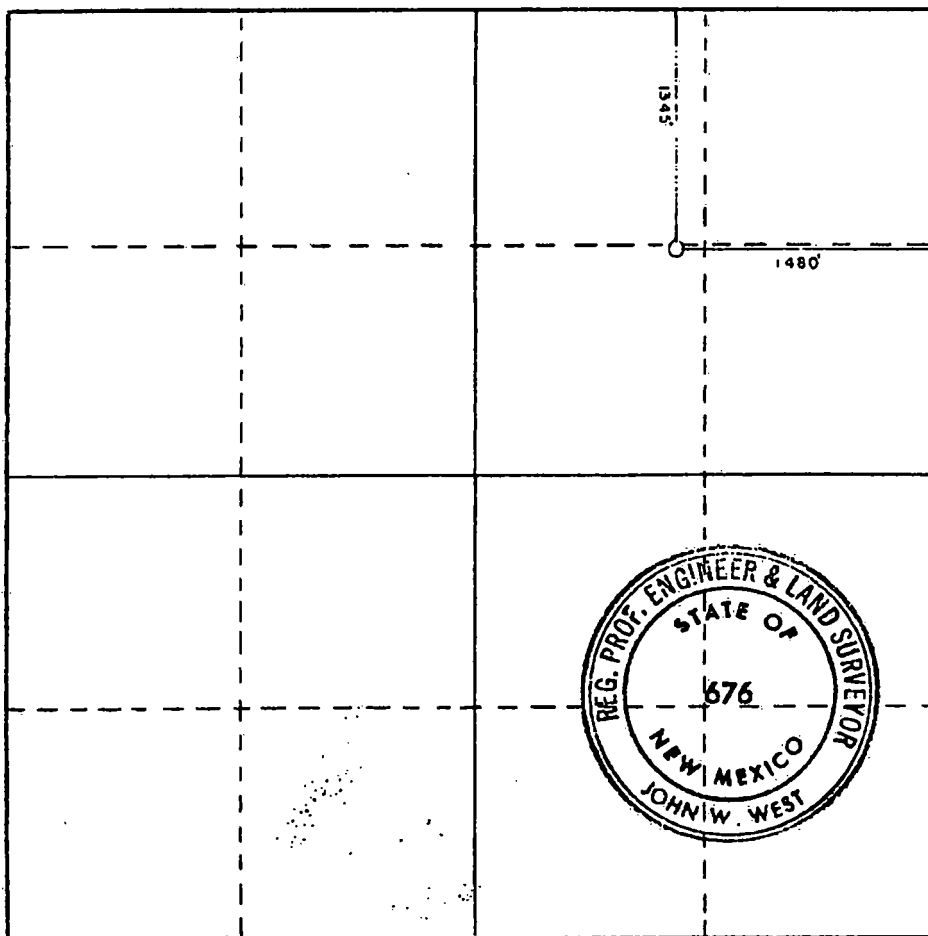

330 660 990 1320 1650 1980 2310 2640 2970 3300 3630 3960 4290 4620 4950 5280 5610 5940 6270 6600

# INCLINATION REPORT

OPERATOR SUN Exploration & Production Co. ADDRESS P.O. BOX 1861, MIDLAND, TEXAS 79702  
 LEASE NAME STATE "A" A/C 3 WELL NO. 10 FIELD Anglie Mattix 7 Rivers Queen Grayburg  
 LOCATION LEA COUNTY, NEW MEXICO

DEPTH	ANGLE INCLINATION DEGREES	DISPLACEMENT	DISPLACEMENT ACCUMULATED
457	$\frac{1}{8}$	2.0108	2.0108
866	$\frac{1}{8}$	1.7996	3.8104
1360	$\frac{1}{2}$	4.2978	8.1082
1854	$\frac{1}{2}$	4.2978	12.4060
2351	$\frac{3}{4}$	6.5107	18.9167
2847	1	8.6800	27.5967
2909	1	1.0850	28.6817
3407	$1\frac{1}{2}$	13.0476	41.7293
3717	$1\frac{3}{4}$	9.4550	51.1843
3800	$1\frac{3}{4}$	2.5315	53.7158

I hereby certify that the above data as set forth is true and correct to the best of my knowledge and belief.

CACTUS DRILLING COMPANY

Debbie Clark  
 TITLE DEBBIE CLARK, OFFICE MANAGER

## AFFIDAVIT:

Before me, the undersigned authority, appeared DEBBIE CLARK  
 known to me to be the person whose name is subscribed herebelow, who, on making deposition, under oath states that he is acting for and in behalf of the operator of the well identified above, and that to the best of his knowledge and belief such well was not intentionally deviated from the true vertical whatsoever.

Debbie Clark  
 AFFIANT'S SIGNATURE

Sworn and subscribed to in my presence on this the 20TH day of FEBRUARY, 1984

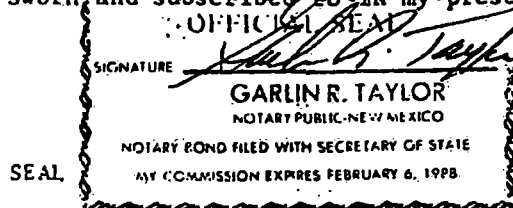

Notary Public in and for the County  
 of Lea, State of New Mexico



3600

STATE A A/C 3 #10  
Schlum CNL log  
2/25/84

3655

IA

3700

I

3710

CCb

3784 FR

3787 TD

3800