

District I
1625 N. French Dr., Hobbs, NM 88240
Phone: (575) 393-6161 Fax: (575) 393-0720

District II
811 S. First St., Artesia, NM 88210
Phone: (575) 748-1283 Fax: (575) 748-9720

District III
1000 Rio Brazos Road, Aztec, NM 87410
Phone: (505) 334-6178 Fax: (505) 334-6170

District IV
1220 S. St. Francis Dr., Santa Fe, NM 87505
Phone: (505) 476-3460 Fax: (505) 476-3462

State of New Mexico
Energy, Minerals & Natural Resources Department
OIL CONSERVATION DIVISION
1220 South St. Francis Dr.
Santa Fe, NM 87505

Form C-102
Revised August 1, 2011
Submit one copy to appropriate
District Office

HOBBS OGD
RECEIVED
DEC 05 2019

AMENDED REPORT

WELL LOCATION AND ACREAGE DEDICATION PLAT

¹ API Number 30-025- 46588		² Pool Code 96438	³ Pool Name Hat Mesa; Wolfcamp
⁴ Property Code 326516	⁵ Property Name GAVILON FED COM		⁶ Well Number 704H
⁷ OGRID No. 325830	⁸ Operator Name ASCENT ENERGY		⁹ Elevation 3,661'

¹⁰ Surface Location

UL or lot no.	Section	Township	Range	Lot Idn	Feet from the	North/South line	Feet from the	East/West line	County
M	33	20 S	33 E		125	SOUTH	792	WEST	LEA

¹¹ Bottom Hole Location If Different From Surface

UL or lot no.	Section	Township	Range	Lot Idn	Feet from the	North/South line	Feet from the	East/West line	County
D	28	20 S	33 E		330	NORTH	1,030	WEST	LEA

¹² Dedicated Acres 320.00	¹³ Joint or Infill	¹⁴ Consolidation Code C	¹⁵ Order No.
---	-------------------------------	---------------------------------------	-------------------------

No allowable will be assigned to this completion until all interests have been consolidated or a non-standard unit has been approved by the division.

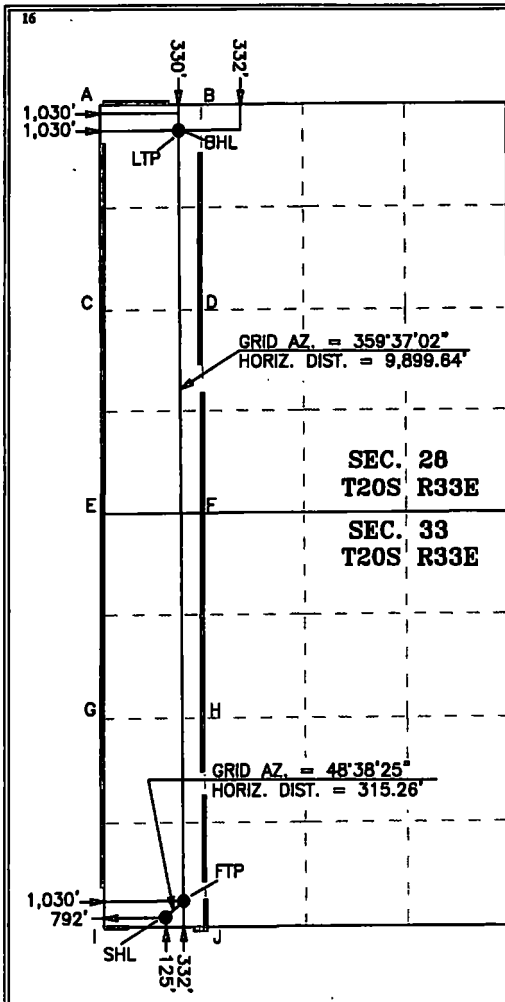

GEODETTIC COORDINATES
NAD 27 NME
SURFACE LOCATION
Y = 554,453.7
X = 703,297.4
LAT. = 32.522573°N
LONG. = 103.673762°W

GEODETTIC COORDINATES
NAD 83 NME
SURFACE LOCATION
Y = 554,515.0
X = 744,478.1
LAT. = 32.522694°N
LONG. = 103.674256°W

FIRST TAKE POINT
NAD 27 NME
Y = 554,682.0
X = 703,534.0
LAT. = 32.523142°N
LONG. = 103.672980°W

FIRST TAKE POINT
NAD 83 NME
Y = 554,723.3
X = 744,714.7
LAT. = 32.523263°N
LONG. = 103.673484°W

CORNER COORDINATES TABLE
NAD 27 NME

A - Y = 584,886.8 N, X = 702,435.9 E
B - Y = 584,889.8 N, X = 703,758.5 E
C - Y = 582,245.8 N, X = 702,453.7 E
D - Y = 582,232.4 N, X = 703,778.0 E
E - Y = 559,604.5 N, X = 702,471.5 E
F - Y = 559,811.7 N, X = 703,793.7 E
G - Y = 556,985.1 N, X = 702,489.0 E
H - Y = 556,972.4 N, X = 703,811.1 E
I - Y = 554,324.2 N, X = 702,508.2 E
J - Y = 554,331.7 N, X = 703,828.4 E

CORNER COORDINATES TABLE
NAD 83 NME

A - Y = 584,948.1 N, X = 743,616.3 E
B - Y = 584,954.1 N, X = 744,938.9 E
C - Y = 582,307.0 N, X = 743,634.1 E
D - Y = 582,313.8 N, X = 744,958.5 E
E - Y = 559,685.9 N, X = 743,852.0 E
F - Y = 559,673.1 N, X = 744,974.2 E
G - Y = 557,026.4 N, X = 743,869.8 E
H - Y = 557,033.7 N, X = 744,991.7 E
I - Y = 554,385.5 N, X = 743,886.9 E
J - Y = 554,393.0 N, X = 745,009.1 E

LAST TAKE POINT
NAD 27 NME
Y = 564,559.3
X = 703,468.2
LAT. = 32.550347°N
LONG. = 103.673005°W

LAST TAKE POINT
NAD 83 NME
Y = 564,620.8
X = 744,648.8
LAT. = 32.550488°N
LONG. = 103.673500°W

BOTTOM HOLE LOCATION
NAD 27 NME
Y = 564,561.3
X = 703,468.1
LAT. = 32.550353°N
LONG. = 103.673005°W

BOTTOM HOLE LOCATION
NAD 83 NME
Y = 564,622.8
X = 744,648.5
LAT. = 32.550473°N
LONG. = 103.673500°W

¹⁷ OPERATOR CERTIFICATION

I hereby certify that the information contained herein is true and complete to the best of my knowledge and belief, and that this organization either owns a working interest or unleased mineral interest in the land including the proposed bottom hole location or has a right to drill this well at this location pursuant to a contract with an owner of such a mineral or working interest, or to a voluntary pooling agreement or a compulsory pooling order heretofore entered by the division.

Brian Wood 6-9-18

Signature Date

BRIAN WOOD

Printed Name

brian@permitswest.com

E-mail Address

(505) 466-8120

¹⁸ SURVEYOR CERTIFICATION

I hereby certify that the well location shown on this plat was plotted from field notes of actual surveys made by me or under my supervision, and that the same is true and correct to the best of my belief.

04-25-2018

Date of Survey

Signature and Seal of Professional Surveyor:



MARK DILLON HARP 23786
Certificate Number

AW 2018010118