

Distances/areas relative to NAD 83 Combined Scale Factor: 0.99983935 Convergence: 00°30'07.11000"

LOCATION VERIFICATION MAP

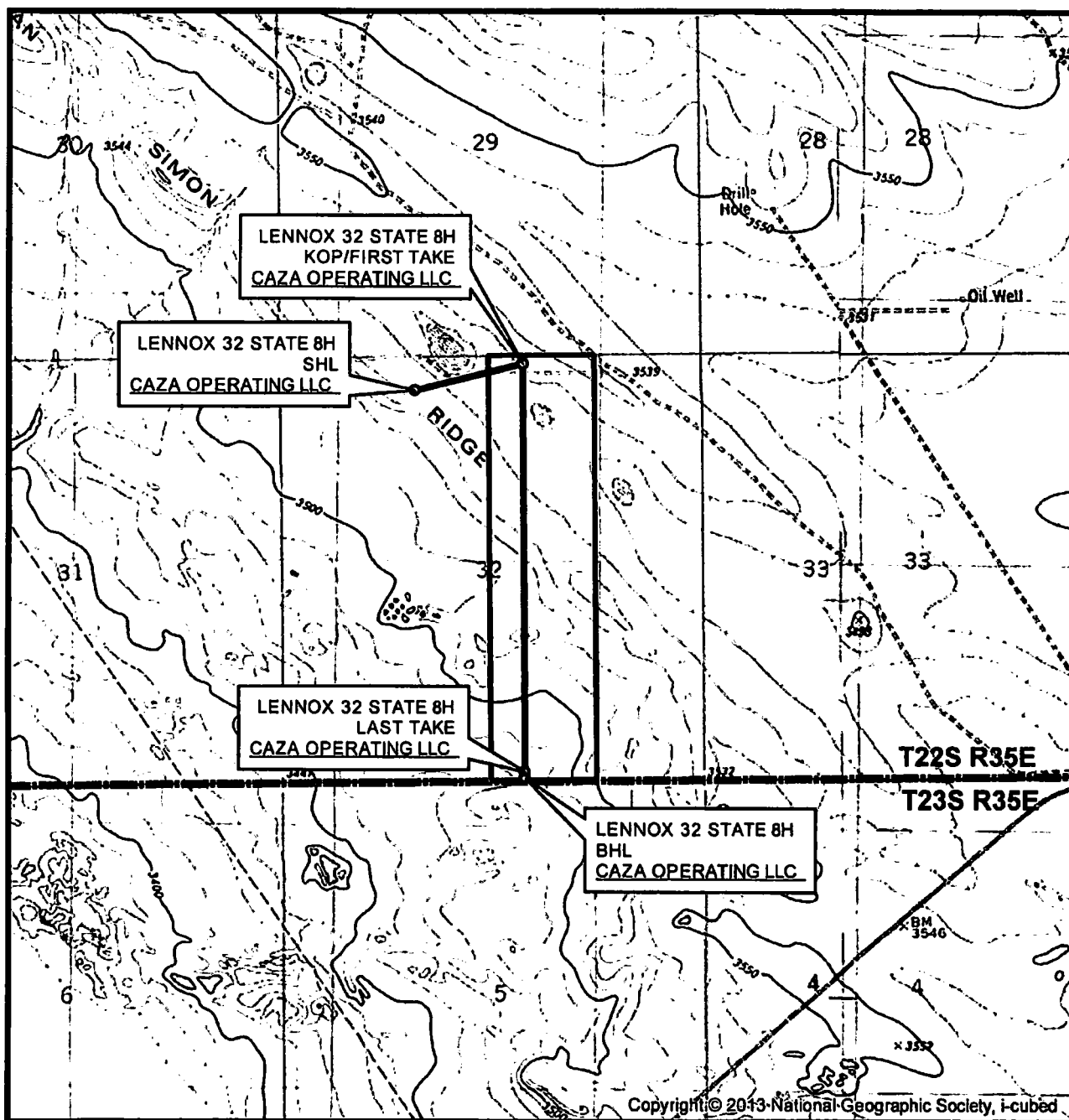

SEC. 32 TWP. 22-S RGE. 35-E
 SURVEY: N.M.P.M.
 COUNTY: LEA
 OPERATOR: CAZA OPERATING LLC
 DESCRIPTION: 422' FNL & 1730' FWL
 ELEVATION: 3534'
 LEASE: LENNOX 32 STATE
 U.S.G.S. TOPOGRAPHIC MAP: SAN SIMON SINK, NM.

1" = 2,000'
 CONTOUR INTERVAL = 10'



SHEET 2 OF 3

PREPARED BY:
 R-SQUARED GLOBAL, LLC
 1309 LOUISVILLE AVENUE, MONROE, LA 71201
 318-323-6900 OFFICE
 JOB No. R4017_001_D

VICINITY MAP

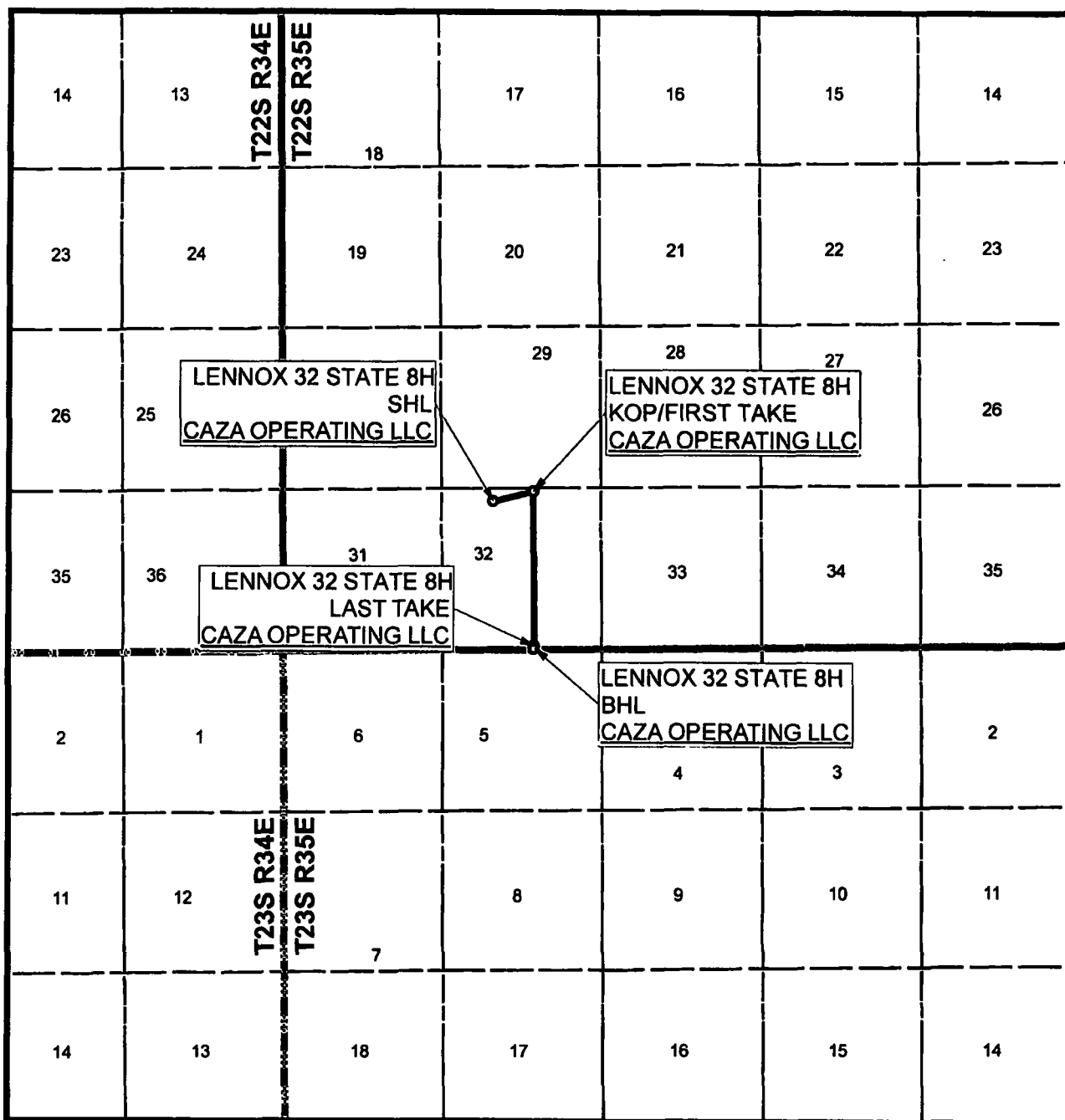

SEC. 32 TWP. 22-S RGE. 35-E

SURVEY: N.M.P.M.

COUNTY: LEA

OPERATOR: CAZA OPERATING LLC

DESCRIPTION: 422' FNL & 1730' FWL

ELEVATION: 3534'

LEASE: LENNOX 32 STATE

U.S.G.S. TOPOGRAPHIC MAP: SAN SIMON SINK, NM.

1" = 1 MILE



SHEET 3 OF 3

PREPARED BY:
R-SQUARED GLOBAL, LLC
1309 LOUISVILLE AVENUE, MONROE, LA 71201
318-323-6900 OFFICE
JOB No. R4017_001_D