

**District I**  
1625 N. French Dr., Hobbs, NM 88240  
Phone: (575) 393-6161 Fax: (575) 393-0720

**District II**  
811 S. First St., Artesia, NM 88210  
Phone: (575) 748-1283 Fax: (575) 748-9720

**District III**  
1000 Rio Brazos Road, Aztec, NM 87410  
Phone: (505) 334-6178 Fax: (505) 334-6170

**District IV**  
1220 S. St. Francis Dr., Santa Fe, NM 87505  
Phone: (505) 476-3460 Fax: (505) 476-3462

State of New Mexico  
Energy, Minerals & Natural Resources Department  
OIL CONSERVATION DIVISION  
1220 South St. Francis Dr.  
Santa Fe, NM 87505

Form C-102  
Revised August 1, 2011  
Submit one copy to appropriate  
District Office

**HOBBS OCD**

JAN 14 2020

☐ AMENDED REPORT  
As-Drilled

**RECEIVED**

WELL LOCATION AND ACREAGE DEDICATION PLAT

<sup>1</sup> API Number 30-025-46000	<sup>2</sup> Pool Code 2220	<sup>3</sup> Pool Name ANTELOPE RIDGE; WOLFCAMP
<sup>4</sup> Property Code 325679	Property Name WILL KANE 15 WXY FEE	
<sup>7</sup> OGRID No. 372098	<sup>8</sup> Operator Name MARATHON OIL PERMIAN LLC	<sup>6</sup> Well Number 10H
		<sup>9</sup> Elevation 3507'

<sup>10</sup> Surface Location

UL or lot no.	Section	Township	Range	Lot Idn	Feet from the	North/South line	Feet from the	East/West line	County
0	15	24S	34E		520	SOUTH	1329	EAST	LEA

<sup>11</sup> Bottom Hole Location If Different From Surface

UL or lot no.	Section	Township	Range	Lot Idn	Feet from the	North/South line	Feet from the	East/West line	County
A	15	24S	34E		56	NORTH	998	EAST	LEA

<sup>12</sup> Dedicated Acres 320.0	<sup>13</sup> Joint or Infill	<sup>14</sup> Consolidation Code	<sup>15</sup> Order No.
--	-------------------------------	----------------------------------	-------------------------

No allowable will be assigned to this completion until all interests have been consolidated or a non-standard unit has been approved by the division.

<p><sup>16</sup> <b>BOTTOM HOLE LOCATION</b> 17,336' MEASURED DEPTH IN FEET NAD 83, SPCS NM EAST X813715.42' / Y446369.50' LATG2.22462679N / LON103.45252193V NAD 87, SPCS NM EAST X772530.78' / Y446310.56' LATG2.22450209N / LON103.45204775V</p>		<p><b>SECTION 11</b></p>	
<p><b>SECTION 9</b> <b>SECTION 10</b></p>		<p><b>SECTION 14</b></p>	
<p><b>LAST TAKE POINT</b> 17,292' MEASURED DEPTH IN FEET NAD 83, SPCS NM EAST X813716.50' / Y446323.74' LATG2.22450649N / LON103.45251960V NAD 87, SPCS NM EAST X772531.86' / Y446466.80' LATG2.22438179N / LON103.45204542V</p>		<p><b>SECTION 16</b> <b>SECTION 15</b></p>	
<p><b>FIRST TAKE POINT</b> 12,258' MEASURED DEPTH IN FEET NAD 83, SPCS NM EAST X813727.82' / Y441553.42' LATG2.21083938N / LON103.45261476V NAD 87, SPCS NM EAST X772542.94' / Y441494.62' LATG2.21071462N / LON103.45214142V</p>		<p><b>SECTION 14</b></p>	
<p><b>KICK OFF POINT</b> 11,800' MEASURED DEPTH IN FEET NAD 83, SPCS NM EAST X813733.99' / Y441446.78' LATG2.21054615N / LON103.45259764V NAD 87, SPCS NM EAST X772549.11' / Y441387.98' LATG2.21042137N / LON103.45212432V</p>		<p><b>SECTION 14</b></p>	
<p><b>SURFACE HOLE LOCATION</b> 520' FSL 1329' FEL SECTION 15 NAD 83, SPCS NM EAST X813727.33' / Y441865.19' LATG2.21170309N / LON103.45357799V NAD 87, SPCS NM EAST X772242.48' / Y441806.38' LATG2.21157834N / LON103.45310454V</p>		<p><b>SECTION 14</b></p>	
<p><b>CORNER COORDINATES</b> NAD 83, SPCS NM EAST A - X: 812076.95' / Y: 446621.80' B - X: 770892.37' / Y: 446562.88' C - X: 814712.56' / Y: 446628.14' D - X: 773527.90' / Y: 446569.19' E - X: 814761.62' / Y: 441354.86' F - X: 773576.71' / Y: 441296.05' G - X: 812116.92' / Y: 441336.41' H - X: 770932.07' / Y: 441277.63'</p>		<p><b>SECTION 14</b></p>	

<sup>17</sup> OPERATOR CERTIFICATION

I hereby certify that the information contained herein is true and complete to the best of my knowledge and belief, and that this organization either owns a working interest or unleased mineral interest in the land including the proposed bottom hole location or has a right to drill this well at this location pursuant to a contract with an owner of such a mineral or working interest, or to a voluntary pooling agreement or a compulsory pooling order heretofore entered by the division.

Signature: *Adrian Covarrubias* Date: 1/9/2020

Printed Name: Adrian Covarrubias

E-mail Address:

<sup>18</sup> SURVEYOR CERTIFICATION

I hereby certify that the well surface location shown on this plat was plotted from field notes of the as-staked surveys made by me or under my supervision, and that the same is true and correct to the best of my belief. Data used for underground measurements were provided by others for reference only and does not constitute field measurements performed by R-Squared Global.

DECEMBER 11, 2019

Date of Survey: Signature and Seal of Professional Surveyor

Certificate Number: DAVID W. MYERS 11403

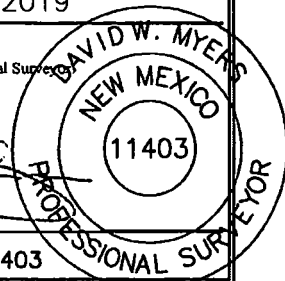

DISTANCES/AREAS RELATIVE TO NAD83 COMBINED SCALE FACTOR: 0.99981187  
CONVERGENCE: 0.434900357 NOTE: ALL DIMENSIONS IN U.S. FEET

1	12/11/2019	DEF
REV.	DATE	BY

SHEET 1 OF 1  
R3973\_001