

District I
1625 N. French Dr., Hobbs, NM 88240
Phone: (575) 393-6161 Fax: (575) 393-0720
District II
811 S. First St., Artesia, NM 88210
Phone: (575) 748-1283 Fax: (575) 748-9720
District III
1000 Rio Brazos Road, Aztec, NM 87410
Phone: (505) 334-6178 Fax: (505) 334-6170
District IV
1220 S. St. Francis Dr., Santa Fe, NM 87505
Phone: (505) 476-3460 Fax: (505) 476-3462

State of New Mexico
Energy, Minerals & Natural Resources Department
OIL CONSERVATION DIVISION
1220 South St. Francis Dr.
Santa Fe, NM 87505

Form C-102
Revised August 1, 2011
Submit one copy to appropriate
District Office

☒ AMENDED REPORT
"As-Drilled"

HOBBS OCD
FEB 24 2020
RECEIVED

WELL LOCATION AND ACREAGE DISPOSITION PLAT

¹ API Number 30-025-44485	² Pool Code 98308	³ Well Name NEEDMORE TANK; UPPER WOLFCAMP
⁴ Property Code 320787	⁵ Property Name SD EA 29 32 FED COM P10	⁶ Well Number 17H
⁷ GRID No. 4323	⁸ Operator Name CHEVRON U.S.A. INC.	⁹ Elevation 3236'

¹⁰ Surface Location

UL or lot no.	Section	Township	Range	Lot Idn	Feet from the	North/South line	Feet from the	East/West line	County
C	29	26 SOUTH	33 EAST, N.M.P.M.		120'	NORTH	2605'	WEST	LEA

¹¹ Bottom Hole Location If Different From Surface

UL or lot no.	Section	Township	Range	Lot Idn	Feet from the	North/South line	Feet from the	East/West line	County
F	32	26 SOUTH	33 EAST, N.M.P.M.		50'	SOUTH	1998'	WEST	LEA

¹² Dedicated Acres 949.56	¹³ Joint or Infill Infill	¹⁴ Consolidation Code	¹⁵ Order No. R-20300
---	---	----------------------------------	------------------------------------

No allowable will be assigned to this completion until all interests have been consolidated or a non-standard unit has been approved by the division.

¹⁶

SD EA 29 32 FED COM P10 NO. 17H WELL	
X= 728,159'	NAD 27
Y= 372,262'	
LAT. 32.021307° N	
LONG. 103.593835° W	
X= 770,347'	NAD83/2011
Y= 372,319'	
LAT. 32.021432° N	
LONG. 103.594402° W	
ELEVATION +3236' NAVD 88	
FINAL KICK OFF POINT	
X= 728,548'	NAD 27
Y= 372,287'	
LAT. 32.021388° N	
LONG. 103.595905° W	
X= 769,736'	NAD83/2011
Y= 372,344'	
LAT. 32.021514° N	
LONG. 103.598372° W	
FINAL FIRST TAKE POINT	
X= 728,615'	NAD 27
Y= 371,963'	
LAT. 32.020498° N	
LONG. 103.595698° W	
X= 769,803'	NAD83/2011
Y= 372,020'	
LAT. 32.020822° N	
LONG. 103.596163° W	
FINAL LAST TAKE POINT	
X= 728,618'	NAD 27
Y= 364,758'	
LAT. 32.000685° N	
LONG. 103.595846° W	
X= 769,806'	NAD83/2011
Y= 364,813'	
LAT. 32.000810° N	
LONG. 103.596312° W	
AS-DRILLED BOTTOM HOLE LOCATION	
X= 728,615'	NAD 27
Y= 364,599'	
LAT. 32.000253° N	
LONG. 103.595860° W	
X= 769,803'	NAD83/2011
Y= 364,856'	
LAT. 32.000379° N	
LONG. 103.596325° W	

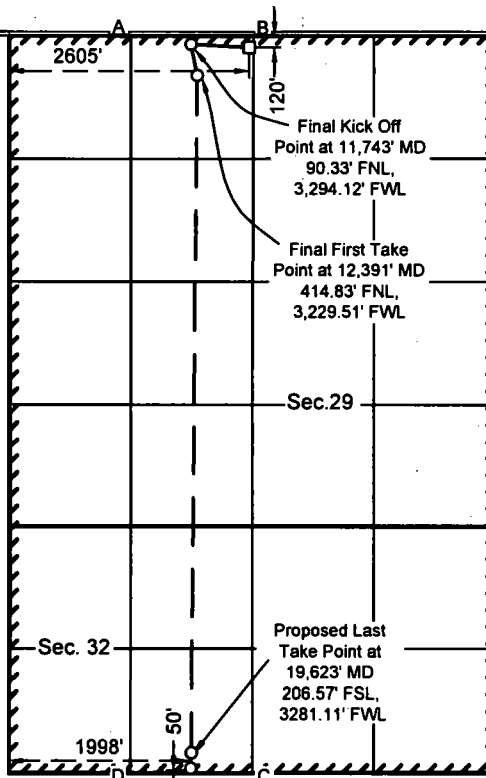

CORNER COORDINATES TABLE (NAD 27)

A - Y=372373.27, X=727875.49
B - Y=372382.09, X=729197.59
C - Y=364553.99, X=729259.12
D - Y=364544.81, X=727938.29

¹⁷ OPERATOR CERTIFICATION

I hereby certify that the information contained herein is true and complete to the best of my knowledge and belief, and that this organization either owns a working interest or unleased mineral interest in the land including the proposed bottom hole location or has a right to drill this well at this location pursuant to a contract with an owner of such a mineral or working interest, or to a voluntary pooling agreement or a compulsory pooling order heretofore entered by the division.

[Signature] 2/20/2020
Signature Date

Laura Becerra
Printed Name

LBecerra@Chevron.com
E-mail Address

¹⁸ SURVEYOR CERTIFICATION

I hereby certify that the well location shown on this plat was plotted from field notes of actual surveys made by me or under my supervision, and that the same is true and correct to the best of my belief.

03/06/2018
Date of Survey

[Signature]
Signature and Seal of Professional Surveyor:

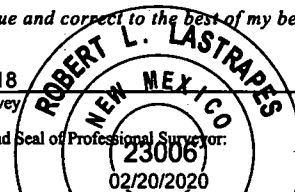

Certificate Number

Intent ☐ As Drilled ☒

API # 30-025-44485			
Operator Name: CHEVRON USA INC		Property Name: SD EA 29 32 FED COM P10	Well Number 17H

Kick Off Point (KOP)

UL C	Section 29	Township 26S	Range 33E	Lot	Feet 90	From N/S FNL	Feet 3,294	From E/W FWL	County LEA
Latitude 32.021514					Longitude 103.596372				NAD NAD 83/86

First Take Point (FTP)

UL C	Section 29	Township 26S	Range 33E	Lot	Feet 415	From N/S FNL	Feet 3,230	From E/W FWL	County LEA
Latitude 32.020622					Longitude 103.596163				NAD NAD 83/86

Last Take Point (LTP)

UL F	Section 32	Township 26S	Range 33E	Lot	Feet 207	From N/S FSL	Feet 3,281	From E/W FWL	County LEA
Latitude 32.000810					Longitude 103.596312				NAD NAD 83/86

Is this well the defining well for the Horizontal Spacing Unit? ☐ NO

Is this well an infill well? ☐ YES

If infill is yes please provide API if available, Operator Name and well number for Defining well for Horizontal Spacing Unit.

API # 30-025-43268			
Operator Name: CHEVRON USA INC		Property Name: SD EA 29 FED COM P8	Well Number 9H

KZ 06/29/2018