

UNITED STATES
DEPARTMENT OF THE INTERIOR
BUREAU OF LAND MANAGEMENTFORM APPROVED
OMB NO. 1004-0137
Expires: January 31, 2018**SUNDRY NOTICES AND REPORTS ON WELLS**
*Do not use this form for proposals to drill or to re-enter an abandoned well. Use form 3160-3 (APD) for such proposals.***SUBMIT IN TRIPLICATE - Other instructions on page 2**

1. Type of Well <input checked="" type="checkbox"/> Oil Well <input type="checkbox"/> Gas Well <input type="checkbox"/> Other		8. Well Name and No. SD 15 FED P419 11H
2. Name of Operator CHEVRON USA INC Contact: KAYLA MCCONNELL E-Mail: kaylamccconnell@chevron.com		9. API Well No. 30-025-46730-00-X1
3a. Address 1616 W. BENDER BLVD HOBBS, NM 88240	3b. Phone No. (include area code) Ph: 432-687-7375	10. Field and Pool or Exploratory Area ANTELOPE RIDGE-WOLFCAMP
4. Location of Well (Footage, Sec., T., R., M., or Survey Description) Sec 15 T26S R32E SESE 577FSL 1020FEL 32.037186 N Lat, 103.657486 W Lon		11. County or Parish, State LEA COUNTY, NM

12. CHECK THE APPROPRIATE BOX(ES) TO INDICATE NATURE OF NOTICE, REPORT, OR OTHER DATA

TYPE OF SUBMISSION	TYPE OF ACTION			
<input checked="" type="checkbox"/> Notice of Intent	<input type="checkbox"/> Acidize	<input type="checkbox"/> Deepen	<input type="checkbox"/> Production (Start/Resume)	<input type="checkbox"/> Water Shut-Off
<input type="checkbox"/> Subsequent Report	<input type="checkbox"/> Alter Casing	<input type="checkbox"/> Hydraulic Fracturing	<input type="checkbox"/> Reclamation	<input type="checkbox"/> Well Integrity
<input type="checkbox"/> Final Abandonment Notice	<input type="checkbox"/> Casing Repair	<input type="checkbox"/> New Construction	<input type="checkbox"/> Recomplete	<input checked="" type="checkbox"/> Other Surface Disturbance
	<input type="checkbox"/> Change Plans	<input type="checkbox"/> Plug and Abandon	<input type="checkbox"/> Temporarily Abandon	
	<input type="checkbox"/> Convert to Injection	<input type="checkbox"/> Plug Back	<input type="checkbox"/> Water Disposal	

13. Describe Proposed or Completed Operation: Clearly state all pertinent details, including estimated starting date of any proposed work and approximate duration thereof. If the proposal is to deepen directionally or recompleat horizontally, give subsurface locations and measured and true vertical depths of all pertinent markers and zones. Attach the Bond under which the work will be performed or provide the Bond No. on file with BLM/BIA. Required subsequent reports must be filed within 30 days following completion of the involved operations. If the operation results in a multiple completion or recompleat in a new interval, a Form 3160-4 must be filed once testing has been completed. Final Abandonment Notices must be filed only after all requirements, including reclamation, have been completed and the operator has determined that the site is ready for final inspection.

Chevron USA Inc. respectfully request to relocate primary access road from the Southeast corner of the Pad to the Southwest corner with a 30' x 170.01' road.

After submittal of the access road route with the APD for Salado Draw Pad #419, an EDS/power line was constructed in the vicinity that resulted in a guide wire that runs directly through the access road. The guide wire is used to structurally support the power line and is unable to be relocated without taking power down to the entire Field. This proposed Sundry relocates the access road so as to remove any interference with existing infrastructure, and also shortens the total footprint/disturbance of the access road to a total of 30' x 170.01'.

Please see the attached Access Road Map.

14. I hereby certify that the foregoing is true and correct. Electronic Submission #502289 verified by the BLM Well Information System For CHEVRON USA INC, sent to the Hobbs Committed to AFMSS for processing by PRISCILLA PEREZ on 02/11/2020 (20PP1260SE)	
Name (Printed/Typed) KAYLA MCCONNELL	Title PERMITTING SPECIALIST
Signature (Electronic Submission)	Date 02/06/2020

THIS SPACE FOR FEDERAL OR STATE OFFICE USE

Approved By <u>CODY LAYTON</u>	Title <u>ASSISTANT FIELD MANAGER</u>	Date <u>02/21/2020</u>
Conditions of approval, if any, are attached. Approval of this notice does not warrant or certify that the applicant holds legal or equitable title to those rights in the subject lease which would entitle the applicant to conduct operations thereon.		Office <u>Hobbs</u>

Title 18 U.S.C. Section 1001 and Title 43 U.S.C. Section 1212, make it a crime for any person knowingly and willfully to make to any department or agency of the United States any false, fictitious or fraudulent statements or representations as to any matter within its jurisdiction.

(Instructions on page 2)

**** BLM REVISED ** BLM REVISED ** BLM REVISED ** BLM REVISED ** BLM REVISED ****

Revisions to Operator-Submitted EC Data for Sundry Notice #502289

	Operator Submitted	BLM Revised (AFMSS)
Sundry Type:	DISTURB NOI	DISTURB NOI
Lease:	NMNM118722	NMNM118722
Agreement:		
Operator:	CHEVRON USA INC 6301 DEAUVILLE BLVD MIDLAND, TX 79706 Ph: 432-687-7375	CHEVRON USA INC 1616 W. BENDER BLVD HOBBS, NM 88240 Ph: 575-263-0431
Admin Contact:	KAYLA MCCONNELL PERMITTING SPECIALIST E-Mail: gncv@chevron.com Ph: 432-687-7375	KAYLA MCCONNELL PERMITTING SPECIALIST E-Mail: kaylamccconnell@chevron.com Ph: 432-687-7375
Tech Contact:	KAYLA MCCONNELL PERMITTING SPECIALIST E-Mail: gncv@chevron.com Ph: 432-687-7375	KAYLA MCCONNELL PERMITTING SPECIALIST E-Mail: kaylamccconnell@chevron.com Ph: 432-687-7375
Location:		
State:	NM	NM
County:	LEA	LEA
Field/Pool:	WC025G08S263205N;UP WOLFC	ANTELOPE RIDGE-WOLFCAMP
Well/Facility:	SD 15 FEDERAL P419 11H Sec 15 T26S R32E 577FSL 1020FEL	SD 15 FED P419 11H Sec 15 T26S R32E SESE 577FSL 1020FEL 32.037186 N Lat, 103.657486 W Lon

R 32 E

T
26
S

Sec. 15

Bureau of Land Management

Sec. 14

CENTERLINE PROPOSED
ACCESS ROAD
30' x ±170.01'
±10.30 Rods
±0.12 Acres

Proposed
Pad 419

11H 13H
12H 14H

POINT OF
BEGINNING

POINT OF
ENDING

Existing
Chevron ROW

Existing
Maelstrom
SWD Access

Existing Pad 9

Existing Pad

Proposed
Access Road

N 77° 00' 34" W 1,662.23'

Fnd. 1 1/2" Iron Pipe
w/cap @ SE Corner
of Section 15

Sec. 23

Existing Lease Road

Sec. 22

Bureau of Land Management

NAD 27 NEW MEXICO EAST ZONE

LEGEND

- Access Centerline
- - - Existing ROW
- - - Existing Pipeline
- - - Existing Road/Pad
- - - Section Line
- Fnd. Monument

Scale: 1" = 300'

300 0 150 300

FOR THE EXCLUSIVE USE OF
CHEVRON U.S.A. INC.
I, Robert L. Lastrapes, Professional
Surveyor, do hereby state this plat is true
and correct to the best of my knowledge.

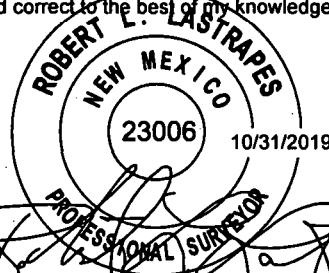

Robert L. Lastrapes
Registration No. 23006

SURFACE USE PLAT

Page 1 of 2

CHEVRON U.S.A. INC.
PROPOSED ACCESS ROAD
SALADO DRAW PAD 419
SECTION 15, T26S-R32E
LEA COUNTY, NEW MEXICO

REVISIONS

DRAWN BY:	PBH	#	BY:	DATE:	DESCRIPTION:
PROJ. MGR.:	VHV				
DATE:	10/30/2019				
FILENAME: T:\2019\2190459\DWG\SD Pad 419_Access Road_SUP.dwg					



C. H. Fenstermaker & Associates, L.L.C.
135 Regency Sq. Lafayette, LA 70508
Ph. 337-237-2200 Fax. 337-232-3299
www.fenstermaker.com

DISCLAIMER: At this time, C. H. Fenstermaker & Associates, L.L.C. has not performed nor was asked to perform any type of engineering, hydrological modeling, flood plain, or "No Rise" certification analyses, including but not limited to determining whether the project will impact flood hazards in connection with federal/FEMA, state, and/or local laws, ordinances and regulations. Accordingly, Fenstermaker makes no warranty or representation of any kind as to the foregoing issues, and persons or entities using this information shall do so at their own risk.

NOTE:

Please be advised, that while reasonable efforts are made to locate and verify pipelines and anomalies using our standard pipeline locating equipment, it is impossible to be 100 % effective. As such, we advise using caution when performing work as there is a possibility that pipelines and other hazards, such as fiber optic cables, PVC pipelines, etc. may exist undetected on site.

NOTE:

Many states maintain information centers that establish links between those who dig (excavators) and those who own and operate underground facilities (operators). It is advisable and in most states, law, for the contractor to contact the center for assistance in locating and marking underground utilities. For guidance, New Mexico One Call www.nm811.org

POINT OF BEGINNING			
X=	708,975'		
Y=	377,670'		
LAT.	32.036536° N	NAD 27	
LONG.	103.658949° W		
X=	750,162'		
Y=	377,727'		
LAT.	32.036661° N	NAD83/2011	
LONG.	103.659419° W		

POINT OF ENDING			
X=	709,145'		
Y=	377,672'		
LAT.	32.036538° N	NAD 27	
LONG.	103.658401° W		
X=	750,332'		
Y=	377,729'		
LAT.	32.036663° N	NAD83/2011	
LONG.	103.658870° W		

CENTERLINE PROPOSED ACCESS ROAD		
COURSE	BEARING	DISTANCE
1	N 89° 25' 45" E	170.01'

FOR THE EXCLUSIVE USE OF
CHEVRON U.S.A. INC.
I, Robert L. Lastrapes, Professional
Surveyor, do hereby state this plat is true
and correct to the best of my knowledge.

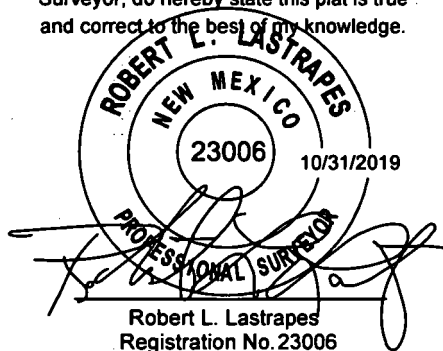

Robert L. Lastrapes
Registration No. 23006



C. H. Fenstermaker & Associates, L.L.C.
135 Regency Sq. Lafayette, LA 70508
Ph. 337-237-2200 Fax. 337-232-3299
www.fenstermaker.com

SURFACE USE PLAT

Page 2 of 2

CHEVRON U.S.A. INC.
PROPOSED ACCESS ROAD
SALADO DRAW PAD 419
SECTION 15, T26S-R32E
LEA COUNTY, NEW MEXICO

REVISIONS

DRAWN BY:	#	BY:	DATE:	DESCRIPTION:
PROJ. MGR.: VHV				
DATE: 10/30/2019				
FILENAME: T:\2019\2190459\DWG\SD Pad 419_Access Road_SUP.dwg				