

**District I**  
1625 N. French Dr., Hobbs, NM 88240  
Phone: (575) 393-6161 Fax: (575) 393-0720  
**District II**  
811 S. First St., Artesia, NM 88210  
Phone: (575) 748-1283 Fax: (575) 748-9720  
**District III**  
1000 Rio Brazos Road, Aztec, NM 87410  
Phone: (505) 334-6178 Fax: (505) 334-6170  
**District IV**  
1220 S. St. Francis Dr., Santa Fe, NM 87505  
Phone: (505) 476-3460 Fax: (505) 476-3462

State of New Mexico  
Energy, Minerals & Natural Resources Department  
**HOBBS OCD**  
OIL CONSERVATION DIVISION  
1220 South St. Francis  
Santa Fe, NM 87505  
**RECEIVED**

Form C-102  
Revised August 1, 2011  
Submit one copy to appropriate  
District Office

☒ AMENDED REPORT  
As-Drilled

WELL LOCATION AND ACREAGE DEDICATION PLAT

<sup>1</sup> API Number 30-025-44336	<sup>2</sup> Pool Code 98308	<sup>3</sup> Pool Name NEEDMORE TANK; UPPER WOLFCAMP POOL
<sup>4</sup> Property Code	<sup>5</sup> Property Name SD EA 29 32 FED COM P11	<sup>6</sup> Well Number 16H
<sup>7</sup> OGRID No. 4323	<sup>8</sup> Operator Name CHEVRON U.S.A. INC.	<sup>9</sup> Elevation 3215'

<sup>10</sup> Surface Location									
UL or lot no.	Section	Township	Range	Lot Idn	Feet from the	North/South line	Feet from the	East/West line	County
D	29	26 SOUTH	33 EAST, N.M.P.M.		195'	NORTH	903'	WEST	LEA

<sup>11</sup> Bottom Hole Location If Different From Surface									
UL or lot no.	Section	Township	Range	Lot Idn	Feet from the	North/South line	Feet from the	East/West line	County
F	32	26 SOUTH	33 EAST, N.M.P.M.		26'	SOUTH	1,585'	WEST	LEA

<sup>12</sup> Dedicated Acres 949.56	<sup>13</sup> Joint or Infill	<sup>14</sup> Consolidation Code	<sup>15</sup> Order No. R-20300
---	-------------------------------	----------------------------------	------------------------------------

No allowable will be assigned to this completion until all interests have been consolidated or a non-standard unit has been approved by the division.

SD EA 29 32 FED COM P11 NO. 16H WELL	
X= 727,458'	NAD 27
Y= 372,175'	
LAT. 32.021101° N	
LONG. 103.599426° W	
X= 768,646'	NAD83/2011
Y= 372,232'	
LAT. 32.021226° N	
LONG. 103.599893° W	
ELEVATION +3215' NAVD 88	
FINAL KICK OFF POINT	
X= 727,956'	NAD 27
Y= 372,286'	
LAT. 32.021395° N	
LONG. 103.597816° W	
X= 769,144'	NAD83/2011
Y= 372,343'	
LAT. 32.021521° N	
LONG. 103.598283° W	
FINAL FIRST TAKE POINT	
X= 727,952'	NAD 27
Y= 371,974'	
LAT. 32.020539° N	
LONG. 103.597838° W	
X= 769,139'	NAD83/2011
Y= 372,031'	
LAT. 32.020664° N	
LONG. 103.598305° W	
FINAL LAST TAKE POINT	
X= 728,199'	NAD 27
Y= 364,692'	
LAT. 32.000516° N	
LONG. 103.597199° W	
X= 769,387'	NAD83/2011
Y= 364,749'	
LAT. 32.000642° N	
LONG. 103.597665° W	
AS-DRILLED BOTTOM HOLE LOCATION	
X= 728,202'	NAD 27
Y= 364,572'	
LAT. 32.000187° N	
LONG. 103.597192° W	
X= 769,390'	NAD83/2011
Y= 364,629'	
LAT. 32.000312° N	
LONG. 103.597657° W	

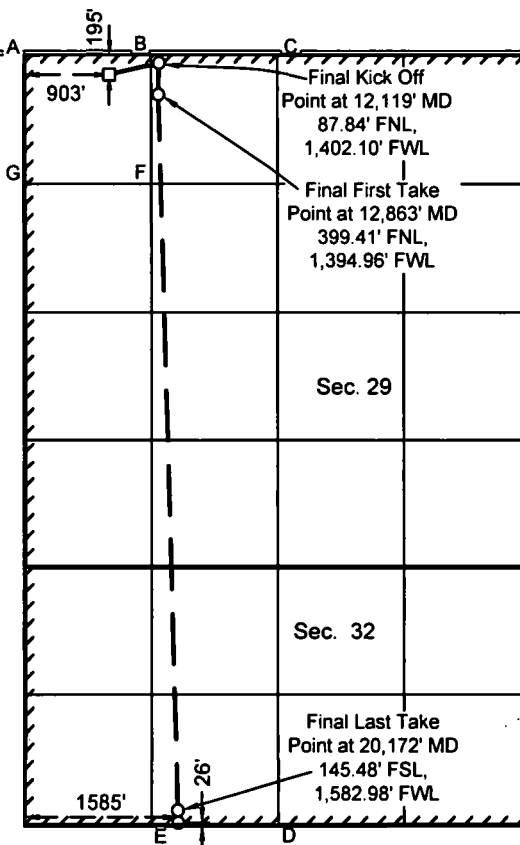

CORNER COORDINATES TABLE (NAD 27)

A - Y=372364.44	X=726553.40
B - Y=372373.27	X=727875.49
C - Y=372382.09	X=729197.59
D - Y=364553.99	X=729259.12
E - Y=364544.81	X=727938.29
F - Y=371053.27	X=727885.85
G - Y=371043.84	X=726563.92

<sup>17</sup> OPERATOR CERTIFICATION

I hereby certify that the information contained herein is true and complete to the best of my knowledge and belief, and that this organization either owns a working interest or unleased mineral interest in the land including the proposed bottom hole location or has a right to drill this well at this location pursuant to a contract with an owner of such a mineral or working interest, or to a voluntary pooling agreement or a compulsory pooling order heretofore entered by the division.

Kayla McConnell 3/10/2020  
Signature Date

Kayla McConnell  
Printed Name

gncv@chevron.com  
E-mail Address

<sup>18</sup> SURVEYOR CERTIFICATION

I hereby certify that the well location shown on this plat was plotted from field notes of actual surveys made by me or under my supervision, and that the same is true and correct to the best of my belief.

04/12/2018  
Date of Survey  
Signature and Seal of Professional Surveyor

02/19/2020

Certificate Number

Intent ☐ As Drilled ☒

API #  
30-025-44336

Operator Name:	Property Name:	Well Number
CHEVRON USA INC	SD EA 29 32 FED COM P11	16H

Kick Off Point (KOP)

UL C	Section 29	Township 26S	Range 33E	Lot	Feet 87	From N/S FNL	Feet 1402	From E/W FWL	County LEA
Latitude 32.021521					Longitude 103.598283			NAD NAD 83/86	

First Take Point (FTP)

UL C	Section 29	Township 26S	Range 33E	Lot	Feet 399	From N/S FNL	Feet 1394	From E/W FWL	County LEA
Latitude 32.020664					Longitude 103.598283			NAD NAD 83/86	

Last Take Point (LTP)

UL F	Section 32	Township 26S	Range 33E	Lot	Feet 145	From N/S FSL	Feet 1582	From E/W FWL	County LEA
Latitude 32.000312					Longitude 103.597657			NAD NAD 83/86	

Is this well the defining well for the Horizontal Spacing Unit? ☐ NO

Is this well an infill well? ☐ YES

If infill is yes please provide API if available, Operator Name and well number for Defining well for Horizontal Spacing Unit.

API #  
30-025-43268

Operator Name:	Property Name:	Well Number
CHEVRON USA INC	SD EA 29 FED COM P8	9H

KZ 06/29/2018