

RECEIVED

UNITED STATES
DEPARTMENT OF THE INTERIOR
BUREAU OF LAND MANAGEMENT

N.M. Oil Cons. Division

1625 N. French Dr.
Hobbs, NM 88240

FORM APPROVED
OMB No. 1004-0135
Expires July 31, 1996

JAN 13 2009

HOBBSCO

SUNDRY NOTICES AND REPORTS ON WELLS

Do not use this form for proposals to drill or to re-enter an
abandoned well. Use form 3160-3 (APD) for such proposals.

SUBMIT IN TRIPLICATE - Other instructions on reverse side

1. Type of Well

☒ Oil Well ☐ Gas Well ☐ Other

2. Name of Operator

Cimarex Energy Co. of Colorado

3a. Address

PO Box 140907; Irving, TX 75014-0907

3b. Phone No (include area code)

972-401-3111

4. Location of Well (Footage, Sec., T., R., M., or Survey Description)

SHL 1980 FNL & 375 FEL 7-15S-31E

BHL 1980 FNL & 375 FWL

5. Lease Serial No.

Surface - Private

SHL Private BHL NM-0153471

6. If Indian, Allottee or Tribe Name

7. If Unit or CA/Agreement, Name and/or No.

Pending

8. Well Name and No.

Coral Sea 7 Federal Com No. 3

9. API Well No.

30-005-

29093

10. Field and Pool, or Exploratory Area

Abo Wildcat

11. County or Parish, State

Chaves County, NM

12. CHECK APPROPRIATE BOX(ES) TO INDICATE NATURE OF NOTICE, REPORT, OR OTHER DATA

TYPE OF SUBMISSION

TYPE OF ACTION

☒ Notice of Intent

☐ Acidize

☐ Deepen

☐ Production (Start/Resume)

☐ Water Shut-Off

☐ Subsequent Report

☐ Alter Casing

☐ Fracture Treat

☐ Reclamation

☐ Well Integrity

☐ Final Abandonment Notice

☐ Casing Repair

☐ New Construction

☐ Recomplete

☒ Other Change Road

☒ Change Plans

☐ Plug and Abandon

☐ Temporarily Abandon

☐ Convert to Injection

☐ Plug Back

☐ Water Disposal

13. Describe Proposed or Completed Operation (clearly state all pertinent details, included estimated starting date of any proposed work and approximate duration thereof. If the proposal is to deepen directionally or recompleat horizontally, give subsurface locations and measured and true vertical depths of all pertinent markers and zones Attach the bond under which the work will be performed or provide the Bond No. on file with BLM/BIA. Required subsequent reports shall be filed within 30 days following completion of the involved operations. If the operation results in a multiple completion or recompleat in a new interval, a Form 3160-4 shall be filed once testing has been completed. Final Abandonment Notices shall be filed only after all requirements, including reclamation, have been completed, and the operator has determined that the site is ready for final inspection.)

Cimarex has changed the access road leading to the Coral Sea 7 Federal Com No. 3 as shown on the attached plats.

The new access road is on fee surface and will therefore not require a ROW.

14. I hereby certify that the foregoing is true and correct

Name (Printed/Typed)

Natalie Krueger

Signature

Title

Regulatory Analyst

Date

October 17, 2008

THIS SPACE FOR FEDERAL OR STATE OFFICE USE

Approved by

/s/ Jerry Dutchover

Acting

Assistant Field Manager

Date

10/9 JAN 2009

Conditions of Approval, if any, are attached. Approval of this notice does not warrant or certify that the applicant holds legal or equitable title to those rights in the subject lease which would entitle the applicant to conduct operations thereon.

Office

ROSWELL FIELD OFFICE

Title 18 U.S.C. Section 1001, makes it a crime for any person knowingly and willfully to make to any department or agency of the United States any false, fictitious or fraudulent statements or representations as to any matter within its jurisdiction.

(Instructions on reverse)

SECTION 7, TOWNSHIP 15 SOUTH, RANGE 31 EAST, N.M.P.M.,
CHAVES COUNTY, NEW MEXICO.

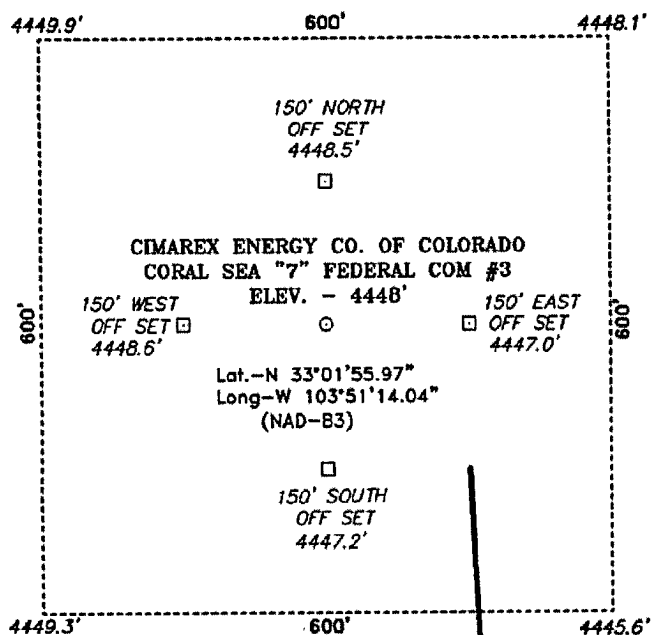

PROPOSED LEASE ROAD 1022.7'

CORAL SEA 7 FED COM #3

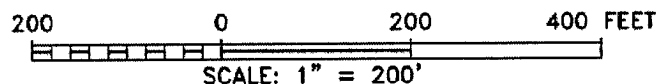

Directions to Location:

FROM MILE MARKER 30 OF HWY 31, GO NORTHEAST
0.9 MILES ON LEASE ROAD TO LEASE ROAD, ON
LEASE ROAD GO NORTHWEST 0.25 MILES TO
PROPOSED LEASE ROAD.

BASIN SURVEYS P.O. BOX 1786 - HOBBS, NEW MEXICO

W.O. Number: 19435 Drawn By: J. SMALL

Date: 04-11-2008 Disk: JMS 19435W

CIMAREX ENERGY CO. OF COLORADO

REF: CORAL SEA "7" FEDERAL COM #3 / WELL PAD TOPO

THE CORAL SEA "7" FEDERAL COM #3 LOCATED 1980'
FROM THE NORTH LINE AND 375' FROM THE EAST LINE OF
SECTION 7, TOWNSHIP 15 SOUTH, RANGE 31 EAST,
N.M.P.M., CHAVES COUNTY, NEW MEXICO.

Survey Date: 04-10-2008 Sheet 1 of 1 Sheets

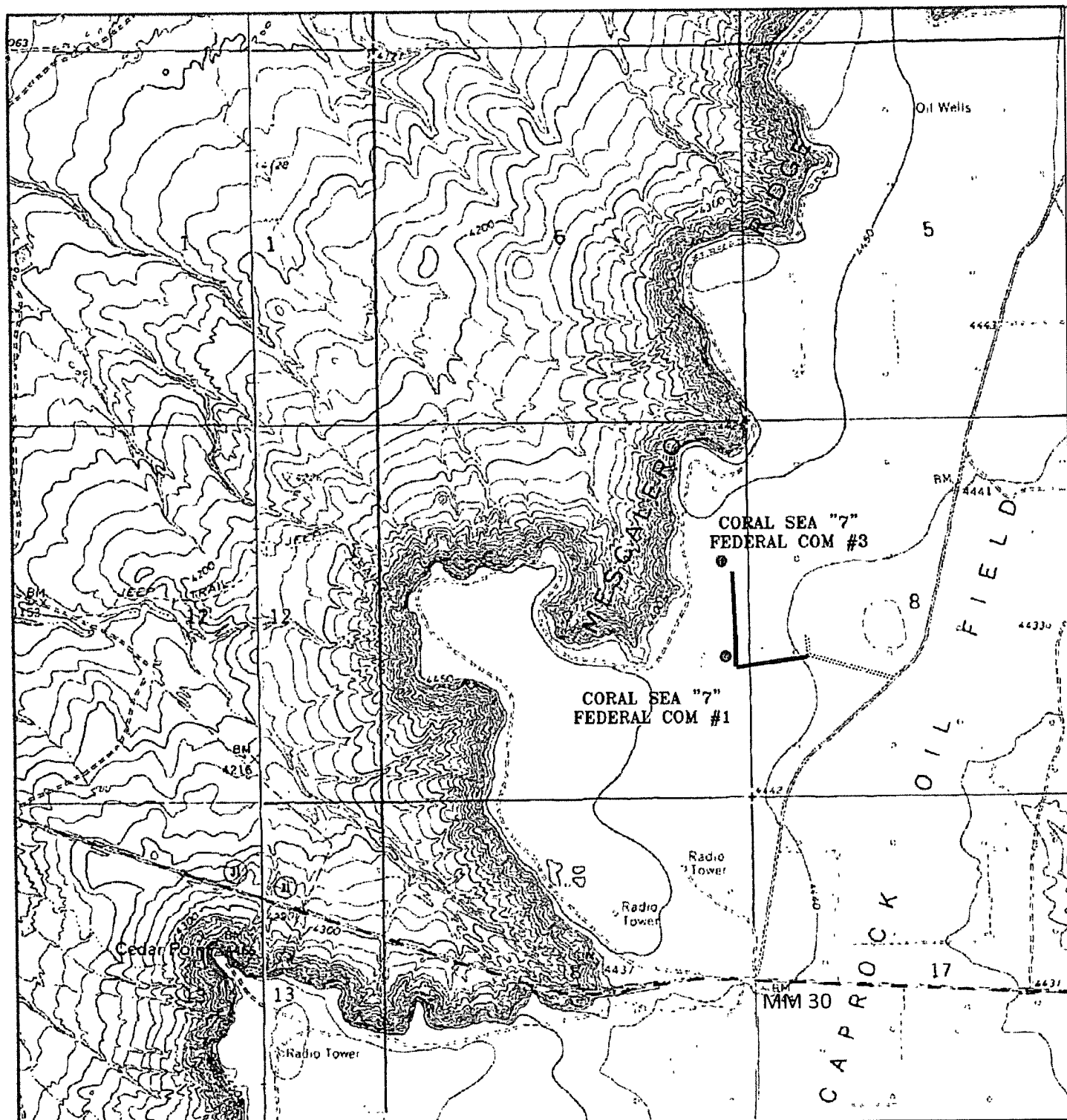

CORAL SEA "7" FEDERAL COM #3
 Located 1980' FNL and 375' FEL
 Section 7, Township 15 South, Range 31 East,
 N.M.P.M., Chaves County, New Mexico.

basin
surveys
 focused on excellence
 in the oilfield

P.O. Box 1786
 1120 N. West County Rd.
 Hobbs, New Mexico 88241
 (505) 393-7316 - Office
 (505) 392-3074 - Fax
 basinsurveys.com

W.O. Number: JMS 19435T

Survey Date: 04-10-2008

Scale: 1" = 2000'

Date: 04-11-2008

CIMAREX
ENERGY CO.
OF COLORADO

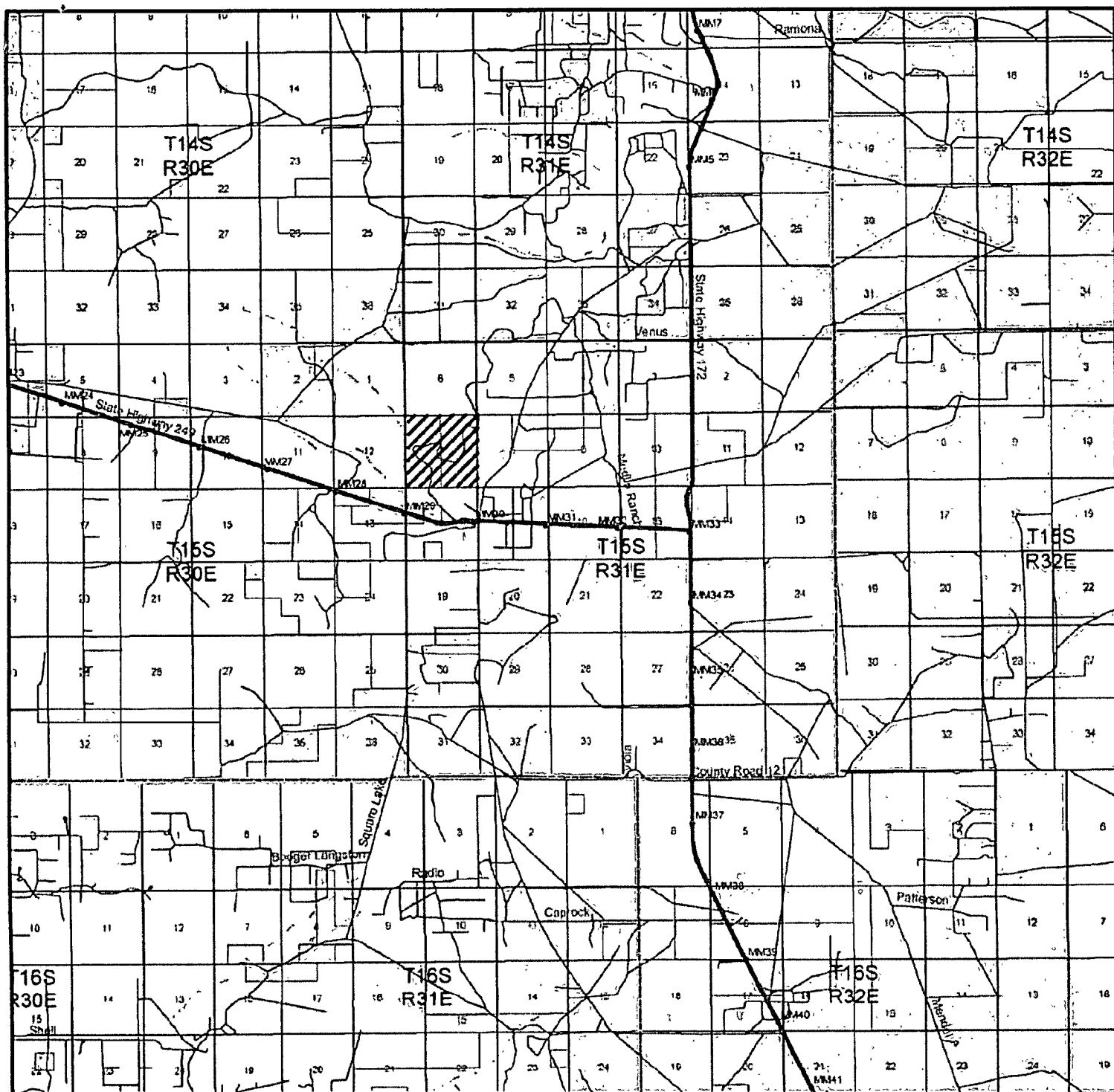

CORAL SEA "7" FEDERAL COM #3
 Located 1980' FNL and 375' FEL
 Section 7, Township 15 South, Range 31 East,
 N.M.P.M., Chaves County, New Mexico.

basin
surveys
 focused on excellence
 in the oilfield

P.O. Box 1786
 1120 N. West County Rd.
 Hobbs, New Mexico 88241
 (505) 393-7316 - Office
 (505) 392-3074 - Fax
 basinsurveys.com

W.O. Number: JMS 19435TR

Survey Date: 04-10-2008

Scale: 1" = 2 MILES

Date: 04-11-2008

CIMAREX
ENERGY CO.
OF COLORADO