

FORMATION RECORD

FROM	TO	THICKNESS IN FEET	FORMATION
0	1.51	1.51	From top of rotary drive bushing to derrick floor
1.51	17.29	15.78	From top of derrick floor to top of 13-3/8" OD casing.
17.29	32	14.71	Caliche and sand
32	233	201	Red bed, lime shells St @ 200
233	382	149	Red bed
<u>Set 13-3/8" OD casing at 372' w/350 cas.</u> Cement circ.			
382	831	449	Red bed
831	1121	290	Shale and red rock 1/4" @ 841
1121	1405	284	Red bed and shells 1/4" @ 1380
1405	1595	190	Red bed
1595	1671	76	Red rock, anhydrite and shells
1671	2060	389	Red bed, shale and sand St @ 1945
2060	2194	134	Red bed and anhydrite
2194	2248	54	Anhydrite
2248	2401	153	Anhydrite, shale, shells and salt
2401	2640	239	Anhydrite, red rock and salt
2640	2772	132	Anhydrite and salt
2772	2873	101	Anhydrite and shale
2873	2957	84	Anhydrite
2957	3422	465	Anhydrite, salt and shale 1" @ 3422, 1" @ 3382
3422	3545	123	Anhydrite and shale
3545	3647	102	Anhydrite
3647	4023	376	Anhydrite and shale
4023	4027	4	Lime
4027	4075	48	Dolomite
4075	4105	30	Lime
4105	4150	45	Dolomite and gyp
4150	4190	40	Shale, dolomite and gyp
4190	4216	26	Dolomite and gyp
4216	4252	36	Lime
4252	4261	9	Dolomite and shale
4261	4340	79	Dolomite and gyp 1-1/2" @ 4320
4340	4365	25	Lime and gyp
4365	4418	53	Dolomite and gyp
4418	4429	11	Lime and gyp 1-1/2" @ 4393
<u>Set 2-5/8" OD casing at 4429' 1500 cas 1300</u> <u>in cas</u>			
1300	4360	3060	Halliburton ran temp. survey Approx. top cement 2900
4429	4582	153	Dolomite 1" @ 4540
4582	4702	120	Lime
4702	4735	33	Dolomite
4735	4813	78	Dolomite and anhydrite
4813	4838	25	Lime and anhydrite
4838	4860	22	Dolomite
4860	4885	25	Dolomite and anhydrite
4885	4943	58	Lime
4943	5022	79	Lime and anhydrite
5022	5113	91	Lime
5113	5199	86	Black lime
5199	5295	96	Lime
5295	5381	86	Dolomite
5381	5512	131	Lime 1" @ 5500
5512	5735	223	Lime, salt and shale
5735	5764	29	Dolomite and anhydrite
5764	5790	26	Lime and salt streaks
5790	5970	180	Lime, dolomite and anhydrite 1-1/3" @ 5950
5970	6095	125	Salt breaks, dolomite and anhydrite
6095	6255	160	Dolomite and anhydrite
6255	6265	10	Dolomite
6265	6346	81	Dolomite and anhydrite
6346	6470	124	Dolomite
6470	6548	78	Dolomite and shale 1-1/2" @ 6470
6548	7014	466	Dolomite and anhydrite 1" @ 6667
7014	8041	27	Lime
7041	7188	147	Dolomite and anhydrite 3/4" @ 6975
7188	7220	32	Lime
7220	7434	214	Dolomite and anhydrite
7434	7492	58	Lime and anhydrite
7492	7608	116	Dolomite and anhydrite
7608	7657	49	Dolomite, anhydrite and shale
7657	7664	7	Red shale abo
7664	7693	29	Abn shale
7693	7728	35	Abn shale and red shale
7728	7783	35	Abn shale red
7783	7787	4	Abn shale
7787	7811	24	Red shale
7811	7828	17	Abn shale and red shale
7828	7856	28	Abn shale and gyp
7856	7860	4	Red shale
7860	7876	16	Red shale and abn
7876	7905	29	Abn shale and gyp
7905	7951	46	Red shale
7951	7957	6	Shale and gyp
7957	7966	9	Red shale
7966	7980	14	Red shale and gyp
7980	8023	43	Red shale
8023	8046	23	Abn shale red and green
8046	8065	19	Red shale abn
8065	8085	20	Red shale
8085	8122	37	Red shale and dolomite
8122	8141	19	Red and green shale
8141	8153	12	Dolomite and red and green shale
8153	8164	11	Lime and shale
8164	8166	2	Dolomite, red and green shale
8166	8203	37	Red and green shale, dolomite w/ anhydrite
8203	8207	4	Shale, lime and anhydrite
8207	8288	61	Dolomite, red and green shale 1/2" @ 8246
8288	8288	18	Dolomite and shale
8288	8388	102	Dolomite, red and green shale
8388	8414	26	Lime and shale
8414	8432	18	Dolomite and anhydrite
8432	8454	22	Dolomite, red and green shale
8454	8498	44	Dolomite and anhydrite
8498	8529	31	Dolomite, red and green shale and anhydrite
8529	8551	22	Dolomite and anhydrite

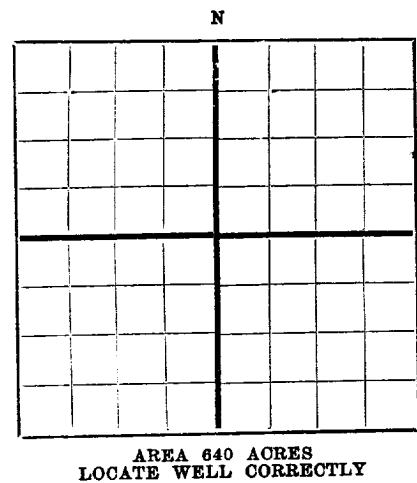

NEW MEXICO OIL CONSERVATION COMMISSION
Santa Fe, New Mexico

WELL RECORD

Mail to Oil Conservation Commission, Santa Fe, New Mexico, or its proper agent not more than twenty days after completion of well. Follow instructions in the Rules and Regulations of the Commission. Indicate questionable data by following it with (?). SUBMIT IN TRIPLICATE. FORM C-110 WILL NOT BE APPROVED UNTIL FORM C-105 IS PROPERLY FILLED OUT.

Company or Operator _____ Address _____
Well No. _____ in _____ of Sec. _____, T. _____
Lease _____
R. _____, N. M. P. M. _____ Field, _____ County.
Well is _____ feet south of the North line and _____ feet west of the East line of _____
If State land the oil and gas lease is No. _____ Assignment No. _____
If patented land the owner is _____, Address _____
If Government land the permittee is _____, Address _____
The Lessee is _____, Address _____
Drilling commenced _____ 19_____. Drilling was completed _____ 19_____.
Name of drilling contractor _____, Address _____
Elevation above sea level at top of casing _____ feet.
The information given is to be kept confidential until _____ 19_____.

OIL SANDS OR ZONES

No. 1, from _____ to _____ No. 4, from _____ to _____
No. 2, from _____ to _____ No. 5, from _____ to _____
No. 3, from _____ to _____ No. 6, from _____ to _____

IMPORTANT WATER SANDS

Include data on rate of water inflow and elevation to which water rose in hole.
No. 1, from _____ to _____ feet.
No. 2, from _____ to _____ feet.
No. 3, from _____ to _____ feet.
No. 4, from _____ to _____ feet.

CASING RECORD

SIZE	WEIGHT PER FOOT	THREADS PER INCH	MAKE	AMOUNT	KIND OF SHOE	CUT & FILLED FROM	PERFORATED		PURPOSE
							FROM	TO	

MUDDING AND CEMENTING RECORD

SIZE OF HOLE	SIZE OF CASING	WHERE SET	NO. SACKS OF CEMENT	METHODS USED	MUD GRAVITY	AMOUNT OF MUD USED

PLUGS AND ADAPTERS

Heaving plug—Material _____ Length _____ Depth Set _____
Adapters — Material _____ Size _____

RECORD OF SHOOTING OR CHEMICAL TREATMENT

SIZE	SHELL USED	EXPLOSIVE OR CHEMICAL USED	QUANTITY	DATE	DEPTH SHOT OR TREATED	DEPTH CLEANED OUT

Results of shooting or chemical treatment _____

RECORD OF DRILL-STEM AND SPECIAL TESTS

If drill-stem or other special tests or deviation surveys were made, submit report on separate sheet and attach hereto.

TOOLS USED

Rotary tools were used from _____ feet to _____ feet, and from _____ feet to _____ feet.
Cable tools were used from _____ feet to _____ feet, and from _____ feet to _____ feet.

PRODUCTION

Put to producing _____, 19_____.
The production of the first 24 hours was _____ barrels of fluid of which _____% was oil; _____% emulsion; _____% water; and _____% sediment. Gravity, Be _____
If gas well, cu. ft. per 24 hours _____ Gallons gasoline per 1,000 cu. ft. of gas _____
Rock pressure, lbs. per sq. in. _____

EMPLOYEES

_____, Driller _____, Driller
_____, Driller _____, Driller

FORMATION RECORD ON OTHER SIDE

I hereby swear or affirm that the information given herewith is a complete and correct record of the well and all work done on it so far as can be determined from available records.

Subscribed and sworn to before me this _____
day of _____, 19_____.

Notary Public
My Commission expires _____
Place _____ Date _____
Name _____
Position _____
Representing _____
Company or Operator _____
Address _____