

NO. OF COPIES RECEIVED	
DISTRIBUTION	
SANTA FE	
FILE	
U.S.G.S.	
LAND OFFICE	
OPERATOR	

NEW MEXICO OIL CONSERVATION COMMISSION

Form C-101  
Revised 11-65

5A. Indicate Type of Lease  
STATE  FEE

5. State Oil & Gas Lease No.

APPLICATION FOR PERMIT TO DRILL, DEEPEN, OR PLUG BACK

1a. Type of Work DRILL <input checked="" type="checkbox"/> DEEPEN <input type="checkbox"/> PLUG BACK <input type="checkbox"/>		7. Unit Agreement Name	
b. Type of Well OIL WELL <input checked="" type="checkbox"/> GAS WELL <input type="checkbox"/> OTHER <input type="checkbox"/>		8. Farm or Lease Name Roil	
2. Name of Operator John L. Cox		9. Well No. 1	
3. Address of Operator 408 West Wall, Midland, Texas 79701		10. Field and Pool, or Wildcat W. Sawyer (San Andres)	
4. Location of Well UNIT LETTER <u>H</u> LOCATED <u>2121</u> FEET FROM THE <u>North</u> LINE AND <u>519</u> FEET FROM THE <u>East</u> LINE OF SEC. <u>21</u> TWP. <u>9S</u> RGE. <u>37E</u> NMPM		12. County Lea	
19. Proposed Depth 5100'		19A. Formation San Andres	20. Rotary or C.T. Rotary
21. Elevations (Show whether DF, RT, etc.) 3975.9 GR	21A. Kind & Status Plug. Bond Blanket-Approved	21B. Drilling Contractor Sitton-Norton	22. Approx. Date Work will start 9-28-73

23.

PROPOSED CASING AND CEMENT PROGRAM

SIZE OF HOLE	SIZE OF CASING	WEIGHT PER FOOT	SETTING DEPTH	SACKS OF CEMENT	EST. TOP
12 1/4"	8 5/8"	20#	400'	375 sx.	Cem. Circl.
7 7/8"	4 1/2"	9.5#	5100'	350 sx.	4,000'

8 5/8" to be cemented with 375 sacks Class H cement with 2% Calcium Chloride. This is ample cement to circulate to surface.

4 1/2" casing to be cemented with 350 sacks of Class C cement, 50-50 pozmix with 2% gel, 8# salt/sack and 0.75% CFR2 preceded by 500 gallons mud flush.

Mud Program: Water, Gel, Lime 0 - 400'  
Native Redbed mud 400' - 4,700'  
Low-solids salt gel-starch mud 4,700' - TD

APPROVAL VALID  
FOR 90 DAYS UNLESS  
DRILLING COMMENCED,

EXPIRES 12-17-73

IN ABOVE SPACE DESCRIBE PROPOSED PROGRAM: IF PROPOSAL IS TO DEEPEN OR PLUG BACK, GIVE DATA ON PRESENT PRODUCTIVE ZONE AND PROPOSED NEW PRODUCTIVE ZONE. GIVE BLOWOUT PREVENTER PROGRAM, IF ANY.

I hereby certify that the information above is true and complete to the best of my knowledge and belief.

Signed Marta Hernandez Title Production Clerk Date September 14, 1973

(This space for State Use)

APPROVED BY [Signature] TITLE SUPERVISOR DISTRICT I DATE [Blank]

CONDITIONS OF APPROVAL, IF ANY:

**NEW MEXICO OIL CONSERVATION COMMISSION  
WELL LOCATION AND ACREAGE DEDICATION PLAT**

Form C-102  
Supersedes C-128  
Effective 1-1-65

All distances must be from the outer boundaries of the Section.

Operator <b>JOHN L. COX</b>		Lease <b>Roll</b>			Well No. <b>1</b>
Unit Letter <b>H</b>	Section <b>21</b>	Township <b>9 South</b>	Range <b>37 East</b>	County <b>Lea</b>	
Actual Footage Location of Well: <b>2121</b> feet from the <b>north</b> line and <b>519</b> feet from the <b>east</b> line					
Ground Level Elev., <b>3975.9</b>	Producing Formation <b>San Andres</b>		Pool <b>West Sawyer (San Andres)</b>		Dedicated Acreage: <b>80</b> Acres

1. Outline the acreage dedicated to the subject well by colored pencil or hachure marks on the plat below.
2. If more than one lease is dedicated to the well, outline each and identify the ownership thereof (both as to working interest and royalty).
3. If more than one lease of different ownership is dedicated to the well, have the interests of all owners been consolidated by communitization, unitization, force-pooling, etc.?

Yes     No    If answer is "yes," type of consolidation \_\_\_\_\_

If answer is "no," list the owners and tract descriptions which have actually been consolidated. (Use reverse side of this form if necessary.) \_\_\_\_\_

No allowable will be assigned to the well until all interests have been consolidated (by communitization, unitization, forced-pooling, or otherwise) or until a non-standard unit, eliminating such interests, has been approved by the Commission.

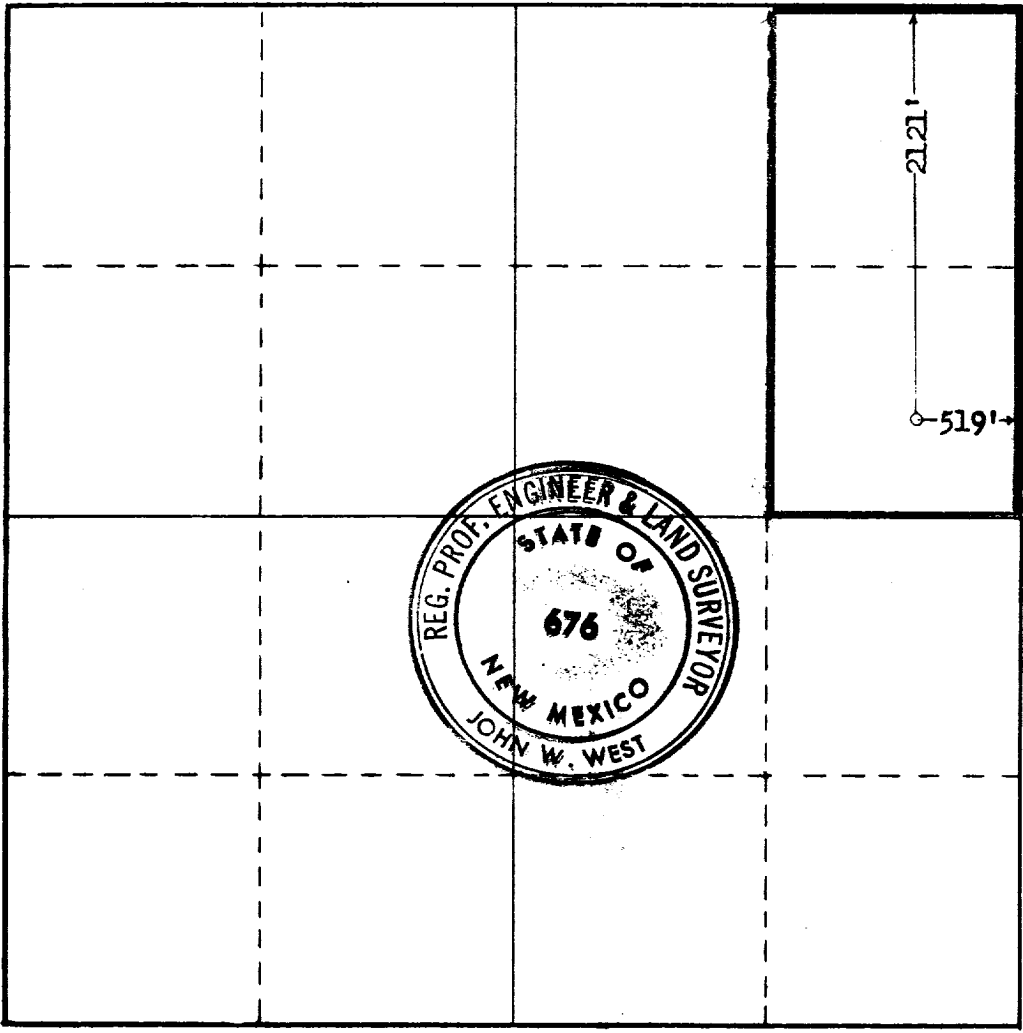

**CERTIFICATION**

I hereby certify that the information contained herein is true and complete to the best of my knowledge and belief.

*Martha Wittenbach*  
Name

**Martha Wittenbach**  
Position

**Production Clerk**  
Company

**JOHN L. COX**  
Date

**September 14, 1973**

I hereby certify that the well location shown on this plat was plotted from field notes of actual surveys made by me or under my supervision, and that the same is true and correct to the best of my knowledge and belief.

Date Surveyed:  
**Sept. 8, 1973**

Registered Professional Engineer  
and/or Land Surveyor

*John W. West*

Certificate No. **676**

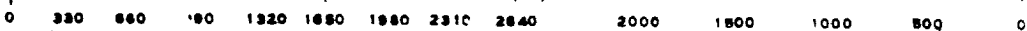

171