

Submit to Appropriate
District Office
State Lease -- 6 copies
Fee Lease -- 5 copies

State of New Mexico
Energy, Minerals and Natural Resources Department

Form C-101
Revised 1-1-89

OIL CONSERVATION DIVISION
P.O. Box 2088
Santa Fe, New Mexico 87504-2088

DISTRICT I
P.O. Box 1980, Hobbs, NM 88240

DISTRICT II
P.O. Drawer DD, Artesia, NM 88210

DISTRICT III
1000 Rio Brazos Rd., Aztec, NM 87410

API NO. (assigned by OCD on New Wells)
30-025-31060

5. Indicate Type of Lease
STATE FEE

6. State Oil & Gas Lease No.
L-332

APPLICATION FOR PERMIT TO DRILL, DEEPEN, OR PLUG BACK

1a. Type of Work:
DRILL RE-ENTER DEEPEN PLUG BACK
b. Type of Well:
OIL WELL GAS WELL OTHER
SINGLE ZONE MULTIPLE ZONE

7. Lease Name or Unit Agreement Name
Sunray -A-, 6822 Ltd

2. Name of Operator
BTA Oil Producers

8. Well No.
2

3. Address of Operator
104 S. Pecos, Midland, TX 79701

9. Pool name or Wildcat
Lane (San Andres)

4. Well Location
Unit Letter K : 1980 Feet From The South Line and 1980 Feet From The West Line
Section 36 Township 9S Range 33E NMPM Lea County

10. Proposed Depth 5000
11. Formation San Andres
12. Rotary or C.T. Rotary

13. Elevations (Show whether DF, RT, GR, etc.) 4272' GR
14. Kind & Status Plug. Bond Blanket
15. Drilling Contractor Norton Drlg Co
16. Approx. Date Work will start 11-19-90

17. **PROPOSED CASING AND CEMENT PROGRAM**

SIZE OF HOLE	SIZE OF CASING	WEIGHT PER FOOT	SETTING DEPTH	SACKS OF CEMENT	EST. TOP
12-1/4	8-5/8	24	500	400 sx	Surface
7-7/8	5-1/2	15.5	5000	1000 sx	Surface

BOP Sketch attached - 3000 psi

There are no producing wells in this quarter-quarter section.

IN ABOVE SPACE DESCRIBE PROPOSED PROGRAM: IF PROPOSAL IS TO DEEPEN OR PLUG BACK, GIVE DATA ON PRESENT PRODUCTIVE ZONE AND PROPOSED NEW PRODUCTIVE ZONE. GIVE BLOWOUT PREVENTER PROGRAM, IF ANY.

I hereby certify that the information above is true and complete to the best of my knowledge and belief.

SIGNATURE Dorothy Houghton TITLE Regulatory Administrator DATE 11-9-90
TYPE OR PRINT NAME Dorothy Houghton TELEPHONE NO. 915-682-3753

(This space for State Use)

ORIGINAL COPY SENT BY JERRY SEXTON
APPROVED BY _____

NOV 13 1990

APPROVED BY _____ TITLE _____ DATE _____

CONDITIONS OF APPROVAL, IF ANY:

Permit Expires 6 Months from Approval Date Unless Drilling Underway.

B T A O I L P R O D U C E R S

Driller's Zero 1 ft Above Rotary Table

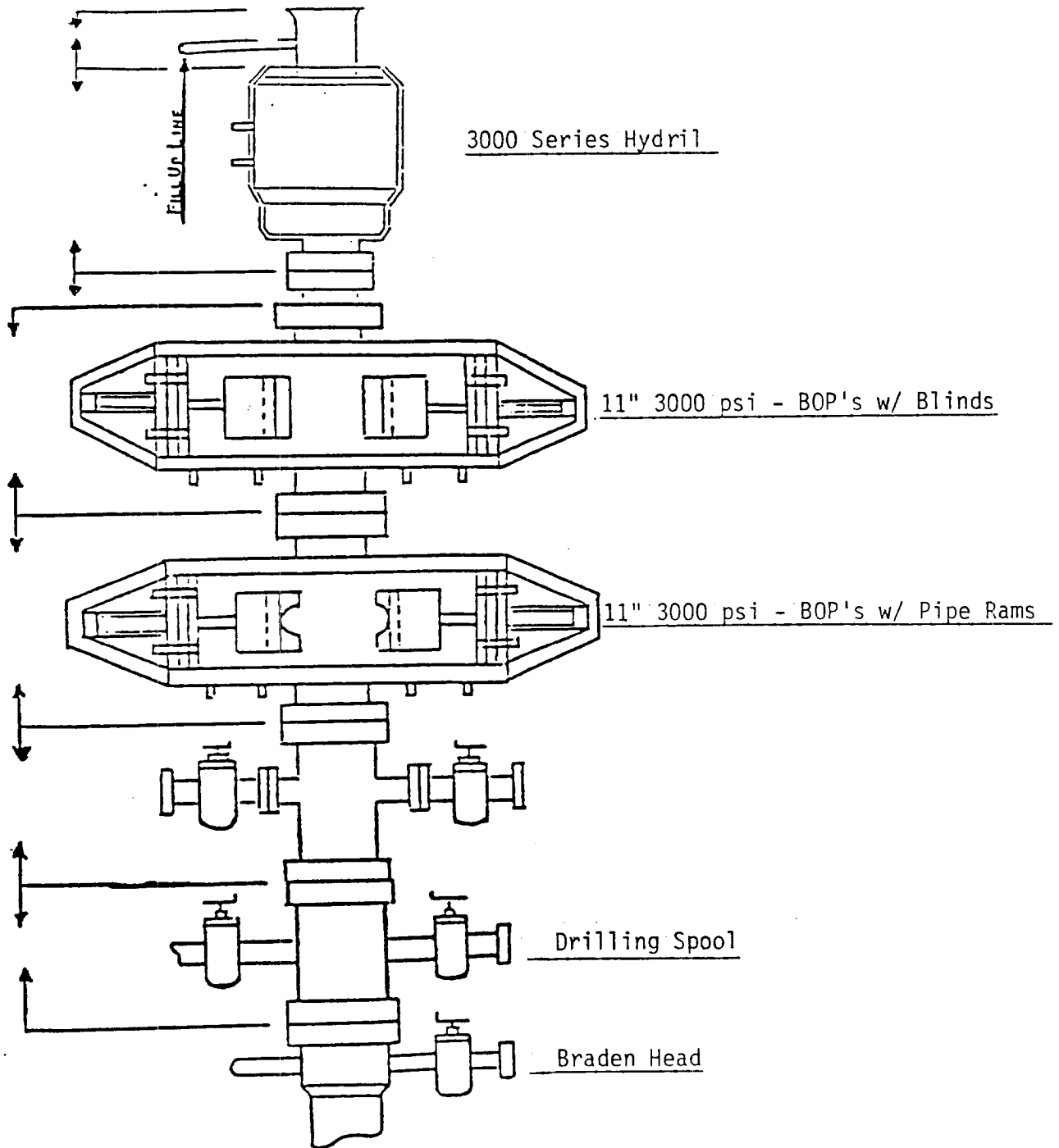

Sunray -A-, 6822 Ltd.
Well #2
Sec. 36, T9S, R33E
Lea Co., N. M.

Submit to Appropriate
District Office
State Lease - 4 copies
Fee Lease - 3 copies

State of New Mexico
Energy, Minerals and Natural Resources Department

Form C-102
Revised 1-1-89

OIL CONSERVATION DIVISION

P.O. Box 2088
Santa Fe, New Mexico 87504-2088

DISTRICT I
P.O. Box 1980, Hobbs, NM 88240

DISTRICT II
P.O. Drawer DD, Artesia, NM 88210

DISTRICT III
1000 Rio Brazos Rd., Aztec, NM 87410

WELL LOCATION AND ACREAGE DEDICATION PLAT

All Distances must be from the outer boundaries of the section

Operator BTA OIL PRODUCERS			Lease 6822 LTD SUNRAY "A"		Well No. 2
Unit Letter K	Section 36	Township 9-SOUTH	Range 33-EAST	County NMPM LEA	

Actual Footage Location of Well:					
1980 feet from the		SOUTH line and		1980 feet from the WEST line	
Ground level Elev. 4272'	Producing Formation San Andres	Pool Lane	Dedicated Acreage: 40 Acres		

- Outline the acreage dedicated to the subject well by colored pencil or hachure marks on the plat below.
- If more than one lease is dedicated to the well, outline each and identify the ownership thereof (both as to working interest and royalty).
- If more than one lease of different ownership is dedicated to the well, have the interest of all owners been consolidated by communitization, unitization, force-pooling, etc.?

Yes No If answer is "yes" type of consolidation _____

If answer is "no" list the owners and tract descriptions which have actually been consolidated. (Use reverse side of this form if necessary.) _____

No allowable will be assigned to the well until all interests have been consolidated (by communitization, unitization, forced-pooling, or otherwise) or until a non-standard unit, eliminating such interest, has been approved by the Division.

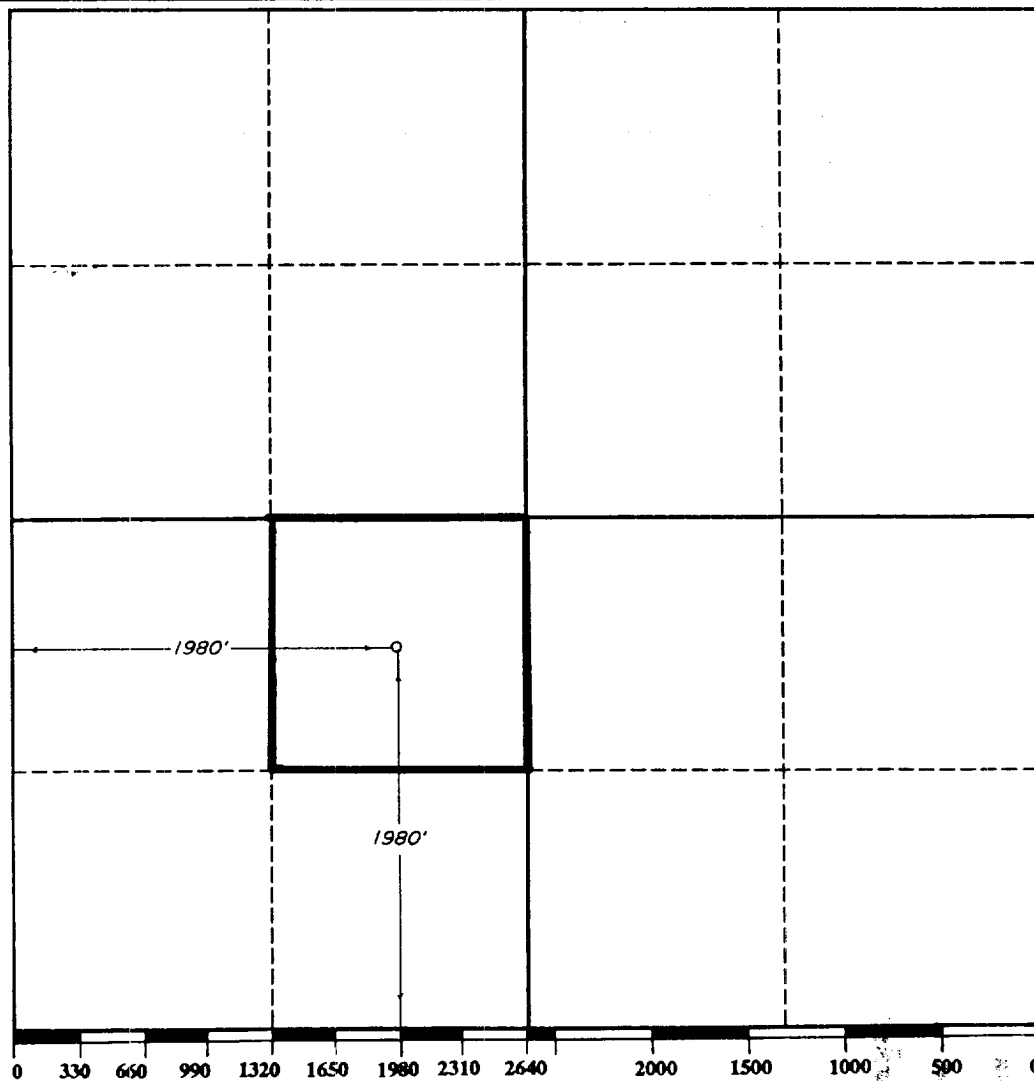

OPERATOR CERTIFICATION

I hereby certify that the information contained herein is true and complete to the best of my knowledge and belief.

Signature: *Dorothy Houghton*

Printed Name: **Dorothy Houghton**

Position: **Regulatory Administrator**

Company: **BTA Oil Producers**

Date: **11-9-90**

SURVEYOR CERTIFICATION

I hereby certify that the well location shown on this plat was plotted from field notes of actual surveys made by me or under my supervision, and that the same is true and correct to the best of my knowledge and belief.

Date Surveyed: **NOVEMBER 8, 1990**

Signature & Seal of Professional Surveyor: *V. Lynn Bezner*

Certificate No.: **V. LYNN BEZNER, R.L.S. # 7920**

125630