

UNITED STATES
DEPARTMENT OF THE INTERIOR
BUREAU OF LAND MANAGEMENT

SUBMIT IN REVERSE SIDE ON

20-025-31829
Form approved.
Budget Bureau No. 1004-0136
Expires: December 31, 1991

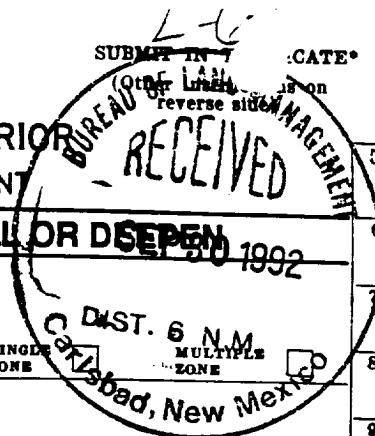

APPLICATION FOR PERMIT TO DRILL OR DEEPEN

1a. TYPE OF WORK
 DRILL DEEPEN

b. TYPE OF WELL
 OIL WELL GAS WELL OTHER

2. NAME OF OPERATOR
 Marshall & Winston, Inc.

3. ADDRESS AND TELEPHONE NO.
 6 Desta Drive, Suite 3100, P O Box 50880, Midland, TX 79702
 (915)684-6373

4. LOCATION OF WELL (Report location clearly and in accordance with any State requirements.)
 At surface: 1710' FSL & 750' FEL, Section 3, T9S-R33E
 At proposed prod. zone: Same

14. DISTANCE IN MILES AND DIRECTION FROM NEAREST TOWN OR POST OFFICE*
 12 miles West and 3 miles North of Crossroads, New Mexico

10. DISTANCE FROM PROPOSED LOCATION TO NEAREST PROPERTY OR LEASE LINE, FT. (Also to nearest drig. unit line, if any)
 750'

16. NO. OF ACRES IN LEASE
 320+

17. NO. OF ACRES ASSIGNED TO THIS WELL
 40

18. DISTANCE FROM PROPOSED LOCATION TO NEAREST WELL, DRILLING, COMPLETED, OR APPLIED FOR, ON THIS LEASE, FT.
 N/A

19. PROPOSED DEPTH
 8900'

20. ROTARY OR CABLE TOOLS
 Rotary

21. ELEVATIONS (Show whether DF, RT, GR, etc.)
 GL 4353.5

22. APPROX. DATE WORK WILL START*
 10/31/92

PROPOSED CASING AND CEMENTING PROGRAM

SIZE OF HOLE	GRADE, SIZE OF CASING	WEIGHT PER FOOT	SETTING DEPTH	QUANTITY OF CEMENT
17 1/2"	H-40 13 3/8 used	54.5#	410'	460 sx circulate to surface
12 1/4"	J-55 8 5/8 used	32# ST&C	4000'	1820 sx circulate to surface
7 7/8"	N-80 J-55 5 1/2 used	17 & 20# LT&C	8900'	770 sx tieback to 3900' 25% excess (100' above 8 5/8" csg shoe)

- Set 40'± of 20" conductor pipe and cement with Redimix to surface.
- Drill 17 1/2" hole to 410'. Run 13 3/8" H-40 54.5# csg and cement with 1620 sx Halliburton light w/16# salt/sx, tail in with 200 sx Premium Plus 2% CaCl, circulate to surface.
- Drill 12 1/4" hole to 4000'. Run 8 5/8" J-55 32# ST&C csg and cement with 1620 sx Halliburton light w/16# salt/sx, tail in with 200 sx Premium Plus 2% CaCl, circulate to surface.
- Drill 7 7/8" hole to 8900'. Run 5 1/2" N-80, J-55 17 & 20# LT&C csg and cement with 560 sx of Halliburton light 5# salt/sx, 1/4# Flocele, tail in with 210 sx of 50/50 Premium POz, .4% Halad 322, 3# KCL/sx, tieback to 3900'.

IN ABOVE SPACE DESCRIBE PROPOSED PROGRAM: If proposal is to deepen, give data on present productive zone and proposed new productive zone. If proposal is to drill or deepen directionally, give pertinent data on subsurface locations and measured and true vertical depths. Give blowout preventer program, if any.

24. SIGNED [Signature] TITLE Agent APPROVAL SUBJECT TO GENERAL REQUIREMENTS AND SPECIAL STIPULATIONS ATTACHED DATE 09/28/92

(This space for Federal or State office use)

PERMIT NO. _____ APPROVAL DATE _____

Application approval does not warrant or certify that the applicant holds legal or equitable title to those rights in the subject lease which would entitle the applicant to conduct operations thereon.

CONDITIONS OF APPROVAL, IF ANY:

APPROVED BY [Signature] TITLE _____ DATE 10/19/92

*See Instructions On Reverse Side

OIL CONSERVATION DIVISION

P.O. Box 2088

Santa Fe, New Mexico 87504-2088

DISTRICT I

P.O. Box 1980, Hobbs, NM 88240

DISTRICT II

P.O. Drawer DD, Artesia, NM 88210

DISTRICT III

1000 Rio Brazos Rd., Artec, NM 87410

WELL LOCATION AND ACREAGE DEDICATION PLAT

All Distances must be from the outer boundaries of the section

Operator MARSHALL & WINSTON INC.		Lease WILDLIFE FEDERAL		Well No. 1
Unit Letter 1	Section 3	Township 9 SOUTH	Range 33 EAST NMPM	County LEA
Actual Footage Location of Well: 1710 feet from the SOUTH line and 750 feet from the EAST line				
Ground Level Elev. 4353.5'	Producing Formation ABO	Pool FLYING Undesignated ABO	Dedicated Acreage: 40 Acres	

- Outline the acreage dedicated to the subject well by colored pencil or hachure marks on the plat below.
- If more than one lease is dedicated to the well, outline each and identify the ownership thereof (both as to working interest and royalty).
- If more than one lease of different ownership is dedicated to the well, have the interest of all owners been consolidated by communitization, unitization, force-pooling, etc.?

Yes No If answer is "yes" type of consolidation _____

If answer is "no" list of owners and tract descriptions which have actually been consolidated. (Use reverse side of this form necessary. _____)

No allowable will be assigned to the well unit all interests have been consolidated (by communitization, unitization, forced-pooling, otherwise) or until a non-standard unit, eliminating such interest, has been approved by the Division.

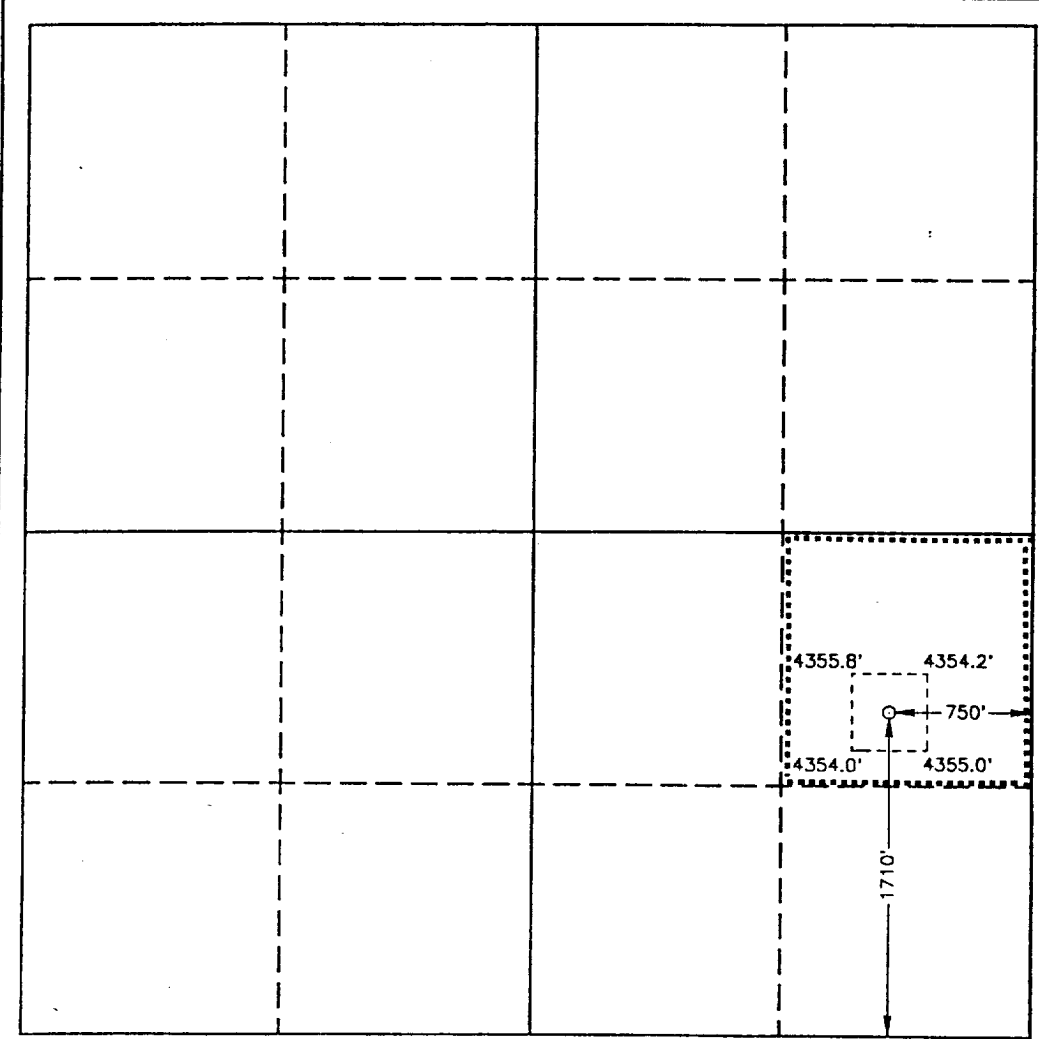

OPERATOR CERTIFICATION

I hereby certify that the information contained herein is true and complete to the best of my knowledge and belief.

Signature: *Joe T. Janica*
 Printed Name: **JOE T. JANICA**
 Position: **AGENT**
 Company: **MARSHALL & WINSTON INC.**
 Date: **09/14/92**

SURVEYOR CERTIFICATION

I hereby certify that the well location shown on this plat was plotted from field notes of actual surveys made by me or under my supervision, and that the same is true and correct to the best of my knowledge and belief.

Date Surveyed: **SEPTEMBER 1, 1992**
 Signature & Seal of Professional Surveyor: *Ronald J. Edson*
 Certificate No. **JOHN W. WEST 676**
RONALD J. EDSON 3239
GARY S. JONES 7877
92-111-1283

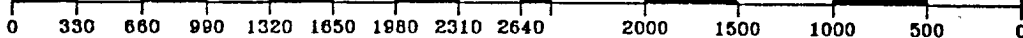

APPLICATION TO DRILL

Marshall & Winston, Inc.
Wildlife Federal #1-X
Section 3, T9S-R33E
Lea County, New Mexico

In response to questions asked under Section II B of Bulletin NTL-6 the following information is provided for your consideration:

1. Location: 750' FEL, 1710' FSL Section 3, T9S-R33E, Lea County, New Mexico
2. Elevation Above Sea Level: 4353.5' GL
3. Geologic Name of Surface Formation: Triassic Aeolian deposit
4. Drilling Tools and Associated Equipment: Conventional rotary drilling rig using mud for the circulation medium
5. Proposed Drilling Depth: 8900'
6. Estimated Geological Marker Tops:

Rustler	1987'	Tubb	6728'
Yates	2580'	Abo	7600'
Penrose	3376'	Wolfcamp	8765'
Grayburg	3565'	Penn Shale	11300'
San Andres	3789'		
Glorietta	5225'		
7. Mineral Bearing Formation:

Ogollala	80-200'	Fresh Water
Santa Rosa	1680'	Brakish Water
Yates	2580'	Gas (Nitrogen)
San Andres	3790'	Oil
Glorietta	5225'	Salt Water
Abo	8500'	Oil
8. Casing Program:
 - (A) Surface casing - 13 3/8" 54.5# H-40 used, drifted and tested to API spec
 - (B) Intermediate casing - 8 5/8" 32# ST&C J-55 used, drifted and tested to API spec
 - (C) Production casing - 5 1/2" 17# & 20# LT&C N-80 J-55 used, drifted and tested to API spec
9. Setting depth of casing and cement for same:
 - (A) 13 3/8" 54.5# casing set @ 410' cement with 460 sx premium plus cement with 2% CaCl, circulate to surface
 - (B) 8 5/8" 32# casing set @ 4000' cement with 1620 sx of Halliburton Light with 16# salt/sx + 1/4# flocele/sx, tail in with 200 sx premium plus w/2% CaCl, circulate to surface
 - (C) 5 1/2" 17# casing set @ 8900' cement with 560 sx of Halliburton Light 1/4# flocele/sx + 6# salt/sx + .4% Halad-9 + 210 sx 50/50 premium/POz 2% gel + .4% Halad-9 + 5% KCl

BLOWOUT PREVENTOR ARRANGEMENT

- 11" SHAFFER TYPE LWS, 5000 psi WP
- 11" CAMERON SPHERICAL, 5000 psi WP
- 120 GALLON, 5 STATION KOOMEY ACCUMULATOR
- 5000 psi WP CHOKE MANIFOLD

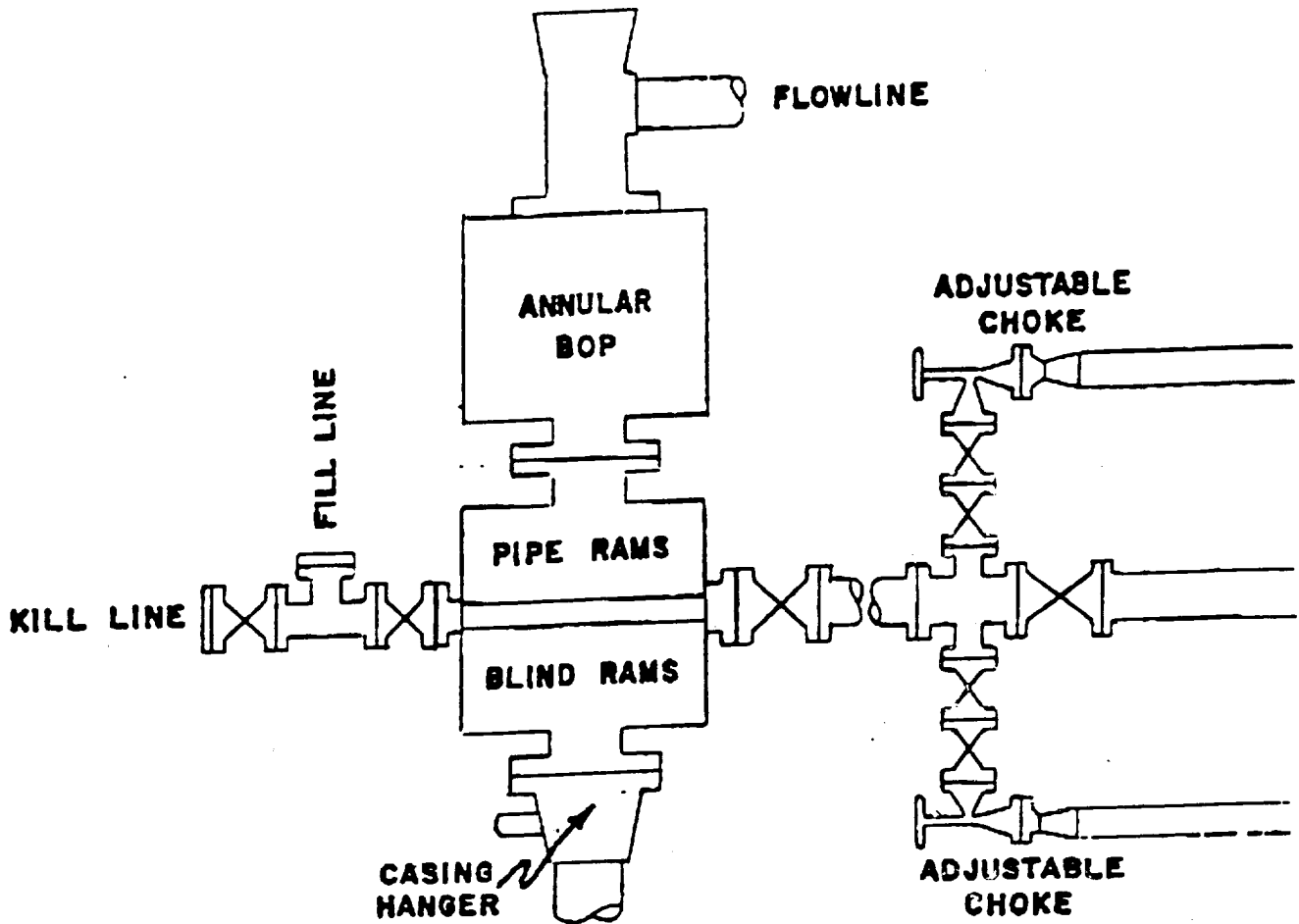

EXHIBIT E
Marshall & Winston Inc.
BOP Sketch of type
To be used on Wildlife Fed. 1-X
750' FEL & 1710' FSL Sec. 3
700 0225