

NEW MEXICO OIL CONSERVATION COMMISSION

Well Location and Acreage Dedication Plat

Section A.

Date July 12, 1957

Operator MAGNOLIA PETROLEUM COMPANY Lease 100-100-100-47
 Well No. 5274 Unit Letter 1 Section 12 Township 15 Range 33E NMPM
 Located 560 Feet From North Line, 560 Feet From West Line
 County Reynolds G. L. Elevation _____ Dedicated Acreage 40 Acres
 Name of Producing Formation Devonian Pool Wildcat - Undesignated

1. Is the Operator the only owner* in the dedicated acreage outlined on the plat below?
Yes _____ No _____.
2. If the answer to question one is "no," have the interests of all the owners been consolidated by communitization agreement or otherwise? Yes _____ No _____. If answer is "yes," Type of Consolidation _____
3. If the answer to question two is "no," list all the owners and their respective interests below:

Owner

Land Description

<u>Owner</u>	<u>Land Description</u>

Section B.

(call) 5271.4

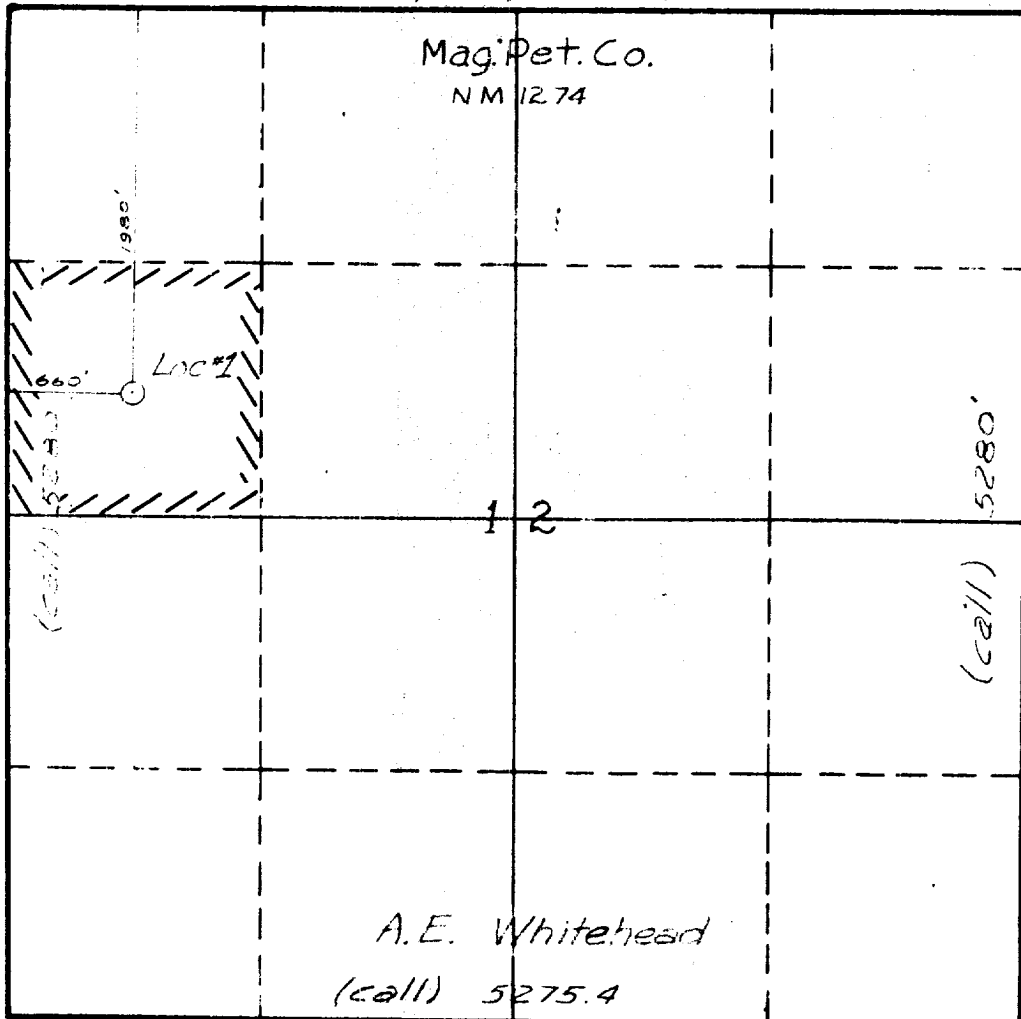

This is to certify that the information in Section A above is true and complete to the best of my knowledge and belief.

Magnolia Petroleum Company

(Operator)

M. Dougherty
(Representative)

Box 2496, Hobbs, New Mexico

Address

This is to certify that the well location shown on the plat in Section B was plotted from field notes of actual surveys made by me or under my supervision and that the same is true and correct to the best of my knowledge and belief.

Date Surveyed July 12, 1957

Carl E. Jensen
Registered Professional
Engineer and/or Land Surveyor.

Certificate No. 2490



ELF