

NO. OF COPIES RECEIVED	
DISTRIBUTION	
SANTA FE	
FILE	
U.S.G.S.	
LAND OFFICE	
OPERATOR	

NEW MEXICO OIL CONSERVATION COMMISSION

Form C-103
Supersedes Old
C-102 and C-103
Effective 1-1-65

5a. Indicate Type of Lease
State Fee

5. State Oil & Gas Lease No.

SUNDRY NOTICES AND REPORTS ON WELLS

(DO NOT USE THIS FORM FOR PROPOSALS TO DRILL OR TO DEEPEN OR PLUG BACK TO A DIFFERENT RESERVOIR. USE "APPLICATION FOR PERMIT -" (FORM C-101) FOR SUCH PROPOSALS.)

1. OIL WELL GAS WELL OTHER- Wildcat

2. Name of Operator
Max M. Wilson

3. Address of Operator
P. O. Box 1317, Roswell, New Mexico

4. Location of Well
UNIT LETTER H 660 FEET FROM THE East LINE AND 1980 FEET FROM
THE North LINE, SECTION 22 TOWNSHIP 7 South RANGE 34 East NMPM.

7. Unit Agreement Name

8. Farm or Lease Name
Carol

9. Well No.
2

10. Field and Pool, or Wildcat

15. Elevation (Show whether DF, RT, GR, etc.)

12. County
Roosevelt

Check Appropriate Box To Indicate Nature of Notice, Report or Other Data

NOTICE OF INTENTION TO:

PERFORM REMEDIAL WORK

TEMPORARILY ABANDON

PULL OR ALTER CASING

OTHER _____

PLUG AND ABANDON

CHANGE PLANS

SUBSEQUENT REPORT OF:

REMEDIAL WORK

COMMENCE DRILLING OPNS.

CASING TEST AND CEMENT JOB

OTHER _____

ALTERING CASING

PLUG AND ABANDONMENT

17. Describe Proposed or Completed Operations (Clearly state all pertinent details, and give pertinent dates, including estimated date of starting any proposed work) SEE RULE 1703.

Drilled to 80 feet
Plugged and abandoned January 3, 1970
15 sx at top with regulation marker

18. I hereby certify that the information above is true and complete to the best of my knowledge and belief.

SIGNED Max M. Wilson TITLE Owner DATE 1-5-70

APPROVED BY John A. Runyan TITLE SUPERVISOR DISTRICT DATE JUL 15 1970

CONDITIONS OF APPROVAL, IF ANY: Geologist

NO. OF COPIES RECEIVED	
DISTRIBUTION	
SANTA FE	
FILE	
U.S.G.S.	
LAND OFFICE	
OPERATOR	

NEW MEXICO OIL CONSERVATION COMMISSION

Form C-103
Supersedes Old
C-102 and C-103
Effective 1-1-65

5a. Indicate Type of Lease
State Fee

5. State Oil & Gas Lease No.

SUNDRY NOTICES AND REPORTS ON WELLS

(DO NOT USE THIS FORM FOR PROPOSALS TO DRILL OR TO DEEPEN OR PLUG BACK TO A DIFFERENT RESERVOIR. USE "APPLICATION FOR PERMIT -" (FORM C-101) FOR SUCH PROPOSALS.)

1. OIL WELL <input type="checkbox"/> GAS WELL <input type="checkbox"/> OTHER- Wildcat		7. Unit Agreement Name
2. Name of Operator Max M. Wilson		8. Farm or Lease Name Carol
3. Address of Operator P. O. Box 1317, Roswell, New Mexico		9. Well No. 2
4. Location of Well UNIT LETTER <u>H</u> <u>660</u> FEET FROM THE <u>East</u> LINE AND <u>1980</u> FEET FROM THE <u>North</u> LINE, SECTION <u>22</u> TOWNSHIP <u>7 South</u> RANGE <u>34 East</u> NMPM.		10. Field and Pool, or Wildcat Wildcat
15. Elevation (Show whether DF, RT, GR, etc.)		12. County Roosevelt

16. Check Appropriate Box To Indicate Nature of Notice, Report or Other Data

NOTICE OF INTENTION TO:		SUBSEQUENT REPORT OF:	
PERFORM REMEDIAL WORK <input type="checkbox"/>	PLUG AND ABANDON <input type="checkbox"/>	REMEDIAL WORK <input type="checkbox"/>	ALTERING CASING <input type="checkbox"/>
TEMPORARILY ABANDON <input type="checkbox"/>	CHANGE PLANS <input checked="" type="checkbox"/>	COMMENCE DRILLING OPNS. <input type="checkbox"/>	PLUG AND ABANDONMENT <input type="checkbox"/>
PULL OR ALTER CASING <input type="checkbox"/>	OTHER <input type="checkbox"/>	CASING TEST AND CEMENT JOB <input type="checkbox"/>	OTHER <input type="checkbox"/>

17. Describe Proposed or Completed Operations (Clearly state all pertinent details, and give pertinent dates, including estimated date of starting any proposed work) SEE RULE 1703.

Change depth from 9000 feet to the Bough "C" formation to 10,000 feet to the Mississippian formation

18. I hereby certify that the information above is true and complete to the best of my knowledge and belief.

SIGNED Don M. Wilson TITLE Owner DATE 12-12-69

FOR RECORD ONLY

APPROVED BY _____ TITLE _____ DATE _____

CONDITIONS OF APPROVAL, IF ANY:

NO. OF COPIES RECEIVED	
DISTRIBUTION	
SANTA FE	
FILE	
U.S.G.S.	
LAND OFFICE	
OPERATOR	

NEW MEXICO OIL CONSERVATION COMMISSION

Form C-101
Revised 1-1-65

Dec 10 12 40 AM '69

5A. Indicate Type of Lease
STATE FEE

5. State Oil & Gas Lease No.

APPLICATION FOR PERMIT TO DRILL, DEEPEN, OR PLUG BACK

1a. Type of Work DRILL <input checked="" type="checkbox"/> DEEPEN <input type="checkbox"/> PLUG BACK <input type="checkbox"/>		7. Unit Agreement Name
b. Type of Well OIL WELL <input type="checkbox"/> GAS WELL <input type="checkbox"/> OTHER <input type="checkbox"/> SINGLE ZONE <input type="checkbox"/> MULTIPLE ZONE <input type="checkbox"/>		8. Farm or Lease Name Carol
2. Name of Operator Max M. Wilson		9. Well No. 2
3. Address of Operator P. O. Box 1317, Roswell, New Mexico 88201		10. Field and Pool, or Wildcat Wildcat
4. Location of Well UNIT LETTER <u>H</u> LOCATED <u>660</u> FEET FROM THE <u>East</u> LINE AND <u>1980</u> FEET FROM THE <u>North</u> LINE OF SEC. <u>22</u> TWP. <u>7South</u> RGE. <u>34 East</u> NMPM		12. County Roosevelt
19. Proposed Depth 9000'		19A. Formation Bough
20. Rotary or C.T. Rotary		
21. Elevations (Show whether DF, RT, etc.)	21A. Kind & Status Plug. Bond \$5000.00	21B. Drilling Contractor
		22. Approx. Date Work will start Dec. 12, 1969

23.

PROPOSED CASING AND CEMENT PROGRAM

SIZE OF HOLE	SIZE OF CASING	WEIGHT PER FOOT	SETTING DEPTH	SACKS OF CEMENT	EST. TOP
15 1/2"	11 3/4"	42#	375	250sx	
11"	8 5/8"	24#	2400'		
	8 5/8"	32#	3700'	425sx	
7 7/8"	5 1/2"		Prod. Zone	150sx	

IN ABOVE SPACE DESCRIBE PROPOSED PROGRAM; IF PROPOSAL IS TO DEEPEN OR PLUG BACK, GIVE DATA ON PRESENT PRODUCTIVE ZONE AND PROPOSED NEW PRODUCTIVE ZONE. GIVE BLOWOUT PREVENTER PROGRAM, IF ANY.

I hereby certify that the information above is true and complete to the best of my knowledge and belief.

Signed Max M. Wilson Title Owner Date Dec. 9, 1969

(This space for State Use)

APPROVED BY FOR RECORD ONLY TITLE _____ DATE _____

CONDITIONS OF APPROVAL, IF ANY:

**NEW MEXICO OIL CONSERVATION COMMISSION
WELL LOCATION AND ACREAGE DEDICATION PLAT**

Form C-102
Supersedes C-128
Effective 1-1-65

All distances must be from the outer boundaries of the Section.

Operator MAX M. WILSON			Lease CAROL		Well No. 2
Unit Letter H	Section 22	Township 7 SOUTH	Range 34 EAST	County ROOSEVELT	
Actual Footage Location of Well: 1980 feet from the NORTH line and 660 feet from the EAST line.					
Ground Level Elev.	Producing Formation 9000' BOUGH C		Pool WILDCAT	Dedicated Acreage: 40 Acres	

1. Outline the acreage dedicated to the subject well by colored pencil or hachure marks on the plat below.
2. If more than one lease is dedicated to the well, outline each and identify the ownership thereof (both as to working interest and royalty).
3. If more than one lease of different ownership is dedicated to the well, have the interests of all owners been consolidated by communitization, unitization, force-pooling, etc?

Yes No If answer is "yes," type of consolidation _____

If answer is "no," list the owners and tract descriptions which have actually been consolidated. (Use reverse side of this form if necessary.) _____

No allowable will be assigned to the well until all interests have been consolidated (by communitization, unitization, forced-pooling, or otherwise) or until a non-standard unit, eliminating such interests, has been approved by the Commission.

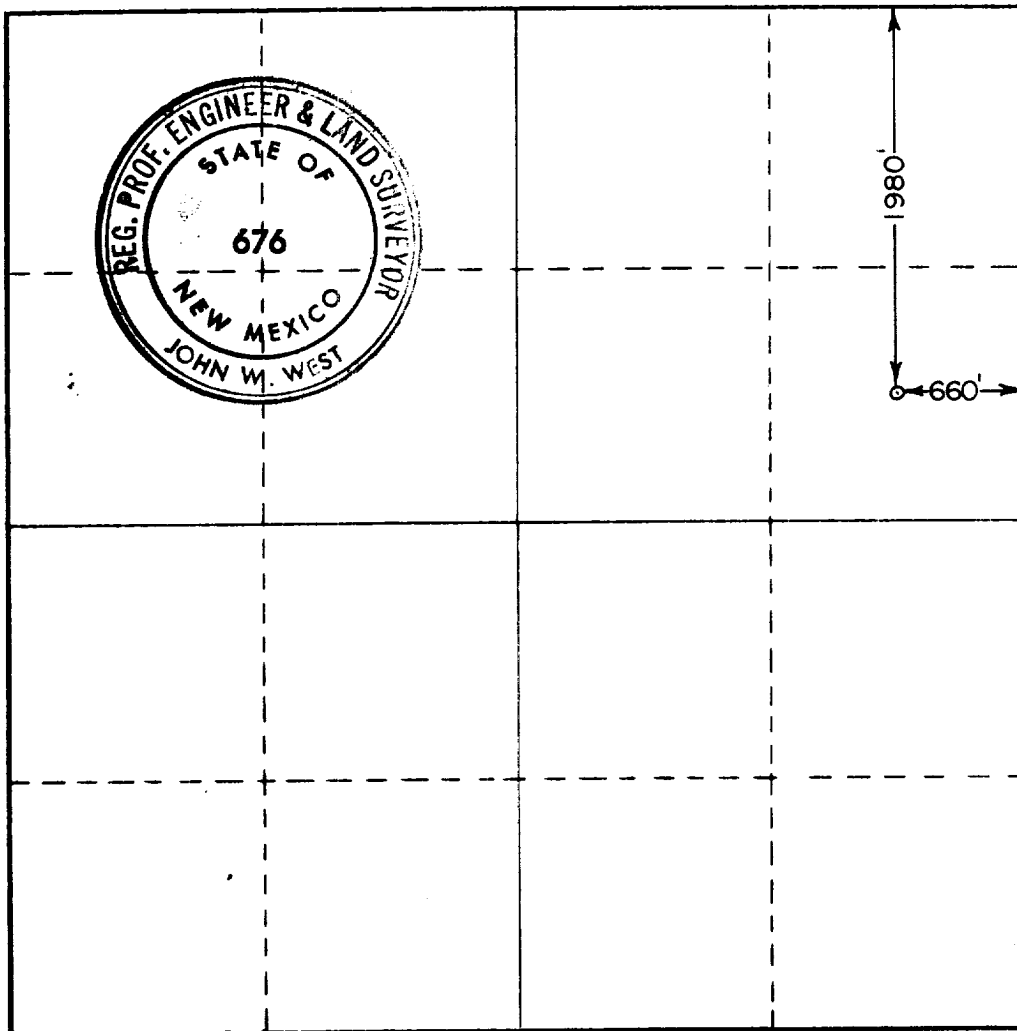

CERTIFICATION

I hereby certify that the information contained herein is true and complete to the best of my knowledge and belief.

Name: *John W. West*
 Position: *Agent*
 Company: *Max Wilson*
 Date: *12-12-69*

I hereby certify that the well location shown on this plat was plotted from field notes of actual surveys made by me or under my supervision, and that the same is true and correct to the best of my knowledge and belief.

Date Surveyed
DECEMBER 10, 1969

Registered Professional Engineer and/or Land Surveyor

John W. West

Certificate No. **676**