

NEW MEXICO OIL CONSERVATION COMMISSION
WELL LOCATION AND ACREAGE DEDICATION PLAN

SEE INSTRUCTIONS FOR COMPLETING THIS FORM ON THE REVERSE SIDE

SECTION A

Operator MAX M. WILSON		Lease HUMBLE STATE		
Unit Lease M	Section 16	Township 8 SOUTH	Range 33 EAST	County
Actual Footage Location of Well: 665.49 feet from the SOUTH line and 662.19 feet from the WEST line				
Ground Level Elev.	Producing Formation Sgt. Andrew	Pool Wildcat		Drilling Method

1. Is the Operator the only owner in the dedicated acreage outlined on the plat below? YES NO ("Owner" means the person who has the right to drill into and to produce from any pool and to appropriate the production either for himself or for himself and another. (63-3-29 (e) NMSA 1955 Comp.)
2. If the answer to question one is "no," have the interests of all the owners been consolidated by communication agreement or otherwise? YES NO . If answer is "yes," Type of Consolidation _____
3. If the answer to question two is "no," list all the owners and their respective interests below:

Owner	Land Description

SECTION B

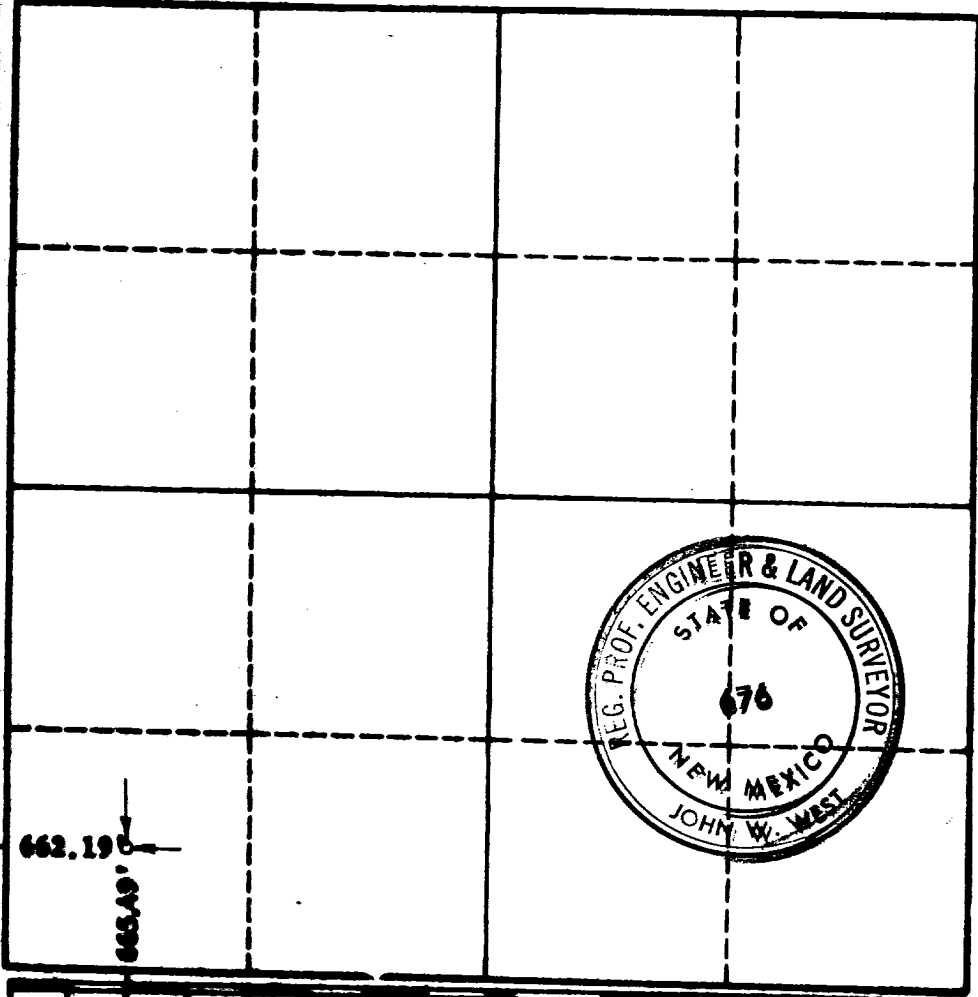

CERTIFICATION

I hereby certify that the information in SECTION A above is true and complete to the best of my knowledge and belief.

Name J. L. Smith
 Position Agent
 Company M.M. Wilson
 Date October 21, 1963

I hereby certify that the well location shown on the plat in SECTION B was plotted from field notes of actual surveys made by me or under my supervision, and that the same is true and correct to the best of my knowledge and belief.

Date Surveyed 8-23-63
 Registered Professional Engineer and/or Land Surveyor, JOHN W. WEST
John W. West
 Certificate No. M. M. - P. E. & L. S. No. 676

