

UNITED STATES
DEPARTMENT OF THE INTERIOR
GEOLOGICAL SURVEY

APPLICATION FOR PERMIT TO DRILL, DEEPEN, OR PLUG BACK

1a. TYPE OF WORK
DRILL DEEPEN PLUG BACK

b. TYPE OF WELL
OIL WELL GAS WELL OTHER
SINGLE ZONE MULTIPLE ZONE

2. NAME OF OPERATOR
Coquina Oil Corporation

3. ADDRESS OF OPERATOR
200 Bldg. of Southwest, Midland, Texas 79701

4. LOCATION OF WELL (Report location clearly and in accordance with any State requirements.)*
At surface 1980' FSL & 1980' FEL of Sec. 27
At proposed prod. zone Same

14. DISTANCE IN MILES AND DIRECTION FROM NEAREST TOWN OR POST OFFICE*
11 miles southeast of Elkins

15. DISTANCE FROM PROPOSED* LOCATION TO NEAREST PROPERTY OR LEASE LINE, FT.
(Also to nearest drlg. unit line, if any.)
1980'

18. DISTANCE FROM PROPOSED LOCATION* TO NEAREST WELL, DRILLING COMPLETED, OR APPLIED FOR, ON THIS LEASE, FT.
1320

21. ELEVATIONS (Show whether DF, RT, GR, etc.)
G. L. 4176'

23. PROPOSED CASING AND CEMENTING PROGRAM

SIZE OF HOLE	SIZE OF CASING	WEIGHT PER FOOT	SETTING DEPTH	QUANTITY OF CEMENT
17	13 3/8	48	300	Circulate
13	8 5/8	24-32	2800	400
7 7/8	5 1/2	15.5-17	9700	750

It is proposed to drill a 17 1/2" hole to 300', run 13 3/8" 48#/ft. casing and cement to surface. WOC 18 hrs. NU BOP. Test casing to 600 psi. Drill 11" hole to 600'. Run 8 5/8" 24# & 32# casing and cement with estimated 400 sxs. cement. WOC 18 hrs. NU BOP. Test casing to 1000 psi. Drill 7 7/8" hole to T.D., estimated 9700'. Fresh water mud will be used from surface to 7400' with viscosity control for good hole cleaning qualities. From 7400' to T. D., density will be maintained as required with adequate control of W.L. and viscosity. PVT, flow sensor, and pump stroke counter will be installed prior to drilling Wolfcamp, estimated 7500'.

IN ABOVE SPACE DESCRIBE PROPOSED PROGRAM: If proposal is to deepen or plug back, give data on present productive zone and present production. If proposal is to drill or deepen directionally, give pertinent data on subsurface locations and measured and true vertical depths. Give blowout preventer program, if any.

24. SIGNEL J. T. Berry (J. T. Berry) TITLE Superintendent DATE 10-1-74

(This space for Federal or State office use)

APPROVED
OCT 31 1974
APPROVED BY: [Signature]
TITLE: DISTRICT ENGINEER

APPROVAL DATE: _____
SUBJECT TO ATTACHED DEEP WELL CONTROL REQUIREMENTS DATED JUN 22 1973

THIS APPROVAL IS RESCINDED IF OPERATIONS ARE NOT COMMENCED WITHIN 3 MONTHS. See Instruction On Reverse Side
JAN 31 1975

5. LEASE DESIGNATION AND SERIAL NO.
NM 022636
6. IF IN AN ALLOTTEE OR TRIBE NAME
7. UNIT AGREEMENT NAME
8. FARM OR LEASE NAME
Shel Federal
9. WELL NO.
10. FIELD AND POOL, OR WILDCAT
Undesignated Morrow
11. SEC., T., B., M., OR BLK. AND SURVEY OR AREA
Sec. 27, T8S, R30E
12. COUNTY OR PARISH 13. STATE
Chaves N.M.

RECEIVED

NOV 1 1974

O. C. C. ARTESIA, OFFICE

RECEIVED
OCT - 3 1974
U. S. GEOLOGICAL SURVEY
ARTESIA, NEW MEXICO

NEW MEXICO OIL CONSERVATION COMMISSION
WELL LOCATION AND ACREAGE DEDICATION PLAN

Form C-102
Supersedes C-128
Effective 1-1-65

All distances must be from the outer boundaries of the Section.

Operator COQUINA OIL CORP.		Lease SHELL-FEDERAL #1		Well No. 1
Unit Letter "J"	Section 27	Township 8-S	Range 30-E	County CHAVES
Actual Postage Location of Well: 1980 feet from the SOUTH line and 1980 feet from the EAST line				
Ground Level Elev. 4176	Producing Formation MORROW	Pool UNDESIGNATED	Dedicated Acreage: 320 Acres	

1. Outline the acreage dedicated to the subject well by colored pencil or hachure marks on the plat below.
2. If more than one lease is dedicated to the well, outline each and identify the ownership thereof (both as to working interest and royalty).
3. If more than one lease of different ownership is dedicated to the well, have the interests of all owners been consolidated by communitization, unitization, force-pooling, etc.?

Yes No If answer is "yes," type of consolidation _____

If answer is "no," list the owners and tract descriptions which have actually been consolidated. (Use reverse side of this form if necessary.) _____

No allowable will be assigned to the well until all interests have been consolidated (by communitization, unitization, forced-pooling, or otherwise) or until a non-standard unit, eliminating such interests, has been approved by the Commission.

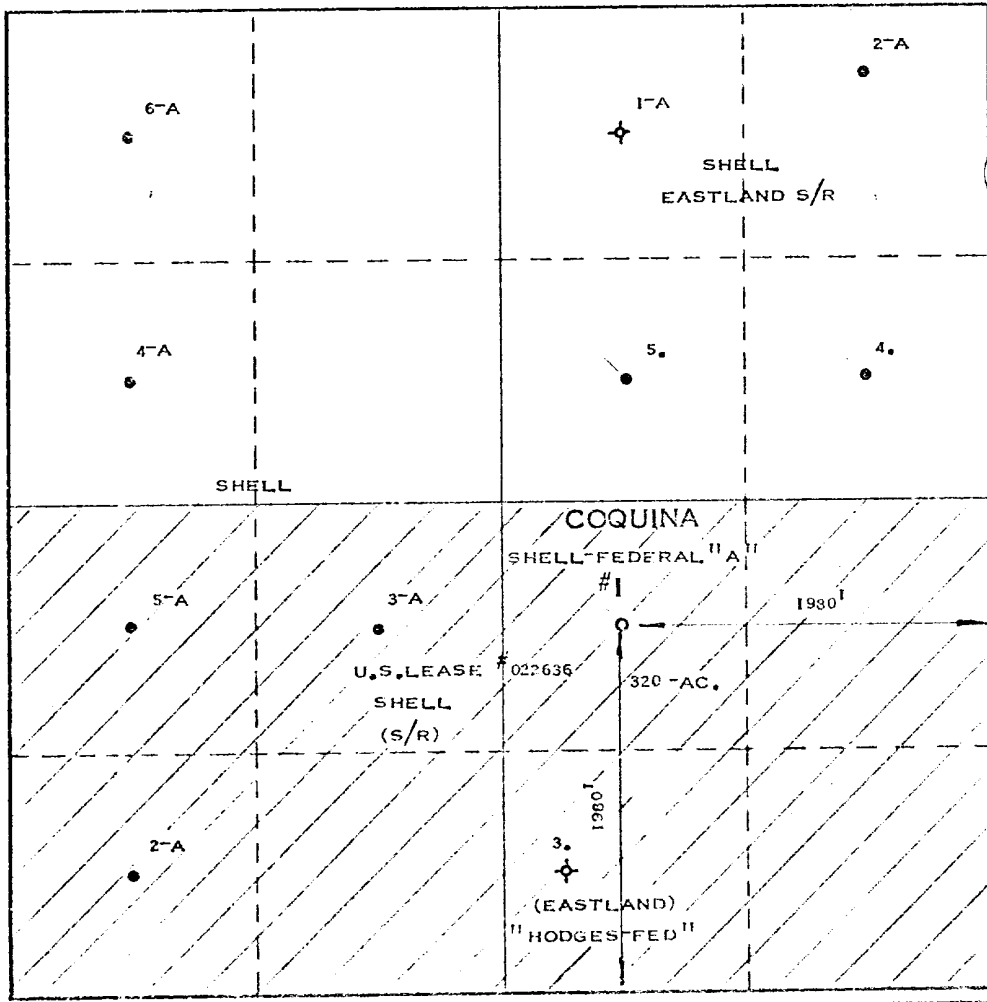

CERTIFICATION

I hereby certify that the information contained herein is true and complete to the best of my knowledge and belief.

J. T. Berry

Name J. T. Berry
Position Superintendent
Company Coquina Oil Corporation
Date October 1, 1974

I hereby certify that the well location shown on this plat was plotted from field notes of actual survey made by me or under my supervision, and that the same is true and correct to the best of my knowledge and belief.

RECEIVED
SEP 13 1974
GEOLOGICAL SURVEY
SANTA FE, NEW MEXICO

Date Surveyed SEPTEMBER 28, 1974
Registered Professional Engineer and Land Surveyor <i>Max A. Schumann Jr.</i> MAX A. SCHUMANN JR.

Certificate No. **1510**

Development Plan for Surface Use

Coquina Oil Corporation
Shell Federal #1
Sec. 27, T7S, R30E
Chaves Co., New Mexico

1. U.S.G.S. Topographic Map, Exhibit 1, is enclosed showing location and all roads within three mile radius.
2. U.S.G.S. Topographic Map shows planned access road. Road will be approximately 1320' long and 12' wide. (Exhibit 2)
3. Section of the County Ownership Map, Exhibit 3, shows all wells in the vicinity of the proposed location.
4. No lateral roads located within one mile of location.
5. Tank battery and flow line, if needed, will be located on drilling pad.
6. Water will be purchased from closest commercial source.
7. All waste will be disposed of in pits and burned.
8. No camps will be constructed.
9. No airstrips will be constructed.
10. Rig layout is noted on Exhibit 4.
11. The location will be restored in accordance with regulations.
12. The terrain is flat, dry, grazing land.

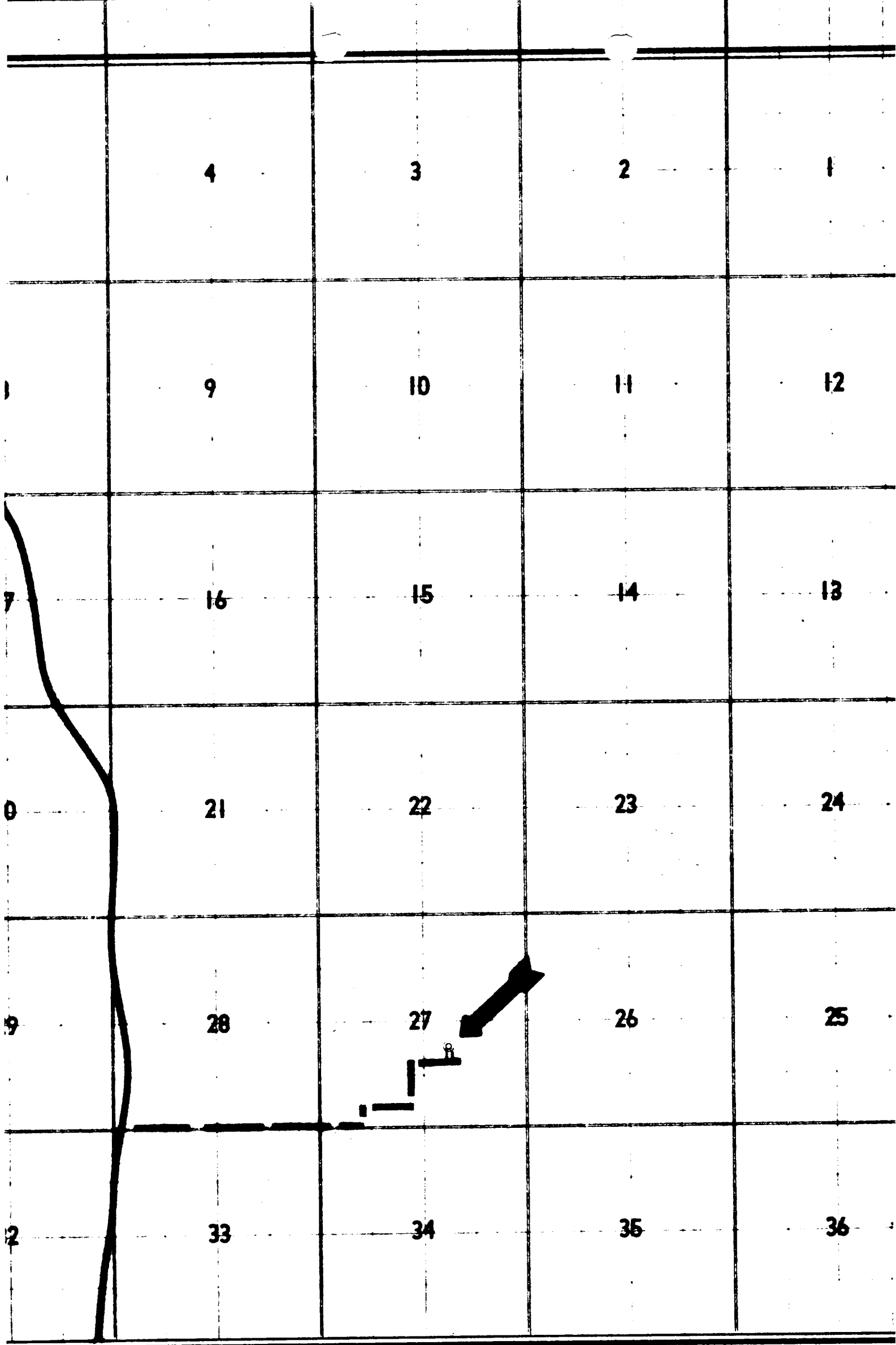

SOUTH

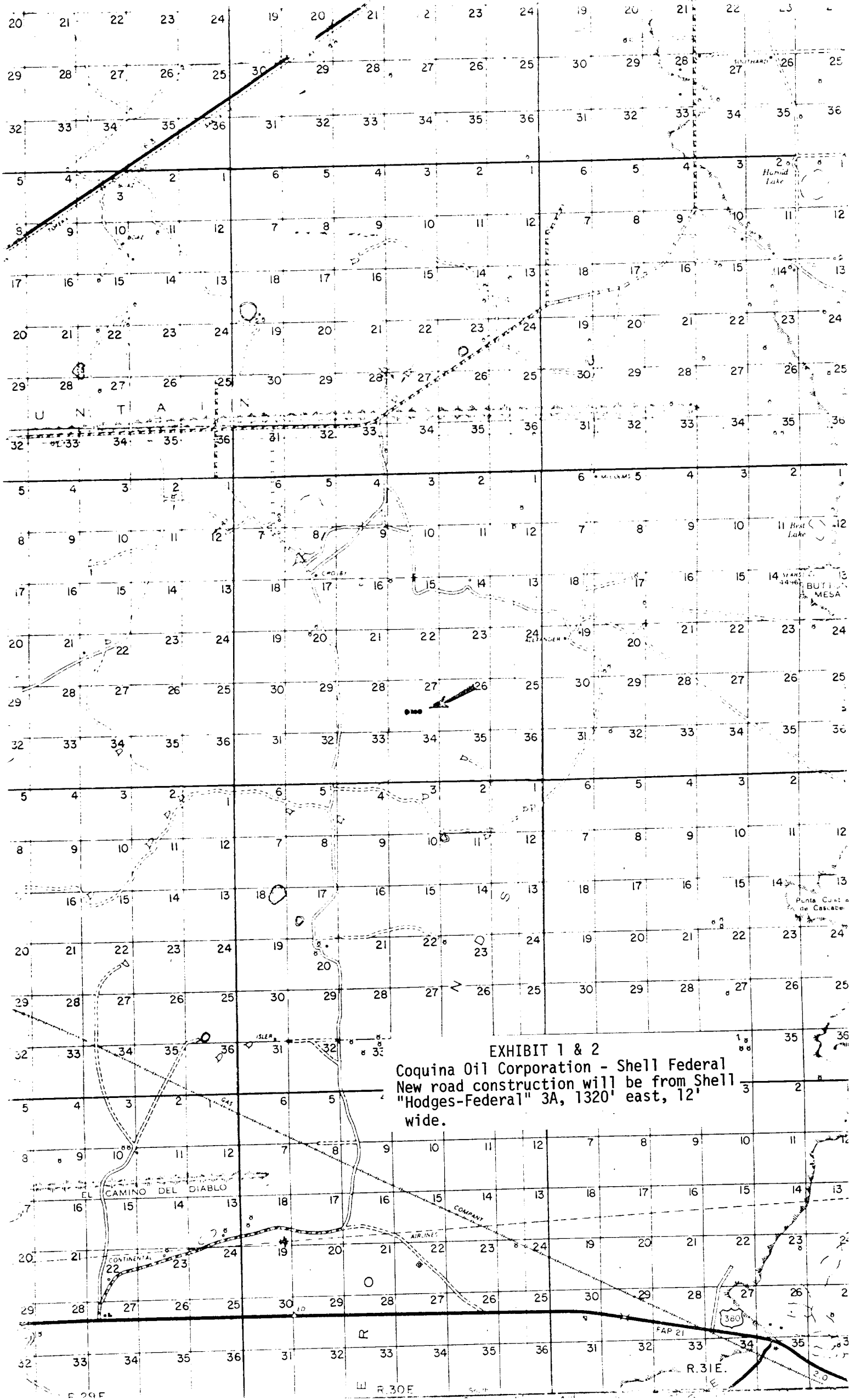

EXHIBIT 1 & 2
 Coquina Oil Corporation - Shell Federal
 New road construction will be from Shell
 "Hodges-Federal" 3A, 1320' east, 12'
 wide.

EL CAMINO DEL DIABLO

CONTINENTAL

COMPART

AIR LINES

FAP 21

380

R. 31E

R. 30E

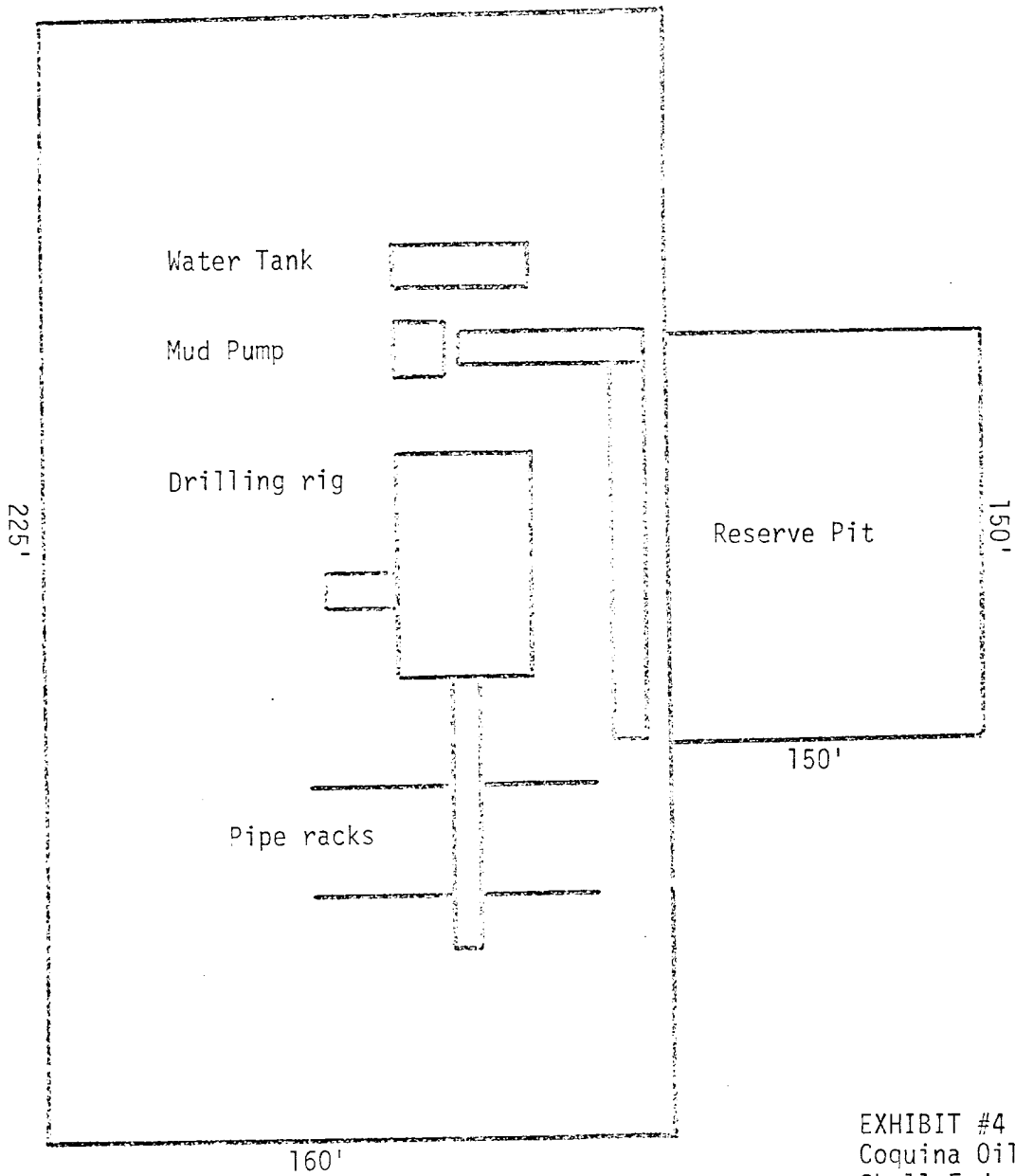
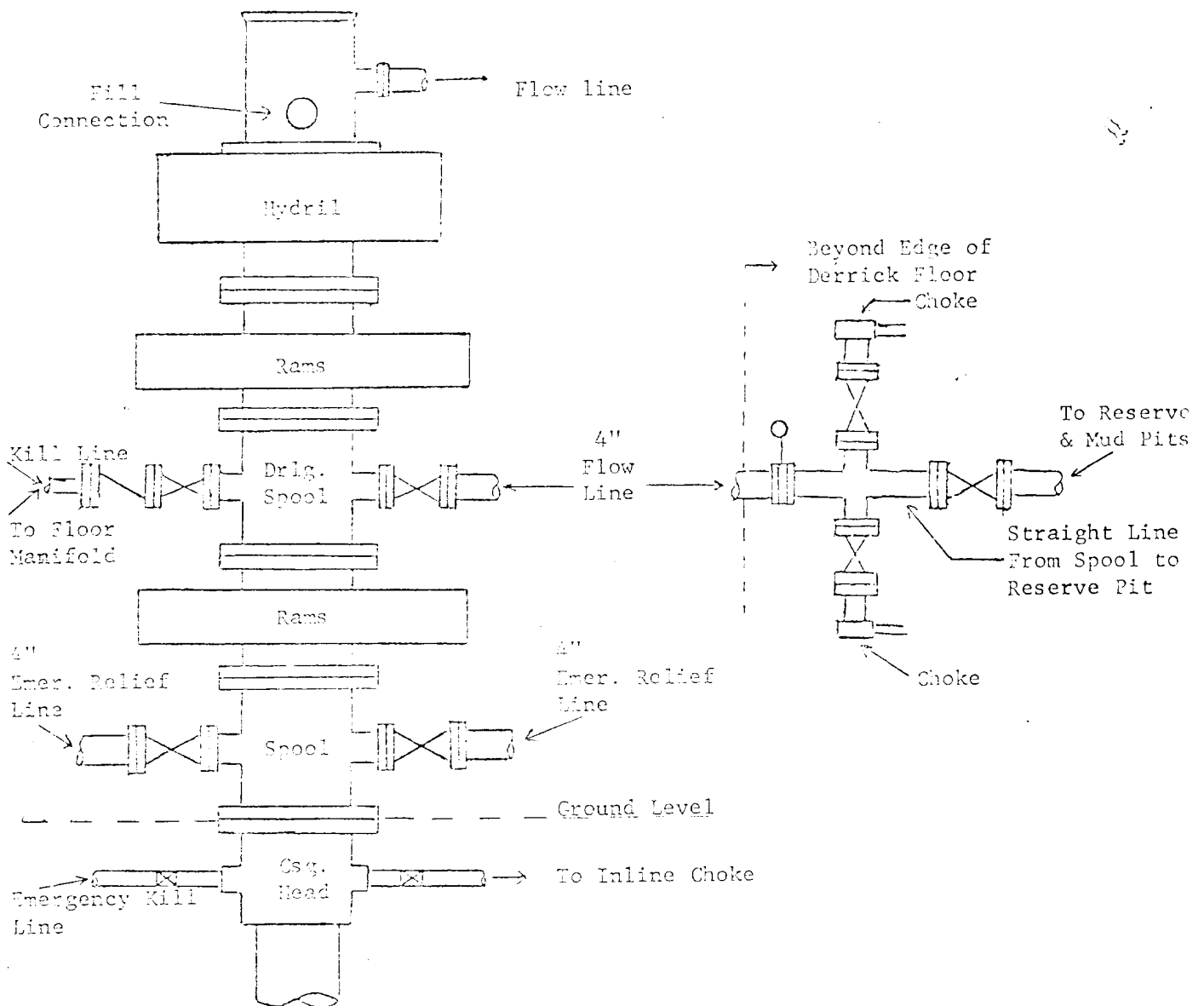

EXHIBIT #4
Coquina Oil Corporation
Shell Federal #1
Chaves Co., N.M.



Minimum assembly will consist of two hydraulically operated ram type preventers and a Hydril. If double type preventers are provided, the flanged outlets of the preventer may be used for the flow line and kill line. Minimum operating equipment for the preventers will be: (1) An air operated pump(s) and (2) an accumulator(s) with means of obtaining a fluid charge. A regulator is to be provided for the Hydril preventer. Sufficient fluid capacity in the accumulator(s) shall be available to close all the pressure operated devices at the same time with 25 percent reserve. Hydraulic oil shall be used as the operating fluid. Seamless steel piping shall be used to connect from the closing end to the preventers. The choke manifold and flow line shall be supported by metal stands. The choke lines shall be anchored. No sharp bends or curves will be permitted in the flow line from the preventers to the pits. Easy and safe access will be maintained to choke manifold at all times. The ram type preventers and hydraulically operated valves will be provided with stem extensions, universal joints, if needed, and operating wheels which are to extend beyond edge of derrick substructure.