

30-005-20902

Form C-101  
Revised 10-1-78

|                        |  |
|------------------------|--|
| NO. OF COPIES RECEIVED |  |
| DISTRIBUTION           |  |
| SANTA FE               |  |
| FILE                   |  |
| U.S.G.S.               |  |
| LAND OFFICE            |  |
| OPERATOR               |  |

5A. Indicate Type of Lease  
STATE  FEE

5. State Oil & Gas Lease No.  
LG-1289

APPLICATION FOR PERMIT TO DRILL, DEEPEN, OR PLUG BACK

a. Type of Work  
DRILL  DEEPEN  PLUG BACK

b. Type of Well  
OIL WELL  GAS WELL  OTHER  SINGLE ZONE  MULTIPLE ZONE

6. Name of Operator  
Yates Petroleum Corporation

7. Address of Operator  
207 S. 4th, Artesia, New Mexico 88210

8. Location of Well  
UNIT LETTER A LOCATED 330 FEET FROM THE North LINE  
330 FEET FROM THE East LINE OF SEC. 2 TWP. 8S RGE. 31E NMPM

7. Unit Agreement Name

8. Farm or Lease Name  
Union "XJ" State

9. Well No.  
1

10. Field and Pool, or Wildcat  
Unders. Tomahawk SA

17. County  
Chaves

19. Proposed Depth  
appr. 4250'

19A. Formation  
San Andres

20. Rotary or C.T.  
Rotary

21. Elevations (show whether DF, RT, etc.)  
4358.1' GL

21A. Kind & Status Plug. Bond  
Blanket

21B. Drilling Contractor  
LaRue Drilling

22. Approx. Date Work will start  
ASAP

PROPOSED CASING AND CEMENT PROGRAM

| SIZE OF HOLE | SIZE OF CASING | WEIGHT PER FOOT | SETTING DEPTH | SACKS OF CEMENT | EST. TOP   |
|--------------|----------------|-----------------|---------------|-----------------|------------|
| 9 1/2"       | 7"             | 20# J-55        | appr. 1700'   | 500 sx          | circulated |
| 6 1/2"       | 4 1/2"         | 9.5\$#          | TD            | 300 sx          |            |

We propose to drill and test the San Andres formation. If commercial, 4 1/2" production casing will be run and cemented with an adequate cover, perforated and stimulated as needed for production.

MUD PROGRAM: Native mud to 1700'. FW to TD.

BOP PROGRAM: BOP's will be installed at 1700' and tested daily.

APPROVAL VALID FOR 180 DAYS  
PERMIT EXPIRES 12/6/83  
UNLESS DRILLING UNDERWAY

ABOVE SPACE DESCRIBE PROPOSED PROGRAM; IF PROPOSAL IS TO DEEPEN OR PLUG BACK, GIVE DATA ON PRESENT PRODUCTIVE ZONE AND PROPOSED NEW PRODUCTION ZONE. GIVE BLOWOUT PREVENTER PROGRAM, IF ANY.

I hereby certify that the information above is true and complete to the best of my knowledge and belief.

Signed [Signature] Title Regulatory Agent Date 6/2/83

(This space for State Use)  
ORIGINAL SIGNED BY JERRY SEXTON  
DISTRICT I SUPERVISOR

APPROVED BY \_\_\_\_\_ TITLE \_\_\_\_\_ DATE JUN 6 1983

CONDITIONS OF APPROVAL, IF ANY:

RECEIVED  
JUN 6 1983  
O.C.D.  
HOBBS OFFICE

NEW MEXICO OIL CONSERVATION COMMISSION  
WELL LOCATION AND ACREAGE DEDICATION PLAT

Form C-102  
Supersedes C-128  
Effective 1-1-65

All distances must be from the outer boundaries of the Section.

|  |  |                            |                                   |                                       |                      |
|--|--|----------------------------|-----------------------------------|---------------------------------------|----------------------|
| Operator<br><b>YATES PETROLEUM CORPORATION</b>   |  |                            | Lease<br><b>Union "XJ" State</b>  |                                       | Well No.<br><b>1</b> |
| Tract Letter<br><b>A</b>   | Section<br><b>2</b>                      | Township<br><b>8 South</b> | Range<br><b>31 East</b>           | County<br><b>Chaves</b>               |                      |
| Actual Footage Location of Well:<br><b>330</b> feet from the <b>North</b> line and <b>330</b> feet from the <b>East</b> line |  |                            |                                   |                                       |                      |
| Ground Level Elev.<br><b>4258.1' GL</b>  | Producing Formation<br><b>San Andres</b> |                            | Pool<br><b>Undes. Tomahawk SA</b> | Dedicated Acreage:<br><b>40</b> Acres |                      |

1. Outline the acreage dedicated to the subject well by colored pencil or hachure marks on the plat below.
2. If more than one lease is dedicated to the well, outline each and identify the ownership thereof (both as to working interest and royalty).
3. If more than one lease of different ownership is dedicated to the well, have the interests of all owners been consolidated by communitization, unitization, force-pooling, etc?

Yes  No If answer is "yes," type of consolidation \_\_\_\_\_

If answer is "no," list the owners and tract descriptions which have actually been consolidated. (Use reverse side of this form if necessary.) \_\_\_\_\_

No allowable will be assigned to the well until all interests have been consolidated (by communitization, unitization, forced-pooling, or otherwise) or until a non-standard unit, eliminating such interests, has been approved by the Commission.

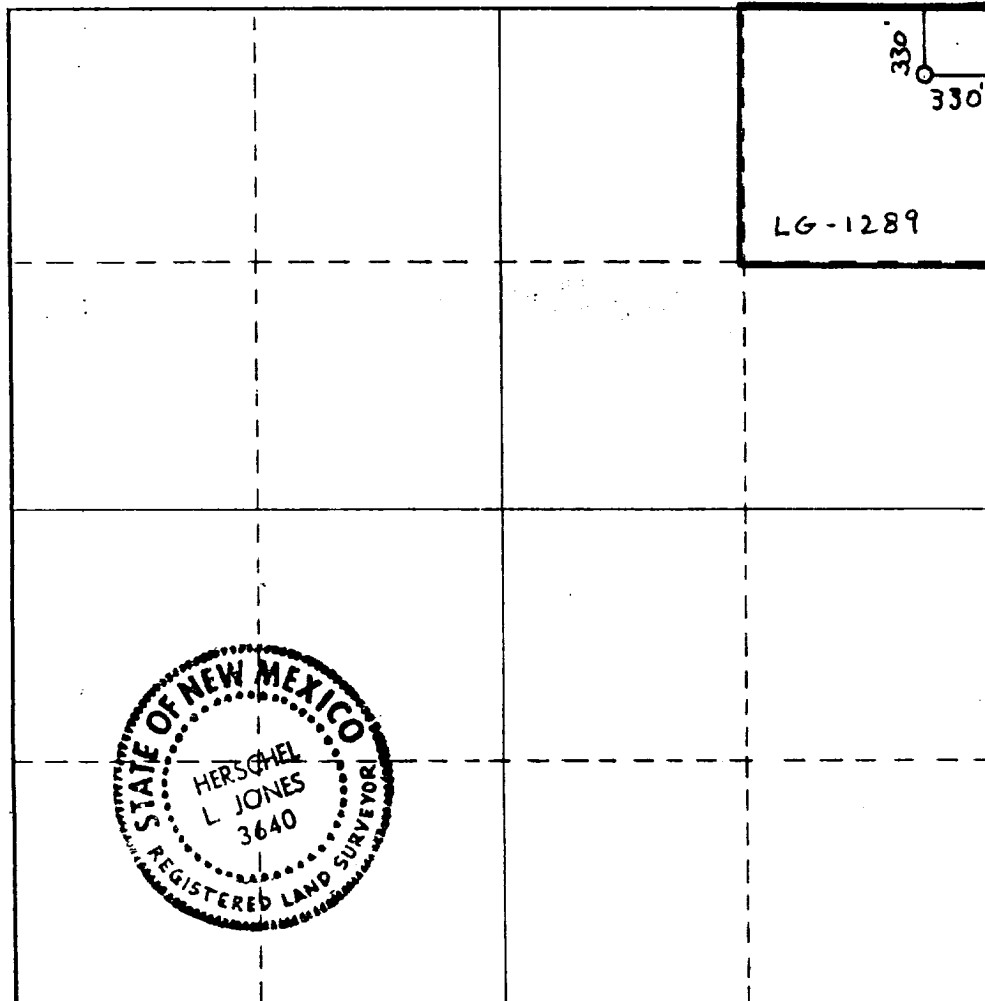

CERTIFICATION

I hereby certify that the information contained herein is true and complete to the best of my knowledge and belief.

*Gilserio Rodriguez*  
Name

**Gilserio Rodriguez**  
Position

**Regulatory Agent**  
Company

**Yates Petroleum Corp.**  
Date

**6/2/83**

I hereby certify that the well location shown on this plat was plotted from field notes of actual surveys made by me or under my supervision, and that the same is true and correct to the best of my knowledge and belief.

Date Surveyed

**May 31, 1983**

Registered Professional Engineer and/or Land Surveyor

*Herschel L. Jones*  
Certificate No.

**3640**

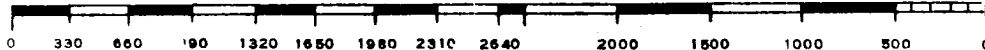

# EXHIBIT B

## BOP DIAGRAM

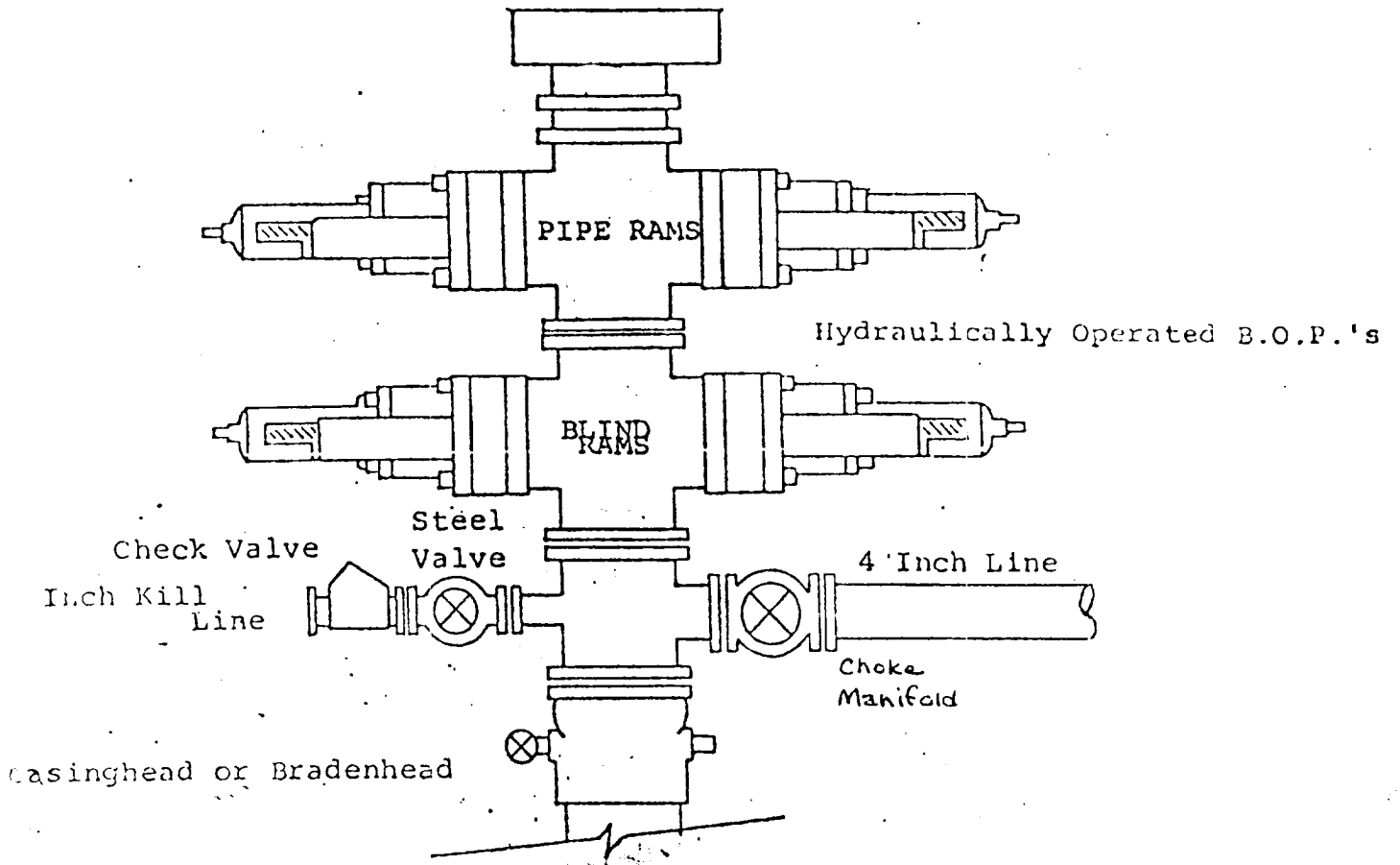

RECEIVED  
JUN 6 1983  
HOBBS OFFICE

