

NEW MEXICO OIL CONSERVATION COMMISSION
Santa Fe, New Mexico

Form C-101
Revised (12/1/55)

NOTICE OF INTENTION TO DRILL

Notice must be given to the District Office of the Oil Conservation Commission and approval obtained before drilling or recompletion begins. If changes in the proposed plan are considered advisable, a copy of this notice showing such changes will be returned to the sender. Submit this notice in QUINTUPLICATE. One copy will be returned following approval. See additional instructions in Rules and Regulations of the Commission. If State Land submit 6 Copies Attach Form C-128 in triplicate to first 3 copies of form C-101

November 27, 1957

Midland, Texas

(Place)

(Date)

OIL CONSERVATION COMMISSION
SANTA FE, NEW MEXICO

Gentlemen:

You are hereby notified that it is our intention to commence the Drilling of a well to be known as

Union Oil Company of California

(Company or Operator)

R. W. Duncan "B"

(Lease)

Well No. 1-6

in E (Unit)

The well is

located 1920 feet from the North

line and 660 feet from the

East

line of Section 6, T. 13S, R. 36E, NMPM.

(GIVE LOCATION FROM SECTION LINE)

Un Designated

Pool,

Lee

County

If State Land the Oil and Gas Lease is No.

If patented land the owner is

R. W. Duncan

Address

Tatum, New Mexico

We propose to drill well with drilling equipment as follows:

Rotary

The status of plugging bond is

J. S. Ward & Sons

Artesia, New Mexico

Drilling Contractor

Delta Drilling Company

Citizens National Bank Building

Tyler, Texas

We intend to complete this well in the

Wolfcamp

formation at an approximate depth of

10,500

feet.

CASING PROGRAM

We propose to use the following strings of Casing and to cement them as indicated:

Size of Hole	Size of Casing	Weight per Foot	New or Second Hand	Depth	Sacks Cement
15"	11-3/4"	42#	New	325'	350
11"	8-5/8"	32# and 24#	New	4,500'	500
7-1/8"	5-1/2"	17# and 15.5#	New	10,500'	400

If changes in the above plans become advisable we will notify you immediately.

ADDITIONAL INFORMATION (If recompletion give full details of proposed plan of work.)

Approved
Except as follows:

Sincerely yours,

Union Oil Company of California

(Company or Operator)

By

Drilling Supt.

Send Communications regarding well to

Name Union Oil Company of California

Address 619 W. Texas Ave., Midland, Texas

OIL CONSERVATION COMMISSION

By

(See instructions for completing this form)

Certificate No. 676

NEW MEXICO OIL CONSERVATION COMMISSION

Well Location and Acreage Dedication Plat

HOOPER'S OFFICE OCC
1957 NOV 23 8:41

Section A.

Date 11-23-1957

Operator Union Oil Company of Calif Lease James Duncan "B"
Well No. 1-6 Unit letter H Section 6 Township 13 South Range 36 East NMPM
Located 1980 Feet From North Line, 660 Feet From East Line
County Lea G. L. Elevation 1980 Dedicated Acreage 40 Acres
Name of Producing Formation Wolfcamp Pool Undesignated

1. Is the Operator the only owner* in the dedicated acreage outlined on the plat below?
Yes _____ No X .
2. If the answer to question one is "no," have the interests of all the owners been consolidated by communitization agreement or otherwise? Yes _____ No X . If answer is "yes," Type of Consolidation Operating agreement pending
3. If the answer to question two is "no," list all the owners and their respective interests below:

<u>Owner</u>	<u>Land Description</u>
<u>Union Oil Company of California</u>	<u>5/8 of N/2, Sec. 6, T-13S, R-36E</u>
<u>Delta Drilling Company</u>	<u>3/8 of N/2, Sec. 6, T-13S, R-36E</u>

Section B

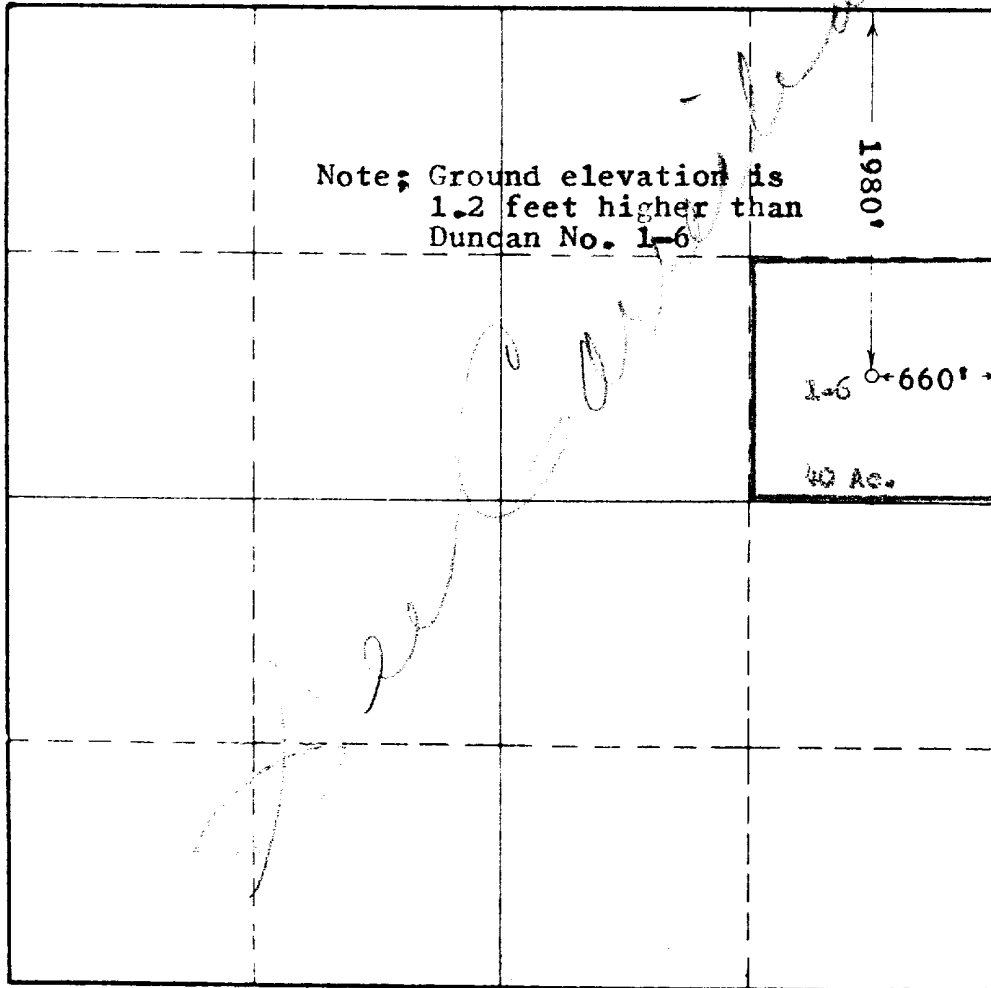

This is to certify that the information in Section A above is true and complete to the best of my knowledge and belief.

Union Oil Company of California
(Operator)
Paul J. [Signature]
(Representative)
619 West Texas Avenue
Midland, Texas
Address

This is to certify that the well location shown on the plat in Section B was plotted from field notes of actual surveys made by me or under my supervision and that the same is true and correct to the best of my knowledge and belief.

Date Surveyed 11-23-1957
John W. West
Registered Professional
Engineer and/or Land Surveyor.

