

State of New Mexico
Energy, Minerals and Natural Resources Department

Form C-101
Revised 1-1-89

Submit to Appropriate
District Office
State Lease - 6 copies
Fee Lease - 5 copies

OIL CONSERVATION DIVISION

P.O. Box 2088
Santa Fe, New Mexico 87504-2088

DISTRICT I
P.O. Box 1980, Hobbs, NM 88240

DISTRICT II
P.O. Drawer DD, Artesia, NM 88210

DISTRICT III
1000 Rio Brazos Rd., Aztec, NM 87410

API NO. (assigned by OCD on New Wells)	<u>30-02531290</u>
5. Indicate Type of Lease	STATE <input checked="" type="checkbox"/> FEE <input type="checkbox"/>
6. State Oil & Gas Lease No.	<u>B7766</u>

APPLICATION FOR PERMIT TO DRILL, DEEPEN, OR PLUG BACK					
1a. Type of Work: DRILL <input checked="" type="checkbox"/> RE-ENTER <input type="checkbox"/> DEEPEN <input type="checkbox"/> PLUG BACK <input type="checkbox"/>	7. Lease Name or Unit Agreement Name <u>Lovington Paddock Unit</u>				
b. Type of Well: OIL WELL <input checked="" type="checkbox"/> GAS WELL <input type="checkbox"/> OTHER <input type="checkbox"/> SINGLE ZONE <input type="checkbox"/> MULTIPLE ZONE <input type="checkbox"/>	8. Well No. <u>114</u>				
2. Name of Operator <u>Greenhill Petroleum Corporation</u>	9. Pool name or Wildcat <u>Lovington Paddock</u>				
3. Address of Operator <u>11490 Westheimer, Ste., 200, Houston, TX 77077</u>					
4. Well Location Unit Letter <u>N</u> : <u>150</u> Feet From The <u>South</u> Line and <u>1650</u> Feet From The <u>West</u> Line Section <u>36</u> Township <u>16S</u> Range <u>36E</u> NMPM <u>1ea</u> County _____					
10. Proposed Depth <u>6600</u>	11. Formation <u>Paddock</u>				
12. Rotary or C.T.					
13. Elevations (Show whether DF, RT, GR, etc.) <u>3835 GR</u>	14. Kind & Status Plug. Bond <u>on file</u>				
15. Drilling Contractor <u>TBD</u>	16. Approx. Date Work will start				
17. PROPOSED CASING AND CEMENT PROGRAM					
SIZE OF HOLE	SIZE OF CASING	WEIGHT PER FOOT	SETTING DEPTH	SACKS OF CEMENT	EST. TOP
<u>12 1/4</u>	<u>8 5/8</u>	<u>25</u>	<u>2050</u>	<u>900</u>	<u>Surface</u>
<u>7 7/8</u>	<u>5 1/2</u>	<u>15.5</u>	<u>6600</u>	<u>to be determined</u>	<u>Surface</u>
				<u>by fluid caliper</u>	

IN ABOVE SPACE DESCRIBE PROPOSED PROGRAM: IF PROPOSAL IS TO DEEPEN OR PLUG BACK, GIVE DATA ON PRESENT PRODUCTIVE ZONE AND PROPOSED NEW PRODUCTIVE ZONE. GIVE BLOWOUT PREVENTER PROGRAM, IF ANY.

I hereby certify that the information above is true and complete to the best of my knowledge and belief.

SIGNATURE Michael J. Newport TITLE Land Manager-Permian Basin DATE 6-6-91
TYPE OR PRINT NAME Michael J. Newport TELEPHONE NO. 955-1146

(This space for State Use)

APPROVED BY ORIGINAL SIGNATURE BY JERRY SEXTON DISTRICT SUPERVISOR TITLE _____ DATE JUN 24 1991

CONDITIONS OF APPROVAL, IF ANY:

MSL-3020

Permit Expires 6 Months From Approval
Date Unless Drilling Underway.

Submit to Appropriate District Office
 State Lease - 4 copies
 Fee Lease - 3 copies

OIL CONSERVATION DIVISION
 P.O. Box 2088
 Santa Fe, New Mexico 87504-2088

DISTRICT I
 P.O. Box 1980, Hobbs, NM 88240

DISTRICT II
 P.O. Denver DO, Artesia, NM 88210

DISTRICT III
 1000 Rio Brazos Rd., Aztec, NM 87410

WELL LOCATION AND ACREAGE DEDICATION PLAT
 All Distances must be from the outer boundaries of the section

Operator GREENHILL PETROLEUM CORP.			Lease LOVINGTON PADDOCK UNIT		Well No. 114
Unit Letter N	Section 36	Township 16 SOUTH	Range 36 EAST	County LEA	
Actual Footage Location of Well: 150 feet from the SOUTH line and 1650 feet from the WEST line					
Ground level Elev. 3835.0	Producing Formation Lovington Paddock		Pool Lovington Paddock		Dedicated Acreage: 40 Acres

- Outline the acreage dedicated to the subject well by colored pencil or hatch marks on the plat below.
- If more than one lease is dedicated to the well, outline each and identify the ownership thereof (both as to working interest and royalty).
- If more than one lease of different ownership is dedicated to the well, have the interest of all owners been consolidated by communitization, unitization, force-pooling, etc.?

Yes No If answer is "yes" type of consolidation Unitized

If answer is "no" list the owners and tract descriptions which have actually been consolidated. (Use reverse side of this form if necessary.)

No allowable will be assigned to the well until all interests have been consolidated (by communitization, unitization, forced-pooling, or otherwise) or until a non-standard unit, eliminating such interest, has been approved by the Division.

OPERATOR CERTIFICATION
 I hereby certify that the information contained herein is true and complete to the best of my knowledge and belief.

Signature Richard Newport
 Printed Name Michael J. Newport
 Position Landman
 Company Greenhill Petroleum Corporation
 Date 6/5/91

SURVEYOR CERTIFICATION
 I hereby certify that the well location shown on this plat was plotted from field notes of actual surveys made by me or under my supervision, and that the same is true and correct to the best of my knowledge and belief.

Date Surveyed 5-21-91
 Signature & Seal of Professional Surveyor [Signature]
 Certificate No. JOHN W. WEST, 676
GARY L. JONES 7977

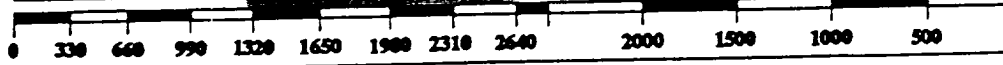
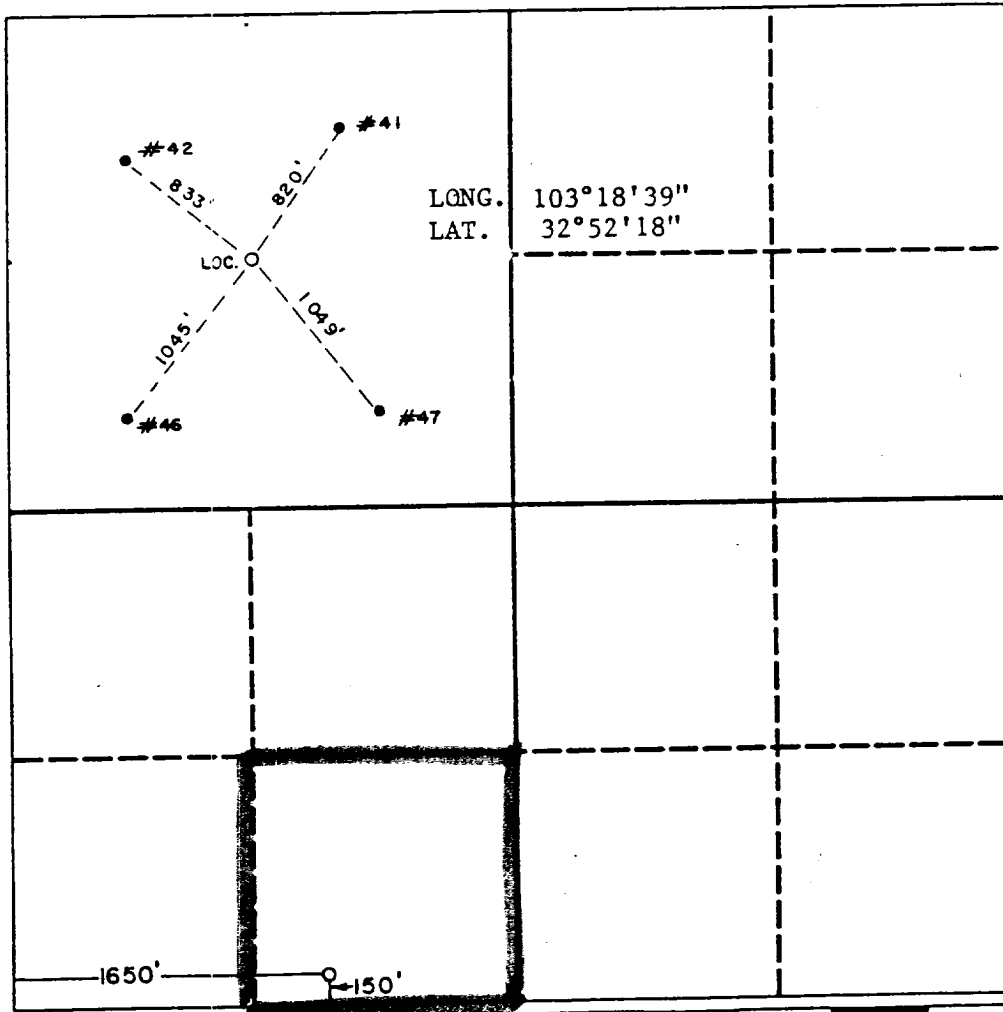

GREENHILL PETROLEUM CORPORATION
BOP PROGRAM FOR
LOVINGTON PADDOCK WELL # 114

Casing Program

BOP Program

Size	Depth	Wt	Grade	Configuration	Test Pressure
8 5/8"	2050'	24	H40, STC	RA	200 psi
5 1/2"	6350'	15.5	K55, STC	RR	250/1500 psi

* RR - Ram Ram

RA - Ram Annular

Diverter - Hydrill may be substituted for a diverter