

NO. OF COPIES RECEIVED		
DISTRIBUTION		
SANTA FE		
FILE		
U.S.G.S.		
LAND OFFICE		
OPERATOR		

NEW MEXICO OIL CONSERVATION COMMISSION

30-025-27570

Form C-101
Revised 1-1-65

5A. Indicate Type of Lease:
STATE FEE

5. State Oil & Gas Lease No.
B-2229

APPLICATION FOR PERMIT TO DRILL, DEEPEN, OR PLUG BACK

1a. Type of Work
b. Type of Well DRILL DEEPEN PLUG BACK
OIL WELL GAS WELL OTHER SINGLE ZONE MULTIPLE ZONE

7. Unit Agreement Name
SMGSAU

8. Farm or Lease Name
Tract 4

2. Name of Operator
CITIES SERVICE COMPANY

9. Well No.
11

3. Address of Operator
P. O. Box 1919 Midland, Texas 79702

10. Field and Pool, or Willist
Maljamar (G-SA)

4. Location of Well UNIT LETTER E LOCATED 1345 FEET FROM THE North LINE
AND 100 FEET FROM THE West LINE OF SEC. 29 TWP. 17S RGE. 33E NMPM

11. Field and Pool, or Willist
Maljamar (G-SA)

12. County
Lea

12. County
Lea

19. Proposed Depth
4400'

19A. Formation
Grybg - SA

20. Rotary or C.T.
Rotary

21. Elevations (show whether DF, RT, etc.)
4077' GR

22. Approx. Date Work will start
October 5, 1981

21A. Kind & Status Plug. Bond
Required/approved

21B. Drilling Contractor
Cactus Drilling Co.

PROPOSED CASING AND CEMENT PROGRAM

SIZE OF HOLE	SIZE OF CASING	WEIGHT PER FOOT	SETTING DEPTH	SACKS OF CEMENT	EST. TOP
12 1/4"	8-5/8"	32#	1300'	650	circulated
7-7/8"	5-1/2"	15.5#	3980'	2000	2400'
4-5/8"	4" (Liner)	9.5#	3700-4400'	75	3700'

It is proposed to drill this well to a T.D. of 4400' and complete in the Grayburg-San Andres formation. The blowout prevention program is as follows:

- one set of blind rams
- one set of drill pipe rams.

The acreage assigned to this well is dedicated to Phillips Petroleum Company as casinghead gas purchaser.

NSL-1430

APPROVAL VALID FOR 150 DAYS
PERMIT EXPIRES 4/9/82
UNLESS DRILLING UNDERWAY

IN ABOVE SPACE DESCRIBE PROPOSED PROGRAM: IF PROPOSAL IS TO DEEPEN OR PLUG BACK, GIVE DATA ON PRESENT PRODUCTIVE ZONE AND PROPOSED NEW PRODUCTIVE ZONE. GIVE BLOWOUT PREVENTER PROGRAM, IF ANY.

I hereby certify that the information above is true and complete to the best of my knowledge and belief.

Signed Elmer Stutz Title Reg. Operations Mgr.-Prod. Date 9-22-81

(This space for State Use)

Orig. Signed by

Jerry Sexton

APPROVED BY _____ TITLE _____ DATE _____

CONDITIONS OF APPROVAL, IF ANY:

NEW MEXICO OIL CONSERVATION COMMISSION
WELL LOCATION AND ACREAGE DEDICATION PLAT

Form C-102
Supersedes C-128
Effective 1-1-65

All distances must be from the outer boundaries of the Section.

Operator CITES SERVICE CO.		Lease SMGSAU TRACT 4		Well No. 11
Unit Letter E	Section 29	Township 17 SOUTH	Range 33 EAST	County LEA
Actual Footage Location of Well: 1345 feet from the NORTH line and 100 feet from the WEST line				
Ground Level Elev. 4076.8	Producing Formation Grayburg - San Andres	Pool Maljamar (G-SA)	Dedicated Acreage: 40 Acres	

1. Outline the acreage dedicated to the subject well by colored pencil or hachure marks on the plat below.
2. If more than one lease is dedicated to the well, outline each and identify the ownership thereof (both as to working interest and royalty).
3. If more than one lease of different ownership is dedicated to the well, have the interests of all owners been consolidated by communitization, unitization, force-pooling, etc?

Yes No If answer is "yes," type of consolidation Unitization

If answer is "no," list the owners and tract descriptions which have actually been consolidated. (Use reverse side of this form if necessary.) _____

No allowable will be assigned to the well until all interests have been consolidated (by communitization, unitization, forced-pooling, or otherwise) or until a non-standard unit, eliminating such interests, has been approved by the Commission.

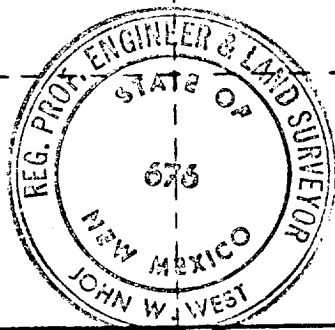
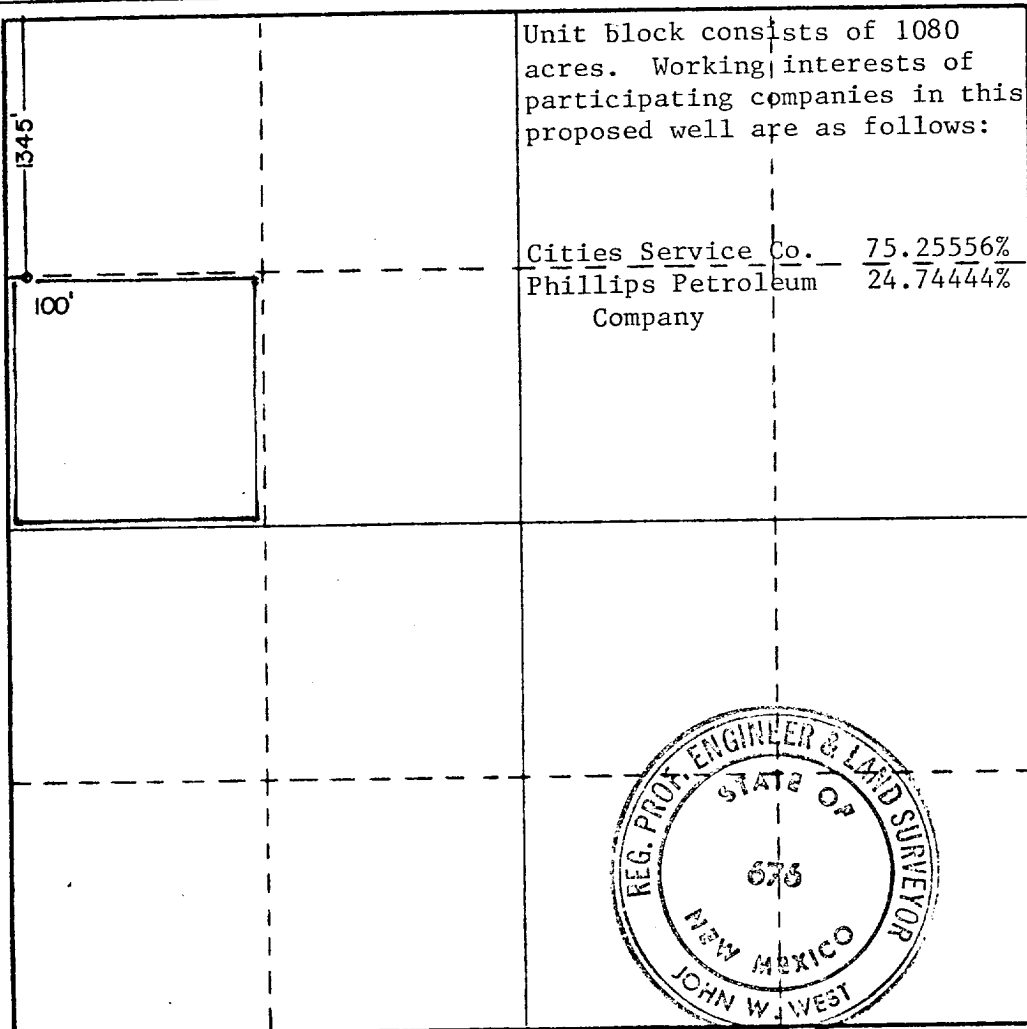

CERTIFICATION

I hereby certify that the information contained herein is true and complete to the best of my knowledge and belief.

Name Elmer Startz
Position
Region Oper. Manager-Prod.
Company
CITIES SERVICE COMPANY
Date
September 22, 1981

I hereby certify that the well location shown on this plat was plotted from field notes of actual surveys made by me or under my supervision, and that the same is true and correct to the best of my knowledge and belief.

Date Surveyed **9-15-81**
Registered Professional Engineer and/or Land Surveyor
John W. West
Certificate No. **JOHN W. WEST 676**
PATRICK A. ROMERO 6865
Ronald J. Eldon 3239

