

WATER CONSERVATION DIVISION

STATE OF NEW MEXICO
ENERGY AND MINERALS DEPARTMENT

P. O. BOX 2088
SANTA FE, NEW MEXICO 87501

Form C-102
Revised 10-1-78

All distances must be from the outer boundaries of the Section.

Operator WOODBINE PETROLEUM INC.		Lease MOBIL FEDERAL			Well No. 4
Unit Letter K	Section 21	Township 19 SOUTH	Range 32 EAST	County LEA	
Actual Footage Location of Wells 1650 feet from the WEST line and 2310 feet from the SOUTH line					
Ground Level Elev. 3585	Producing Formation DELAWARE		Pool LUSK DELAWARE, WEST	Dedicated Acreage 40 Acres	

- Outline the acreage dedicated to the subject well by colored pencil or hachure marks on the plat below.
- If more than one lease is dedicated to the well, outline each and identify the ownership thereof (both as to working interest and royalty). **One lease only.**
- If more than one lease of different ownership is dedicated to the well, have the interests of all owners been consolidated by communitization, unitization, force-pooling, etc? **One lease only.**
 Yes No If answer is "yes," type of consolidation **N/A**
 If answer is "no," list the owners and tract descriptions which have actually been consolidated. (Use reverse side of this form if necessary.) **N/A**
 No allowable will be assigned to the well until all interests have been consolidated (by communitization, unitization, forced-pooling, or otherwise) or until a non-standard unit, eliminating such interests, has been approved by the Division.

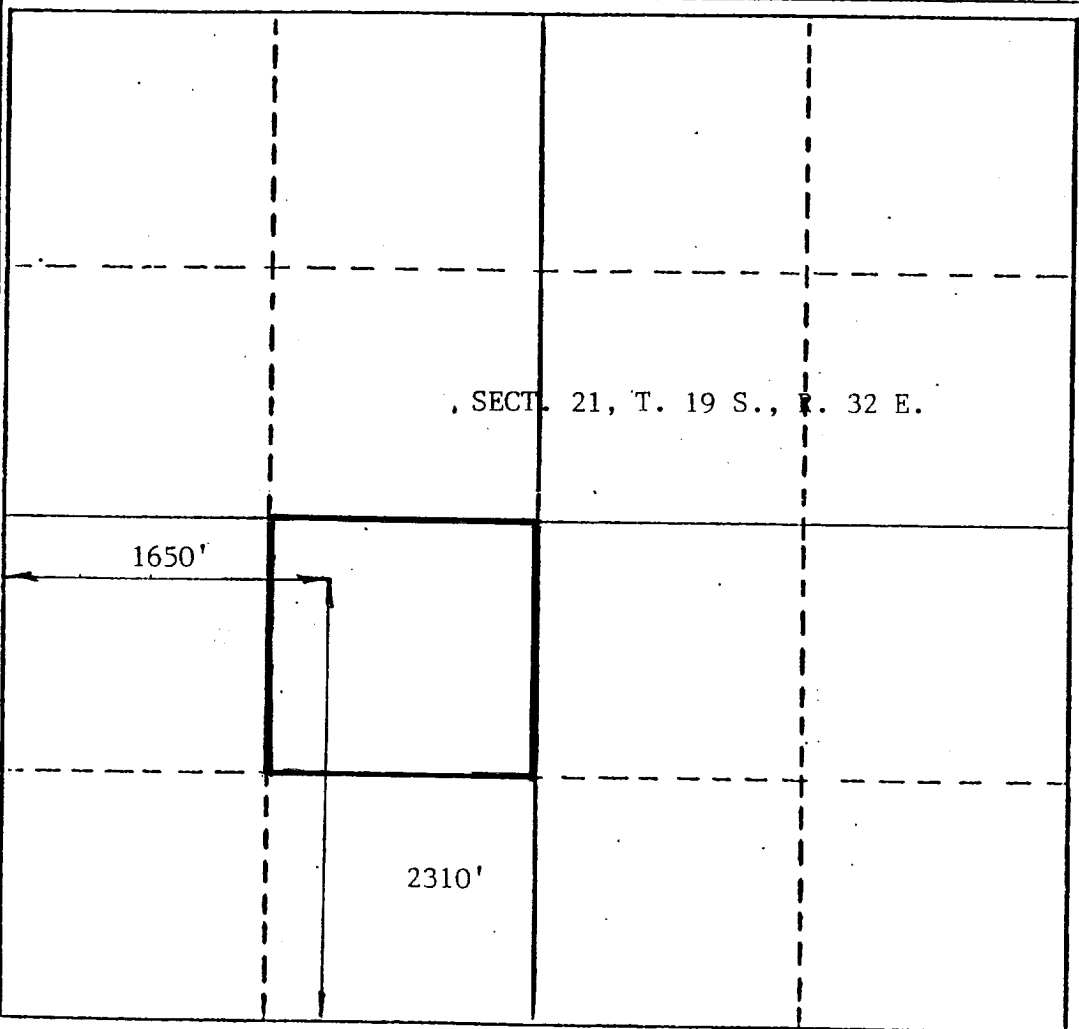

CERTIFICATION

I hereby certify that the information contained herein is true and complete to the best of my knowledge and belief.

Don G. Shackelford
Name

Don G. Shackelford
Position

Executive V. Pres.
Company

Woodbine Petroleum, Inc
Date

January 31, 1990

I hereby certify that the well location shown on this plat was plotted from field notes of actual surveys made by me or under my supervision, and that the same is true and correct to the best of my knowledge and belief.

JOHN D. JAQUES
Date Surveyed **September 19, 1989**
Registered Professional Engineer and/or Land Surveyor
John D. Jaques, P.E. & L.S.
Certificate No. **6290**

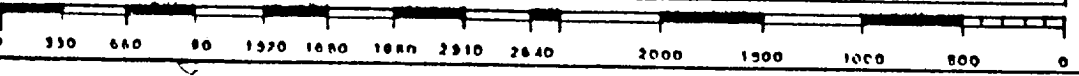

RECEIVED

FEB 7 1990

RECEIVED

FEB 7 1990

OOD

NOBBS OFFICE