

NEW MEXICO OIL CONSERVATION COMMISSION
Well Location and Acreage Dedication Plat

Form C-128
Revised 5/1/57

Section A.

Date 3-24-58

Operator Gulf Oil Corp. Lease Lea State HS
Well No. 3 Unit Letter F Section 16 Township 18 S. Range 32 E. NMPM
Located 1980 Feet From North Line, 1980 Feet From West Line
County Lea G. L. Elevation 3785.0 Dedicated Acreage 40 Acres
Name of Producing Formation Queen Pool Young

1. Is the Operator the only owner* in the dedicated acreage outlined on the plat below?
Yes No
2. If the answer to question one is "no," have the interests of all the owners been consolidated by communitization agreement or otherwise? Yes No . If answer is "yes," Type of Consolidation _____
3. If the answer to question two is "no," list all the owners and their respective interests below:

Owner Land Description

Section B

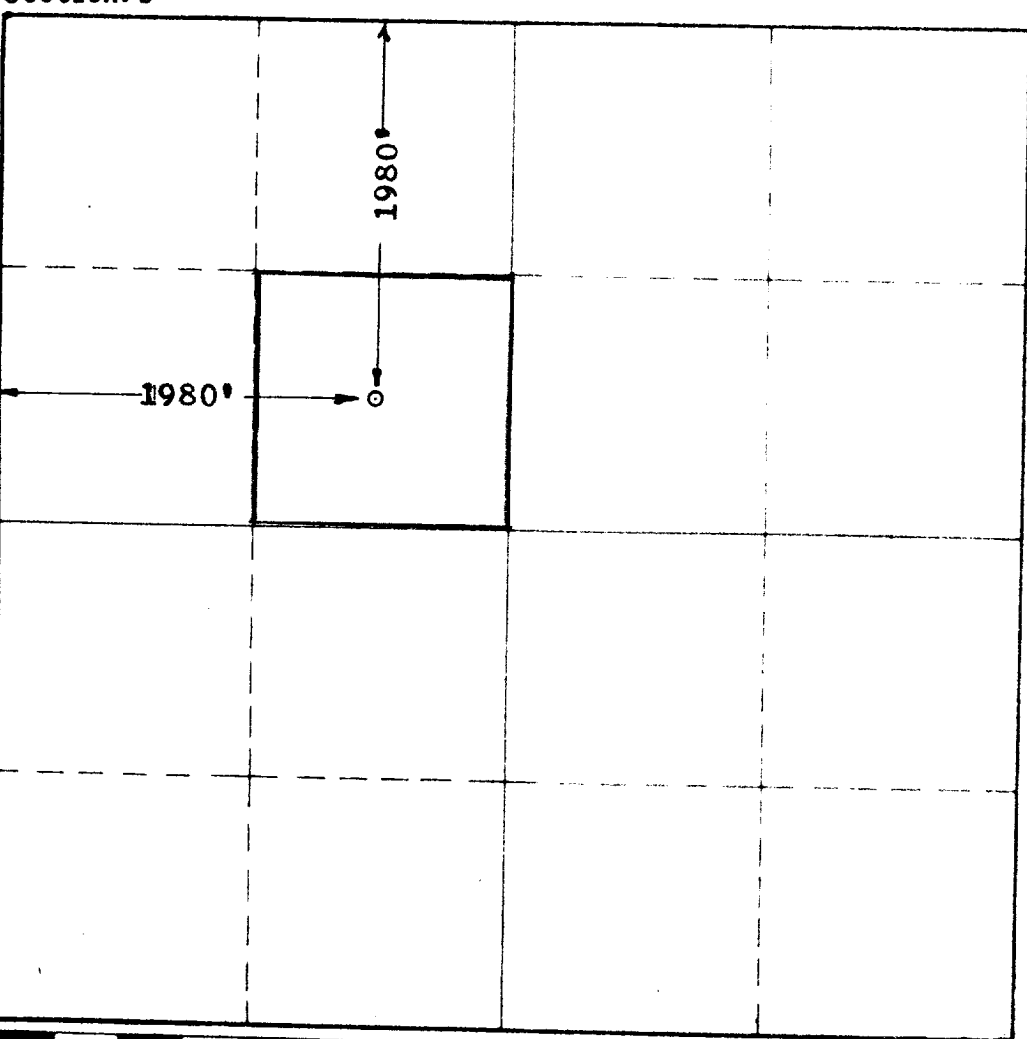

This is to certify that the information in Section A above is true and complete to the best of my knowledge and belief.

Gulf Oil Corporation
(Operator)
G. F. Taylor
(Representative)
Area Supt. of Production
Box 2167 - Hobbs, New Mexico
Address

This is to certify that the well location shown on the plat in Section B was plotted from field notes of actual surveys made by me or under my supervision and that the same is true and correct to the best of my knowledge and belief.

Date Surveyed 3-24-58
John W. West
Registered Professional
Engineer and/or Land Surveyor.

(See instructions for completing this form on the reverse side) Certificate No. 676