

NEW MEXICO OIL CONSERVATION COMMISSION  
WELL LOCATION AND ACREAGE DEDICATION PLAT

FORM C-128  
Revised 5/1/57

SEE INSTRUCTIONS FOR COMPLETING THIS FORM ON THE REVERSE SIDE <sup>Oct 26</sup> ~~THE REVERSE SIDE~~ <sup>1963</sup> ~~1963~~

SECTION A

Operator <b>FEATHERSTONE DEVELOPMENT CORP.</b>			Lease <b>T P C &amp; O- STATE</b>		Well No. <b>1</b>
Unit Letter <b>I</b>	Section <b>24</b>	Township <b>17 SOUTH</b>	Range <b>35 EAST</b>	County <b>LEA</b>	
Actual Footage Location of Well: <b>1650</b> feet from the <b>SOUTH</b> line and <b>330</b> feet from the <b>EAST</b> line					
Ground Level Elev. <b>3896.1</b>	Producing Formation <i>Alamo</i>		Pool <i>Vacuum</i>		Dedicated Acreage: <b>40</b> Acres

1. Is the Operator the only owner in the dedicated acreage outlined on the plat below? YES \_\_\_\_\_ NO \_\_\_\_\_. ("Owner" means the person who has the right to drill into and to produce from any pool and to appropriate the production either for himself or for himself and another. (65-3-29 (a) NMSA 1955 Comp.)
2. If the answer to question one is "no," have the interests of all the owners been consolidated by communization agreement or otherwise? YES \_\_\_\_\_ NO \_\_\_\_\_. If answer is "yes," Type of Consolidation \_\_\_\_\_
3. If the answer to question two is "no," list all the owners and their respective interests below:

Owner	Land Description

SECTION B

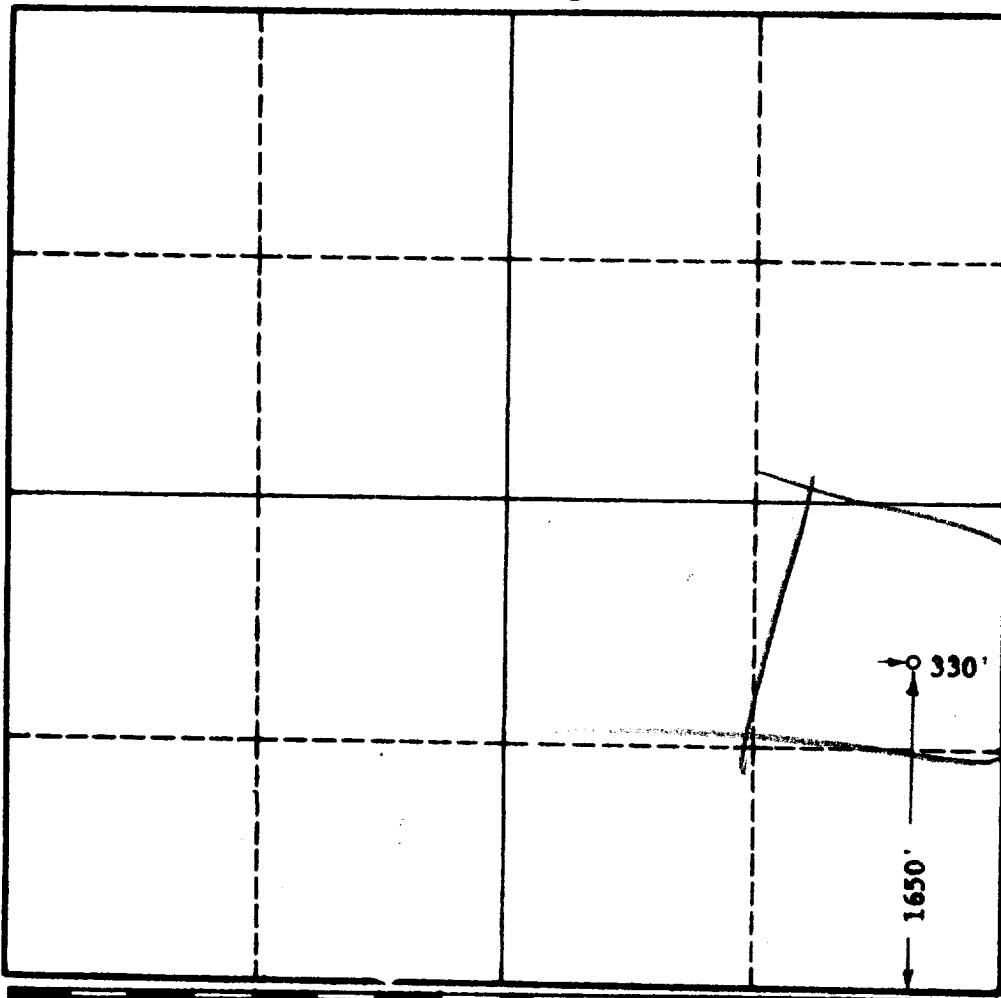

CERTIFICATION

I hereby certify that the information in SECTION A above is true and complete to the best of my knowledge and belief.

*John O'Brien*  
Name  
Geologist  
Position  
Olen F. Featherstone  
Company  
October 21, 1963  
Date

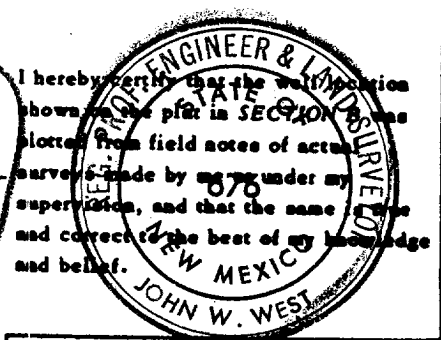

I hereby certify that the well location shown on the plat in SECTION B was plotted from field notes of actual survey made by me or under my supervision, and that the same are true and correct to the best of my knowledge and belief.

Date Surveyed  
**OCT. 18, 1963**  
Registered Professional Engineer and/or Land Surveyor, **JOHN W. WEST**  
*John W. West*  
Certificate No.  
**N. M. - P. E. & L. S. NO. 676**

173

RECEIVED

OCT 21 1961

NEW MEXICO OFFICE