

Submit to: Appropriate District Office
 State Lease - 6 copies
 Fee Lease - 5 copies

State of New Mexico
 Energy, Minerals and Natural Resources Department

Form C-101
 Revised 1-1-89

OIL CONSERVATION DIVISION
 P.O. Box 2088
 Santa Fe, New Mexico 87504-2088

DISTRICT I
 P.O. Box 1980, Hobbs, NM 88240

DISTRICT II
 P.O. Drawer DD, Artesia, NM 88210

DISTRICT III
 1000 Rio Brazos Rd., Aztec, NM 87410

API NO. (assigned by OCD on New Wells)
3E-025-32058

5. Indicate Type of Lease
 STATE FEE

6. State Oil & Gas Lease No.
 B-1404

APPLICATION FOR PERMIT TO DRILL, DEEPEN, OR PLUG BACK

1a. Type of Work:
 DRILL RE-ENTER DEEPEN PLUG BACK
 b. Type of Well:
 OR SINGLE MULTIPLE
 WELL WELL OTHER ZONE ZONE

7. Lease Name or Unit Agreement Name
 East Vacuum Gb/SA Unit

2. Name of Operator
 Phillips Petroleum Company

8. Well No. Tract 2721
 003

3. Address of Operator
 4001 Penbrook Street, Odessa, Texas 79762

9. Pool name or Wildcat
 Vacuum Gb/SA

4. Well Location
 Unit Letter N : 660 Feet From The South Line and 1415 Feet From The West Line
 Section 27 Township 17-S Range 35-E NMPM Lea County

10. Proposed Depth 4900'
 11. Formation San Andres
 12. Rotary or C.T. Rotary

13. Elevations (Show whether DF, RT, GR, etc.)
3934.3' GL
 14. Kind & Status Plug. Bond
Blanket
 15. Drilling Contractor
NA
 16. Approx. Date Work will start
Upon Approval

17. PROPOSED CASING AND CEMENT PROGRAM

SIZE OF HOLE	SIZE OF CASING	WEIGHT PER FOOT	SETTING DEPTH	SACKS OF CEMENT	EST. TOP
12-1/4"	8-5/8"	24#	1650'	1000 sx 'C'	Surface
7-7/8"	5-1/2"	15.5#	4900'	400 sx 'C'	Surface
				Tail w/ 300sx 'C'	4000'

IN ABOVE SPACE DESCRIBE PROPOSED PROGRAM: IF PROPOSAL IS TO DEEPEN OR PLUG BACK, GIVE DATA ON PRESENT PRODUCTIVE ZONE AND PROPOSED NEW PRODUCTIVE ZONE. GIVE BLOWOUT PREVENTER PROGRAM, IF ANY.

I hereby certify that the information above is true and complete to the best of my knowledge and belief.

SIGNATURE [Signature] TITLE Supv. Regulatory Affairs DATE 06-23-93
 TYPE OR PRINT NAME L. M. Sanders (915)
 TELEPHONE NO. 368-1488

(This space for State Use) ORIGINAL SIGNED BY JERRY SEXTON
 DISTRICT I SUPERVISOR

APPROVED BY _____ TITLE _____ DATE JUL 20 1993

CONDITIONS OF APPROVAL, IF ANY:

RECEIVED

JUN 22 1991

CD-408B^C
OFFICE

Submit to Appropriate
 District Office
 State Lease - 4 copies
 Fee Lease - 3 copies

State of New Mexico
 Energy, Minerals and Natural Resources Department

Form C-102
 Revised 1-1-89

OIL CONSERVATION DIVISION

P.O. Box 2088

Santa Fe, New Mexico 87504-2088

DISTRICT I

P.O. Box 1980, Hobbs, NM 88240

DISTRICT II

P.O. Drawer DD, Artesia, NM 88210

DISTRICT III

1000 Rio Brazos Rd., Aztec, NM 87410

WELL LOCATION AND ACREAGE DEDICATION PLAT

All Distances must be from the outer boundaries of the section

Operator PHILLIPS PETROLEUM CO.			Lease EAST VACUUM Gb/SA, TRACT 2721		Well No. 003
Unit Letter N	Section 27	Township 17 SOUTH	Range 35 EAST	NMPM	County LEA

Actual Footage Location of Well:
 660 feet from the SOUTH line and 1415 feet from the WEST line

Ground Level Elev. 3934.3'	Producing Formation San Andres	Pool Vacuum Gb/SA	Dedicated Acreage: 40 Acres
-------------------------------	-----------------------------------	----------------------	--------------------------------

- Outline the acreage dedicated to the subject well by colored pencil or hashure marks on the plat below.
- If more than one lease is dedicated to the well, outline each and identify the ownership thereof (both as to working interest and royalty).
- If more than one lease of different ownership is dedicated to the well, have the interest of all owners been consolidated by communitization, unitization, force-pooling, etc.?
 - Yes No If answer is "yes" type of consolidation _____

If answer is "no" list of owners and tract descriptions which have actually been consolidated. (Use reverse side of this form necessary.) _____

No allowable will be assigned to the well unit all interests have been consolidated (by communitization, unitization, forced-pooling, otherwise) or until a non-standard unit, eliminating such interest, has been approved by the Division.

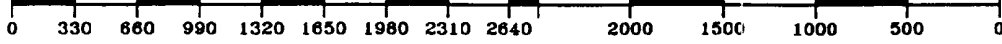
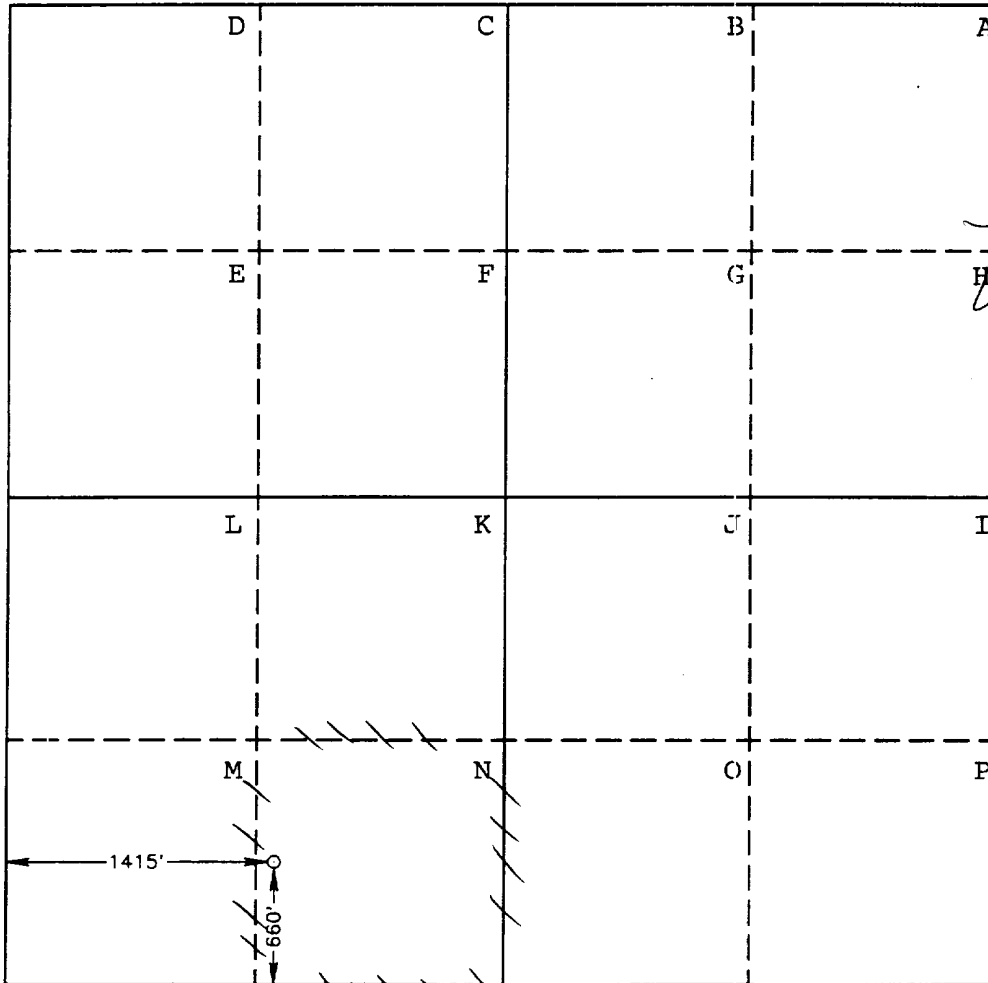

OPERATOR CERTIFICATION

I hereby certify the the information contained herein is true and complete to the best of my knowledge and belief.

Signature: *[Handwritten Signature]*

Printed Name: T. M. Sanders

Position: Supv., Reg. Affairs

Company: Phillips Petroleum Co.

Date: 6/23/93

SURVEYOR CERTIFICATION

I hereby certify that the well location shown on this plat was plotted from field notes of actual surveys made by me or under my supervision, and that the same is true and correct to the best of my knowledge and belief.

Date Surveyed: APRIL 05, 1993

Signature & Seal of Professional Surveyor: *[Handwritten Signature]*

[Professional Surveyor Seal: GARY L. JONES, NEW MEXICO]

Certificate No. JOHN W. WEST, 676
 RONALD L. REIDSON, 3239
 GARY L. JONES, 7977

6-11-8816

NSL 3283

RECEIVED

JUN 28 1993

JOHN HOBBS
OFFICE

PROPOSED CASING & CEMENTING PROGRAM

EVGSAU 2721-003

8 5/8" 24 lb/ft J-55 Surface Casing Set at 1650' - 12 1/4" Hole:

Circulate to surface with 1000 sx of Class "C" + 2% CaCl₂.

Slurry Weight:	14.8 ppg
Slurry Yield:	1.32 ft ³ /sx
Water Requirement:	6.3 gals/sx

5 1/2" 15.5 lb/ft J-55 Production Casing Set at 4900' - 7 7/8" Hole:

Lead: 400 sx Class "C" + 20% Diacel D + 3% Salt. Desired TOC = Surface.

Slurry Weight:	12.0 ppg
Slurry Yield:	2.79 ft ³ /sx
Water Requirement:	16.1 gals/sx

Tail: 300 sx Class "C" Neat. Desired TOC = 4000'.

Slurry Weight:	14.8 ppg
Slurry Yield:	1.32 ft ³ /sx
Water Requirement:	6.3 gals/sx

RECEIVED

JUN 28 1993

LIBRARY
601

PROPOSED MUD PROGRAM

EVGSAU 2721-003

DEPTH	MUD WEIGHT	VISCOSITY	FLUID LOSS	CL PPM	% SOLIDS	ADDITIVES
Surf - 1650'	8.3-9.0 ppg	28-36 sec/1000 cc	-	-	-	Native Solids
1650' - 4000'	10.0 ppg	28-32 sec/1000 cc	-	Saturated	-	Native Solids
4000' - 4900'	10.0-10.2 ppg	32-38 sec/1000 cc	20 cc or less	Saturated	-	Starch/Drispac+

RECEIVED

JUN 28 1933

CO. HONORS
DISTRICT

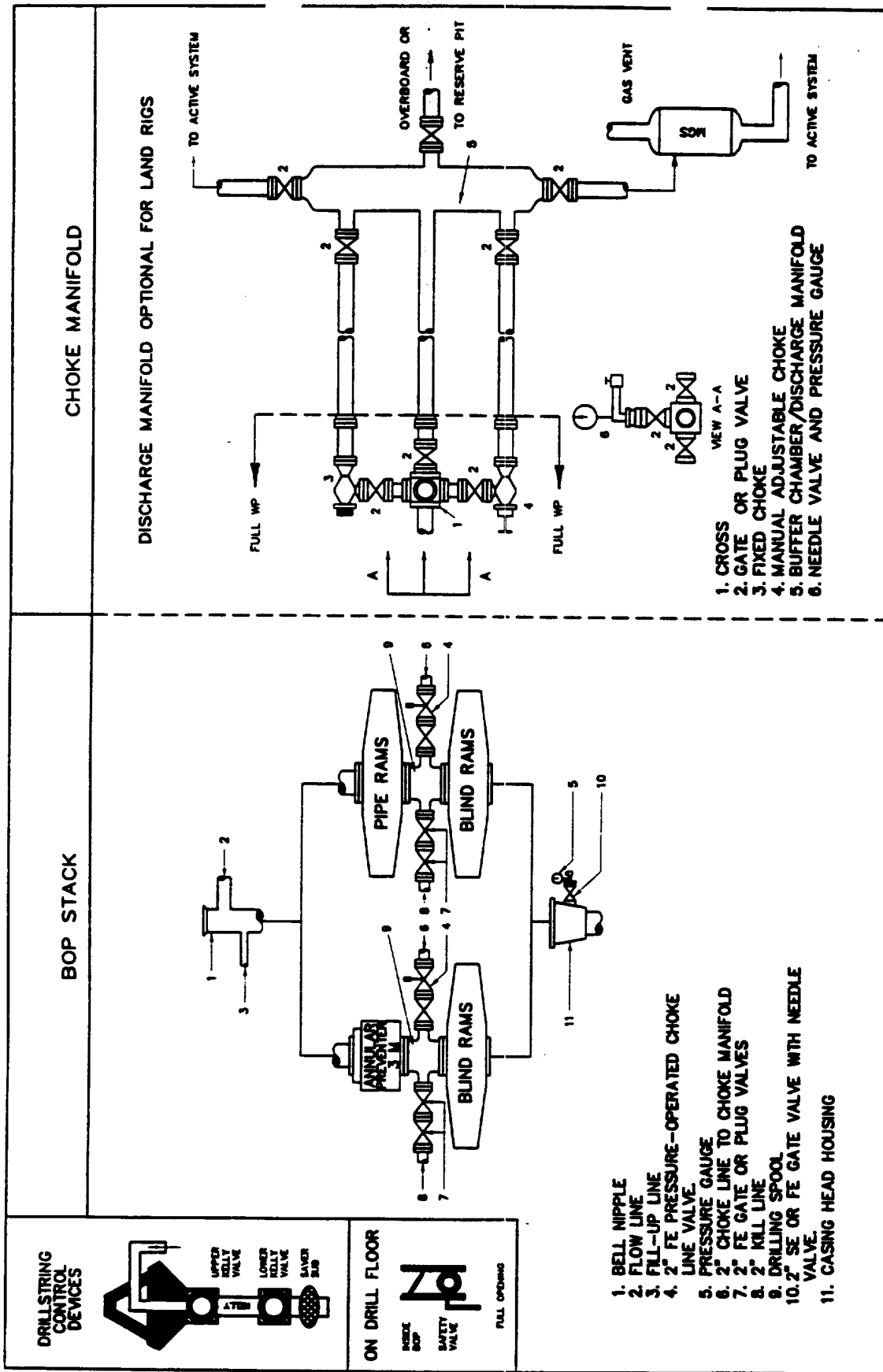

Fig. 2.4. Class 2 BOP and Choke Manifold.

RECEIVED

JUN 25 1903

U. S. DEPT. OF
AGRICULTURE

RECEIVED

JUN 28 1993

OLD HOBBBS
OFFICE