

District I
PO Box 1980, Hobbs, NM 88241-1980
District II
PO Drawer DD, Artesia, NM 88211-0719
District III
1000 Rio Brazos Rd., Aztec, NM 87410
District IV
PO Box 2088, Santa Fe, NM 87504-2088

State of New Mexico
Energy, Minerals & Natural Resources Department

OIL CONSERVATION DIVISION
PO Box 2088
Santa Fe, NM 87504-2088

Form C-101
Revised February 21, 1994
Instructions on back
Submit to Appropriate District Office
State Lease - 6 Copies
Fee Lease - 5 Copies

AMENDED REPORT

APPLICATION FOR PERMIT TO DRILL, RE-ENTER, DEEPEN, PLUGBACK, OR ADD A ZONE

¹ Operator Name and Address. SDX Resources, Inc. P. O. Box 5061 Midland, TX. 79704		¹ OGRID Number 020451
		³ API Number 30-025-33463
⁴ Property Code 009834	⁴ Property Name Northeast Pearl Queen Unit	⁴ Well No. 24

⁷ Surface Location

UL or lot no.	Section	Township	Range	Lot Idn	Feet from the	North/South line	Feet from the	East/West line	County
F	23	19S	35E		2310	North	1500	West	Lea

⁸ Proposed Bottom Hole Location If Different From Surface

UL or lot no.	Section	Township	Range	Lot Idn	Feet from the	North/South line	Feet from the	East/West line	County
⁹ Proposed Pool 1 Pearl; Queen					¹⁰ Proposed Pool 2				

¹¹ Work Type Code N	¹¹ Well Type Code 0	¹² Cable/Rotary Rotary	¹⁴ Lease Type Code S	¹⁵ Ground Level Elevation 3768'
¹⁶ Multiple No	¹⁷ Proposed Depth 5000'	¹⁸ Formation Queen	¹⁹ Contractor Rod-Ric Drlg Co.	²⁰ Spud Date 6/01/96

²¹ Proposed Casing and Cement Program

Hole Size	Casing Size	Casing weight/foot	Setting Depth	Sacks of Cement	Estimated TOC
12-1/4"	8-5/8"	24	350'	350 sxs C1 C	Surf.
7-7/8"	5-1/2"	14#	5000'	350 sxs Poz + 400 sxs Lite	Surf.

²² Describe the proposed program. If this application is to DEEPEN or PLUG BACK give the data on the present productive zone and proposed new productive zone. Describe the blowout prevention program, if any. Use additional sheets if necessary.

Plan to drill a 12-1/4" hole to approximately 350' and set 8-5/8" surface casing at 350'. Circulate C1 C cement. Drill 7-7/8" hole to total depth. Run logs. Run 5-1/2" casing and circulate cement. Perferate the Queen formation and stimulate as necessary for optimum production.

Regular location by OCD Order No. R-10533.

Permit Expires 1 Year From Approval
Date Unless Drilling Underway

²³ I hereby certify that the information given above is true and complete to the best of my knowledge and belief.		OIL CONSERVATION DIVISION	
Signature: <i>Janice Courtney</i>			
Printed name: Janice Courtney		Approved by: ORIGINAL SIGNED BY JERRY SEXTON DISTRICT I SUPERVISOR	
Title: Regulatory Tech		Title:	
Date: 5/20/96		Approval Date: MAY 23 1996	Expiration Date:
Phone: 915/685-1761		Conditions of Approval: Attached <input type="checkbox"/>	

District I
 PO Box 1980, Hobbs, NM 88241-1980
 District II
 PO Drawer DD, Artesia, NM 88211-0719
 District III
 1000 Rio Brazos Rd., Aztec, NM 87410
 District IV
 PO Box 2088, Santa Fe, NM 87504-2088

State of New Mexico
 Energy, Minerals & Natural Resources Department

OIL CONSERVATION DIVISION
 PO Box 2088
 Santa Fe, NM 87504-2088

Form C-102
 Revised February 10, 1994
 Instructions on back
 Submit to Appropriate District Office
 State Lease - 4 Copies
 Fee Lease - 3 Copies

AMENDED REPORT

WELL LOCATION AND ACREAGE DEDICATION PLAT

¹ API Number 30-025-33463		² Pool Code 49780	³ Pool Name Pearl;Queen
⁴ Property Code 009834	⁵ Property Name NE PEARL QUEEN UNIT		⁶ Well Number 24
⁷ OGRID No. 020451	⁸ Operator Name SDX RESOURCES, INC.		⁹ Elevation 3768.

¹⁰ Surface Location

UL or lot no.	Section	Township	Range	Lot Idn	Feet from the	North/South line	Feet from the	East/West line	County
F	23	19-S	35-E		2310	NORTH	1500	WEST	LEA

¹¹ Bottom Hole Location If Different From Surface

UL or lot no.	Section	Township	Range	Lot Idn	Feet from the	North/South line	Feet from the	East/West line	County
40									

¹² Dedicated Acres 40	¹³ Joint or Infill	¹⁴ Consolidation Code	¹⁵ Order No.
-------------------------------------	-------------------------------	----------------------------------	-------------------------

NO ALLOWABLE WILL BE ASSIGNED TO THIS COMPLETION UNTIL ALL INTERESTS HAVE BEEN CONSOLIDATED OR A NON-STANDARD UNIT HAS BEEN APPROVED BY THE DIVISION

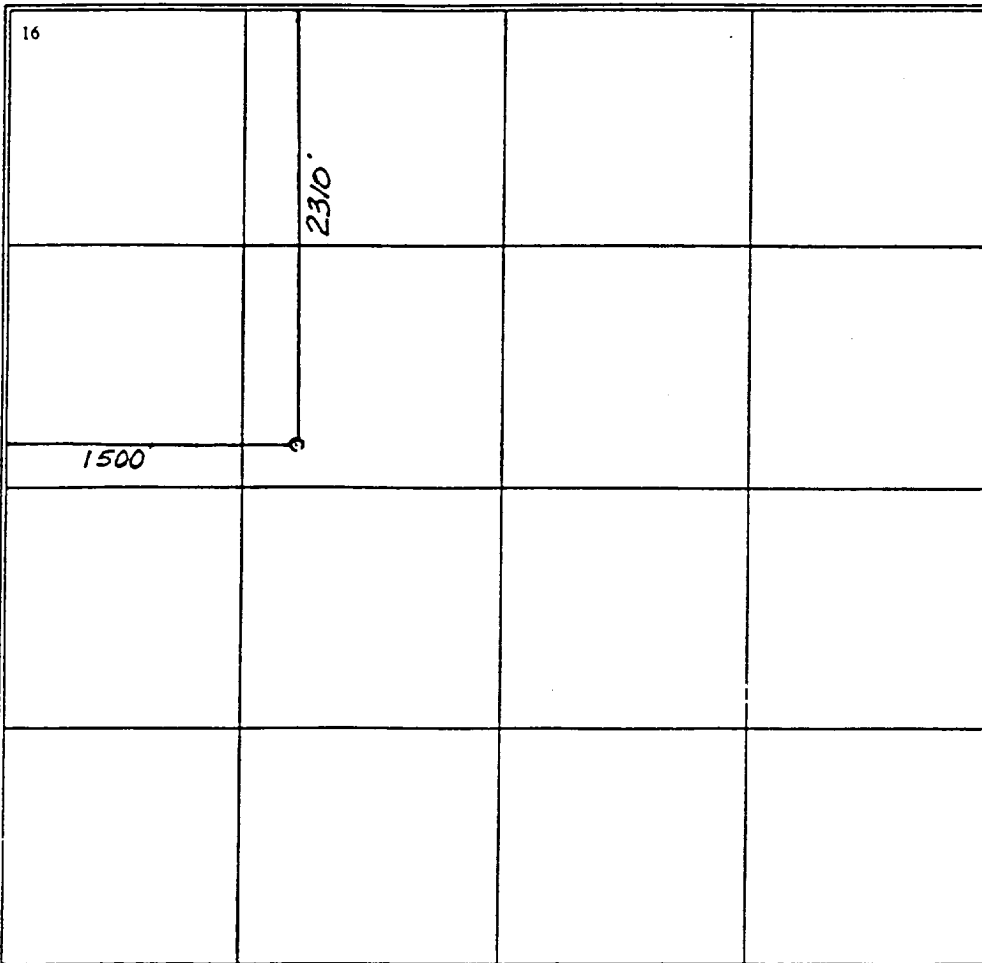

¹⁷ OPERATOR CERTIFICATION

I hereby certify that the information contained herein is true and complete to the best of my knowledge and belief

Janice Courtney
 Signature
 Janice Courtney
 Printed Name
 Regulatory Tech.
 Title
 5/20/96
 Date

¹⁸ SURVEYOR CERTIFICATION

I hereby certify that the well location shown on this plat was plotted from field notes of actual surveys made by me or under my supervision, and that the same is true and correct to the best of my belief.

MAY 14, 1996
 Date of Survey
 Signature and Seal of Professional Surveyor:

 Certificate Number: NM PR 5412

BLOWOUT PREVENTER
DIAGRAM

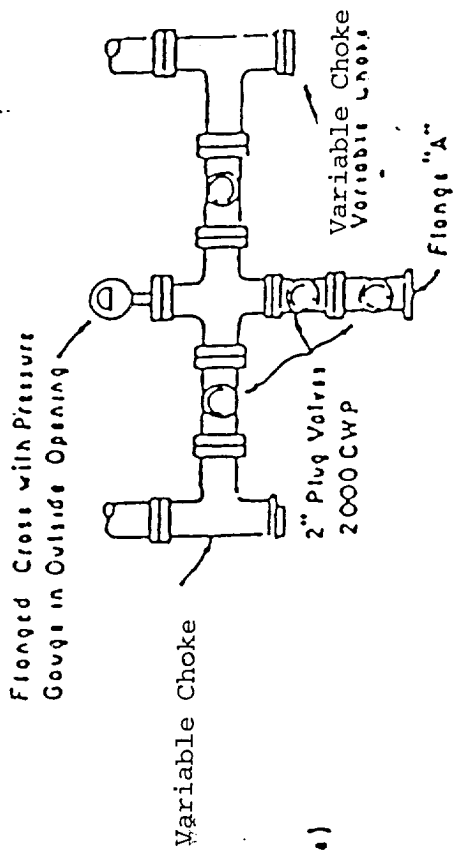
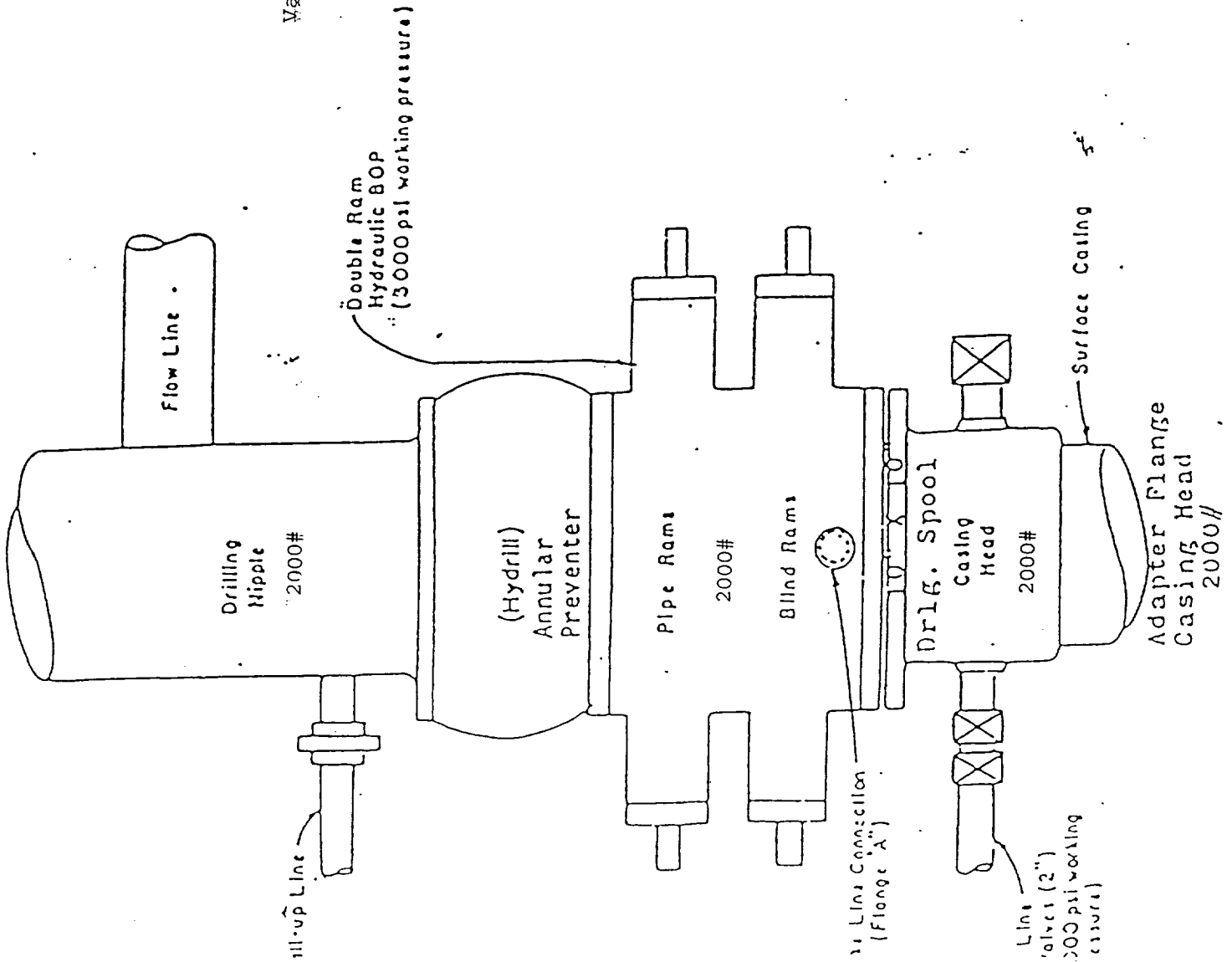

PLAN VIEW - CHOKE MANIFOLD