

District I
 PO Box 1980, Hobbs, NM 88241-1980
 District II
 PO Drawer DD, Artesia, NM 88211-0719
 District III
 1000 Rio Brazos Rd., Aztec, NM 87410
 District IV
 PO Box 2088, Santa Fe, NM 87504-2088

State of New Mexico
 Energy, Minerals & Natural Resources Department

OIL CONSERVATION DIVISION
 PO Box 2088
 Santa Fe, NM 87504-2088

Form C-101
 Revised February 10, 1994
 Instructions on back
 Submit to Appropriate District Office
 State Lease - 6 Copies
 Fee Lease - 5 Copies

AMENDED REPORT

APPLICATION FOR PERMIT TO DRILL, RE-ENTER, DEEPEN, PLUGBACK, OR ADD A ZONE

Operator Name and Address. Altura Energy LTD P.O. Box 4294 Houston, Texas 77210-4294		OGRID Number 157984
		API Number 30-025-34226
Property Code 22159	Property Name Hoover SW 32	Well No. 1

Surface Location

UL or lot no.	Section	Township	Range	Lot Idn	Feet from the	North/South line	Feet from the	East/West line	County
G	32	17-S	34-E		1650	North	1930	East	Lea

Proposed Bottom Hole Location If Different From Surface

UL or lot no.	Section	Township	Range	Lot Idn	Feet from the	North/South line	Feet from the	East/West line	County
Proposed Pool 1 Drinkard - Wildcat					Proposed Pool 2 Tubb - Wildcat North Vacuum - Abo Blinbry - Wildcat				

Work Type Code N	Well Type Code O	Cable/Rotary R	Lease Type Code S	Ground Level Elevation 4071'
Multiple N	Proposed Depth 9000'	Formation Drinkard	Contractor Norton	Spud Date 12/15/97

Proposed Casing and Cement Program

Hole Size	Casing Size	Casing weight/foot	Setting Depth	Sacks of Cement	Estimated TOC
24"	20"	Conductor	40'	50 sx.	Surface
12-1/4"	8-5/8"	24	1725'	1050 sx.	Surface
7-7/8"	5-1/2"	17	9000'	4500 sx.	3300' from surface

Describe the proposed program. If this application is to DEEPEN or PLUG BACK give the data on the present productive zone and proposed new productive zone. Describe the blowout prevention program, if any. Use additional sheets if necessary.

See attached for proposed drilling program

BOP Program 3000# Ram Preventer

Permit Expires 1 Year From Approval
 Date Unless Drilling Underway

I hereby certify that the information given above is true and complete to the best of my knowledge and belief. Signature: <i>Mark Stephens</i>		OIL CONSERVATION DIVISION	
Printed name: Mark Stephens		Approved by: <i>CHAS WILLIAMS</i> DISTRICT I SUPERVISOR	
Title: Business Analyst (SG)		Approval Date: 30-10-1997	Expiration Date:
Date: 12/5/97	Phone: (281) 552-1158	Conditions of Approval: Attached <input type="checkbox"/>	

5
2
3

2
mrp

C-101 Instructions

Measurements and dimensions are to be in feet/inches. Well locations will refer to the New Mexico Principal Meridian.

IF THIS IS AN AMENDED REPORT CHECK THE BOX LABELED "AMENDED REPORT" AT THE TOP OF THIS DOCUMENT.

- | | |
|--|---|
| <p>1 Operator's OGRID number. If you do not have one it will be assigned and filled in by the District office.</p> <p>2 Operator's name and address</p> <p>3 API number of this well. If this is a new drill the OCD will assign the number and fill this in.</p> <p>4 Property code. If this is a new property the OCD will assign the number and fill it in.</p> <p>5 Property name that used to be called 'well name'</p> <p>6 The number of this well on the property.</p> <p>7 The surveyed location of this well New Mexico Principal Meridian NOTE: If the United States government survey designates a Lot Number for this location use that number in the 'UL or lot no.' box. Otherwise use the OCD Unit Letter.</p> <p>8 The proposed bottom hole location of this well at TD</p> <p>9 and 10 The proposed pool(s) to which this well is being drilled.</p> <p>11 Work type code from the following table:
 N New well
 E Re-entry
 D Drill deeper
 P Plugback
 A Add a zone</p> <p>12 Well type code from the following table:
 O Single oil completion
 G Single gas completion
 M Multiple completion
 I Injection well
 S SWD well
 W Water supply well
 C Carbon dioxide well</p> <p>13 Cable or rotary drilling code
 C Propose to cable tool drill
 R Propose to rotary drill</p> <p>14 Lease type code from the following table:
 F Federal
 S State
 P Private
 N Navajo
 J Jicarilla
 U Ute
 I Other Indian tribe</p> <p>15 Ground level elevation above sea level</p> <p>16 Intend to multiple complete? Yes or No</p> <p>17 Proposed total depth of this well</p> | <p>18 Geologic formation and TD</p> <p>19 Name of the intended drilling company if known.</p> <p>20 Anticipated start date</p> <p>21 Proposed hole size 10 inches, proposed casing OD inches, casing weight in pounds per foot, setting depth of the casing or depth and top of liner, proposed cementing volume, and estimate of top of cement</p> <p>22 Brief description of the proposed drilling program and BOP program. Attach additional sheets if necessary.</p> <p>23 The signature, printed name, and title of the person authorized to make this report. The date this report was signed and the telephone number to call for questions about this report.</p> |
|--|---|

Proposed Drilling Program
Hoover SW 32 Well No. 1
Lea County, New Mexico

20" Conductor should be set at 40' before moving on location. A 12-1/4" hole will be drilled from surface to approximately 1725' or 25' into the Rustler, whichever is deeper. A full string of 8-5/8", 24#, J-55 surface casing will be run to approximately 1725' with cement circulated to surface. After casing is run and cemented, weld on wellhead. Wait on cement for 12 hours and test casing to 1000 psi and the BOPs to their rating prior to drilling out.

A 7-7/8" hole will be drilled out from surface casing point (approx. 1725') to a total depth of 9000'. A full string of 5-1/2", 17# , K-55 casing will be run to TD. The casing will be cemented in two stages with TOC calculated to 3300' from surface.

DISTRICT I
P.O. Box 1980, Hobbs, NM 88241-1980

State of New Mexico
Energy, Minerals and Natural Resources Department

Form C-102
Revised February 10, 1994
Submit to Appropriate District Office
State Lease - 4 Copies
Fee Lease - 3 Copies

DISTRICT II
P.O. Drawer DD, Artesia, NM 88211-0719

DISTRICT III
1000 Rio Brazos Rd., Aztec, NM 87410

OIL CONSERVATION DIVISION
P.O. Box 2088
Santa Fe, New Mexico 87504-2088

DISTRICT IV
P.O. BOX 2088, SANTA FE, N.M. 87504-2088

AMENDED REPORT

WELL LOCATION AND ACREAGE DEDICATION PLAT

API Number 30-025-34236	Pool Code 61760	Pool Name Vacuum #003, V. Drinkard - Wildeat
Property Code 22159	Property Name HOOVER SW 32	Well Number 1
OGRID No. 157984	Operator Name ALTURA ENERGY LTD.	Elevation 4071'

Surface Location

UL or lot No.	Section	Township	Range	Lot Idn	Feet from the	North/South line	Feet from the	East/West line	County
G	32	17-S	34-E		1650	NORTH	1930	EAST	LEA

Bottom Hole Location If Different From Surface

UL or lot No.	Section	Township	Range	Lot Idn	Feet from the	North/South line	Feet from the	East/West line	County

Dedicated Acres	Joint or Infill	Consolidation Code	Order No.
40			

NO ALLOWABLE WILL BE ASSIGNED TO THIS COMPLETION UNTIL ALL INTERESTS HAVE BEEN CONSOLIDATED OR A NON-STANDARD UNIT HAS BEEN APPROVED BY THE DIVISION

	<p>OPERATOR CERTIFICATION</p> <p>I hereby certify the the information contained herein is true and complete to the best of my knowledge and belief.</p> <p><i>Mark Stephens</i> Signature</p> <p>Mark Stephens Printed Name</p> <p>Business Analyst (SG) Title</p> <p>December 8, 1997 Date</p>	
	<p>SURVEYOR CERTIFICATION</p> <p>I hereby certify that the well location shown on this plat was plotted from field notes of actual surveys made by me or under my supervision and that the same is true and correct to the best of my belief.</p> <p>NOVEMBER 25, 1997 Date Surveyed</p> <p>Signature & Seal of Professional Surveyor <i>Ronald J. Eldson</i></p> <p>Certificate No. RONALD J. ELDSON 3239 GARY ANDERSON 12641</p>	

VICINITY MAP

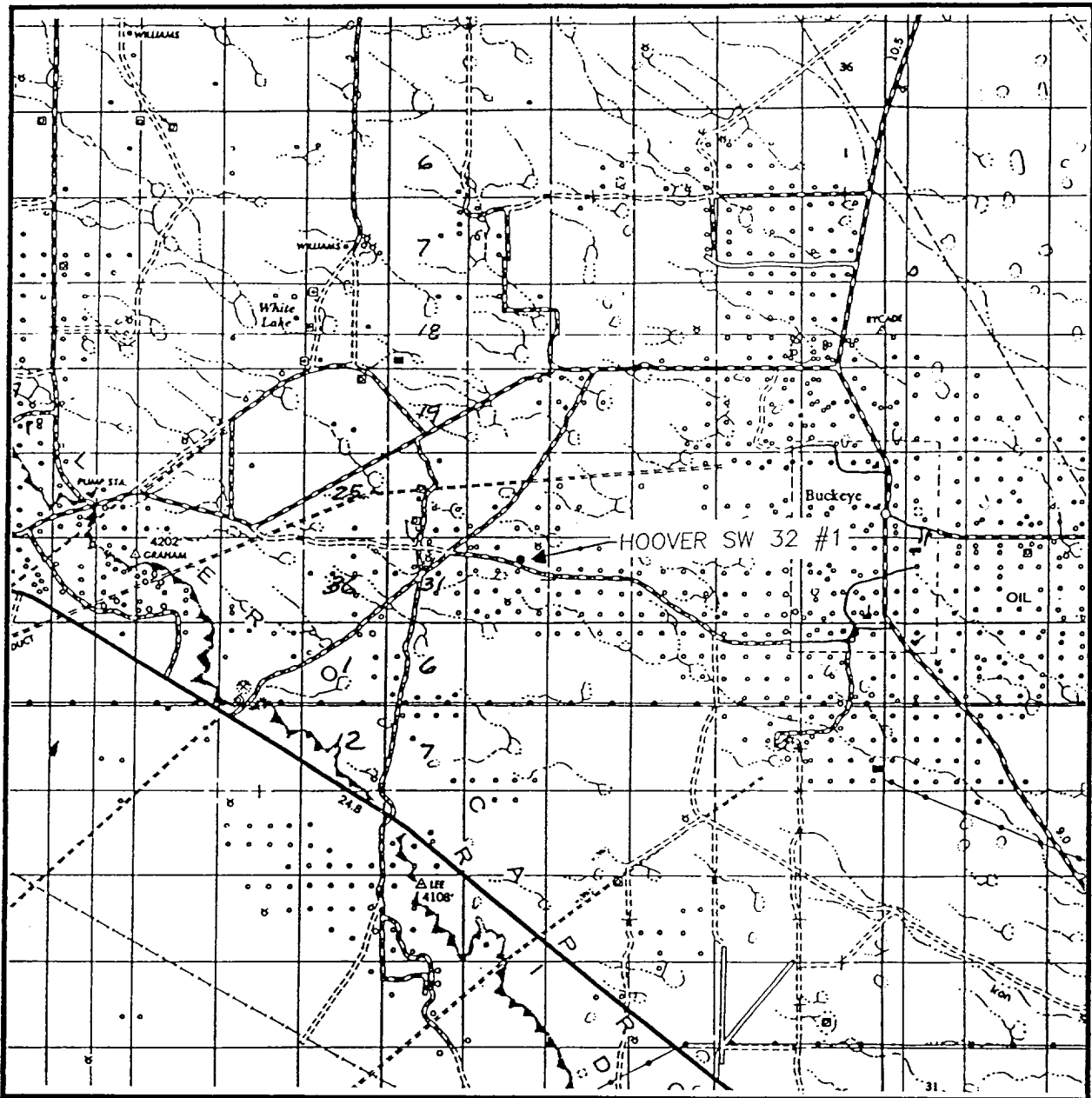

SCALE: 1" = 2 MILES

SEC. 32 TWP. 17-S RGE. 34-E
 SURVEY N.M.P.M.
 COUNTY LEA
 DESCRIPTION 1650' FNL & 1930' FEL
 ELEVATION 4071'
 OPERATOR ALTURA ENERGY LTD.
 LEASE HOOVER SW 32

JOHN WEST ENGINEERING
HOBBS, NEW MEXICO
(505) 393-3117

LOCATION VERIFICATION MAP

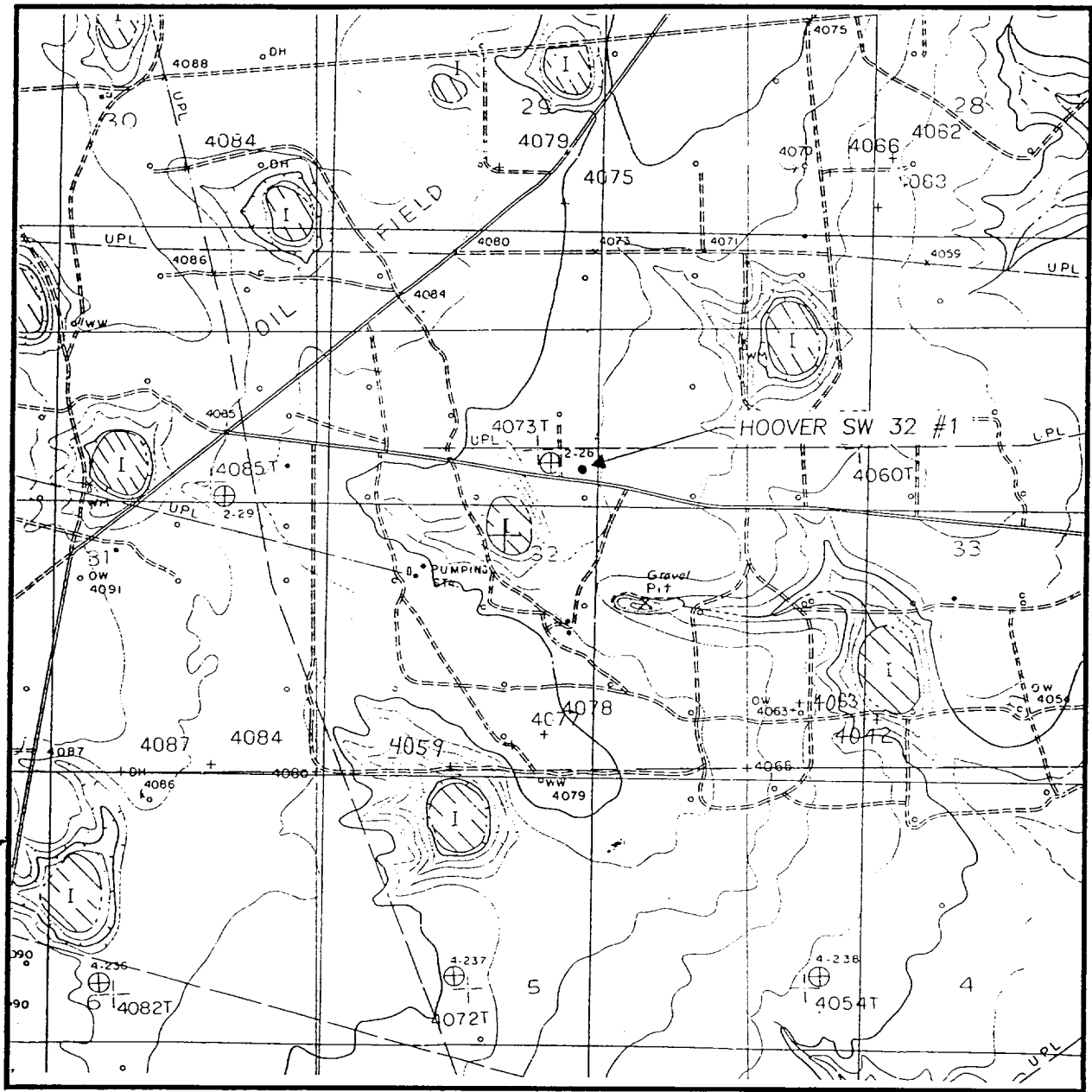

SCALE: 1" = 2000'

CONTOUR INTERVAL
BUCKEYE - 5'

SEC. 32 TWP. 17-S RGE. 34-E

SURVEY _____ N.M.P.M.

COUNTY _____ LEA

DESCRIPTION 1650' FNL & 1930' FEL

ELEVATION _____ 4071'

OPERATOR ALTURA ENERGY LTD.

LEASE _____ HOOPER SW 32

U.S.G.S. TOPOGRAPHIC MAP
BUCKEYE, NM

JOHN WEST ENGINEERING
HOBBS, NEW MEXICO
(505) 393-3117