

NEW MEXICO  
OIL CONSERVATION COMMISSION

Form C-128

**DUPLICATE**

Well Location and/or Gas Proration Plat

Date May 18, 1956

Operator The Texas Company Lease No. 65611 Z. A. McMillan "A"

Well No. 2 Section 3 Township 19 South Range 37 East NMPM

Located 660 Feet From South Line, 660 Feet From West Line,

Lea County, New Mexico. G. L. Elevation 3665.0

Name of Producing Formation Queen Sand Pool Dumont Dedicated Acreage 40

(Note: All distances must be from outer boundaries of Section)

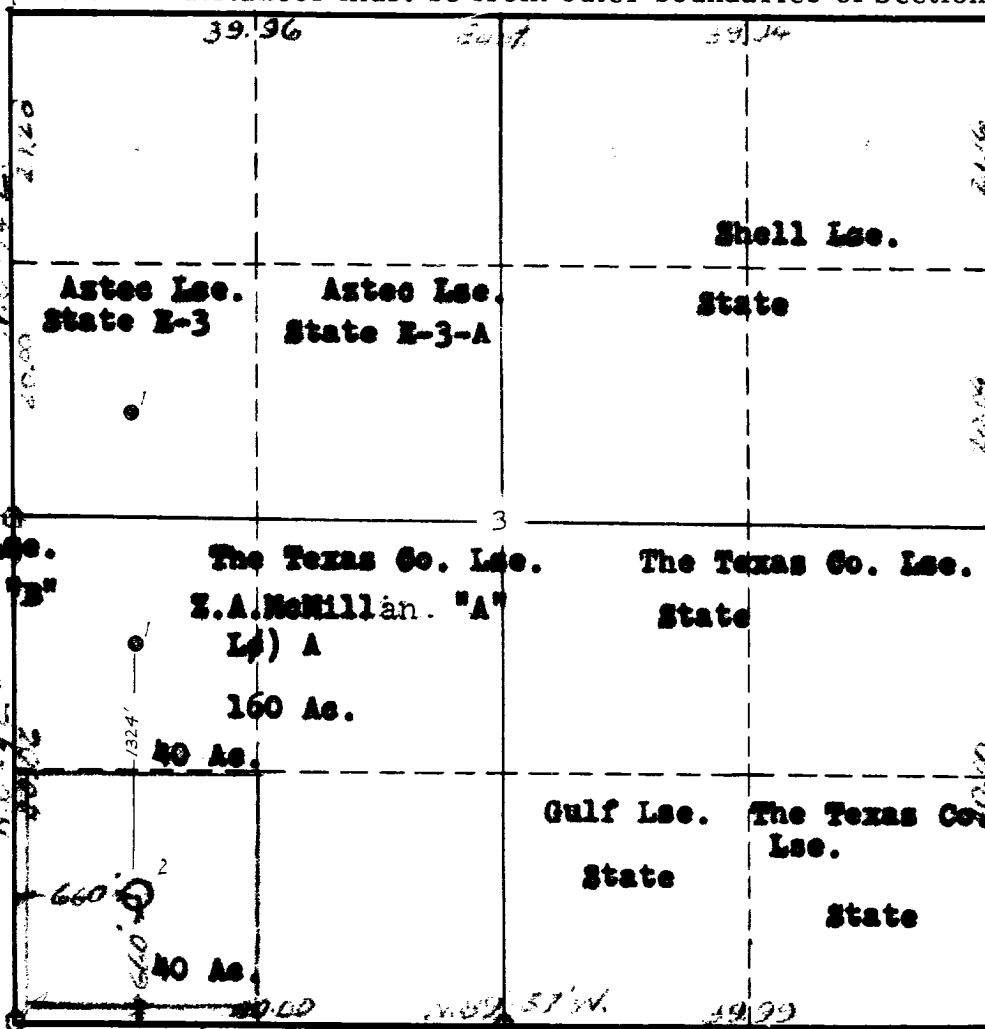

LEGEND:  
Q - G. L. O.  
Brass Cap

The Texas Co. Lse.  
Z.A. McMillan "B"

The Texas Co. Lse.  
Z.A. McMillan "A"  
160 Ac.

The Texas Co. Lse.  
State

Gulf Lse. State  
The Texas Co. Lse. State

NOTE

This section of form is to be used for gas wells only.

1. Is this Well a Dual Comp. ? Yes      No     .
2. If the answer to Question 1 is yes, are there any other dually completed wells within the dedicated acreage? Yes      No     .

Name \_\_\_\_\_  
Position \_\_\_\_\_  
Representing \_\_\_\_\_  
Address \_\_\_\_\_

This is to certify that the above plat was prepared from field notes of actual surveys made by me or under my supervision and that the same are true and correct to the best of my knowledge and belief.

Date Surveyed May 18, 1956  
John W. Shuman  
Registered Professional Engineer and/or  
Land Surveyor License No. 1559