

District I
PO Box 1988, Hobbs, NM 88241-1988
District II
811 S. 1st Street, Artesia, NM 88210-2834
District III
1000 Rio Bravo Rd., Aztec, NM 87410
District IV
PO Box 2088, Santa Fe, NM 87504-2088

OIL CONSERVATION DIVISION
P.O. Box 2088
Santa Fe, NM 87504-2088

AMENDED REPORT

APPLICATION FOR PERMIT TO DRILL, RE-ENTER, DEEPEN, PLUGBACK, OR ADD A ZONE

¹ Operator name and Address Chevron U.S.A. Inc. P.O. Box 1150 Midland, TX 79702		² OGRID Number 4323
⁴ Property Code 002565	³ Property Name THEODORE ANDERSON	³ API Number 30-0 25-33236
		⁶ Well Number 10

⁷ Surface Location									
UL or lot no.	Section	Township	Range	Lot. Idn	Feet from the	North/South Line	Feet from the	East/West line	County
P	8	20-S	37-E		990	SOUTH	515	EAST	LEA

⁸ Proposed Bottom Hole Location If Different From Surface									
UL or lot no.	Section	Township	Range	Lot. Idn	Feet from the	North/South Line	Feet from the	East/West line	County

⁹ Proposed Pool 1 WEIR-BLINEBRY	¹⁰ Proposed Pool 2
---	-------------------------------

¹¹ Work Type Code N	¹² Well Type Code O	¹³ Cable/Rotary ROTARY	¹⁴ Lease Type Code S	¹⁵ Ground Level Elevation 3534'
¹⁶ Multiple NO	¹⁷ Proposed Depth 7200	¹⁸ Formations BLINEBRY/TUBB	¹⁹ Contractor UNKNOWN	²⁰ Spud Date 01-01-96

²¹ Proposed Casing and Cement Program					
Hole Size	Casing Size	Casing weight/foot	Setting Depth	Sacks of Cement	Estimated TOC
12 1/4	8 5/8	24	1150'	1200	SURFACE
7 7/8	5 1/2	15.5	7200	1000	

²² Describe the proposed program. If this application is to DEEPEN or PLUG BACK give the data on the present productive zone and proposed new productive zone. Describe the blowout prevention program, if any. Use additional sheets if necessary.

CHEVRON PROPOSES TO:
DRILL WITH 12 1/4" BIT TO 1150', RUN 8 5/8" CSG. CMT WITH CLASS "C" TO SURFACE.
NIPPLE UP BOPE & TEST. DRILL WITH 7 7/8" BIT TO 7200', RUN 5 1/2" CSG., CMT WITH CLASS "C".

MUD PROGRAM: SURFACE HOLE: 0' - 1150', FRESH WATER 8.4-9.2 PPG.
PRODUCTION HOLE: 1150' - 7200', BRINE WATER 10.0 PPG.

BOPE: SEE ATTACHED CHEVRON CLASS II BOPE.

*****PLEASE EXPEDITE*****

Permit Expires 6 Months From Approval Date Unless Drilling Underway.

²³ I hereby certify that the information given above is true and complete to the best of my knowledge and belief. Signature: <i>Wendi Kingston</i>	OIL CONSERVATION DIVISION	
Printed name: WENDI KINGSTON	Approved by: <i>Jerry Sexton</i>	SIGNED BY JERRY SEXTON DISTRICT SUPERVISOR
Title: DRILLING TECH.	Title:	
Date: 12/21/95	Approval Date: DEC 26 1995	Expiration Date:
Phone: (915) 687-7826	Conditions of Approval:	Attached <input type="checkbox"/>

DISTRICT I
P.O. Box 1980, Hobbs, NM 88241-1980

State of New Mexico
Energy, Minerals and Natural Resources Department

Form C-102
Revised February 10, 1994
Submit to Appropriate District Office
State Lease - 4 Copies
Fee Lease - 3 Copies

DISTRICT II
P.O. Drawer DD, Artesia, NM 88211-0719

DISTRICT III
1000 Rio Brazos Rd., Aztec, NM 87410

OIL CONSERVATION DIVISION

P.O. Box 2088
Santa Fe, New Mexico 87504-2088

DISTRICT IV
P.O. BOX 2088, SANTA FE, N.M. 87504-2088

AMENDED REPORT

WELL LOCATION AND ACREAGE DEDICATION PLAT

API Number 30025-33236	Pool Code 63780	Pool Name Weir-Blinebry
Property Code 002565	Property Name THEODORE ANDERSON	Well Number 10
OGRID No. 4323	Operator Name CHEVRON U.S.A. INC.	Elevation 3534

Surface Location

UL or lot No.	Section	Township	Range	Lot Idn	Feet from the	North/South line	Feet from the	East/West line	County
2	8	20 S	37 E		990	SOUTH	515'	EAST	LEA

Bottom Hole Location If Different From Surface

UL or lot No.	Section	Township	Range	Lot Idn	Feet from the	North/South line	Feet from the	East/West line	County

Dedicated Acres 45	Joint or Infill	Consolidation Code	Order No.
-----------------------	-----------------	--------------------	-----------

NO ALLOWABLE WILL BE ASSIGNED TO THIS COMPLETION UNTIL ALL INTERESTS HAVE BEEN CONSOLIDATED OR A NON-STANDARD UNIT HAS BEEN APPROVED BY THE DIVISION

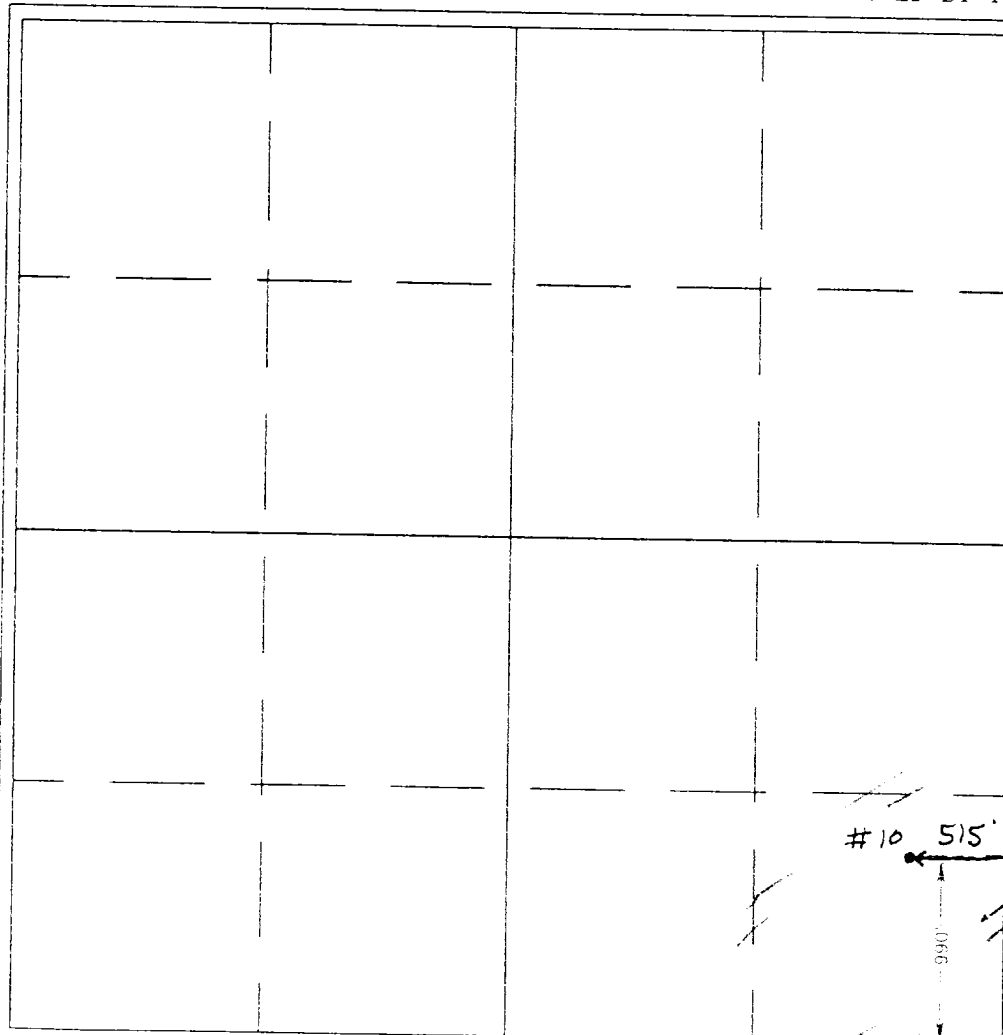

OPERATOR CERTIFICATION

I hereby certify the the information contained herein is true and complete to the best of my knowledge and belief.

Wendi Kingston
Signature

Wendi Kingston
Printed Name

T.A.
Title

12/21/95
Date

SURVEYOR CERTIFICATION

I hereby certify that the well location shown on this plat was plotted from field notes of actual surveys made by me or under my supervision, and that the same is true and correct to the best of my belief.

NOVEMBER 2, 1995
Date Surveyed

John West
Signature & Seal
Professional Surveyor

NEW MEXICO
Professional Surveyor
11-07-95
P.O. Box 95-1722

Certificate No. JOHN WEST 676
EDSON 3236
EDSON 1264

LOCATION VERIFICATION MAP

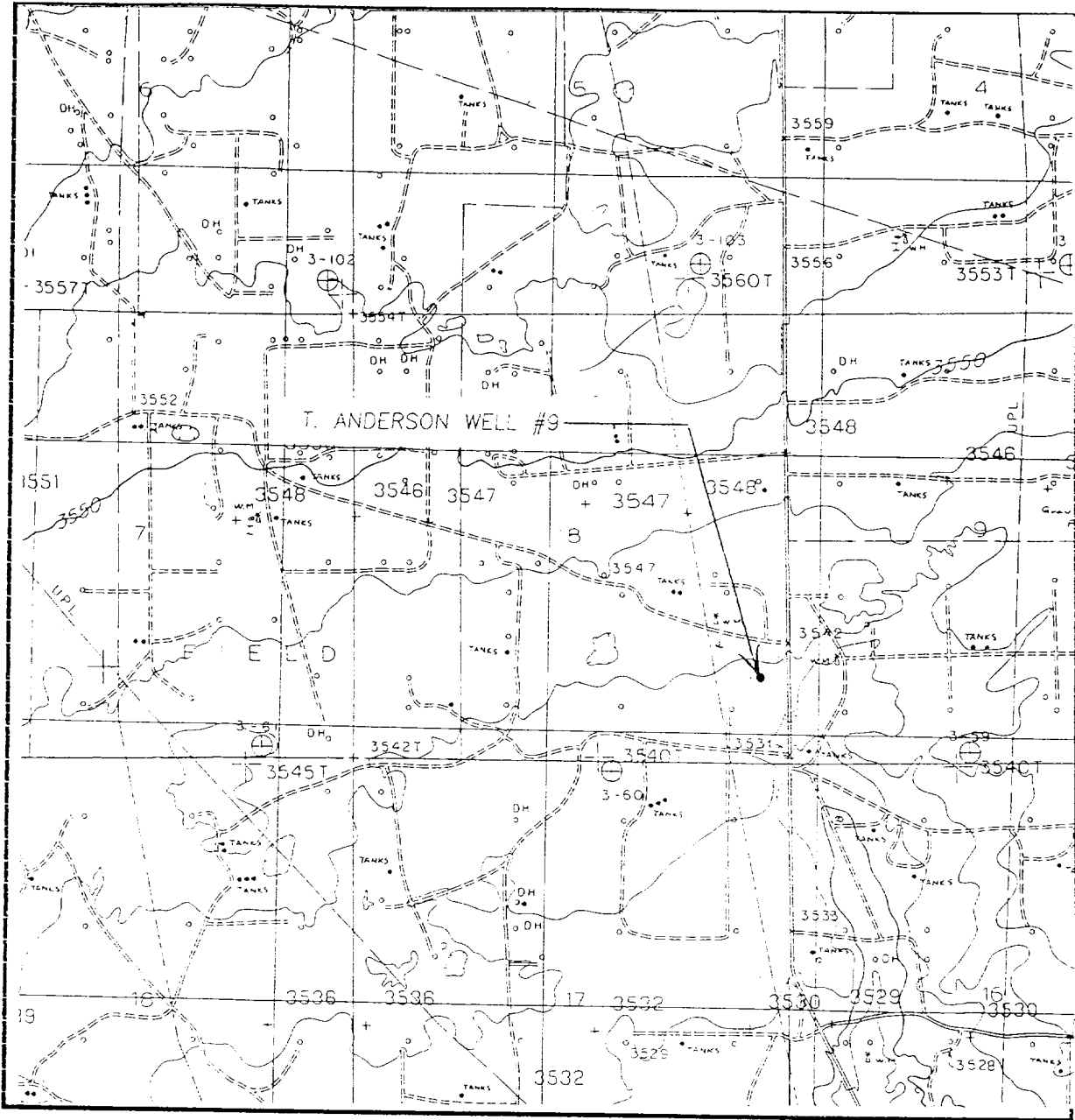

SCALE: 1" = 2000'

CONTOUR INTERVAL - 5'

SEC. 8 TWP. 20-S RGE. 37-E

SURVEY N.M.P.M.

COUNTY LEA

DESCRIPTION 990' FSL & 330' FEL

ELEVATION 3534

OPERATOR CHEVRON U.S.A. INC.

LEASE T. ANDERSON

U.S.G.S. TOPOGRAPHIC MAP

MONUMENT SOUTH N.M.

**JOHN WEST ENGINEERING
HOBBS, NEW MEXICO**

(505) 393-3117

VICINITY MAP

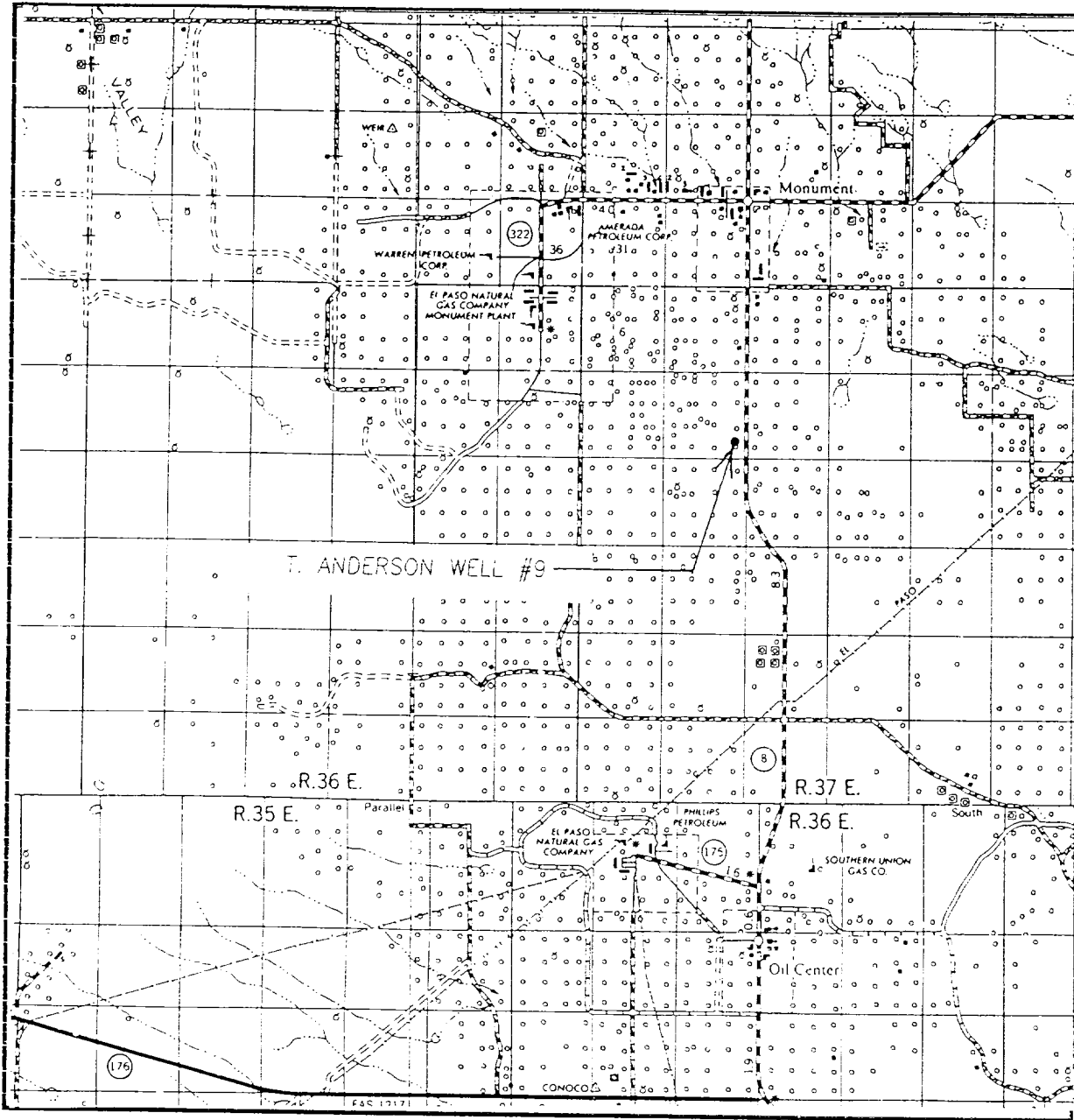

SCALE: 1" = 2 MILES

SEC. 8 TWP. 20-S RGE. 37-E
 SURVEY N.M.P.M.
 COUNTY LEA
 DESCRIPTION 990' FSL & 330' FEL
 ELEVATION 3534
 OPERATOR CHEVRON U.S.A. INC
 LEASE T. ANDERSON

JOHN WEST ENGINEERING
HOBBS, NEW MEXICO
(505) 393-3117

D. CLASS II-B BLOWOUT PREVENTER STACK:

Figure 11J.3
Class II-B Blowout Preventer Stack

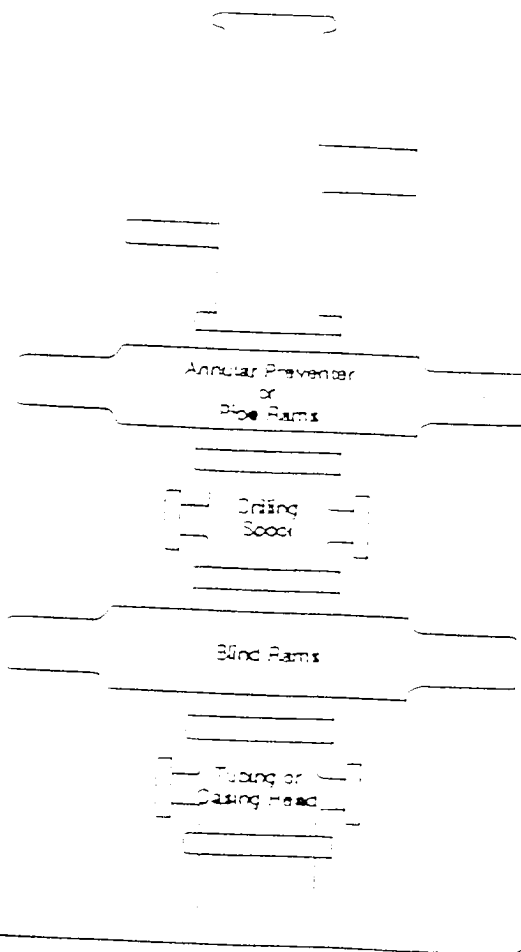

The Class II-B preventer stack is designed for drilling or workover operations. It is composed of a single hydraulically operated annular preventer on top, then a drilling spool, and a single blind ram preventer on bottom. In an alternate configuration, a single pipe ram preventer may be substituted for the annular preventer. The choke and kill lines are installed onto the drilling spool and must have a minimum internal diameter of 2". An emergency kill line may be installed on the wellhead. As the maximum anticipated surface pressure of this stack is less than 2000 psi, screwed connections may be used. All components must be of steel construction. The Class II-B blowout preventer stack is shown to the left in Figure 11J.3.

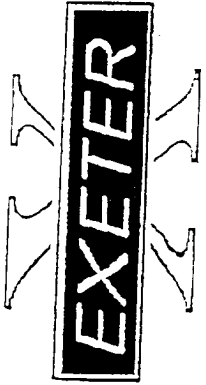

RIG 70

Location Dimensions

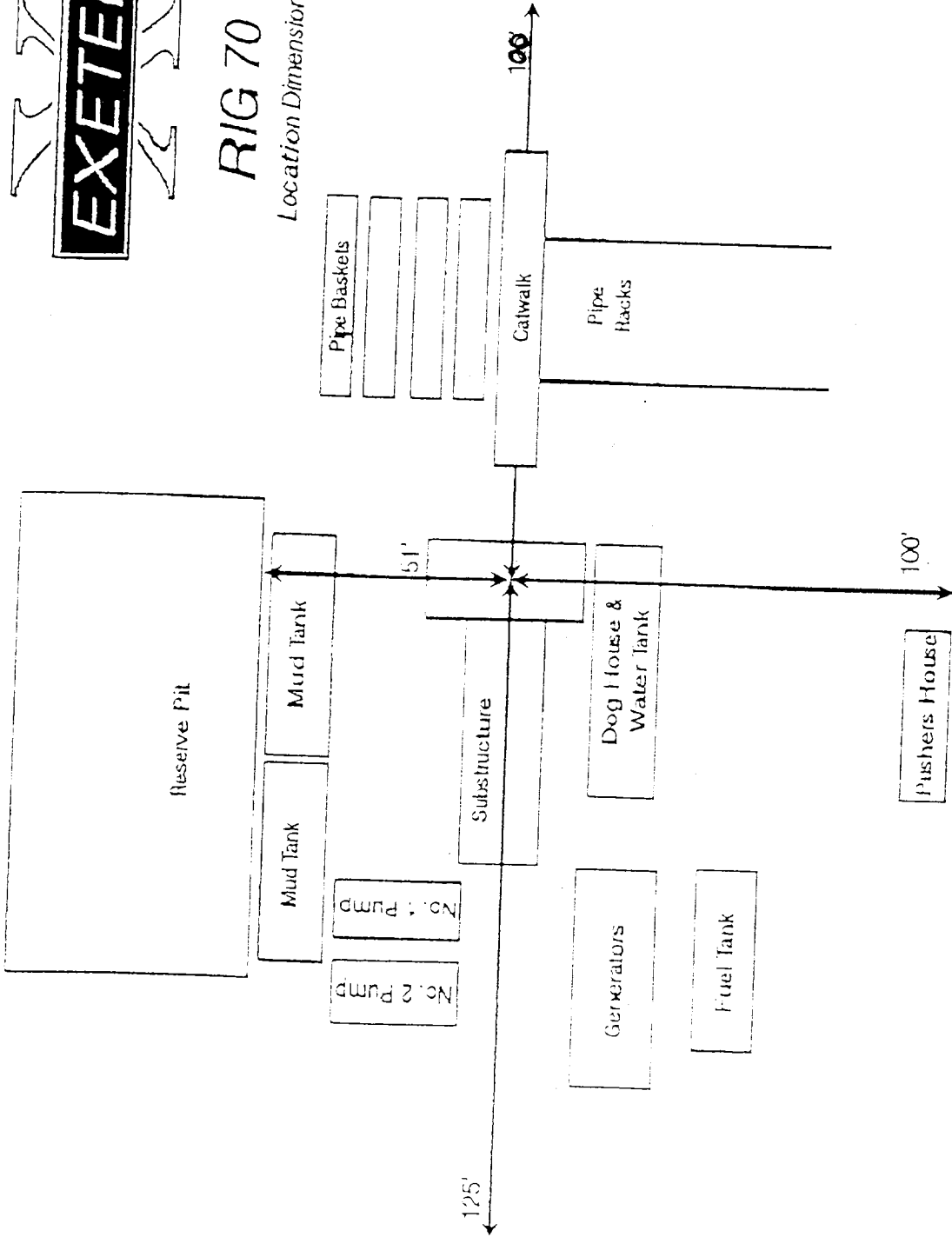

4-95