

District I
PO Box 1980, Hobbs, NM 88241-1980

District II
811 South First, Artesia, NM 88210

District III
1000 Rio Brazos Rd., Aztec, NM 87410

District IV
2040 South Pacheco, Santa Fe, NM 87505

State of New Mexico
Energy, Minerals & Natural Resources Department

OIL CONSERVATION DIVISION
2040 South Pacheco
Santa Fe, NM 87505

Form C-101

Revised October 18, 1994

Instructions on back

Submit to Appropriate District Office

State Lease - 6 Copies

Fee Lease - 5 Copies

☐ AMENDED REPORT

APPLICATION FOR PERMIT TO DRILL, RE-ENTER, DEEPEN, PLUGBACK, OR ADD A ZONE

Operator Name and Address BTA OIL PRODUCERS 104 SOUTH PECOS MIDLAND, T X 79701		OGRID Number 003002
		API Number 30-025-34726
Property Code 002314	Property Name Gem, 8705 JV-P	Well No. 7

Surface Location

POTASH AREA

UL or lot no.	Section	Township	Range	Lot Idn	Feet from the	North/South line	Feet from the	East/West Line	County
L	2	20-S	33-E		1650	South	330	West	Lea

Proposed Bottom Hole Location If Different From Surface

UL or lot no.	Section	Township	Range	Lot Idn	Feet from the	North/South line	Feet from the	East/West Line	County
Proposed Pool 1 Teas, Delaware Pool code 96797					Proposed Pool 2				

Work Type Code N	Well Type Code O	Cable/Rotary R	Lease Type Code S	Ground Level Elevation 3581
Multiple No	Proposed Depth 7000	Formation Delaware	Contractor N/A	Spud Date 11-01-99

Proposed Casing and Cement Program

Hole Size	Casing Size	Casing weight/foot	Setting Depth	Sacks of Cement	Estimated TOC
17-1/2"	13-3/8"	54.5#	1,400	Sufficient to	Circ. to Surface
11"	8-5/8"	32#	3,300	Sufficient to	Circ. to Surface
7-7/8"	5-1/2"	17#	7,000	Sufficient for	TOC @ 4,000'
					TIE BACK TO INTERMEDIATE

Describe the proposed program. If this application is to DEEPEN or PLUG BACK give the data on the present productive zone and proposed new productive zone. Describe the blowout prevention program, if any. Use additional sheets if necessary.

BOP's on 13-3/8" csg and below -3,000 psi WP SRRA

Potash lessee: Mississippi Potash, Inc.
P. O. Box 101
Carlsbad, NM 88220

Surface lessee: Kenneth Smith, Inc.
P. O. Box 764
Carlsbad, NM 88220

Permit Expires 1 Year From Approval
Date Unless Drilling Underway

I hereby certify that the information given above is true and complete to the best of my knowledge and belief.

Signature:

Printed name:

DOROTHY HOUGHTON

Title:

REGULATORY ADMINISTRATOR

Date:

10-01-99

Phone:

915/682-3753

OIL CONSERVATION DIVISION

Approved By:

ORIGINAL SIGNED BY CHRIS WILLIAMS
DISTRICT I SUPERVISOR

Title:

Approval Date:

OCT 15 1999

Expiration Date:

Conditions of Approval:

Attached: ☐

CT
MP



STATE OF NEW MEXICO
ENERGY, MINERALS AND NATURAL RESOURCES DEPARTMENT
OIL CONSERVATION DIVISION
HOBBS DISTRICT OFFICE

GOVERNOR

POST OFFICE BOX 1880
HOBBS, NEW MEXICO 88241-1880
(505) 283-6181

BUREAU OF LAND MANAGEMENT
P.O. Box 1778
Carlsbad, NM 88221

STATE LAND OFFICE
Attn: Joe Mraz
P.O. Box 1148
Santa Fe, NM 87504

RE: APPLICATION FOR PERMIT TO DRILL IN POTASH AREA

OPERATOR BTA Oil Producers

LEASE NAME Gem, 8705 JV-P #7

PROPOSED LOCATION 2-208-33E (Unit L)

PROPOSED DEPTH 7000'

Gentlemen:

The application for permit to drill identified above has been filled with this office of the New Mexico Oil Conservation Division. Pursuant to the provisions of Oil Conservation Division Order R-III-P, please advise this office whether the location is within an established Life-of-Mine-Reserve area filed with and approved by your office. If not, please advise whether it is within the buffer zone established by the order.

Thank you for your assistance. Please return as soon as possible.

Very truly yours,

OIL CONSERVATION DIVISION

Chris Williams
Supervisor, District I

RESPONSE:

The above-referenced location is in LMR ----- Yes ☐ No ☒

The above-referenced location is within the buffer zone----- Yes ☐ No ☒

Signed [Signature]

Date 10-12-99

Representing BLM



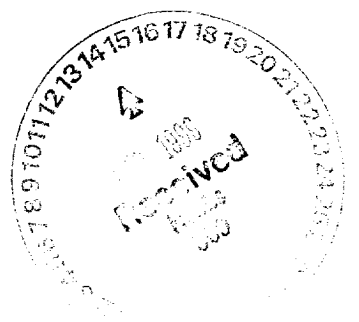



STATE OF NEW MEXICO
ENERGY, MINERALS AND NATURAL RESOURCES DEPARTMENT

OIL CONSERVATION DIVISION
HOBBS DISTRICT OFFICE

GOVERNOR

POST OFFICE BOX 1880
HOBBS, NEW MEXICO 88241-1880
(505) 393-6161

BUREAU OF LAND MANAGEMENT
P.O. Box 1778
Carlsbad, NM 88221

STATE LAND OFFICE
Attn: Joe Mraz
P.O. Box 1148
Santa Fe, NM 87504

RE: APPLICATION FOR PERMIT TO DRILL IN POTASH AREA

OPERATOR BTA Oil Producers

LEASE NAME Gem, 8705 JV-P #7

PROPOSED LOCATION 2-20S-33E (Unit L)

PROPOSED DEPTH 7000'

Gentlemen:

The application for permit to drill identified above has been filled with this office of the New Mexico Oil Conservation Division. Pursuant to the provisions of Oil Conservation Division Order R-III-P, please advise this office whether the location is within an established Life-of-Mine-Reserve area filed with and approved by your office. If not, please advise whether it is within the buffer zone established by the order.

Thank you for your assistance. Please return as soon as possible.

Very truly yours,

OIL CONSERVATION DIVISION

Chris Williams
Supervisor, District I

RESPONSE:

The above-referenced location is in LMR ----- Yes ☐ No ☒

The above-referenced location is within the buffer zone----- Yes ☐ No ☒

Signed *Chris Williams*

Date 10/6/99

Representing SLC

JR.
MRAZ
10-6-99







October 7, 1999

Oil Conservation Division
P.O. Box 1980
Hobbs, NM 88241
Attention: Mr. Chris Williams, District Supervisor

Re: BTA 8705 JV-P Gem No. 7
Section 2, T-20-S, R-33-E
Lea County, New Mexico

Dear Mr. Williams:

Mississippi Potash, Inc. offers no objection to the drilling of the BTA 8705 JV-P Gem No. 7 well by BTA Oil Producers.

Sincerely,

A handwritten signature in cursive script, appearing to read "Jill Farnsworth".

Jill Farnsworth
Chief Mine Engineer

Cc: Ms. Dorothy Houghton
BTA Oil Producers
104 South Pecos
Midland, TX 79701

Ms. Lori Wrotenbery
Director
Oil Conservation Division
2040 South Pacheco
Santa Fe, NM 87505

GUIDELINES FOR PROCESSING APD FOR WELL IN POTASH AREA -- R-111-P

BLM approves federal wells in potash area so we do not have to worry about this.

STATE & FEE LEASES

Post to map and if within the potash area outlined on map or within 1 mile of that area do the following:

- 1) Make certain operator has filed a plat of the area showing the potash lessees for the area where the well is located as well as the 1-mile radius referred to.
- 2) Make certain operator has notified all of the potash lessees by certified mail of the APD. They must send copy of delivery notice to us since 20-day waiting period starts from delivery date.
- 3) Send letter to BLM and SLO advising them of this APD and request they advise if this location is within LMR or buffer zone.

BUFFER ZONE -- shallow well is 1/4 mile of LMR
-- deep well is 1/2 mile of LMR

- 4) If application is within LMR or buffer zone you must DENY it under R-111-P unless, there is a mutual agreement of lessor and lessees of oil & gas and potash interests. Copy of this agreement must be submitted with APD.
- 5) If application is outside LMR or buffer zone and no objection is received within 20 days from date of receipt by potash lessees of certified notice, the APD may be approved.

CHECK LIST FOR PROCESSING APD IN POTASH AREA

OPERATOR: BTA Oil Producers

LEASE & WELL Gem, 8705 JV-P #7

LOCATION 2-20S-33E (UNIT L) PROPOSED DEPTH 7000'

DATE APD RECEIVED 10/5/99 WAS PLAT OF AREA ATTACHED Yes

WERE ALL POTASH LESSEES NOTIFIED BY CERTIFIED MAIL? yes

20-DAY WAITING PERIOD BEGINS 10-5-99 ENDS 10-14-99

WERE WAIVERS RECEIVED? yes

DATE SLO NOTIFIED 10-5-99 DATE REPLY RECEIVED 10-13-99

DATE BLM NOTIFIED 10-5-99 DATE REPLY RECEIVED 10-14-99

IS LOCATION INSIDE LMR OR BUFFER ZONE? YES NO ✓

IF LOCATION INSIDE LMR OR BUFFER ZONE WAS LESSEE/LESSOR AGREEMENT FURNISHED

DATE APD APPROVED OCT 15 1999 DATE APD DENIED

DISTRICT I
P.O. Box 1880, Hobbs, NM 88241-1880

State of New Mexico
Energy, Minerals and Natural Resources Department

Form C-102
Revised February 10, 1994
Submit to Appropriate District Office
State Lease - 4 Copies
Fee Lease - 3 Copies

DISTRICT II
P.O. Drawer DD, Artesia, NM 88211-0719

DISTRICT III
1000 Rio Brazos Rd., Aztec, NM 87410

DISTRICT IV
P.O. BOX 2088, SANTA FE, N.M. 87504-2088

OIL CONSERVATION DIVISION

P.O. Box 2088
Santa Fe, New Mexico 87504-2088

☐ AMENDED REPORT

WELL LOCATION AND ACREAGE DEDICATION PLAT

API Number 30-025-34726	Pool Code 96797	Pool Name Teas, Delaware
Property Code 002314	Property Name 8705 JV-P GEM	Well Number 7
OGRID No. 003002	Operator Name BTA OIL PRODUCERS	Elevation 3581

Surface Location

UL or lot No. L	Section 2	Township 20 S	Range 33 E	Lot Idn	Feet from the 1650	North/South line SOUTH	Feet from the 330	East/West line WEST	County LEA
---------------------------	---------------------	-------------------------	----------------------	---------	------------------------------	----------------------------------	-----------------------------	-------------------------------	----------------------

Bottom Hole Location If Different From Surface

UL or lot No.	Section	Township	Range	Lot Idn	Feet from the	North/South line	Feet from the	East/West line	County
Dedicated Acres 40	Joint or Infill J	Consolidation Code	Order No.						

NO ALLOWABLE WILL BE ASSIGNED TO THIS COMPLETION UNTIL ALL INTERESTS HAVE BEEN CONSOLIDATED
OR A NON-STANDARD UNIT HAS BEEN APPROVED BY THE DIVISION

LOT 4 39.74 ACRES	LOT 3 39.59 ACRES	LOT 2 39.43 ACRES	LOT 1 39.28 ACRES	<p>OPERATOR CERTIFICATION</p> <p>I hereby certify the the information contained herein is true and complete to the best of my knowledge and belief.</p> <p><i>Dorothy Houghton</i> Signature</p> <p>DOROTHY HOUGHTON Printed Name</p> <p>Regulatory Administrator Title</p> <p>10/04/99 Date</p> <p>SURVEYOR CERTIFICATION</p> <p>I hereby certify that the well location shown on this plat was plotted from field notes of actual surveys made by me or under my supervision, and that the same is true and correct to the best of my belief.</p> <p>SEPTEMBER 29, 1999</p> <p>Date Surveyed Signature & Seal Professional Surveyor RONALD J. EIDSON NEW MEXICO 3239 9-30-99 9-11-0820 Certificate No. RONALD J. EIDSON 3239 CAROL EIDSON 12641 DAVID J. McDONALD 12185</p>
---------------------------------	---------------------------------	---------------------------------	---------------------------------	---

VICINITY MAP

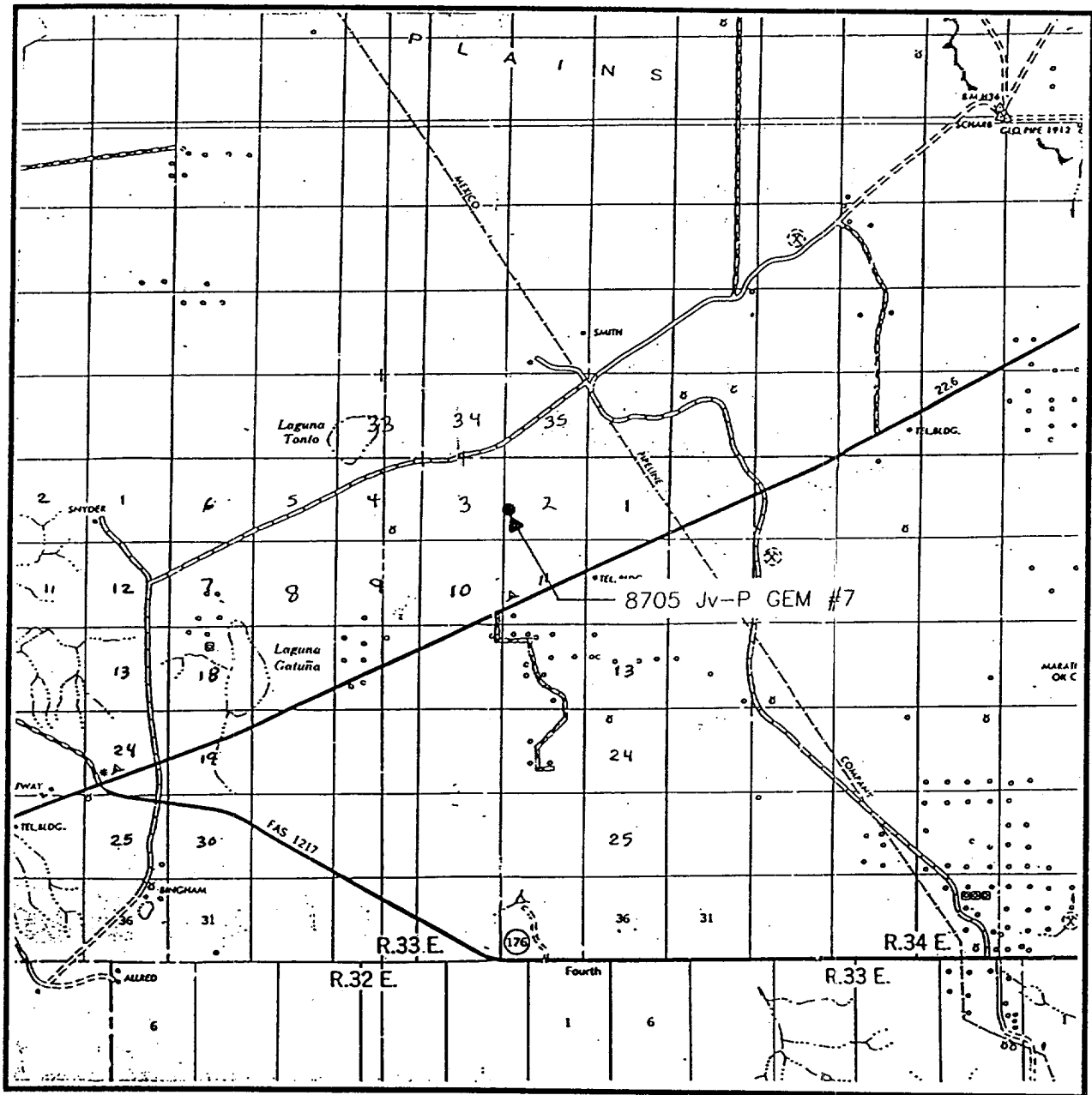

SCALE: 1" = 2 MILES

SEC. 2 TWP. 20-S RGE. 33-E

SURVEY N.M.P.M.

COUNTY LEA

DESCRIPTION 1650' FSL & 330' FWL

ELEVATION 3581

OPERATOR BTA OIL PRODUCERS

LEASE 8705 Jv-P GEM

**JOHN WEST SURVEYING
HOBBS, NEW MEXICO**

(505) 393-3117

LOCATION VERIFICATION MAP

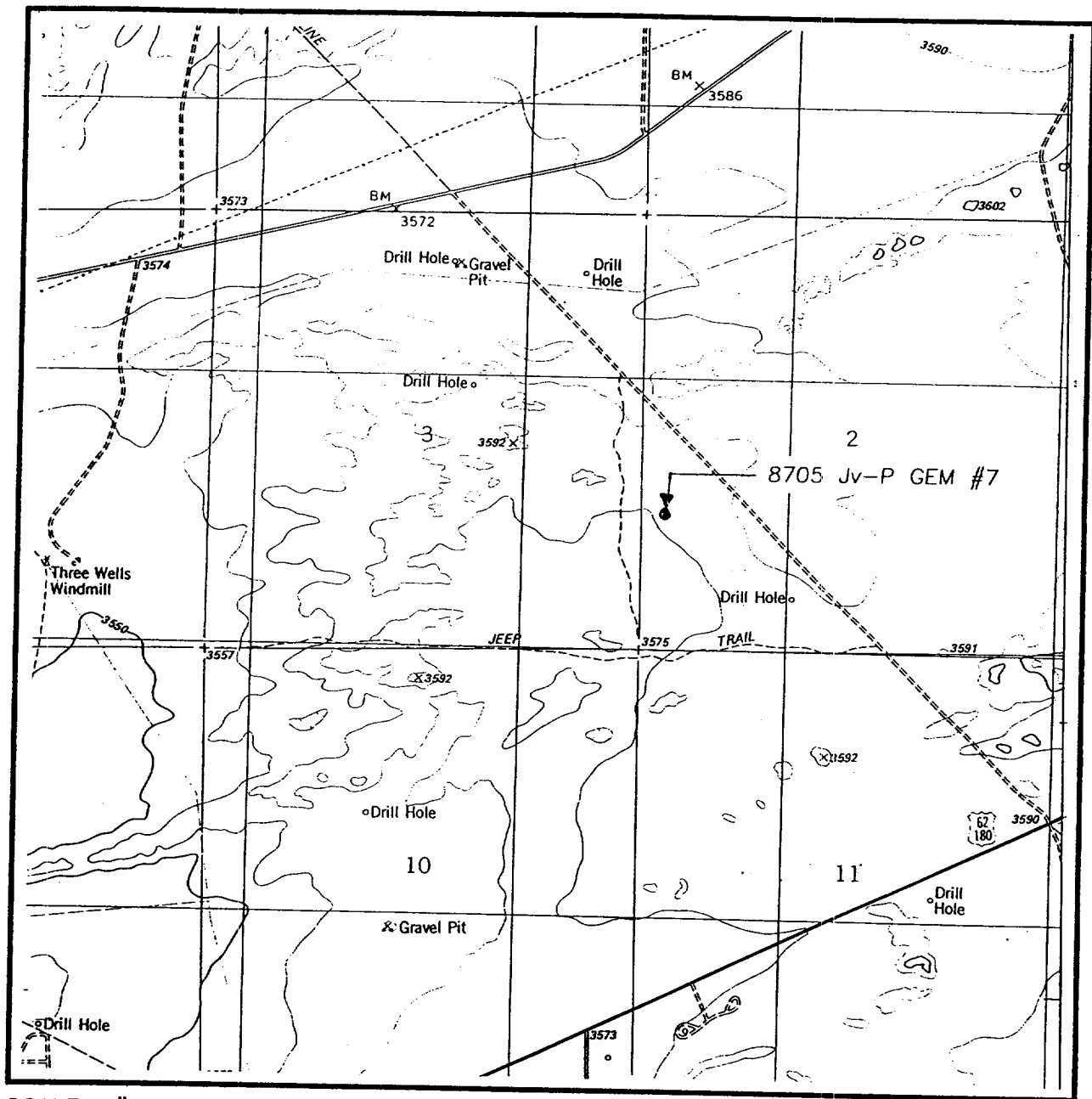

SCALE: 1" = 2000'

CONTOUR INTERVAL:
LAGUNA GATUNA - 10'

SEC. 2 TWP. 20-S RGE. 33-E

SURVEY N.M.P.M.

COUNTY LEA

DESCRIPTION 1650' FSL & 330' FWL

ELEVATION 3581

OPERATOR BTA OIL PRODUCERS

LEASE 8705 Jv-P GEM

U.S.G.S. TOPOGRAPHIC MAP

LAGUNA GATUNA, N.M.

JOHN WEST SURVEYING
HOBBS, NEW MEXICO
(505) 393-3117